

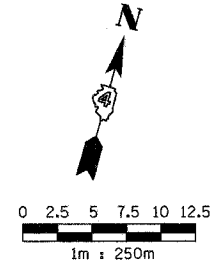

F.A.I. RTE.	SECTION	COUNTY	TOTAL SHEETS	SHEET NO.
74*	**	TAZEWELL	1366	977
STA. 99+960		TO STA. 100+050		
FED. ROAD DIST. NO.	ILLINOIS	FED. AID PROJECT		
*WASHINGTON STREET				
**(90-11R-2)90113,14,14-1R-1				

TRAFFIC CONTROL
 LANE CLOSURE ON WASHINGTON STREET SHALL BE IN ACCORDANCE WITH STANDARD 701601 FOR PLACEMENT OF DRUMS OR BARRICADES

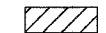

SYMBOLS

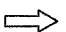
-  WORK AREA
-  DRUM OR BARRICADE 50' SPACING
-  DIRECTION OF TRAFFIC FLOW

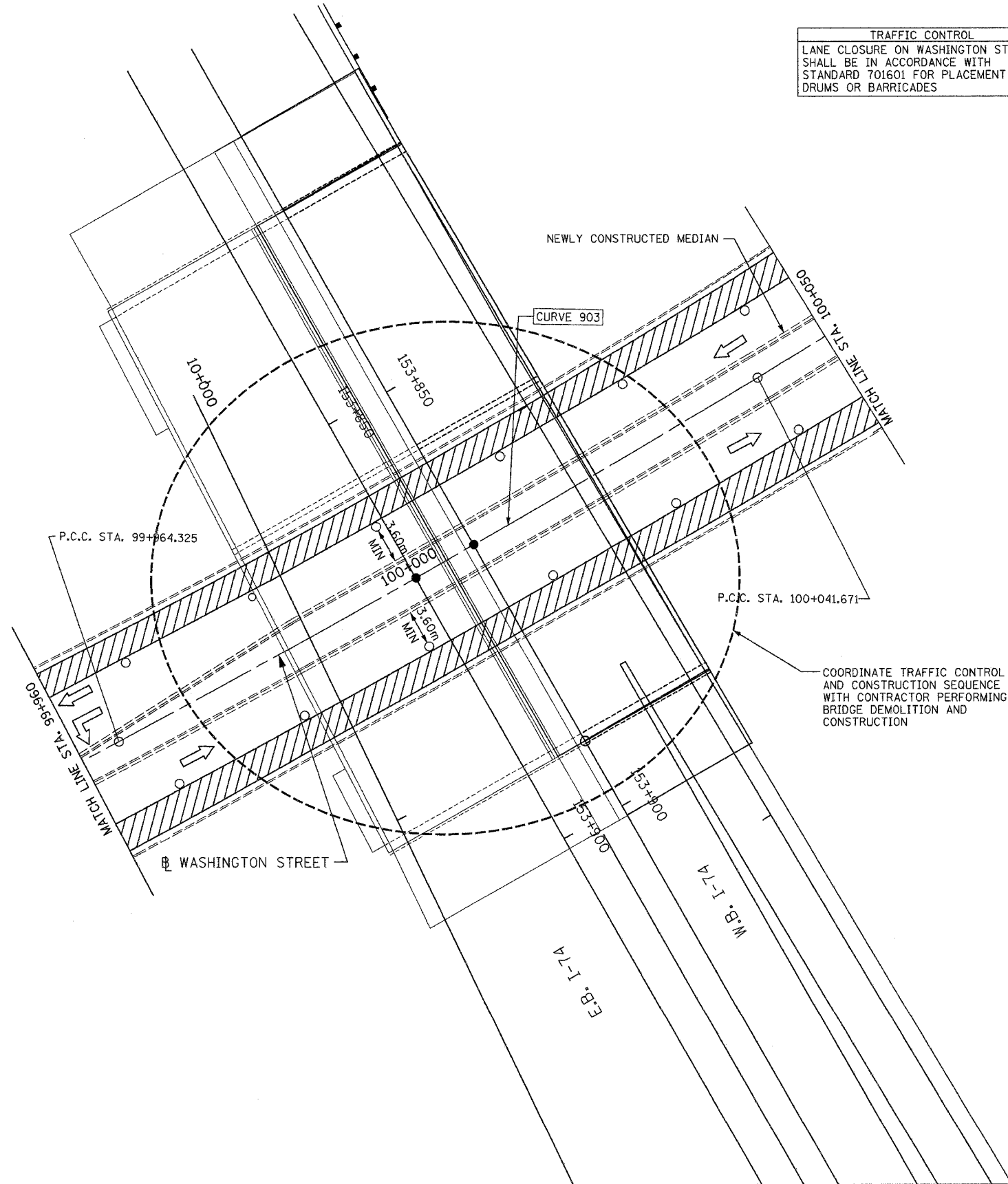

COORDINATE TRAFFIC CONTROL AND CONSTRUCTION SEQUENCE WITH CONTRACTOR PERFORMING BRIDGE DEMOLITION AND CONSTRUCTION



VASCONCELLES
 ENGINEERING CORP.
 SPRINGFIELD, ILLINOIS

REVISIONS	
NAME	DATE

ILLINOIS DEPARTMENT OF TRANSPORTATION
 MAINTENANCE OF TRAFFIC
 STAGE 3-2
 WASHINGTON STREET
 STA. 99+960 TO STA. 100+050
 DATE _____ DRAWN BY _____
 CHECKED BY _____

CONTRACT 11: PLAN SET 2 OF 3 PRE-FINAL 02/02/04 VEC 14 OF 53. JOB NO. 751-001 VASCONCELLES ENGINEERING CORP. DESIGN FIRM REGISTRATION NUMBER 184-003107

mt0005-bdws