

F.A.I. RTE.	SECTION	COUNTY	TOTAL SHEETS	SHEET NO.
74	*	TAZEWELL	136	985
STA. 154+500		TO STA. 154+850		
FED. ROAD DIST. NO. 4		ILLINOIS		FED. AID PROJECT

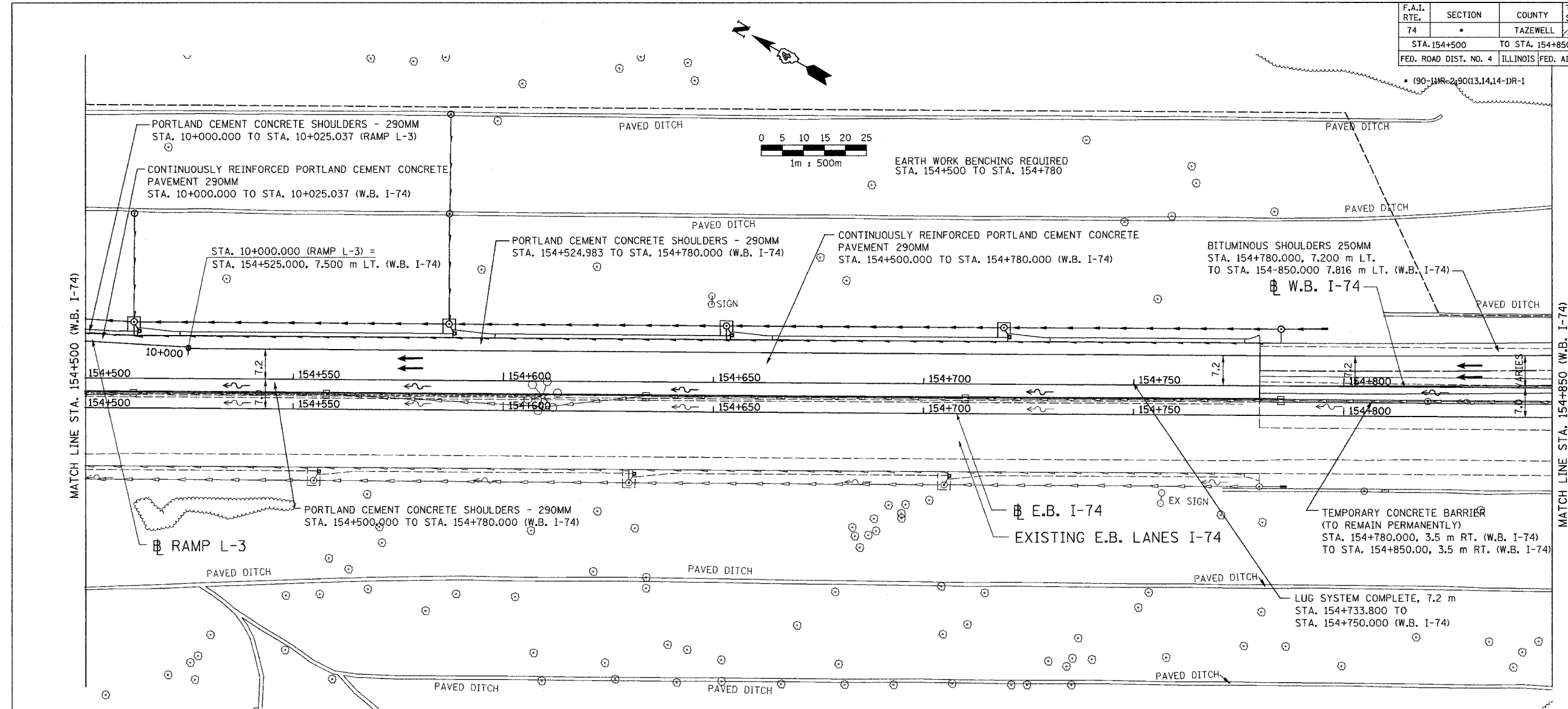

LEGEND	
<b>PROPOSED</b>	
●	CATCH BASIN
— —	INLET
○	MANHOLE
*—	SAG
↑↑	SUMMIT
— —	DITCH
— —	SWALE
— —	PIPE UNDERDRAIN
— —	SANITARY SEWER
— —	STORM SEWER
— —	FLOW DIRECTION
▲	END SECTION
— —	CULVERT
— —	CONSTRUCTION LIMITS
<b>EXISTING</b>	
—○—	GAS (LOCATION OF RECORD)
—x—x—	SANITARY (LOCATION OF RECORD)
—T—	TELEPHONE (LOCATION OF RECORD)
—W—	WATER (LOCATION OF RECORD)
— —	DITCH

01/07/2005 02:40:22 PM  
 G:\ddto\5589-74\dwg\contract\11\p1170-6g.dgn

ALL DIMENSIONS ARE IN METERS (m) EXCEPT AS NOTED

**DA**  
 DAILY & ASSOCIATES,  
 ENGINEERS, INC.  
 PEORIA, ILLINOIS

REVISIONS	
NAME	DATE

ALL STATIONS INDICATED ARE WESTBOUND STATIONING UNLESS OTHERWISE NOTED.

ILLINOIS DEPARTMENT OF TRANSPORTATION

PROPOSED ROADWAY PLAN  
 F.A.I. ROUTE 74 (I-74)  
 STA. 154+500 TO STA. 154+850

DATE 01/07/2005

DRAWN BY  
 CHECKED BY

SHEET 6 OF 12

CONTRACT 11: PLAN SET 2 OF 4 FINAL PLANS 01/05