

F.A.I. RTE.	SECTION	COUNTY	TOTAL SHEETS	SHEET NO.
74	*	TAZEWELL	1366	987
STA. 154+850		TO STA. 155+200		
FED. ROAD DIST. NO. 4		ILLINOIS		FED. AID PROJECT

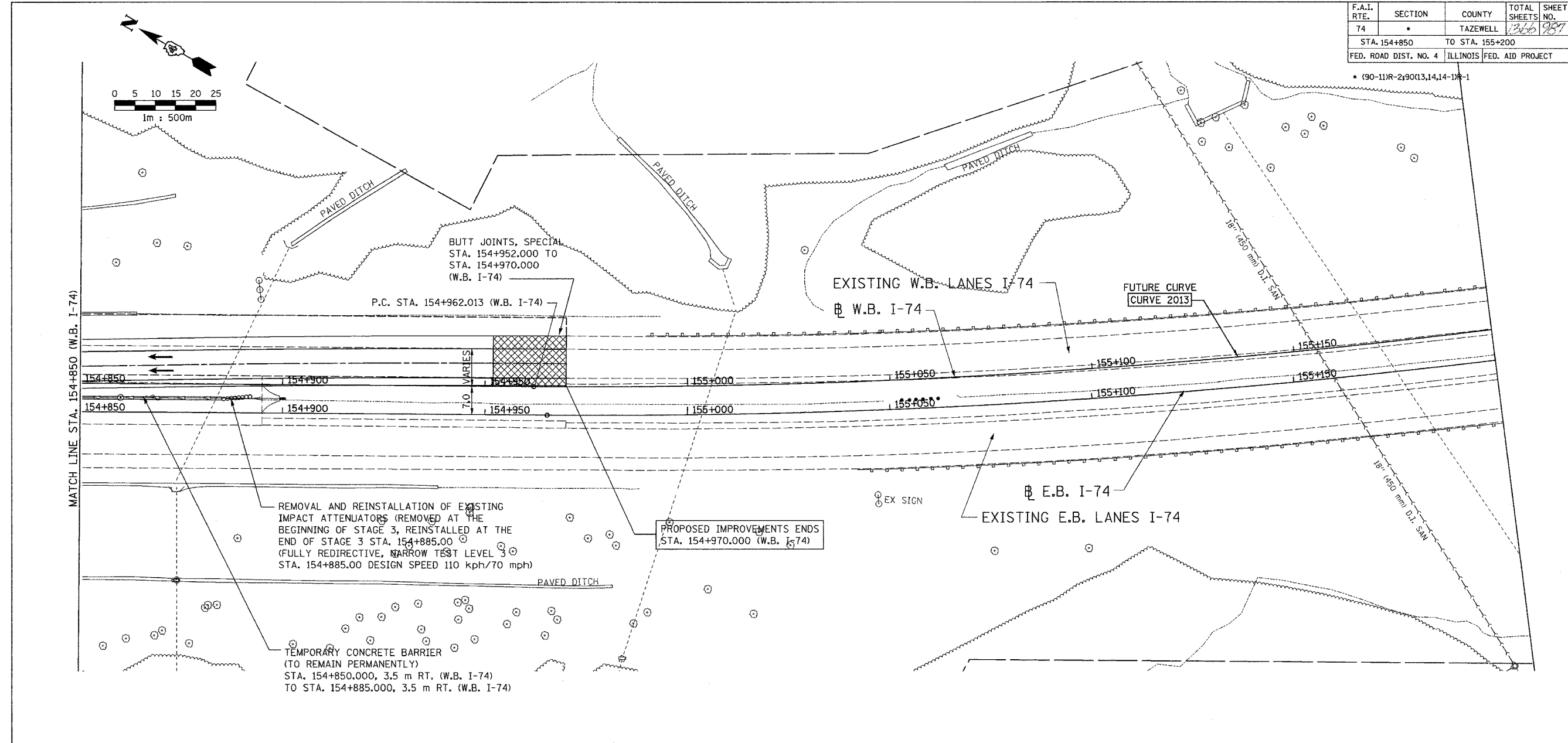

PROPOSED		LEGEND	
●	CATCH BASIN	—G—	GAS (LOCATION OF RECORD)
⊥	INLET	—S—	SANITARY (LOCATION OF RECORD)
⊙	MANHOLE	—T—	TELEPHONE (LOCATION OF RECORD)
*	SAG	—W—	WATER (LOCATION OF RECORD)
↑ ↓	SUMMIT	- - - -	DITCH
↑ ↓	DITCH		
↑ ↓	SWALE		
—	PIPE UNDERDRAIN		
—	SANITARY SEWER		
—	STORM SEWER		
→	FLOW DIRECTION		
▲	END SECTION		
—	CULVERT		
—	RIGHT-OF-WAY		
—	CONSTRUCTION LIMITS		

REMOVAL AND REINSTALLATION OF EXISTING IMPACT ATTENUATORS (REMOVED AT THE BEGINNING OF STAGE 3, REINSTALLED AT THE END OF STAGE 3 STA. 154+885.00 (FULLY REDIRECTIVE, NARROW TEST LEVEL 3) STA. 154+885.00 DESIGN SPEED 110 kph/70 mph)

PROPOSED IMPROVEMENTS ENDS STA. 154+970.000 (W.B. I-74)

TEMPORARY CONCRETE BARRIER (TO REMAIN PERMANENTLY) STA. 154+850.000, 3.5 m RT. (W.B. I-74) TO STA. 154+885.000, 3.5 m RT. (W.B. I-74)

BUTT JOINTS, SPECIAL STA. 154+952.000 TO STA. 154+970.000 (W.B. I-74)

P.C. STA. 154+962.013 (W.B. I-74)

ALL DIMENSIONS ARE IN METERS (m) EXCEPT AS NOTED

**DA**  
DAILY & ASSOCIATES,  
ENGINEERS, INC.  
PEORIA, ILLINOIS

REVISIONS	
NAME	DATE

SHEET 8 OF 12

ALL STATIONS INDICATED ARE WESTBOUND STATIONING UNLESS OTHERWISE NOTED.

ILLINOIS DEPARTMENT OF TRANSPORTATION

PROPOSED ROADWAY PLAN  
F.A.I. ROUTE 74 (I-74)  
STA. 154+850 TO STA. 155+200

DATE 01/07/2005

DRAWN BY  
CHECKED BY

01/07/2005 02:40:24 PM  
P:\gdr\5589-74\dwg\contr\gch\p172-60.dwg

CONTRACT 11: PLAN SET 2 OF 4 FINAL PLANS 01/05