

F.A.I. RTE.	SECTION	COUNTY	TOTAL SHEETS	SHEET NO.
74	*	TAZEWELL	1366	999
STA. 154+500		TO STA. 155+200		
FED. ROAD DIST. NO. 4		ILLINOIS FED. AID PROJECT		
* (90-111R-2) 9003, 1414-1R-1				

FINAL SURVEY	BY	DATE
SURVEY PLOTTED		
NOTE BOOK TEMPLATE		
AREAS CHECKED		
NO.		

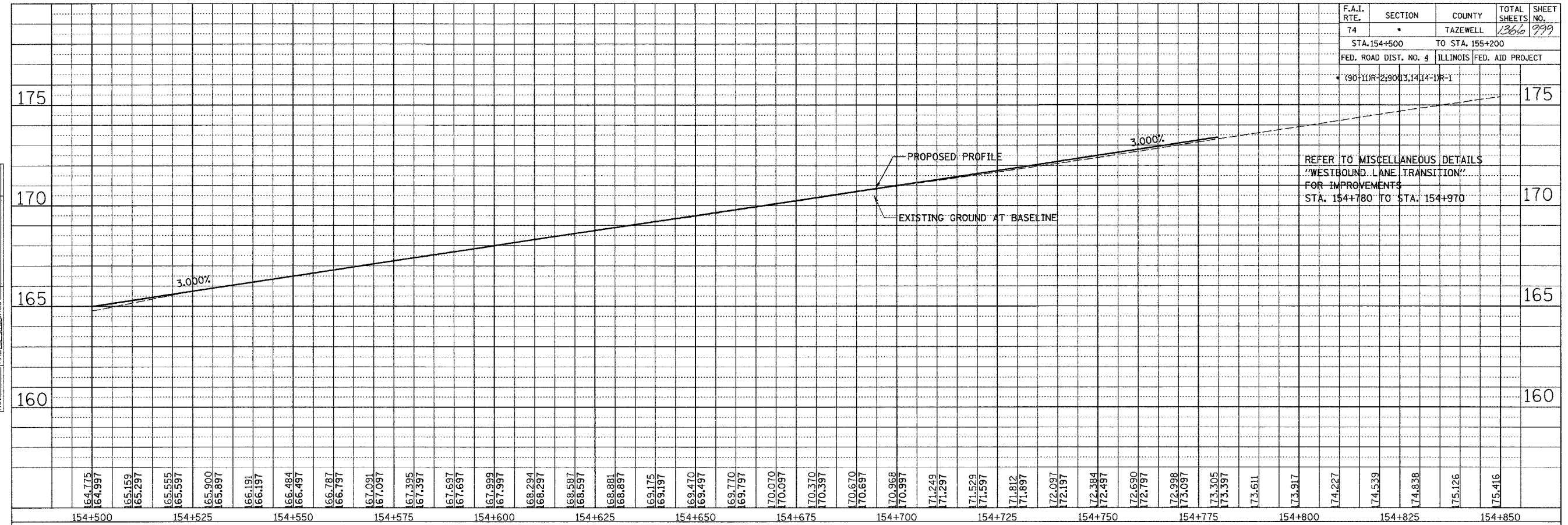

REFER TO MISCELLANEOUS DETAILS "WESTBOUND LANE TRANSITION" FOR IMPROVEMENTS STA. 154+780 TO STA. 154+970

ORIGINAL SURVEY	BY	DATE
SURVEY PLOTTED		
NOTE BOOK TEMPLATE		
AREAS CHECKED		
NO.		

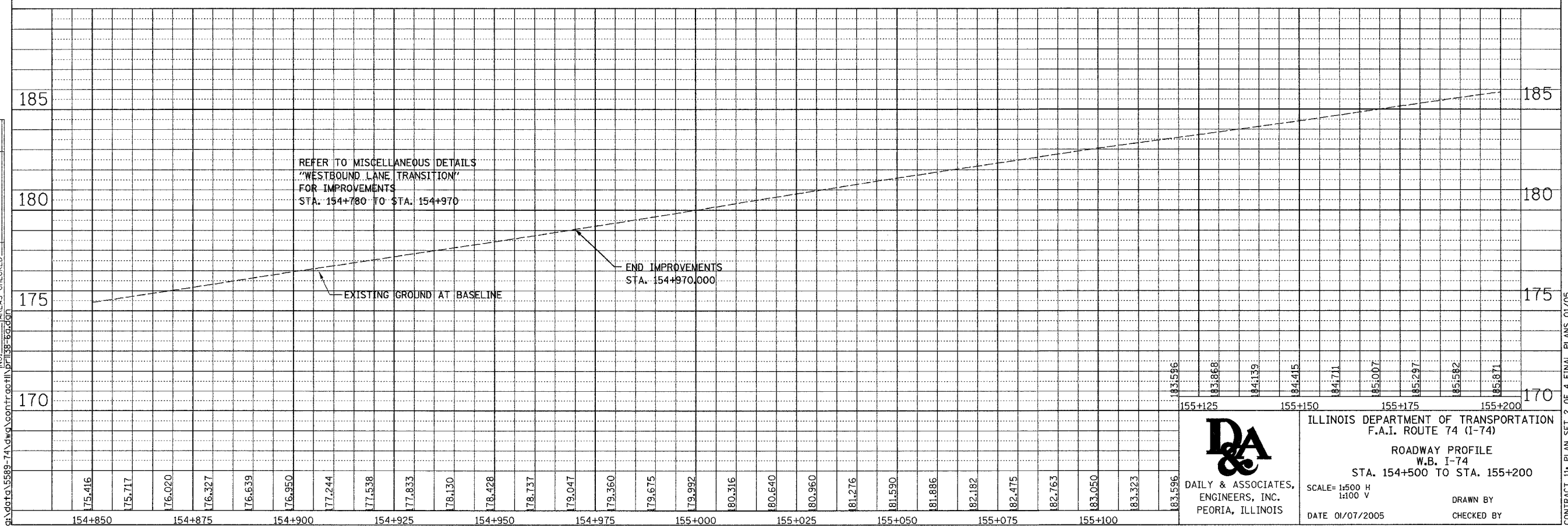

REFER TO MISCELLANEOUS DETAILS "WESTBOUND LANE TRANSITION" FOR IMPROVEMENTS STA. 154+780 TO STA. 154+970

END IMPROVEMENTS STA. 154+970.000



ILLINOIS DEPARTMENT OF TRANSPORTATION
 F.A.I. ROUTE 74 (I-74)
 ROADWAY PROFILE
 W.B. I-74
 STA. 154+500 TO STA. 155+200
 SCALE= 1:500 H
 1:100 V
 DATE 01/07/2005
 DRAWN BY
 CHECKED BY

01/07/2005 02:40:30 PM
 G:\p01a\5589-74\dwg\contract\plan\154-850.dwg

CONTRACT 11: PLAN SET 2 OF 4 FINAL PLANS 01/05