

F.A.I. RTE.	SECTION	COUNTY	TOTAL SHEETS	SHEET NO.
74		TAZEWELL	1366	1008
STA. 154+500		TO STA. 154+850		
FED. ROAD DIST. NO. 4		ILLINOIS FED. AID PROJECT		

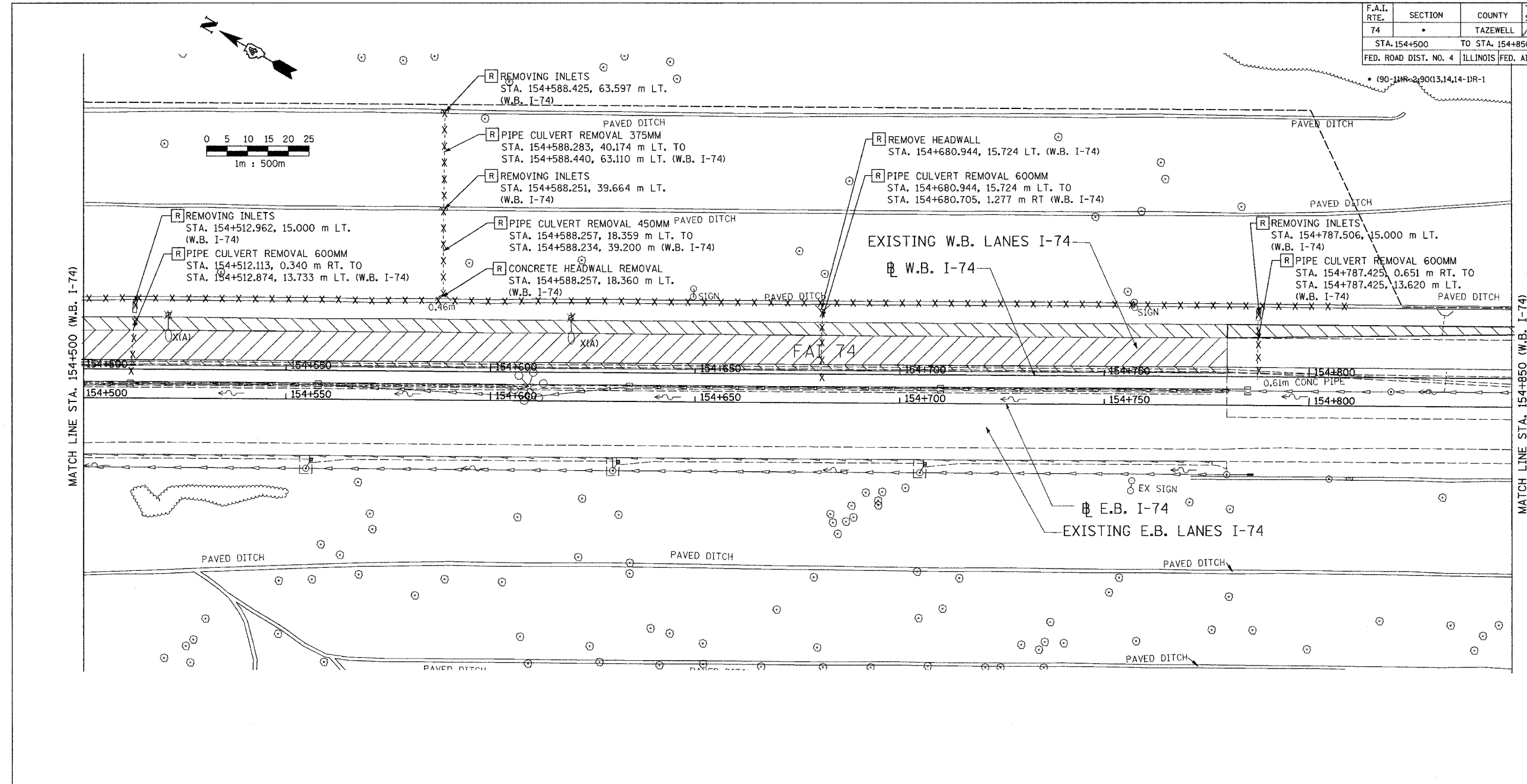

**EXISTING**

- \* LIGHT POLE TO BE REMOVED (BY OTHERS)
- CATCH BASIN
- INLET
- MANHOLE
- ⊗ SAG
- ↑↑ SUMMIT
- DITCH
- SWALE
- PIPE UNDERDRAIN
- SANITARY SEWER (LOCATION OF RECORD)
- STORM SEWER
- COMBINATION SEWER
- CULVERT
- CONCRETE HEADWALL
- FLOW DIRECTION
- GAS (LOCATION OF RECORD)
- TELEPHONE (LOCATION OF RECORD)
- WATER (LOCATION OF RECORD)
- DITCH

**LEGEND**

- STRUCTURE TO BE REMOVED
- ITEM TO BE ABANDONED
- ITEM TO BE RELOCATED
- STORM SEWER REMOVAL
- COMBINATION SEWER REMOVAL
- RIGHT-OF-WAY
- CONSTRUCTION LIMITS
- ▨ PAVEMENT REMOVAL
- ▨ SHOULDER REMOVAL
- ⊗ GUARDRAIL REMOVAL
- ⊗ PAVED DITCH REMOVAL

01/07/2005 02:40:40 PM  
 Q:\gdata\5589-74\dwg\contract\plan\112-6g.dwg

ALL DIMENSIONS ARE IN METERS (m) EXCEPT AS NOTED



REVISIONS	
NAME	DATE

SHEET 5 OF 12

ALL STATIONS INDICATED ARE WESTBOUND STATIONING UNLESS OTHERWISE NOTED.

ILLINOIS DEPARTMENT OF TRANSPORTATION  
 EXISTING DRAINAGE & UTILITIES PLAN  
 F.A.I. ROUTE 74 (I-74)  
 STA. 154+500 TO STA. 154+850

DATE 01/07/2005  
 DRAWN BY  
 CHECKED BY

CONTRACT 11: PLAN SET 2 OF 4 FINAL PLANS 01/05