

F.A.I. RTE.	SECTION	COUNTY	TOTAL SHEETS	SHEET NO.
74	*	TAZEWELL	1366	1013
STA. **		TO STA. **		
FED. ROAD DIST. NO. 4		ILLINOIS FED. AID PROJECT		

* (90-111R-2;9013,14,14-1R-1)
 ** RAMP L-1 STA. 10+200 TO STA. 10+518.739
 RAMP L-2 STA. 10+000 TO STA. 10+350

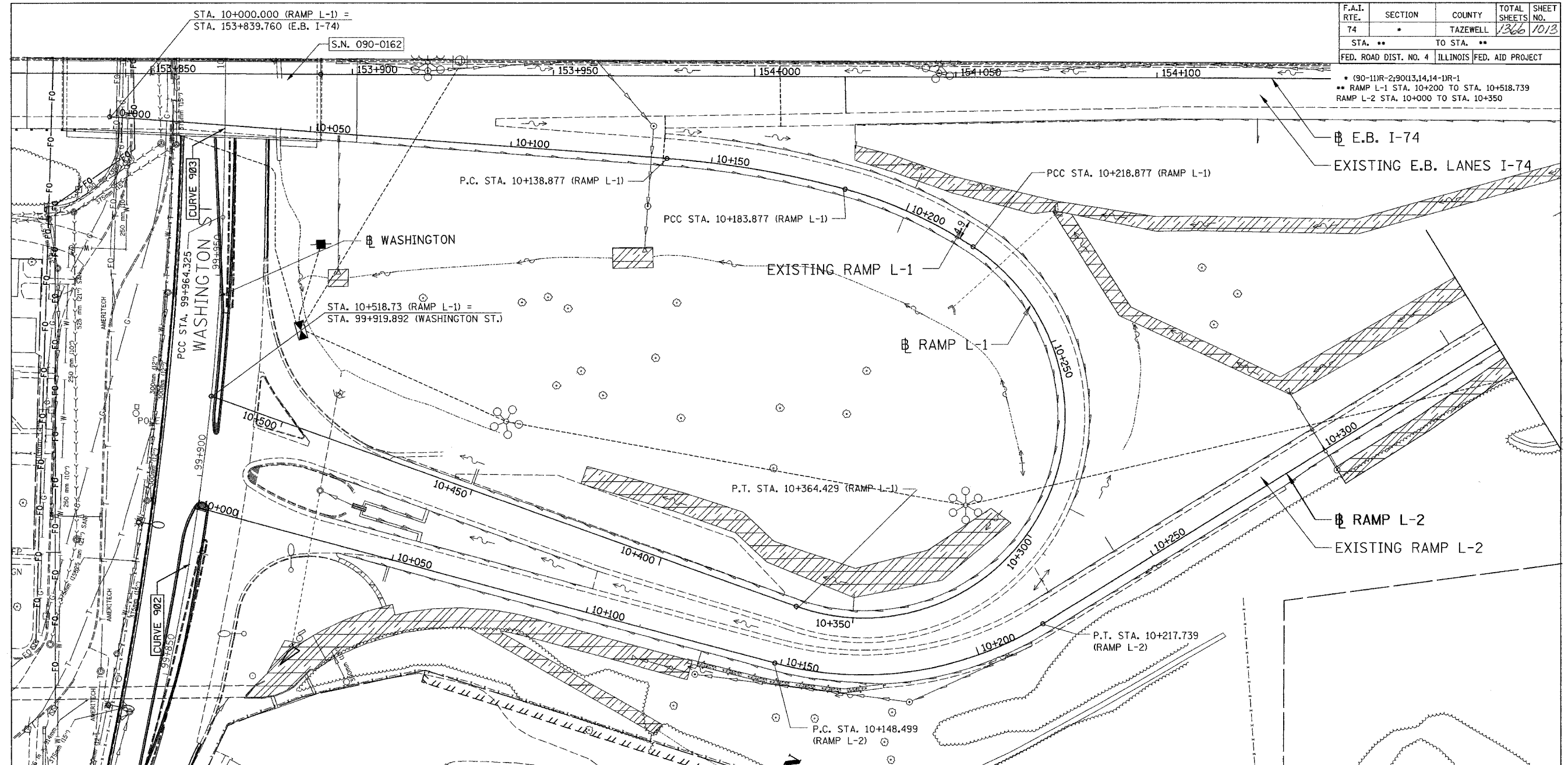

LEGEND	
	PROPOSED STORM SEWER, 600 mm Ø
	PROPOSED PIPE UNDERDRAIN
	PROPOSED HEADWALL
	PROPOSED INLET
	PROPOSED DITCH FLOW LINE
	PROPOSED RIGHT-OF-WAY
	PROPOSED CONSTRUCTION LIMITS
	EXISTING GAS (LOCATION OF RECORD)
	EXISTING SANITARY (LOCATION OF RECORD)
	EXISTING DITCH

EXISTING UTILITIES FOR THE VICINITY OF WASHINGTON STREET TO BE SUBMITTED WITH OFF-SYSTEM UTILITY PLANS.

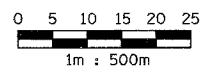

01/07/2005 02:40:45 PM
 g:\dotra\5589-74\dwg\contr\seth\gdl195-5g.dwg

ALL DIMENSIONS ARE IN METERS (m) EXCEPT AS NOTED



REVISIONS	
NAME	DATE

SHEET 10 OF 12
 ALL STATIONS INDICATED ARE WESTBOUND STATIONING UNLESS OTHERWISE NOTED.
 ILLINOIS DEPARTMENT OF TRANSPORTATION
 PROPOSED DRAINAGE & UTILITIES PLAN
 F.A.I. ROUTE 74 (I-74)
 RAMP L-1 STA. 10+200 TO STA. 10+518.739
 AND
 RAMP L-2 STA. 10+000 TO STA. 10+350.000
 DRAWN BY
 DATE 01/07/2005 CHECKED BY

CONTRACT 11: PLAN SET 2 OF 4 FINAL PLANS 01/05