

F.A.I. RTE.	SECTION	COUNTY	TOTAL SHEETS	SHEET NO.
74	*	TAZEWELL	1366	1023
STA. 154+150		TO STA. 154+500		
FED. ROAD DIST. NO. 4		ILLINOIS		FED. AID PROJECT

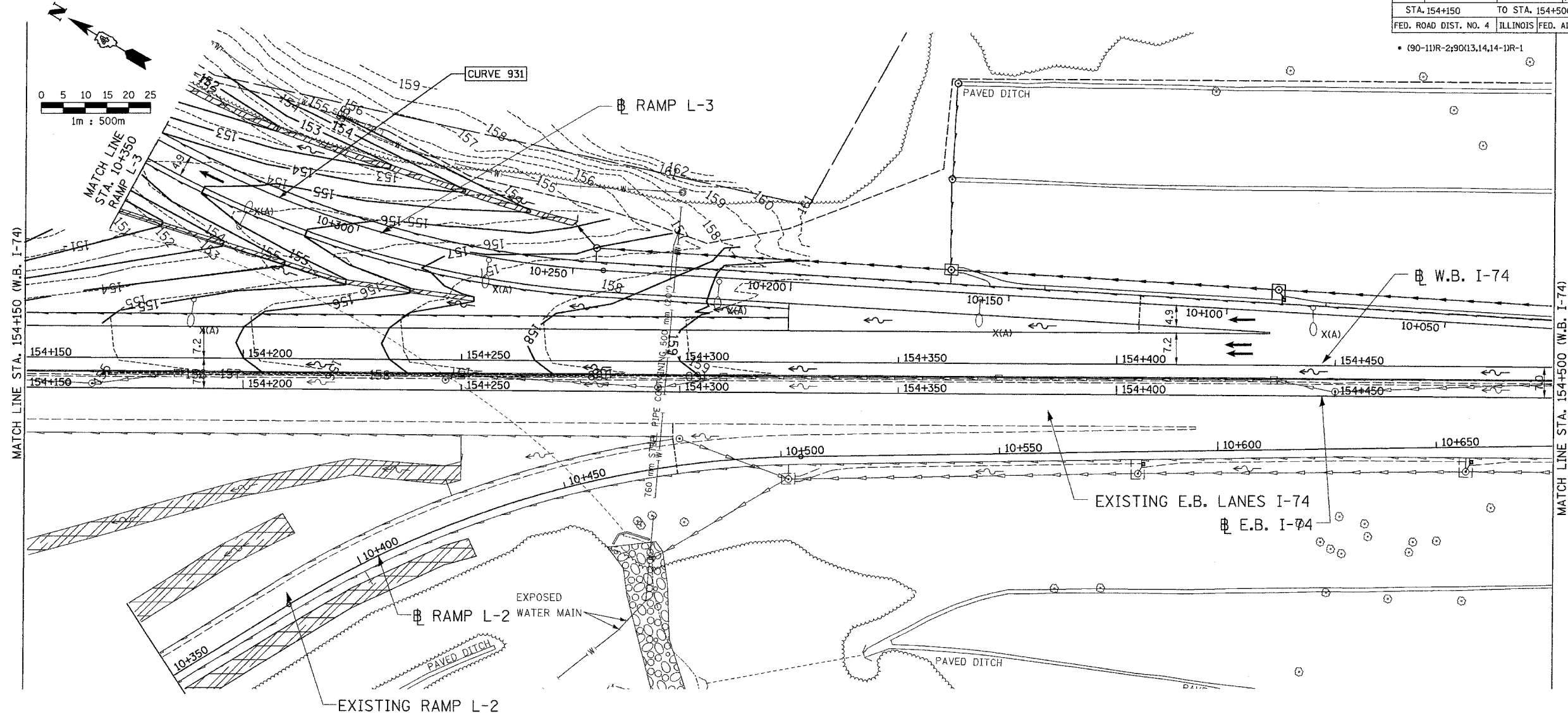

• (90-111R-2;90(13,14,14-1R-1

01/07/2005 01:21:51 PM  
 G:\dtd\5589-74\dwg\con\tr\ce\11\g102-6a.dgn

ALL DIMENSIONS ARE IN METERS (m) EXCEPT AS NOTED

**DA**  
 DAILY & ASSOCIATES,  
 ENGINEERS, INC.  
 PEORIA, ILLINOIS

REVISIONS	
NAME	DATE

SHEET 2 OF 2

ALL STATIONS INDICATED ARE WESTBOUND STATIONING UNLESS OTHERWISE NOTED.

ILLINOIS DEPARTMENT OF TRANSPORTATION

INTERCHANGE GRADING DETAIL  
 F.A.I. ROUTE 74 (I-74)  
 RAMP L-3  
 STA. 10+025 TO STA. 10+350

DATE 01/07/2005

DRAWN BY \_\_\_\_\_  
 CHECKED BY \_\_\_\_\_

CONTRACT 11: PLAN SET 2 OF 4 FINAL PLANS 01/05