

F.A.I. RTE.	SECTION	COUNTY	TOTAL SHEETS	SHEET NO.
74*	**	TAZEWELL	1366	1028
STA. 99+800		TO STA. 99+960		
FED. ROAD DIST. NO.	ILLINOIS	FED. AID PROJECT		
*WASHINGTON STREET				
**90-11R-29013,14,14-1R-1				

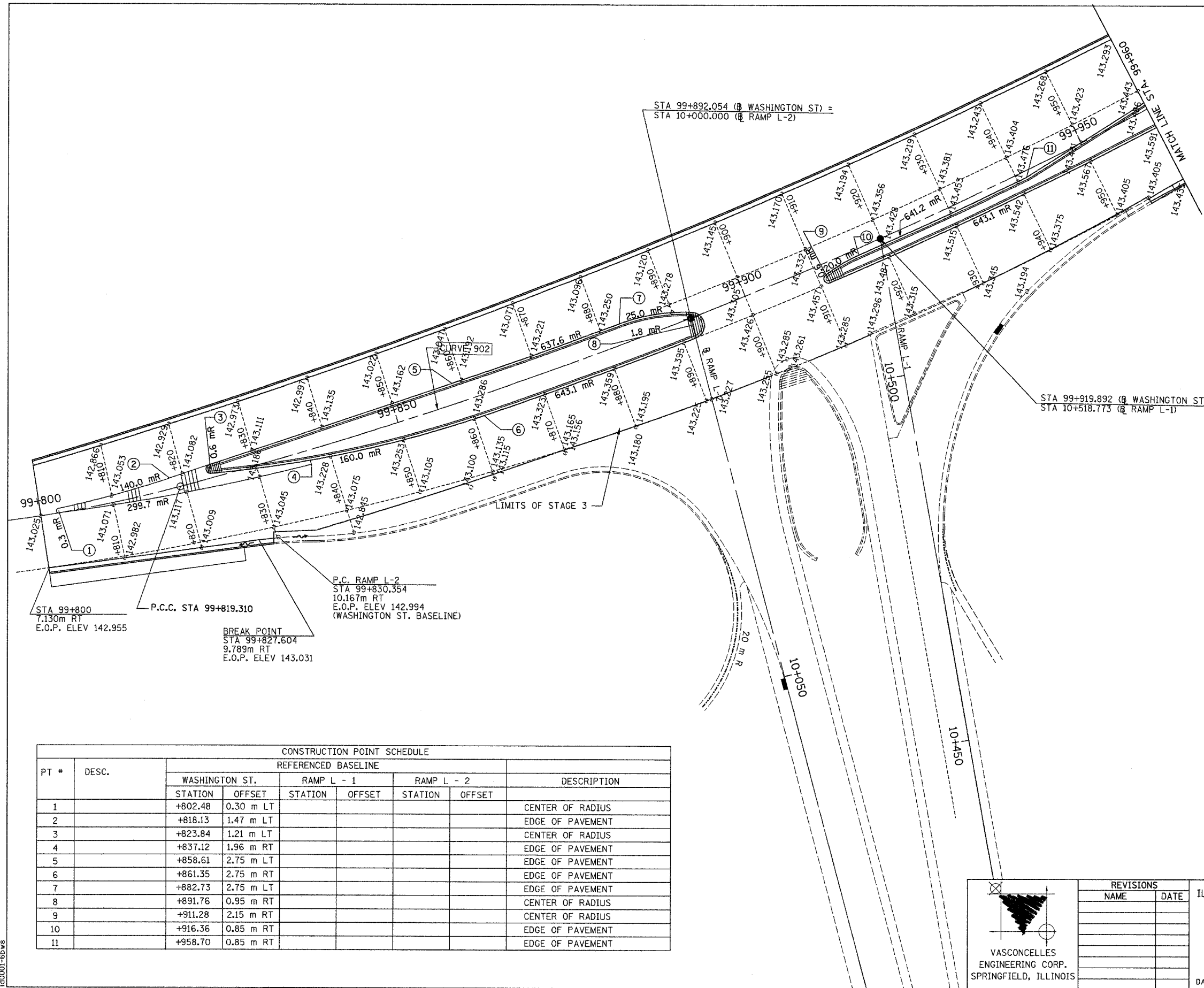
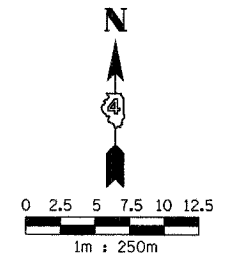

STA 99+800  
7.130m RT  
E.O.P. ELEV 142.955

P.C.C. STA 99+819.310

P.C. RAMP L-2  
STA 99+830.354  
10.167m RT  
E.O.P. ELEV 142.994  
(WASHINGTON ST. BASELINE)

BREAK POINT  
STA 99+827.604  
9.789m RT  
E.O.P. ELEV 143.031

PT #	DESC.	CONSTRUCTION POINT SCHEDULE						DESCRIPTION
		REFERENCED BASELINE						
		WASHINGTON ST.		RAMP L - 1		RAMP L - 2		
STATION	OFFSET	STATION	OFFSET	STATION	OFFSET			
1		+802.48	0.30 m LT					CENTER OF RADIUS
2		+818.13	1.47 m LT					EDGE OF PAVEMENT
3		+823.84	1.21 m LT					CENTER OF RADIUS
4		+837.12	1.96 m RT					EDGE OF PAVEMENT
5		+858.61	2.75 m LT					EDGE OF PAVEMENT
6		+861.35	2.75 m RT					EDGE OF PAVEMENT
7		+882.73	2.75 m LT					EDGE OF PAVEMENT
8		+891.76	0.95 m RT					CENTER OF RADIUS
9		+911.28	2.15 m RT					CENTER OF RADIUS
10		+916.36	0.85 m RT					EDGE OF PAVEMENT
11		+958.70	0.85 m RT					EDGE OF PAVEMENT

VASCONCELLES  
 ENGINEERING CORP.  
 SPRINGFIELD, ILLINOIS

REVISIONS	
NAME	DATE

ILLINOIS DEPARTMENT OF TRANSPORTATION

INTERSECTION DETAIL  
 RAMP L-1 AND L-2  
 WASHINGTON STREET  
 STA. 99+800 TO STA. 99+960

DRAWN BY  
 CHECKED BY  
 DATE

CONTRACT 11: PLAN SET 2 OF 3 PRE-FINAL 02/02/04 VEC 30 OF 53 JOB NO. 751-001 VASCONCELLES ENGINEERING CORP. DESIGN FIRM REGISTRATION NUMBER 184-002107

1d0001-6bws