

F.A.I. RTE.	SECTION	COUNTY	TOTAL SHEETS NO.	SHEET NO.
74*	**	TAZEWELL	1366	1037
STA. 99+800		TO STA. 99+960		
FED. ROAD DIST. NO.		ILLINOIS FED. AID PROJECT		
*WASHINGTON STREET **90-11R-2;9013,14,14-1R-1				

**PAVEMENT MARKING LEGEND**

- (1X) 100 (4) SOLID
- (2X) 150 (6) SOLID
- (3X) 200 (8) SOLID
- (4X) 300 (12) SOLID
- (5X) 600 (24) SOLID
- (6X) 100 (4) DOUBLE SOLID
- (7X) 100 (4) SKIP DASH
- (8X) 150 (6) SKIP DASH
- (9X) 200 (8) SKIP DASH
- (10X) 200 (8) DOTTED
- (11X) LETTERS AND ARROWS

**RAISED REFLECTIVE PAVEMENT MARKERS**

- 1 < ONE-WAY CRYSTAL MARKER AT 24.38 m(80') CENTERS
- 2 < ONE-WAY CRYSTAL MARKER AT 12.19 m(40') CENTERS
- 3 < ONE-WAY CRYSTAL MARKER AT 6.10 m(20') CENTERS
- 4 < ONE-WAY AMBER MARKER AT 12.19 m(40') CENTERS
- 5 < ONE-WAY AMBER MARKER AT 12.19 m(40') CENTERS FOR SPEEDS LESS THAN 45 MPH
- 6 < TWO-WAY AMBER MARKER AT 24.38 m(80') CENTERS FOR SPEEDS GREATER THAN 45 MPH

WHERE "X" DESIGNATES:

- E = EPOXY
- P = PAINT
- T = THERMOPLASTIC
- TP= TEMPORARY PAVEMENT MARKING TAPE
- T3= PAVEMENT MARKING TAPE, TYPE III

— WHITE  
— YELLOW

All dimensions are in millimeters (inches) unless otherwise shown.

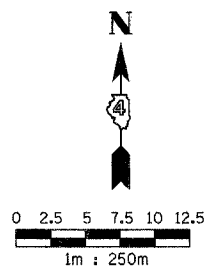
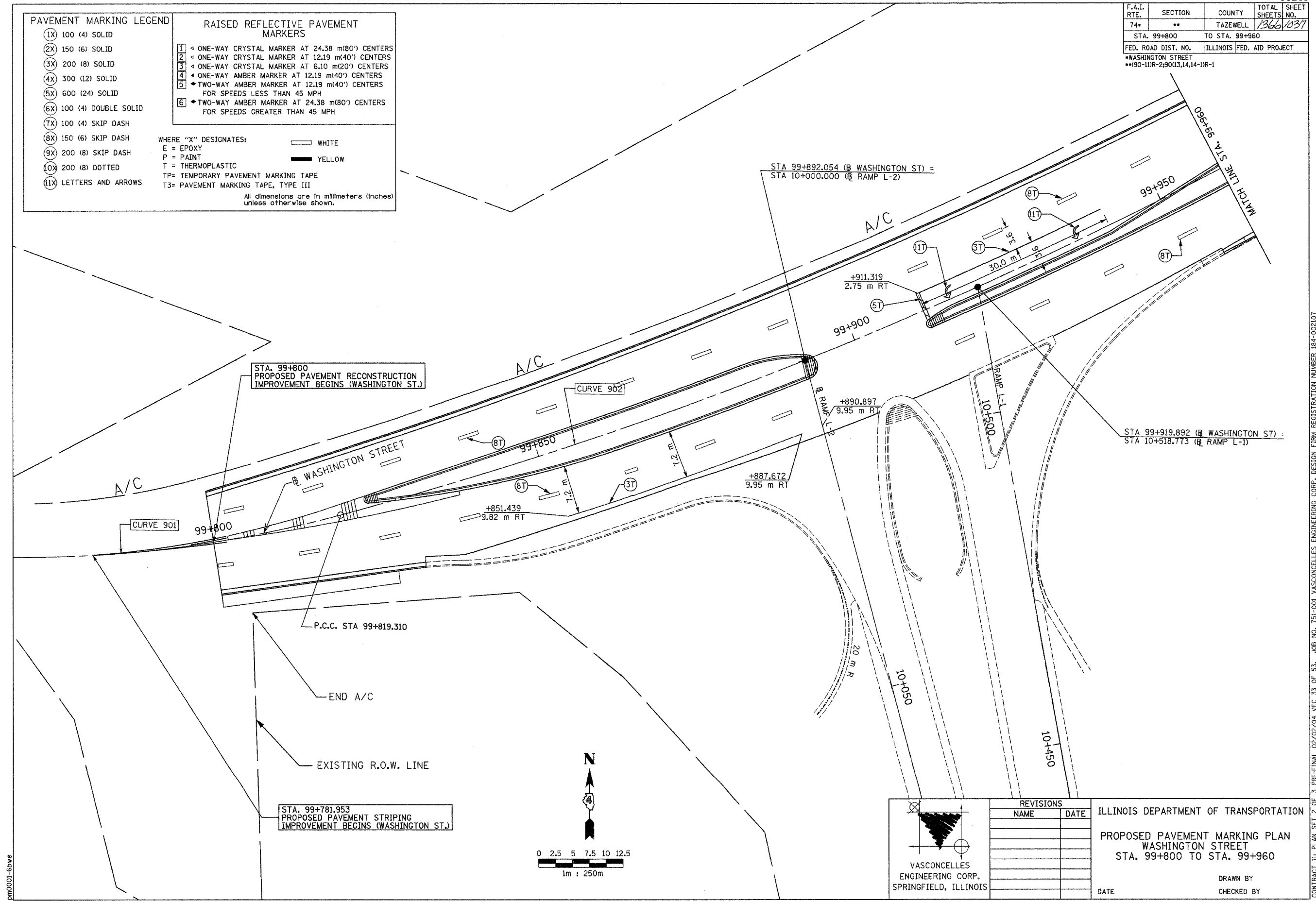

VASCONCELLES  
ENGINEERING CORP.  
SPRINGFIELD, ILLINOIS

REVISIONS	
NAME	DATE

ILLINOIS DEPARTMENT OF TRANSPORTATION  
PROPOSED PAVEMENT MARKING PLAN  
WASHINGTON STREET  
STA. 99+800 TO STA. 99+960

DATE \_\_\_\_\_ DRAWN BY \_\_\_\_\_  
CHECKED BY \_\_\_\_\_

CONTRACT II: PLAN SET 2 OF 3 PRE-FINAL 02/02/04 VEC 33 OF 53. JOB NO. 751-001 VASCONCELLES ENGINEERING CORP. DESIGN FIRM REGISTRATION NUMBER 184-002107