

F.A.I. RTE.	SECTION	COUNTY	TOTAL SHEETS	SHEET NO.
74		TAZEWELL	1366	1040
STA. 153+875		TO STA. 154+100		
FED. ROAD DIST. NO. 4		ILLINOIS FED. AID PROJECT		

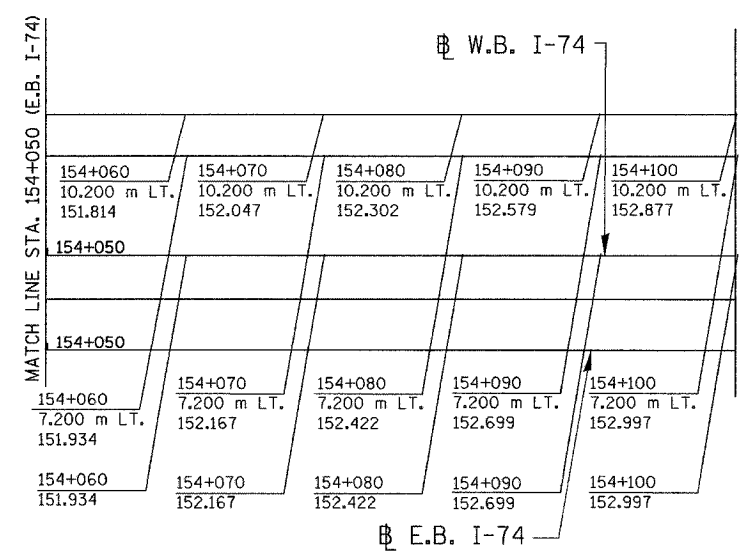
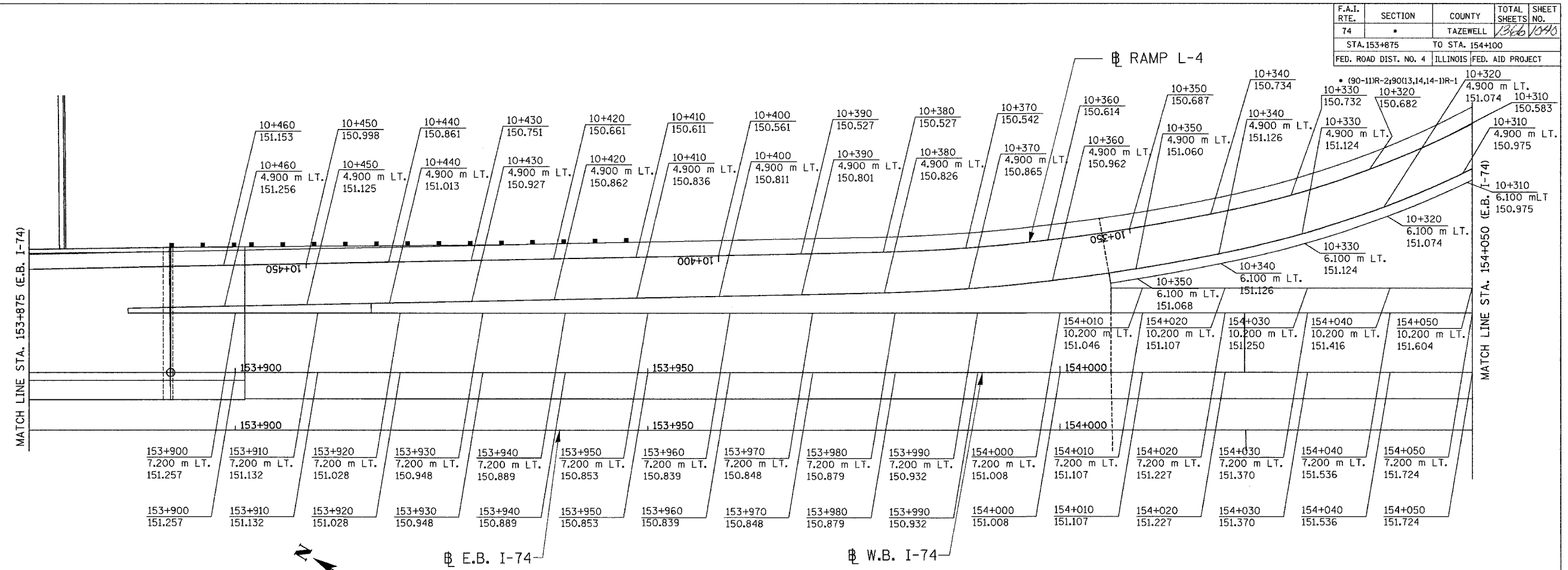

01/07/2005 01:21:59 PM
 g:\data\5589-74\dwg\contract\11\g105-6a.dwg

ALL DIMENSIONS ARE IN METERS (m) EXCEPT AS NOTED

ALL STATIONS INDICATED ARE WESTBOUND STATIONING UNLESS OTHERWISE NOTED.

DA
 DAILY & ASSOCIATES,
 ENGINEERS, INC.
 PEORIA, ILLINOIS

REVISIONS	
NAME	DATE

ILLINOIS DEPARTMENT OF TRANSPORTATION

RAMP L-4 GORE DETAILS
 F.A.I. ROUTE 74 (I-74)
 STA. 153+875 TO STA. 154+100

DATE 01/07/2005

DRAWN BY _____
 CHECKED BY _____

SHEET 1 OF 3

CONTRACT 11: PLAN SET 2 OF 4 FINAL PLANS 01/05