

F.A.I. RTE.	SECTION	COUNTY	TOTAL SHEETS	SHEET NO.
74	*	TAZEWELL	1366	151
STA.		TO STA.		
FED. ROAD DIST. NO. 4		ILLINOIS FED. AID PROJECT		
* (98-11R-2) 0+3.14, 14+1R-1				

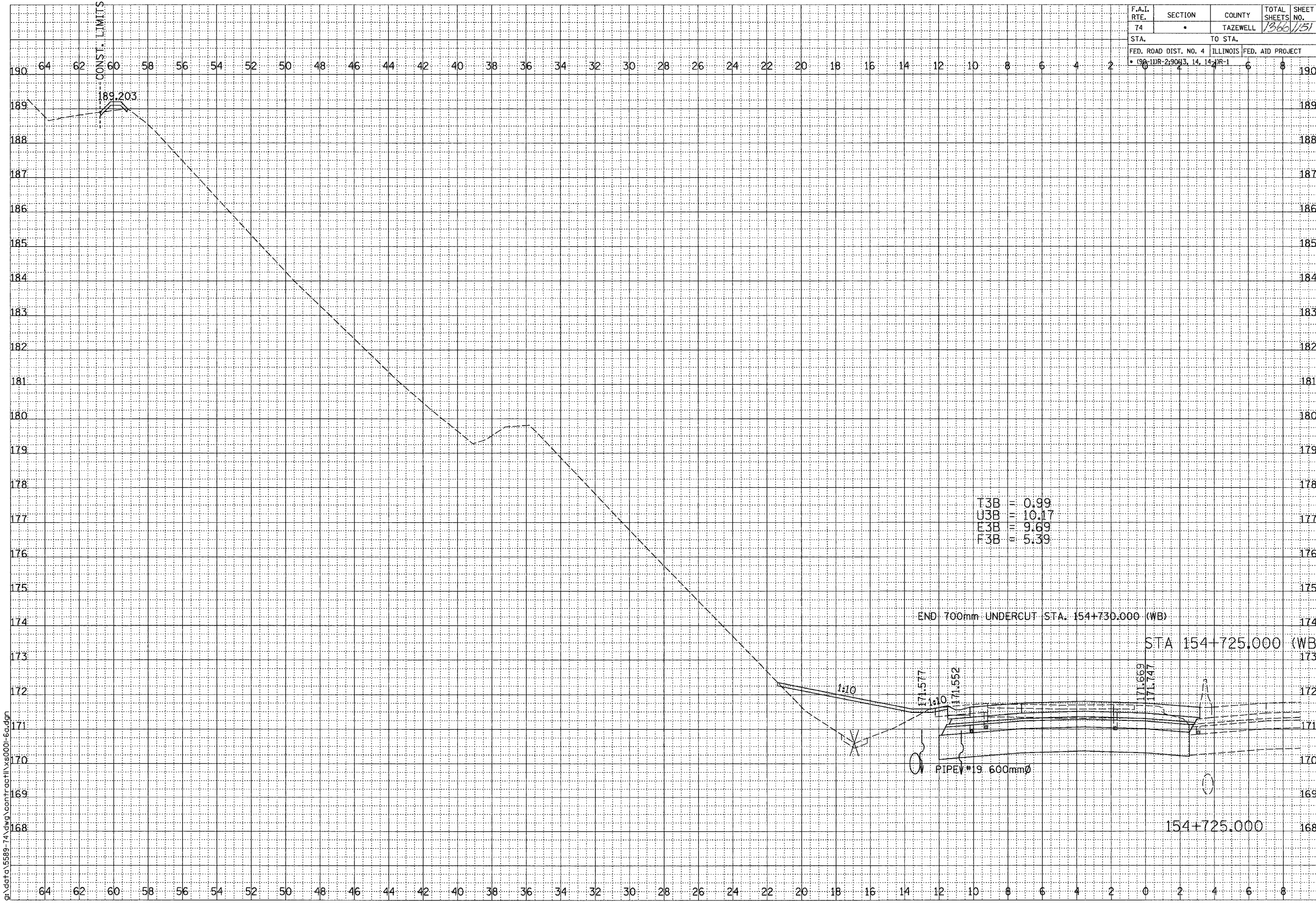

T3B	=	0.99
U3B	=	10.17
E3B	=	9.69
F3B	=	5.39

END 700mm UNDERCUT STA. 154+730.000 (WB)

STA 154+725.000 (WB)

PIPEV\*19 600mmØ

154+725.000

F.A.I. ROUTE 74 (I-74)

SHEET 57 OF 67

FINAL	BY	DATE
SURVEYED		
PLOTTED		
NOTE BOOK		
AREAS		
CHECKED		



ORIGINAL	BY	DATE
SURVEYED		
PLOTTED		
NOTE BOOK		
AREAS		
CHECKED		

SCALE  
H 1: 100  
V 1: 50

01/07/2005 09:26:32 AM  
G:\data\5589-74\dwg\cont\cost\150001-60.dwg

CONTRACT 11: PLAN SET 2 OF 3 FINAL PLANS 1/3/04