

SHEET NO: 1 OF 10  
 APPLICABLE TO: CONTRACT #68201 - PRE-STAGE 3 TO STAGE 3B  
 PURPOSE OF SHEET: THIS SHEET DEPICTS THE ADVANCED WARNING SIGNS WHICH WERE PLACED DURING CONTRACT #68195. THESE ADVANCED SIGNINGS SHALL REMAIN FROM PRE-STAGE 3 TO STAGE 3B OF CONTRACT #68201.

**NOTE:**

THE EXISTING TEMPORARY SIGNING AND STRIPING FOR THE THREE-LANE CONFIGURATION SHALL BE MAINTAINED BY CONTRACT #68201 FROM PRE-STAGE 3 TO STAGE 3B, AND SHALL BE INCLUDED WITHIN THE LUMP SUM PAY ITEM FOR TRAFFIC CONTROL AND PROTECTION (SPECIAL).

F.A. RTE.	SECTION	COUNTY	TOTAL SHEETS	SHEET NO.
		PEORIA/TAZEWELL	1366	1201
STA.	TO STA.			
FED. ROAD DIST. NO. 8	ILLINOIS FED. AID PROJECT			

CONTRACT #68201  
 MCCLUGGAGE MOT PLANS  
 PRE-STAGE 3 TO STAGE 3B  
 SHEET 1 OF 10

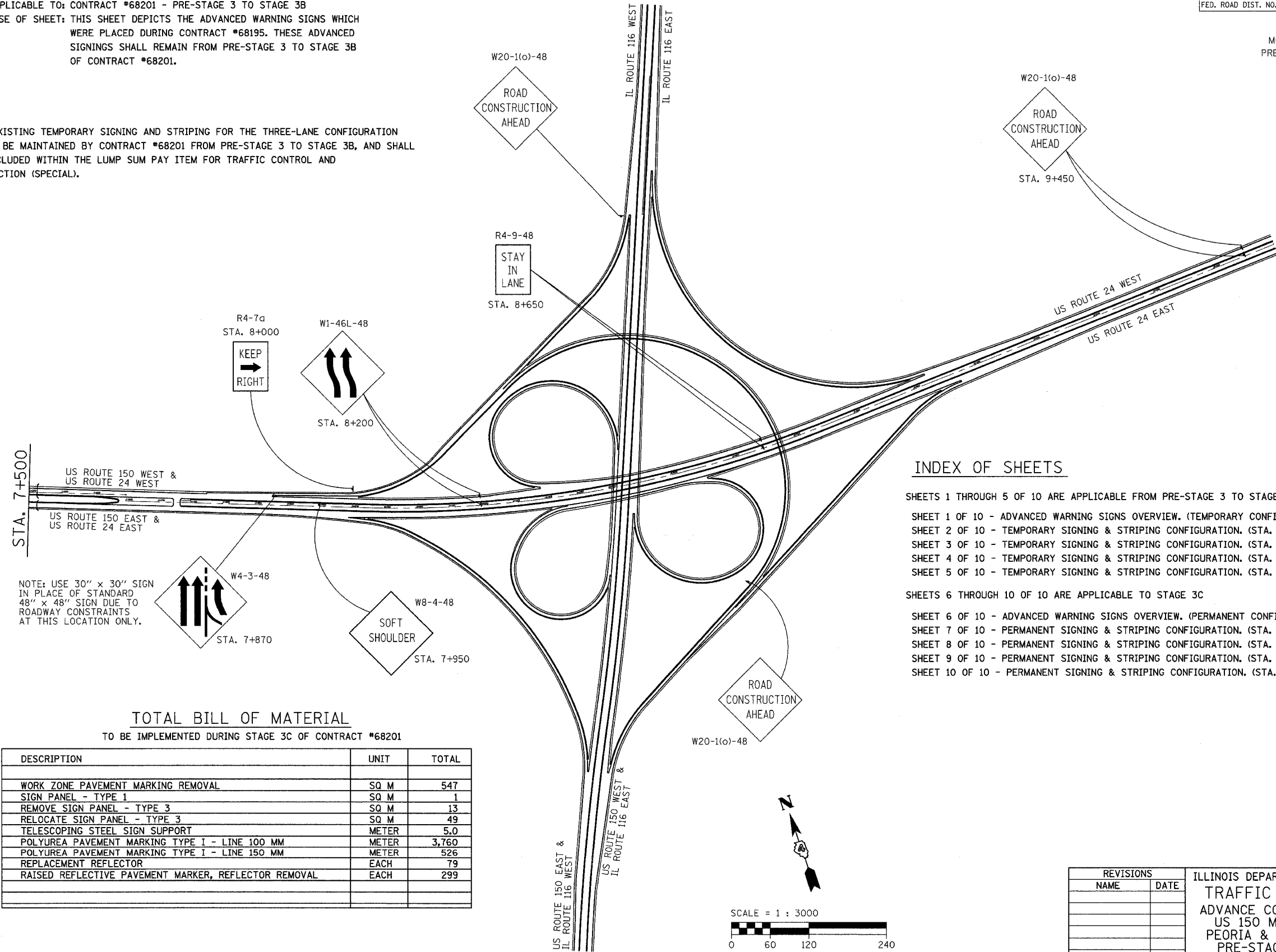

**INDEX OF SHEETS**

SHEETS 1 THROUGH 5 OF 10 ARE APPLICABLE FROM PRE-STAGE 3 TO STAGE 3B  
 SHEET 1 OF 10 - ADVANCED WARNING SIGNS OVERVIEW. (TEMPORARY CONFIGURATION).  
 SHEET 2 OF 10 - TEMPORARY SIGNING & STRIPING CONFIGURATION. (STA. 5+900 TO STA. 6+225)  
 SHEET 3 OF 10 - TEMPORARY SIGNING & STRIPING CONFIGURATION. (STA. 6+225 TO STA. 6+900)  
 SHEET 4 OF 10 - TEMPORARY SIGNING & STRIPING CONFIGURATION. (STA. 6+900 TO STA. 7+500)  
 SHEET 5 OF 10 - TEMPORARY SIGNING & STRIPING CONFIGURATION. (STA. 7+500 TO STA. 8+000)  
 SHEETS 6 THROUGH 10 OF 10 ARE APPLICABLE TO STAGE 3C  
 SHEET 6 OF 10 - ADVANCED WARNING SIGNS OVERVIEW. (PERMANENT CONFIGURATION).  
 SHEET 7 OF 10 - PERMANENT SIGNING & STRIPING CONFIGURATION. (STA. 5+900 TO STA. 6+225)  
 SHEET 8 OF 10 - PERMANENT SIGNING & STRIPING CONFIGURATION. (STA. 6+225 TO STA. 6+900)  
 SHEET 9 OF 10 - PERMANENT SIGNING & STRIPING CONFIGURATION. (STA. 6+900 TO STA. 7+500)  
 SHEET 10 OF 10 - PERMANENT SIGNING & STRIPING CONFIGURATION. (STA. 7+500 TO STA. 8+000)

**TOTAL BILL OF MATERIAL**

TO BE IMPLEMENTED DURING STAGE 3C OF CONTRACT #68201

DESCRIPTION	UNIT	TOTAL
WORK ZONE PAVEMENT MARKING REMOVAL	SQ M	547
SIGN PANEL - TYPE 1	SQ M	1
REMOVE SIGN PANEL - TYPE 3	SQ M	13
RELOCATE SIGN PANEL - TYPE 3	SQ M	49
TELESCOPING STEEL SIGN SUPPORT	METER	5.0
POLYUREA PAVEMENT MARKING TYPE I - LINE 100 MM	METER	3,760
POLYUREA PAVEMENT MARKING TYPE I - LINE 150 MM	METER	526
REPLACEMENT REFLECTOR	EACH	79
RAISED REFLECTIVE PAVEMENT MARKER, REFLECTOR REMOVAL	EACH	299

LIN ENGINEERING, LTD. CONSULTING ENGINEERS  
 210 WEST CHESTNUT, CHATHAM, IL 62629  
 PHONE: (217)-483-4168 FAX: (217)-483-4706

REVISIONS	
NAME	DATE

ILLINOIS DEPARTMENT OF TRANSPORTATION  
 TRAFFIC CONTROL PLAN  
 ADVANCE CONSTRUCTION SIGNING  
 US 150 MCCLUGGAGE BRIDGE  
 PEORIA & TAZEWELL COUNTIES  
 PRE-STAGE 3 TO STAGE 3B  
 SCALE = 1:3000 DRAWN BY: FML  
 DATE: 11/04 CHECKED BY: IYL