

| | | | | |
|-----------------------|----------|-----------------|------------------|-----------|
| F.A. RTE. | SECTION | COUNTY | TOTAL SHEETS | SHEET NO. |
| | | PEORIA/TAZEWELL | 1366 | 1206 |
| STA. | TO STA. | | | |
| FED. ROAD DIST. NO. 8 | ILLINOIS | | FED. AID PROJECT | |

SHEET NO: 6 OF 10
 APPLICABLE TO: CONTRACT #68201 - STAGE 3C
 PURPOSE OF SHEET: THIS SHEET DEPICTS THE ADVANCED WARNING SIGNS WHICH WERE PLACED DURING CONTRACT #68195. DURING STAGE 3C OF CONTRACT #68201, THESE ADVANCED WARNING SIGNS ARE SCHEDULED FOR REMOVAL.

CONTRACT #68201
 MCCLUGGAGE MOT PLANS
 STAGE 3C
 SHEET 6 OF 10

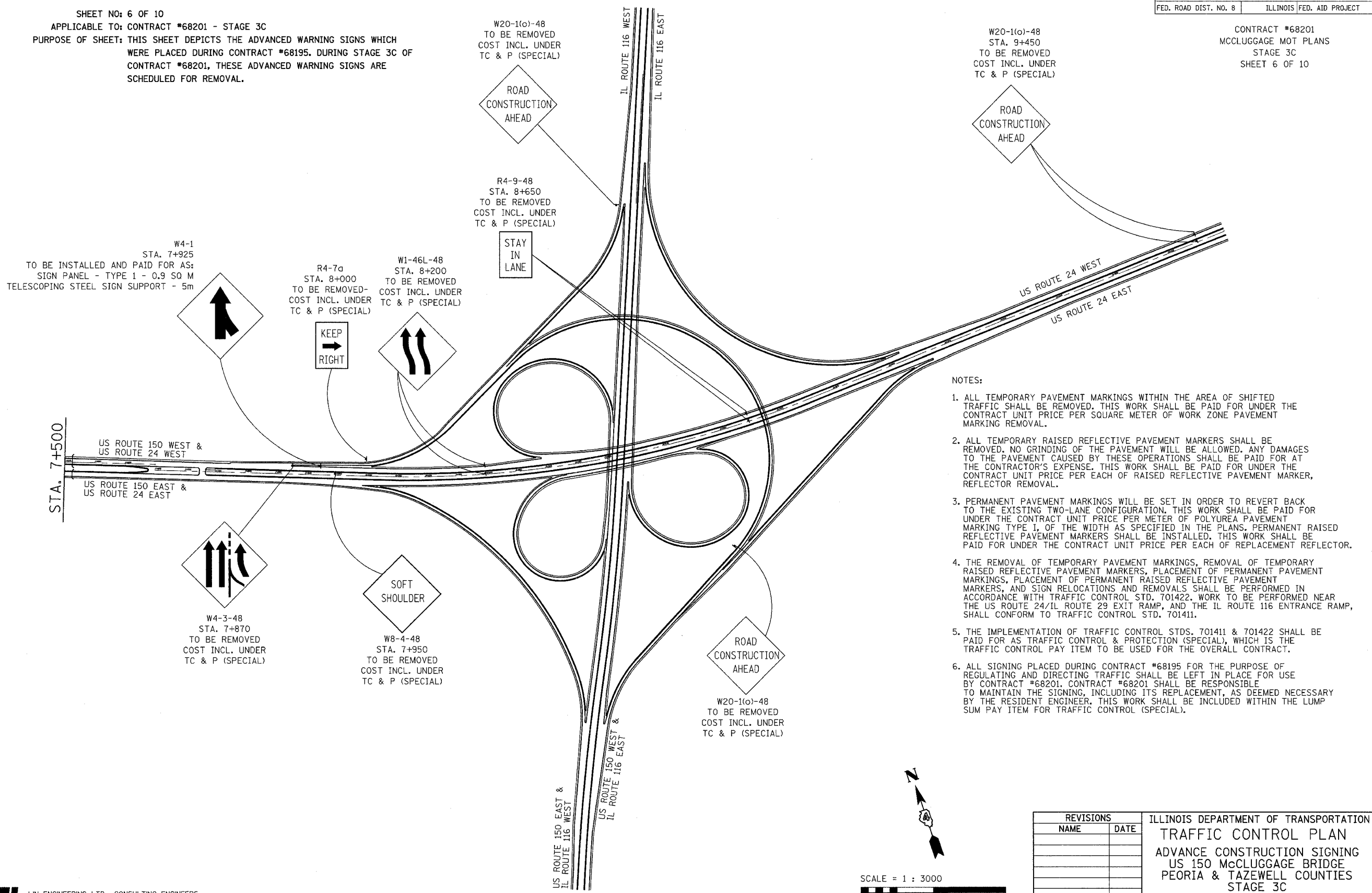

- NOTES:
1. ALL TEMPORARY PAVEMENT MARKINGS WITHIN THE AREA OF SHIFTED TRAFFIC SHALL BE REMOVED. THIS WORK SHALL BE PAID FOR UNDER THE CONTRACT UNIT PRICE PER SQUARE METER OF WORK ZONE PAVEMENT MARKING REMOVAL.
 2. ALL TEMPORARY RAISED REFLECTIVE PAVEMENT MARKERS SHALL BE REMOVED. NO GRINDING OF THE PAVEMENT WILL BE ALLOWED. ANY DAMAGES TO THE PAVEMENT CAUSED BY THESE OPERATIONS SHALL BE PAID FOR AT THE CONTRACTOR'S EXPENSE. THIS WORK SHALL BE PAID FOR UNDER THE CONTRACT UNIT PRICE PER EACH OF RAISED REFLECTIVE PAVEMENT MARKER, REFLECTOR REMOVAL.
 3. PERMANENT PAVEMENT MARKINGS WILL BE SET IN ORDER TO REVERT BACK TO THE EXISTING TWO-LANE CONFIGURATION. THIS WORK SHALL BE PAID FOR UNDER THE CONTRACT UNIT PRICE PER METER OF POLYUREA PAVEMENT MARKING TYPE I, OF THE WIDTH AS SPECIFIED IN THE PLANS. PERMANENT RAISED REFLECTIVE PAVEMENT MARKERS SHALL BE INSTALLED. THIS WORK SHALL BE PAID FOR UNDER THE CONTRACT UNIT PRICE PER EACH OF REPLACEMENT REFLECTOR.
 4. THE REMOVAL OF TEMPORARY PAVEMENT MARKINGS, REMOVAL OF TEMPORARY RAISED REFLECTIVE PAVEMENT MARKERS, PLACEMENT OF PERMANENT PAVEMENT MARKINGS, PLACEMENT OF PERMANENT RAISED REFLECTIVE PAVEMENT MARKERS, AND SIGN RELOCATIONS AND REMOVALS SHALL BE PERFORMED IN ACCORDANCE WITH TRAFFIC CONTROL STD. 701422. WORK TO BE PERFORMED NEAR THE US ROUTE 24/IL ROUTE 29 EXIT RAMP, AND THE IL ROUTE 116 ENTRANCE RAMP, SHALL CONFORM TO TRAFFIC CONTROL STD. 701411.
 5. THE IMPLEMENTATION OF TRAFFIC CONTROL STDs. 701411 & 701422 SHALL BE PAID FOR AS TRAFFIC CONTROL & PROTECTION (SPECIAL), WHICH IS THE TRAFFIC CONTROL PAY ITEM TO BE USED FOR THE OVERALL CONTRACT.
 6. ALL SIGNING PLACED DURING CONTRACT #68195 FOR THE PURPOSE OF REGULATING AND DIRECTING TRAFFIC SHALL BE LEFT IN PLACE FOR USE BY CONTRACT #68201. CONTRACT #68201 SHALL BE RESPONSIBLE TO MAINTAIN THE SIGNING, INCLUDING ITS REPLACEMENT, AS DEEMED NECESSARY BY THE RESIDENT ENGINEER. THIS WORK SHALL BE INCLUDED WITHIN THE LUMP SUM PAY ITEM FOR TRAFFIC CONTROL (SPECIAL).

LI LIN ENGINEERING, LTD. CONSULTING ENGINEERS
 210 WEST CHESTNUT, CHATHAM, IL 62629
 PHONE: (217)-483-4168 FAX: (217)-483-4706

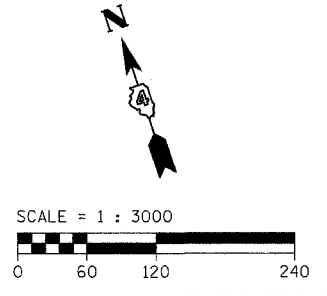

| REVISIONS | | ILLINOIS DEPARTMENT OF TRANSPORTATION TRAFFIC CONTROL PLAN ADVANCE CONSTRUCTION SIGNING US 150 MCCLUGGAGE BRIDGE PEORIA & TAZEWELL COUNTIES STAGE 3C |
|-----------|------|---|
| NAME | DATE | |
| | | |
| | | |
| | | |
| | | |
| | | |
| | | |
| | | |
| | | |
| | | |
| | | |

SCALE = 1:3000
 DATE: 11/04
 DRAWN BY: FML
 CHECKED BY: JH