

F.A.I. RTE.	SECTION	COUNTY	TOTAL SHEETS	SHEET NO.
74		TAZEWELL	1366	1219
STA. 153+800		TO STA. 154+150		
FED. ROAD DIST. NO.		ILLINOIS FED. AID PROJECT		
		• (90-11)R-2;90(13, 14, 14-1)R-1		
CONTRACT NO. 68201				

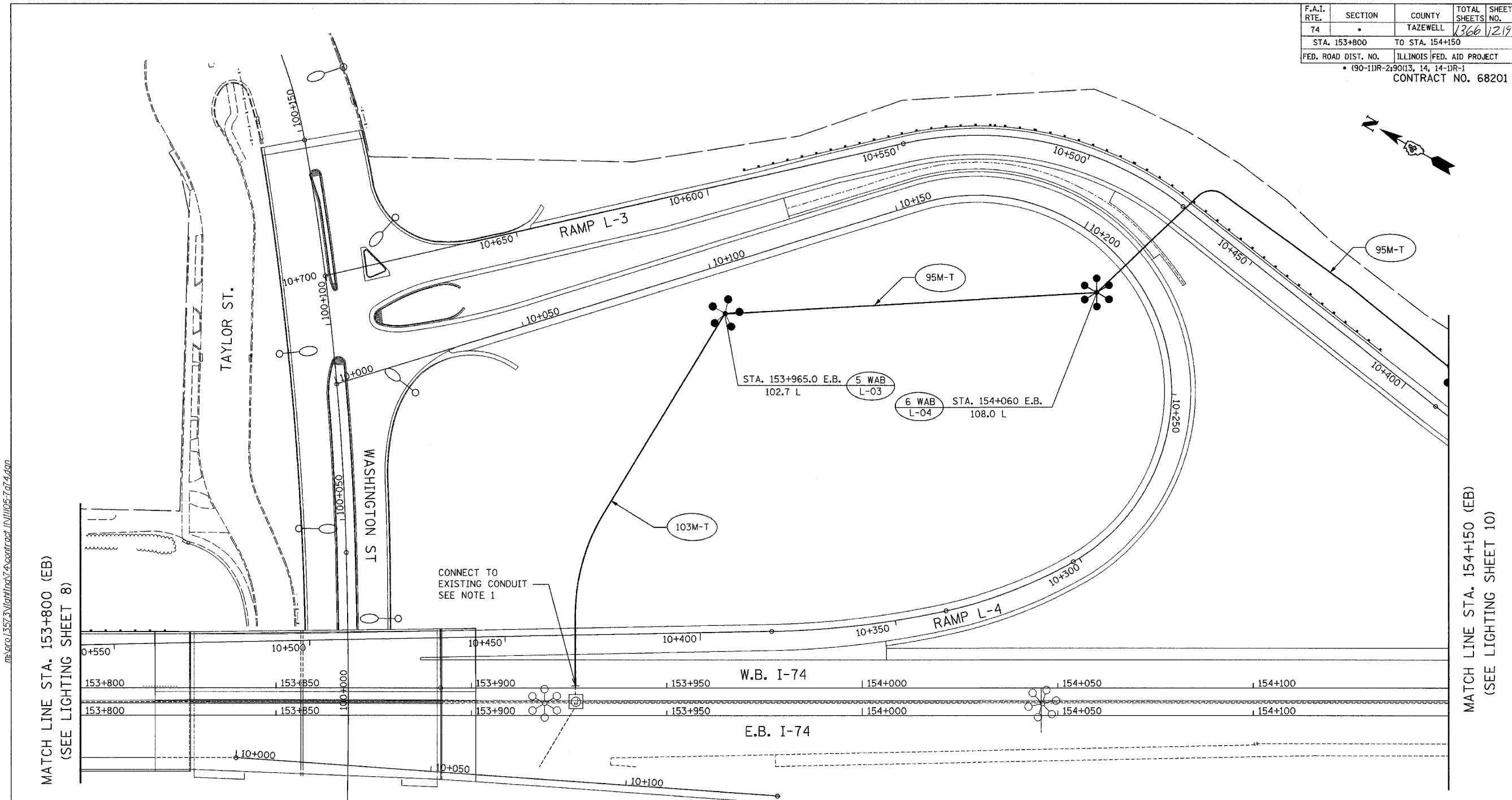

MATCH LINE STA. 153+800 (EB)
(SEE LIGHTING SHEET 8)

MATCH LINE STA. 154+150 (EB)
(SEE LIGHTING SHEET 10)

STREET LIGHTING - BILL OF MATERIAL - THIS SHEET

PAY ITEM	UNIT	QUANTITY
CONDUIT IN TRENCH, 75mm DIA., PVC	METER	293.0
TRENCH AND BACKFILL FOR ELECTRICAL WORK	METER	293.0
HIGH MAST LUMINAIRE, (INSTALL ONLY)	EACH	11
LIGHT TOWER, INSTALL ONLY	EACH	2
LIGHT TOWER FOUNDATION	METER	13.6

NOTE 1:
USE CONDUIT COUPLING TO CONNECT PROPOSED TO EXISTING CONDUIT. COST IS INCLUDED IN " CONDUIT IN TRENCH, 75MM, DIA., PVC " PAY ITEM.

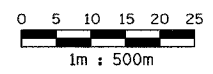

ab alfred benesch & company
CONSULTING ENGINEERS
205 NORTH MICHIGAN AVENUE, CHICAGO, ILLINOIS 60601

REVISIONS	
NAME	DATE

LIGHTING SHEET 9 OF 41
ILLINOIS DEPARTMENT OF TRANSPORTATION
PROPOSED LIGHTING PLAN
W.B. I-74
STA. 153+800 TO STA. 154+150
DRAWN BY DJK
CHECKED BY MKR
DATE: 12/20/04

12/20/2004 12:41:16 PM m:\pco\3573\lighting\4-contract\111105-7a7-4.dgn