

F.A.I. RTE.	SECTION	COUNTY	TOTAL SHEETS	SHEET NO.
74	•	TAZEWELL	1366	1231
STA.	TO STA.			
FED. ROAD DIST. NO.	ILLINOIS	FED. AID PROJECT		
• (90-11R-2)90(13, 14, 14-1R-1				
CONTRACT NO. 68201				

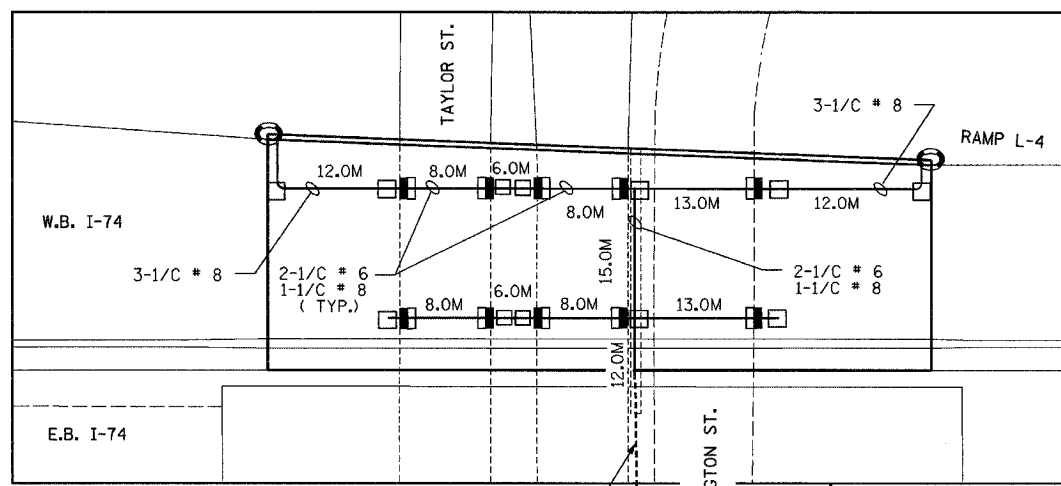

BILL OF MATERIAL-THIS SHEET

PAY ITEM	UNIT	QTY.
ELECTRIC CABLE IN CONDUIT, 600V (XLP-TYPE USE) 1/C # 8	METER	169.0
ELECTRIC CABLE IN CONDUIT, 600V (XLP-TYPE USE) 1/C # 6	METER	194.0
ELECTRIC CABLE IN CONDUIT, 600V (XLP-TYPE USE) 1/C # 4	METER	307.0
ELECTRIC CABLE IN CONDUIT, 600V (XLP-TYPE USE) 1/C # 2	METER	921.0

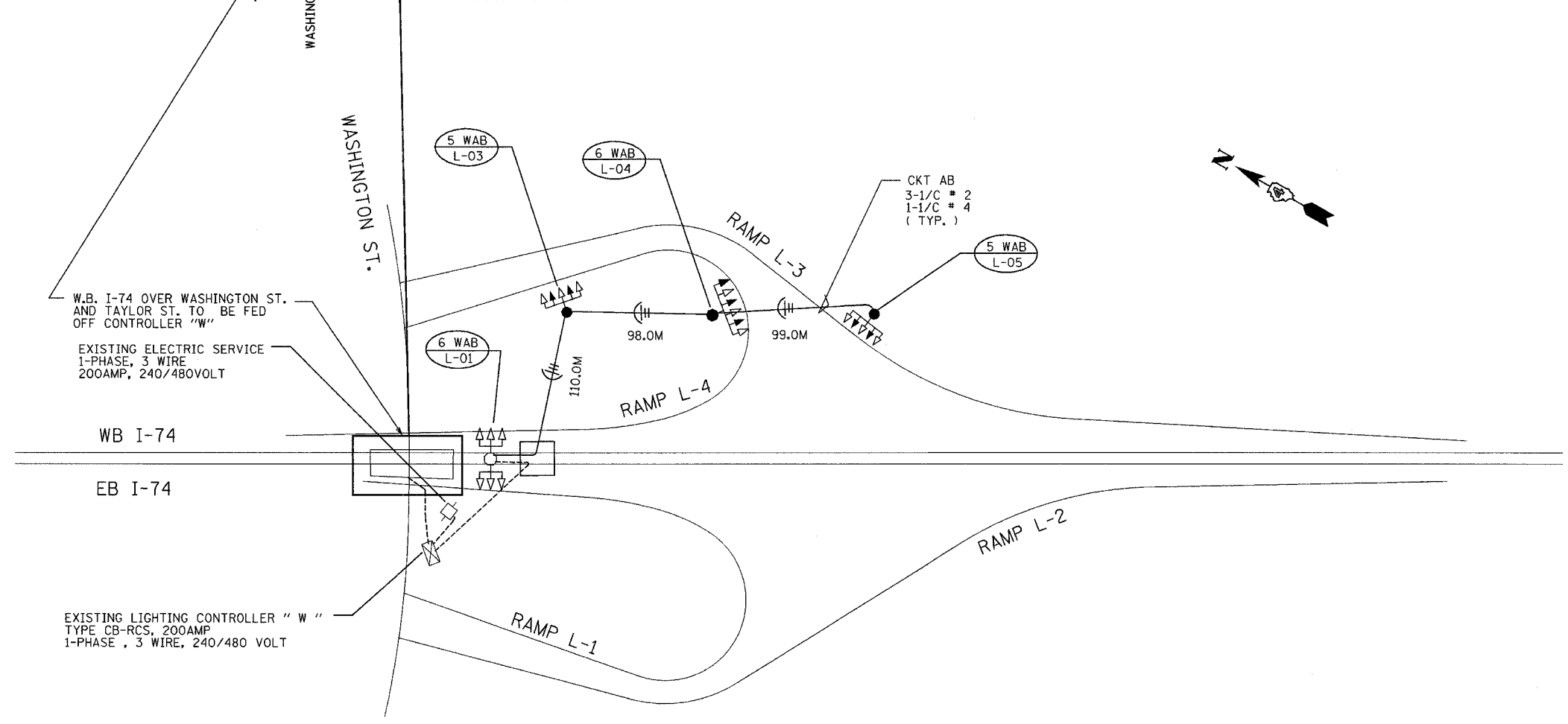

W.B. I-74 OVER WASHINGTON ST. AND TAYLOR ST. TO BE FED OFF CONTROLLER "W"

EXISTING ELECTRIC SERVICE 1-PHASE, 3 WIRE 200AMP, 240/480VOLT

EXISTING LIGHTING CONTROLLER " W " TYPE CB-RCS, 200AMP 1-PHASE , 3 WIRE, 240/480 VOLT

LIGHTING SHEET 21 OF 41

REVISIONS	
NAME	DATE

ILLINOIS DEPARTMENT OF TRANSPORTATION
 WIRING PLAN
 I-74 AND WASHINGTON STREET
 DRAWN BY DJK/MMK
 CHECKED BY MKR
 DATE: 12/20/04

ab alfred benesch & company
 CONSULTING ENGINEERS
 205 NORTH MICHIGAN AVENUE, CHICAGO, ILLINOIS 60601

12/20/2004 12:44:26 PM n:\proj\13573\lath\m\74-contract\110102-74-4wiring.dwg