

F.A. RYE.	SECTION	COUNTY	TOTAL SHEETS	SHEET NO.
.	.	**	20	3

- D-5 CONTRACT MAINT 2005-10
- MACON, MOULTRIE & PIATT CONTRACT NO. 70449

LOCATION MAP #1
IL 48, FROM CHRISTIAN CO. LINE TO
SOUTH OF U.S. 51
MACON COUNTY /RURAL 2-LANE

SECTION D-5 CONTRACT MAINT 2005-10
 ENDS @ STATION 727+61.00

BRIDGE OMISSION:
 S. N. 058+0029
 STATION 381+91.00 TO
 STATION 382+51.00

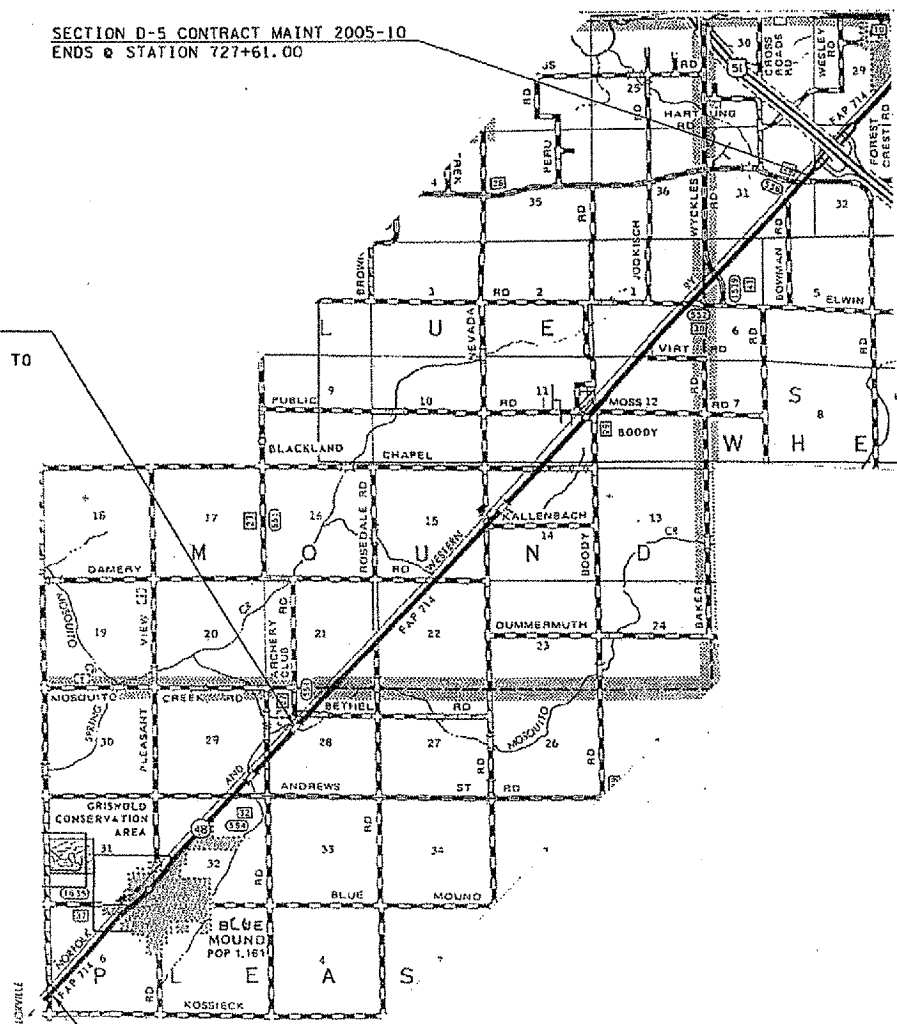

SECTION D-5 CONTRACT MAINT 2005-10
 BEGINS @ STATION 206+63.00

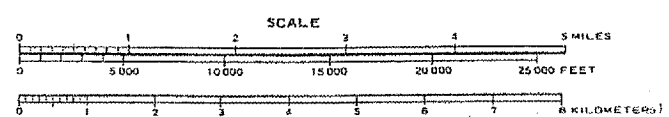

TOTAL LENGTH OF SECTION = 52,098.00 FT. = 9.867 MILES
 NET LENGTH OF SECTION = 52,038.00 FT. = 9.856 MILES

LOCATION MAP #2
IL 105, FROM MAFFET ST. TO JASPER ST.
MACON COUNTY /URBAN MULTI-LANE

SECTION D-5 CONTRACT MAINT 2005-10
 BEGINS @ STATION 130+17.00

SECTION D-5 CONTRACT MAINT 2005-10
 ENDS @ STATION 142+32.00

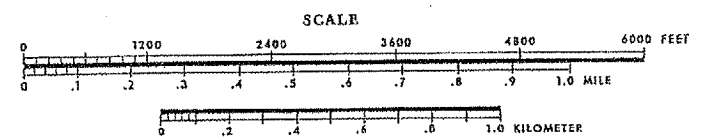
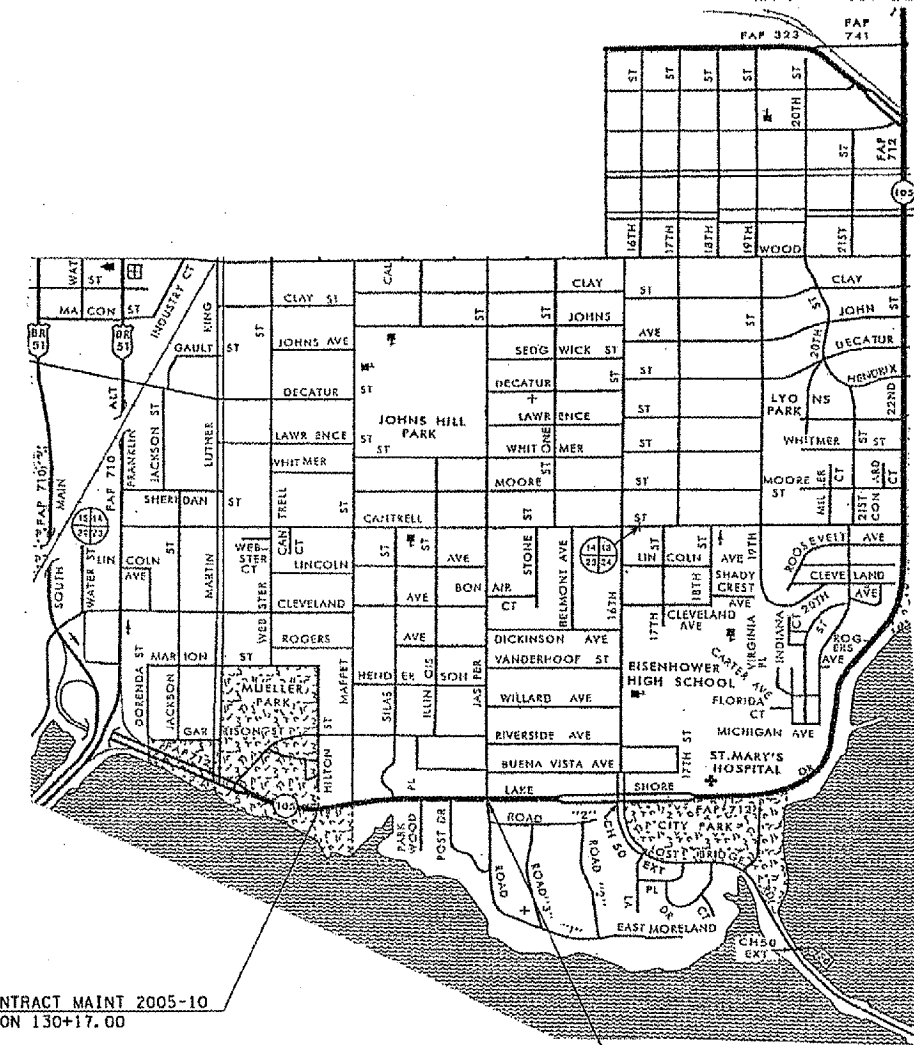

TOTAL LENGTH OF SECTION = 1,215.00 FT. = 0.230 MILES
 NET LENGTH OF SECTION = 1,215.00 FT. = 0.230 MILES