

|                          |         |          |                  |           |
|--------------------------|---------|----------|------------------|-----------|
| F.A.P. RTE.              | SECTION | COUNTY   | TOTAL SHEETS     | SHEET NO. |
| 502                      | *       | ADAMS    | 315              | 26        |
| STA.                     |         | TO STA.  |                  |           |
| FED. ROAD DIST. NO.      |         | ILLINOIS | FED. AID PROJECT |           |
| * E53RS-7, P(RS-2)JN, TS |         |          |                  |           |
| CONTRACT NO. 72897       |         |          |                  |           |

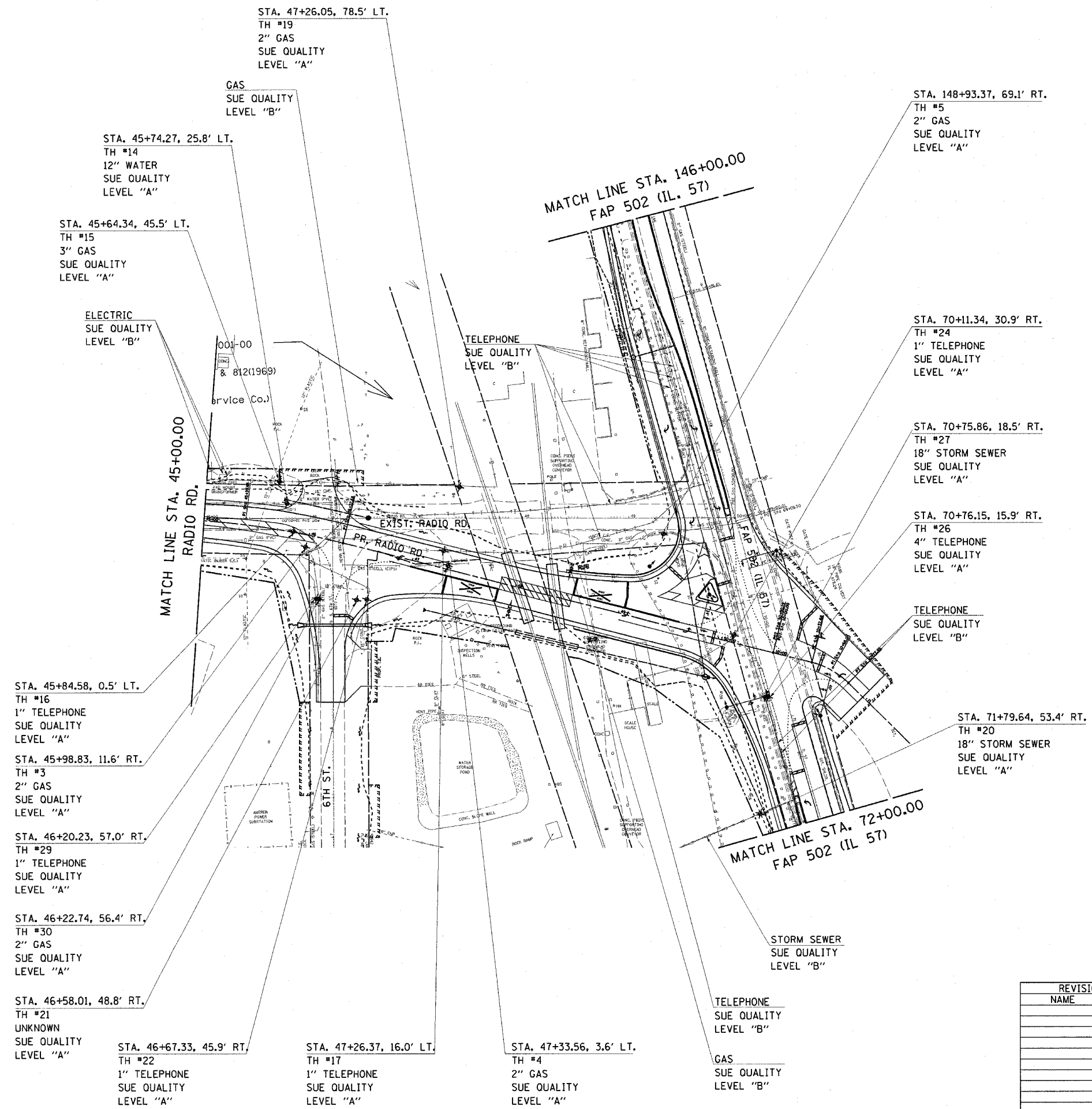
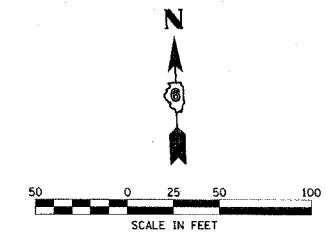

STA. 47+26.05, 78.5' LT.  
TH #19  
2" GAS  
SUE QUALITY  
LEVEL "A"

GAS  
SUE QUALITY  
LEVEL "B"

STA. 45+74.27, 25.8' LT.  
TH #14  
12" WATER  
SUE QUALITY  
LEVEL "A"

STA. 45+64.34, 45.5' LT.  
TH #15  
3" GAS  
SUE QUALITY  
LEVEL "A"

ELECTRIC  
SUE QUALITY  
LEVEL "B"

TELEPHONE  
SUE QUALITY  
LEVEL "B"

STA. 148+93.37, 69.1' RT.  
TH #5  
2" GAS  
SUE QUALITY  
LEVEL "A"

STA. 70+11.34, 30.9' RT.  
TH #24  
1" TELEPHONE  
SUE QUALITY  
LEVEL "A"

STA. 70+75.86, 18.5' RT.  
TH #27  
18" STORM SEWER  
SUE QUALITY  
LEVEL "A"

STA. 70+76.15, 15.9' RT.  
TH #26  
4" TELEPHONE  
SUE QUALITY  
LEVEL "A"

TELEPHONE  
SUE QUALITY  
LEVEL "B"

STA. 71+79.64, 53.4' RT.  
TH #20  
18" STORM SEWER  
SUE QUALITY  
LEVEL "A"

STA. 45+84.58, 0.5' LT.  
TH #16  
1" TELEPHONE  
SUE QUALITY  
LEVEL "A"

STA. 45+98.83, 11.6' RT.  
TH #3  
2" GAS  
SUE QUALITY  
LEVEL "A"

STA. 46+20.23, 57.0' RT.  
TH #29  
1" TELEPHONE  
SUE QUALITY  
LEVEL "A"

STA. 46+22.74, 56.4' RT.  
TH #30  
2" GAS  
SUE QUALITY  
LEVEL "A"

STA. 46+58.01, 48.8' RT.  
TH #21  
UNKNOWN  
SUE QUALITY  
LEVEL "A"

STA. 46+67.33, 45.9' RT.  
TH #22  
1" TELEPHONE  
SUE QUALITY  
LEVEL "A"

STA. 47+26.37, 16.0' LT.  
TH #17  
1" TELEPHONE  
SUE QUALITY  
LEVEL "A"

STA. 47+33.56, 3.6' LT.  
TH #4  
2" GAS  
SUE QUALITY  
LEVEL "A"

TELEPHONE  
SUE QUALITY  
LEVEL "B"

GAS  
SUE QUALITY  
LEVEL "B"

STORM SEWER  
SUE QUALITY  
LEVEL "B"

| REVISIONS |      |
|-----------|------|
| NAME      | DATE |
|           |      |
|           |      |
|           |      |
|           |      |
|           |      |
|           |      |

ILLINOIS DEPARTMENT OF TRANSPORTATION  
**UNDERGROUND UTILITY SURVEY**  
FAP 502 (IL 57) & RADIO ROAD  
SEC. E53RS-7, P(RS-2)JN, TS  
ADAMS COUNTY  
QUINCY, IL.  
SCALE: VERT. \_\_\_\_\_  
HORIZ. \_\_\_\_\_  
DATE 07-12-04  
DRAWN BY TMJ  
CHECKED BY MEB

\*DGN-SPEC\*  
 \*DATE-TIME\*  
 \*REF01\*