

F.A.P. RTE.	SECTION	COUNTY	TOTAL SHEETS	SHEET NO.
502		ADAMS	315	30
STA.		TO STA.		
FED. ROAD DIST. NO.		ILLINOIS FED. AID PROJECT		

• [53RS-7, PIRS-2]JN, TS
CONTRACT NO. 72897

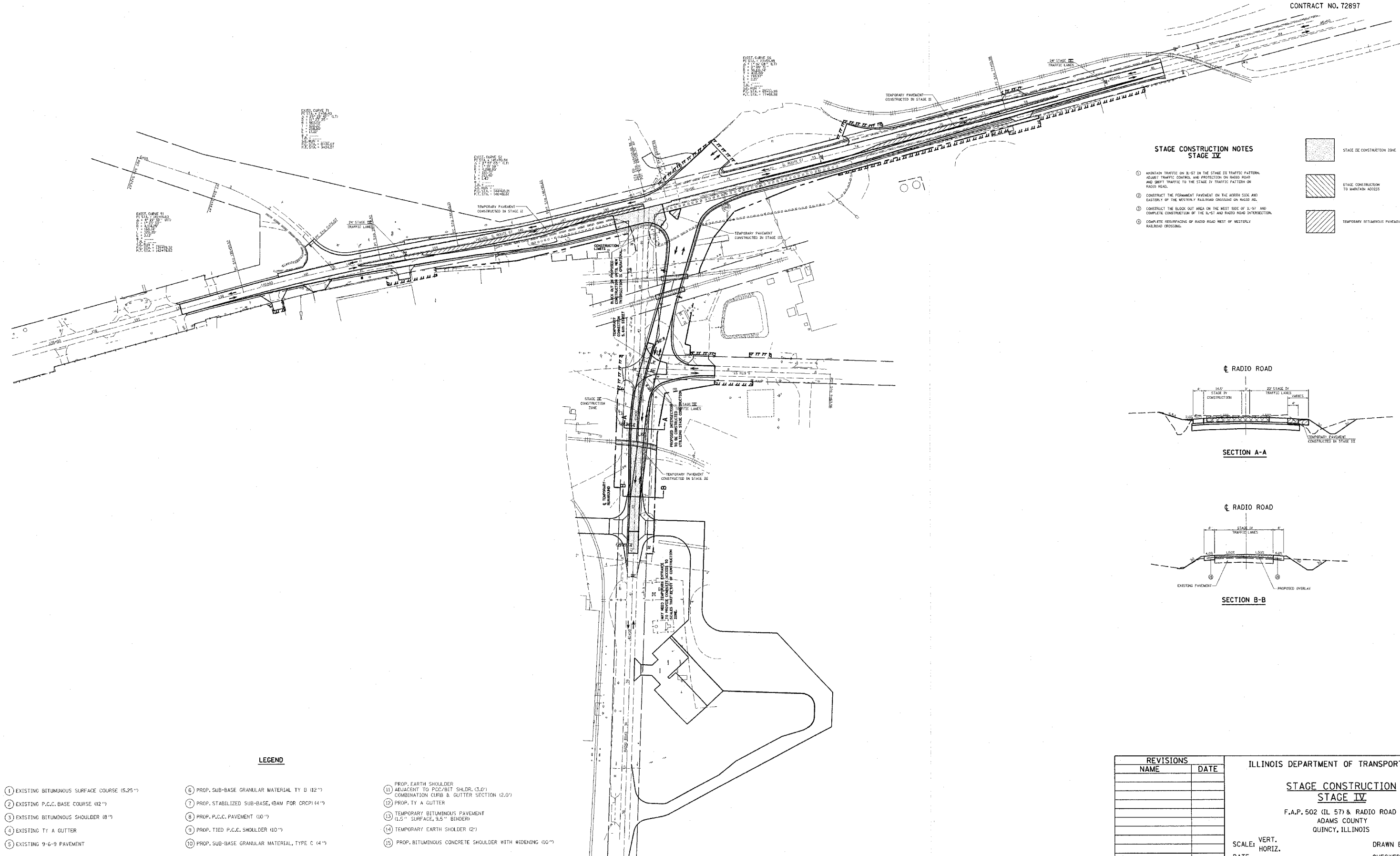

**STAGE CONSTRUCTION NOTES
STAGE IV**

- ① MAINTAIN TRAFFIC ON IL-57 ON THE STAGE III TRAFFIC PATTERN. ADJUST TRAFFIC CONTROL AND PROTECTION ON RADIO ROAD AND SHIRT TRAFFIC TO THE STAGE IV TRAFFIC PATTERN ON RADIO ROAD.
- ② CONSTRUCT THE PERMANENT PAVEMENT ON THE NORTH SIDE AND EASTERLY OF THE WESTERLY RAILROAD CROSSING ON RADIO RD.
- ③ CONSTRUCT THE BLOCK OUT AREA ON THE WEST SIDE OF IL-57 AND COMPLETE CONSTRUCTION OF THE IL-57 AND RADIO ROAD INTERSECTION.
- ④ COMPLETE RESURFACING OF RADIO ROAD WEST OF WESTERLY RAILROAD CROSSING.

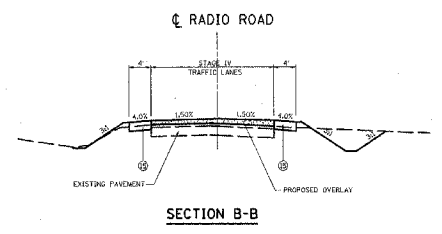
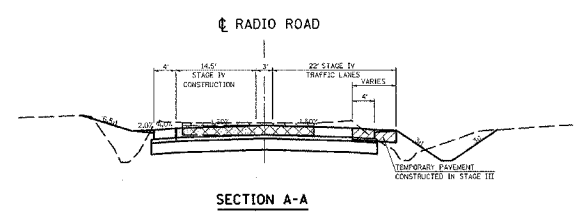
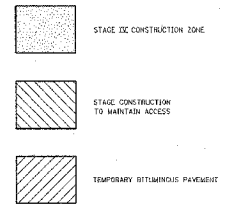

LEGEND

- | | | |
|--|--|---|
| ① EXISTING BITUMINOUS SURFACE COURSE (5.25") | ⑥ PROP. SUB-BASE GRANULAR MATERIAL TY B (12") | ⑪ PROP. EARTH SHOULDER ADJACENT TO PCC/BIT SHLDR. (3.0') COMBINATION CURB & GUTTER SECTION (2.0') |
| ② EXISTING P.C.C. BASE COURSE (12") | ⑦ PROP. STABILIZED SUB-BASE, (BAM FOR CRCP) (4") | ⑫ PROP. TY A GUTTER |
| ③ EXISTING BITUMINOUS SHOULDER (8") | ⑧ PROP. P.C.C. PAVEMENT (10") | ⑬ TEMPORARY BITUMINOUS PAVEMENT (1.5" SURFACE, 3.5" BINDER) |
| ④ EXISTING TY A GUTTER | ⑨ PROP. TIED P.C.C. SHOULDER (10") | ⑭ TEMPORARY EARTH SHOULDER (2') |
| ⑤ EXISTING 9-6-9 PAVEMENT | ⑩ PROP. SUB-BASE GRANULAR MATERIAL, TYPE C (4") | ⑮ PROP. BITUMINOUS CONCRETE SHOULDER WITH WIDENING (10") |

REVISIONS	
NAME	DATE

ILLINOIS DEPARTMENT OF TRANSPORTATION

**STAGE CONSTRUCTION
STAGE IV**

F.A.P. 502 (IL 57) & RADIO ROAD
ADAMS COUNTY
QUINCY, ILLINOIS

SCALE: VERT. _____
HORIZ. _____

DATE _____

DRAWN BY _____
CHECKED BY _____

c:\projects\d653004\woolpert_080204\radio rd stage 4.dgn
2/2/2005
*REF01