

F.A.P. RTE.	SECTION	COUNTY	TOTAL SHEETS	SHEET NO.
502	.	ADAMS	315	64
STA.		TO STA.		
FED. ROAD DIST. NO.		ILLINOIS FED. AID PROJECT		
		(53RS-7, P1RS-2)JN, TS		
		CONTRACT NO. 72897		

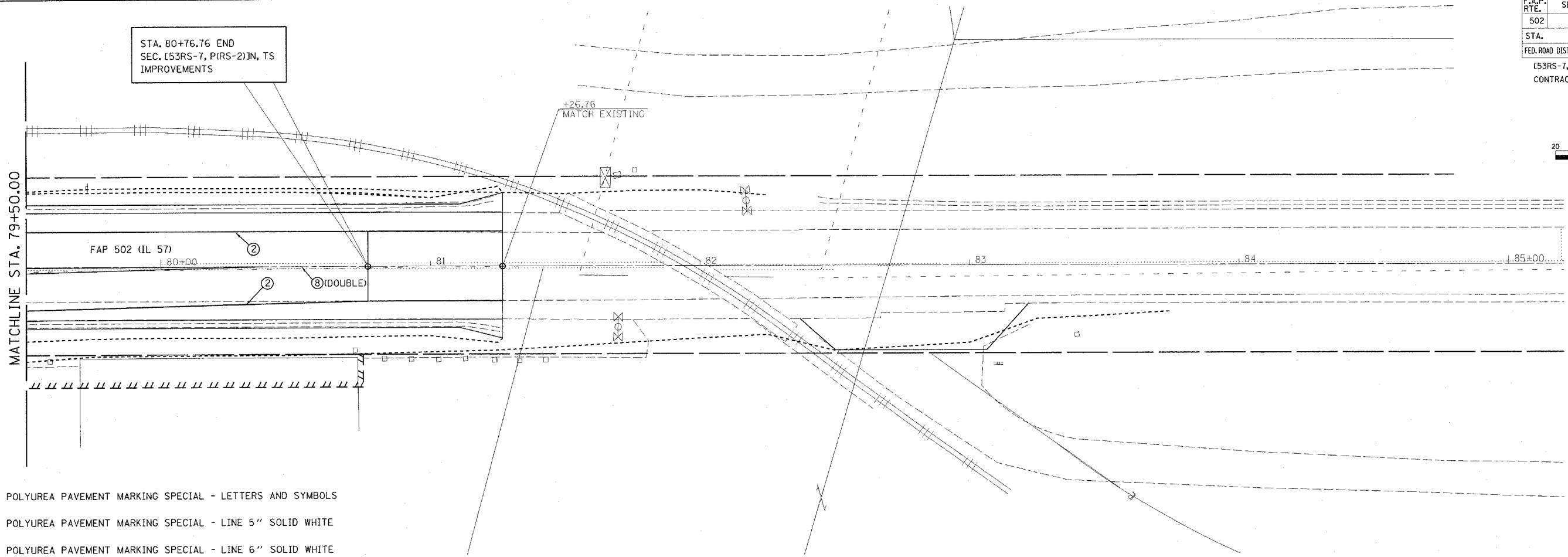

- ① POLYUREA PAVEMENT MARKING SPECIAL - LETTERS AND SYMBOLS
- ② POLYUREA PAVEMENT MARKING SPECIAL - LINE 5" SOLID WHITE
- ③ POLYUREA PAVEMENT MARKING SPECIAL - LINE 6" SOLID WHITE
- ④ POLYUREA PAVEMENT MARKING SPECIAL - LINE 8" SOLID WHITE
- ⑤ POLYUREA PAVEMENT MARKING SPECIAL - LINE 12" SOLID WHITE
- ⑥ POLYUREA PAVEMENT MARKING SPECIAL - LINE 24" SOLID WHITE
- ⑦ POLYUREA PAVEMENT MARKING SPECIAL - LINE 5" SKIP DASH YELLOW
- ⑧ POLYUREA PAVEMENT MARKING SPECIAL - LINE 5" SOLID YELLOW
- ⑨ POLYUREA PAVEMENT MARKING SPECIAL - LINE 6" SOLID YELLOW
- ⑩ POLYUREA PAVEMENT MARKING SPECIAL - LINE 8" SOLID YELLOW
- ⑪ RAISED REFLECTIVE PAVEMENT MARKERS - 1 WAY - AMBER
- ⑫ RAISED REFLECTIVE PAVEMENT MARKERS - 2 WAY - AMBER

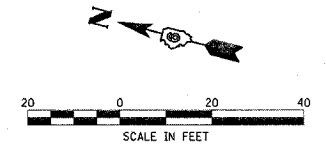
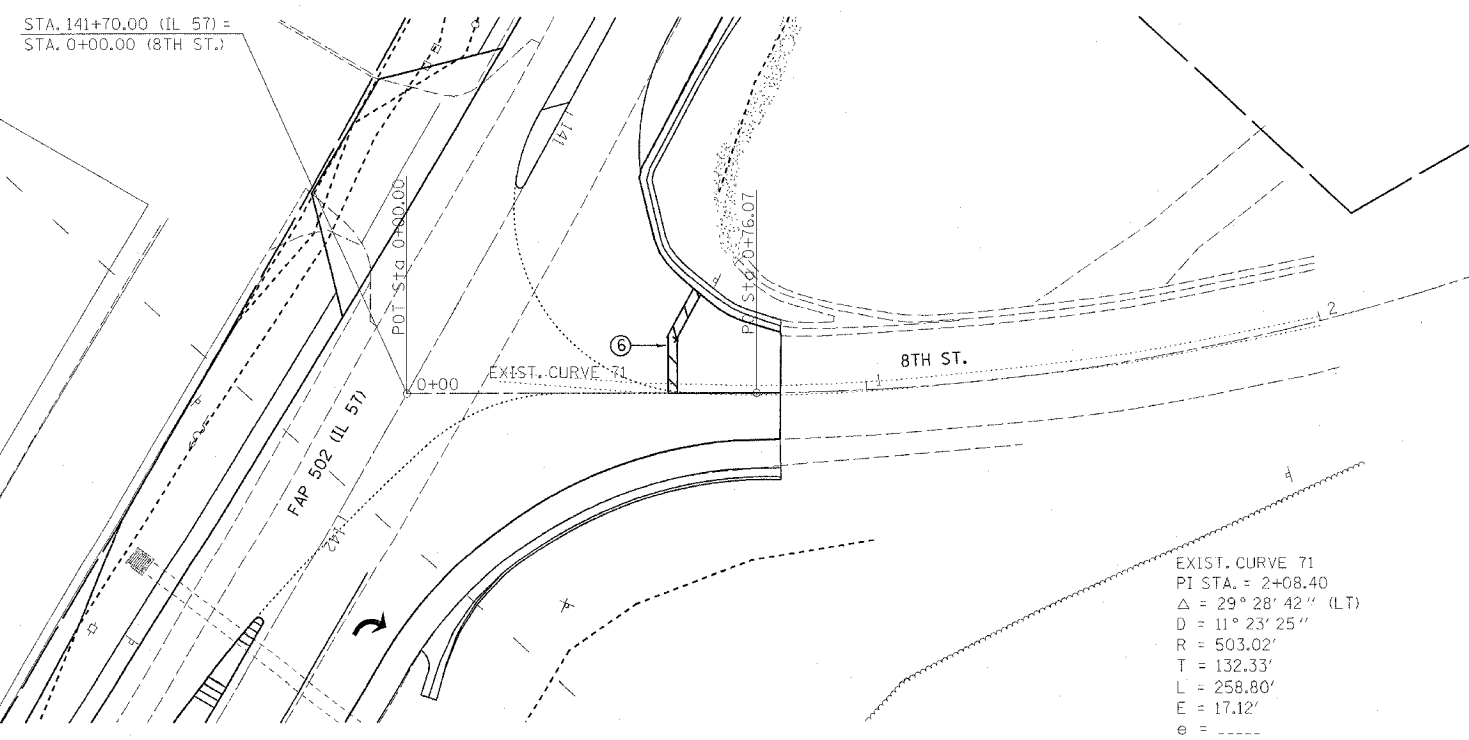

EXIST. CURVE 71
 PI STA. = 2+08.40
 $\Delta = 29^\circ 28' 42''$ (LT)
 $D = 11^\circ 23' 25''$
 $R = 503.02'$
 $T = 132.33'$
 $L = 258.80'$
 $E = 17.12'$
 $e = \dots$
 $T.R. = \dots$
 $S.E. RUN = \dots$
 P.C. STA. = 0+76.07
 P.T. STA. = 3+34.87

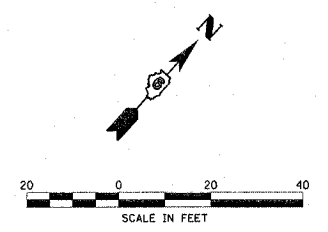

REVISIONS	
NAME	DATE

ILLINOIS DEPARTMENT OF TRANSPORTATION
PAVEMENT MARKING DETAILS
 FAP 502 (IL 57) & RADIO ROAD
 SEC. [53RS-7, P1RS-2]JN, TS
 ADAMS COUNTY
 QUINCY, IL.
 SCALE: VERT. _____
 HORIZ. _____
 DATE 08-02-04
 DRAWN BY TMJ
 CHECKED BY MEB

ct:\projects\d653004\pavem\pkm.dgn
 2/3/2005
 *REF01