

F.A.P. RTE.	SECTION	COUNTY	TOTAL SHEETS	SHEET NO.
502		ADAMS	315	65
STA.		TO STA.		
FED. ROAD DIST. NO.		ILLINOIS	FED. AID PROJECT	
* [53RS-7, P[RS-2]JN, TS				
CONTRACT NO. 72897				

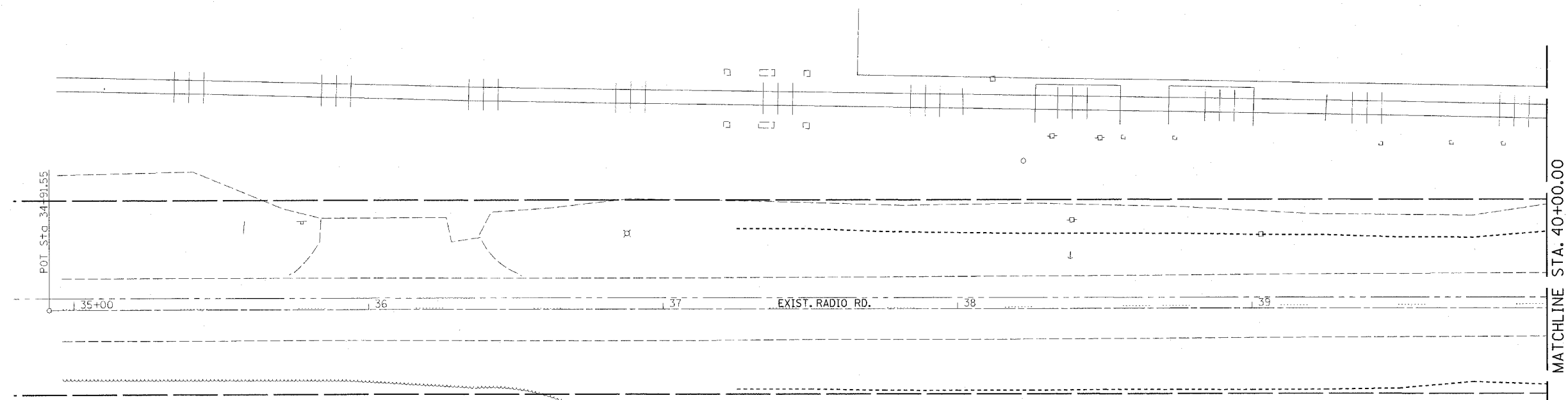

- |  |  |
|--|--|
| ① POLYUREA PAVEMENT MARKING SPECIAL - LETTERS AND SYMBOLS  | ⑦ POLYUREA PAVEMENT MARKING SPECIAL - LINE 5" SKIP DASH YELLOW |
| ② POLYUREA PAVEMENT MARKING SPECIAL - LINE 5" SOLID WHITE  | ⑧ POLYUREA PAVEMENT MARKING SPECIAL - LINE 5" SOLID YELLOW     |
| ③ POLYUREA PAVEMENT MARKING SPECIAL - LINE 6" SOLID WHITE  | ⑨ POLYUREA PAVEMENT MARKING SPECIAL - LINE 6" SOLID YELLOW     |
| ④ POLYUREA PAVEMENT MARKING SPECIAL - LINE 8" SOLID WHITE  | ⑩ POLYUREA PAVEMENT MARKING SPECIAL - LINE 8" SOLID YELLOW     |
| ⑤ POLYUREA PAVEMENT MARKING SPECIAL - LINE 12" SOLID WHITE | ⑪ RAISED REFLECTIVE PAVEMENT MARKERS - 1 WAY - AMBER           |
| ⑥ POLYUREA PAVEMENT MARKING SPECIAL - LINE 24" SOLID WHITE | ⑫ RAISED REFLECTIVE PAVEMENT MARKERS - 2 WAY - AMBER           |

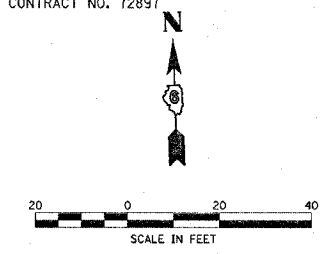
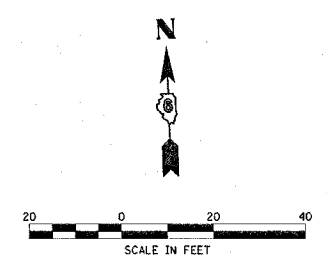
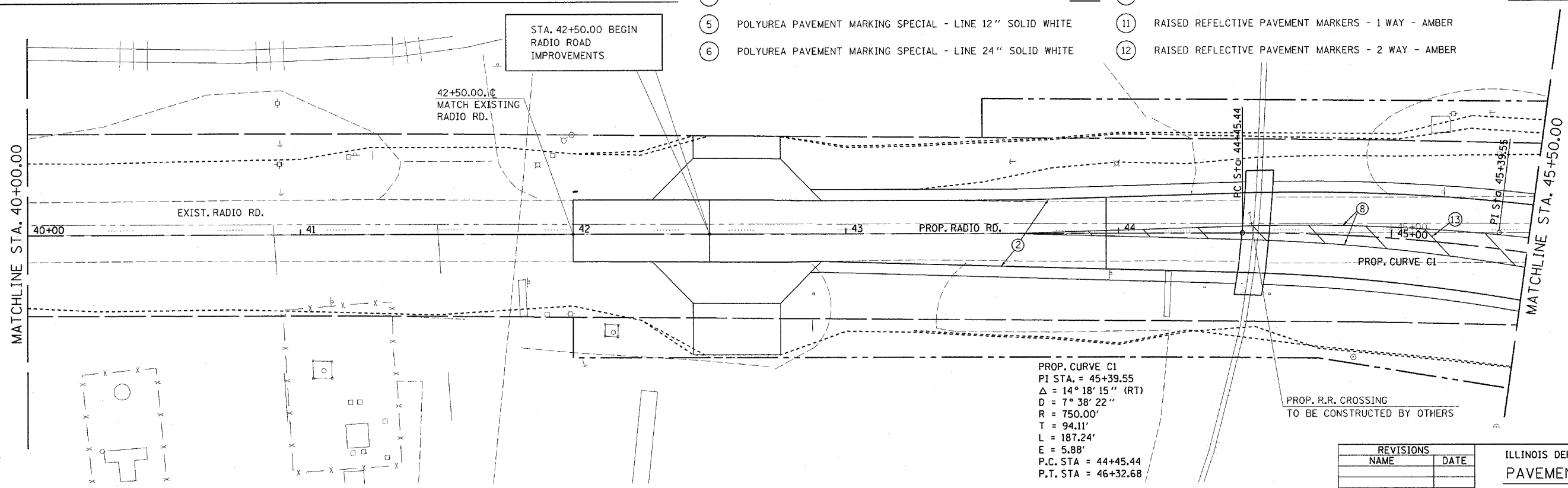

PROP. CURVE C1  
 PI STA. = 45+39.55  
 $\Delta = 14^\circ 18' 15''$  (RT)  
 $D = 7^\circ 38' 22''$   
 $R = 750.00'$   
 $T = 94.11'$   
 $L = 187.24'$   
 $E = 5.88'$   
 P.C. STA = 44+45.44  
 P.T. STA = 46+32.68

PROP. R.R. CROSSING  
 TO BE CONSTRUCTED BY OTHERS

REVISIONS	
NAME	DATE

ILLINOIS DEPARTMENT OF TRANSPORTATION  
**PAVEMENT MARKING DETAILS**  
 FAP 502 (IL 57) & RADIO ROAD  
 SEC. [53RS-7, P[RS-2]JN, TS  
 ADAMS COUNTY  
 QUINCY, IL.  
 SCALE: VERT. \_\_\_\_\_  
 HORIZ. \_\_\_\_\_  
 DATE 08-02-04  
 DRAWN BY TMJ  
 CHECKED BY MEB

ct:\projects\d653004\pavemark.dgn  
 2/3/2005  
 \*REF01