

FAU ROUTE	SECTION	COUNTY	TOTAL SHEETS	SHEET NO
9320	68WRS	MONROE	35	15
STA.		TO STA.		
CONTRACT NO.: 76792				

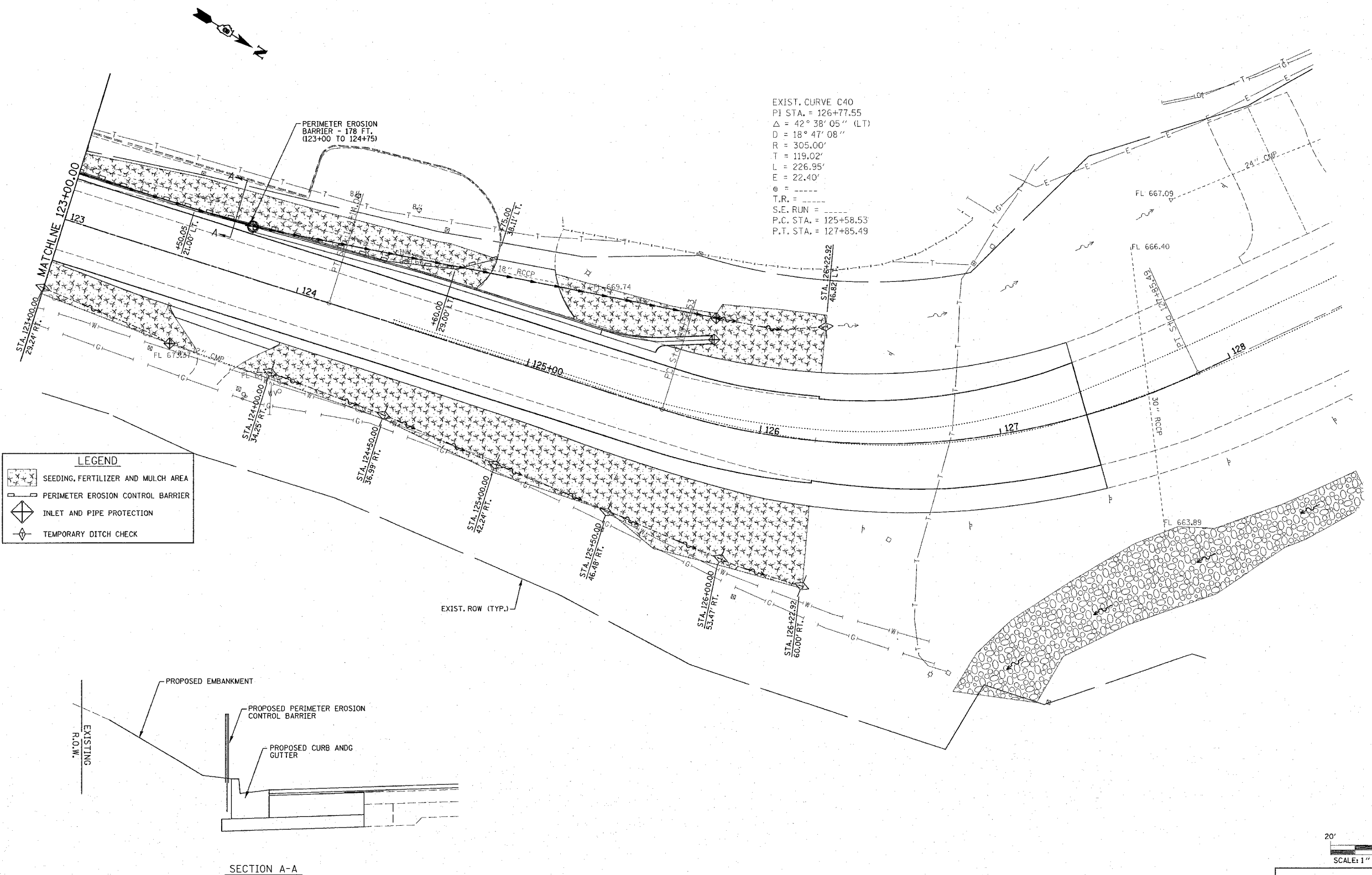

LEGEND

	SEEDING, FERTILIZER AND MULCH AREA
	PERIMETER EROSION CONTROL BARRIER
	INLET AND PIPE PROTECTION
	TEMPORARY DITCH CHECK

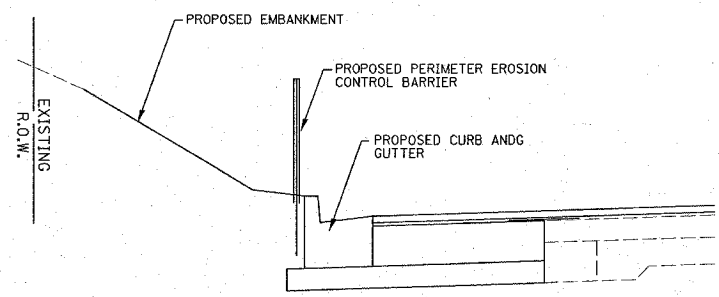

SECTION A-A

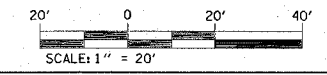

REVISIONS	
NAME	DATE

ILLINOIS DEPARTMENT OF TRANSPORTATION
EROSION AND SEDIMENT CONTROL PLAN
 FAU 9320
 SECTION 68WRS
 MONROE COUNTY
 DRAWN BY:

PLAN	DATE

2/7/2005
 Monday February 07, 2005 @ 10:52:47 AM
 C:\projects\erof\erof\11605304.dgn LV=2,7,9,20,24,29,38-39,42,46-48,50
 C:\projects\erof\erof\11605304.dgn LV=2,7,9,20,24,29,38-39,42,46-48,50