

F.A.P. ROUTE NO.	SECTION	COUNTY	TOTAL SHEETS	SHEET NO.
0607	01-00014-00-FP	WILL	85	17
STA. 29+00	TO STA. 34+00			
FED. ROAD DIST. NO.	ILLINOIS	FED AID PROJECT	CMF-0607 (070)	

CONTRACT NO. 83786

SCALE: 1" = 20'

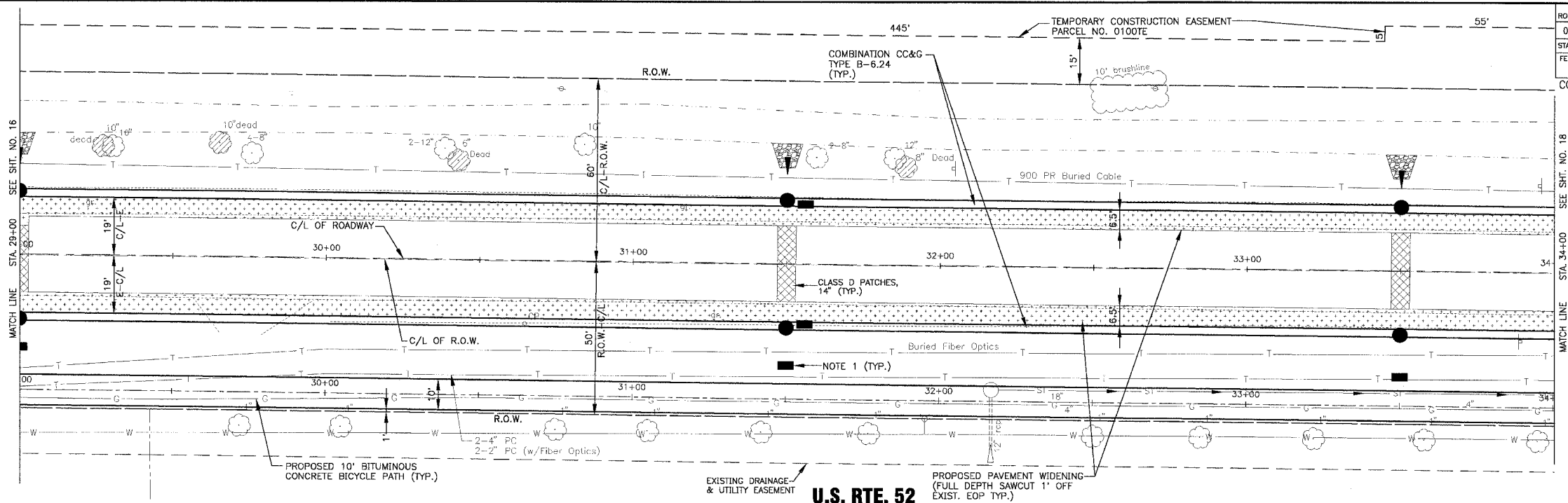

NOTE:  
1. SEE SHT. NO. 27 FOR DRAINAGE AND UTILITY INFORMATION.

**U.S. RTE. 52 ROADWAY PROFILE**

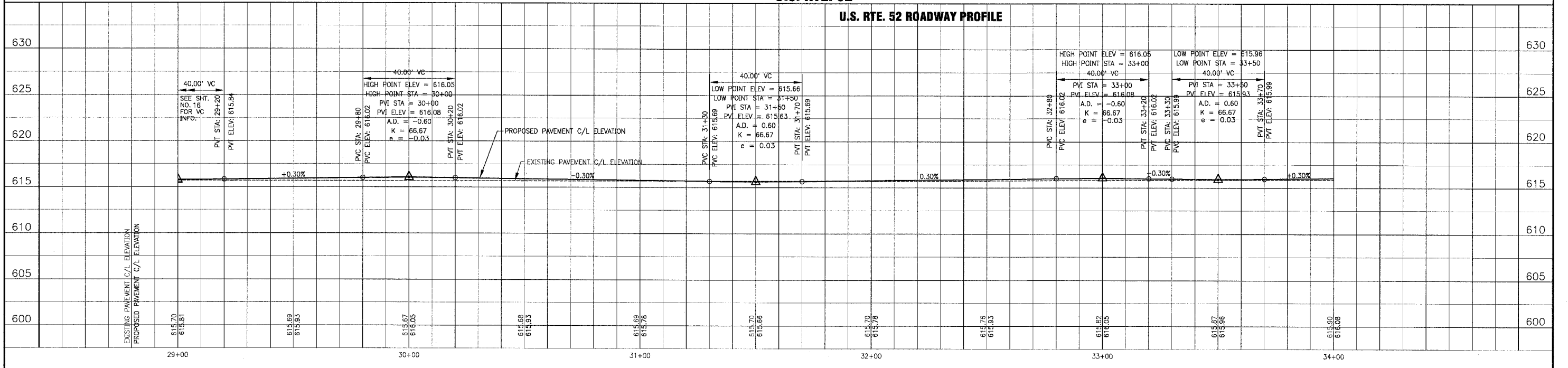

**U.S. RTE. 52 BICYCLE PATH PROFILE**

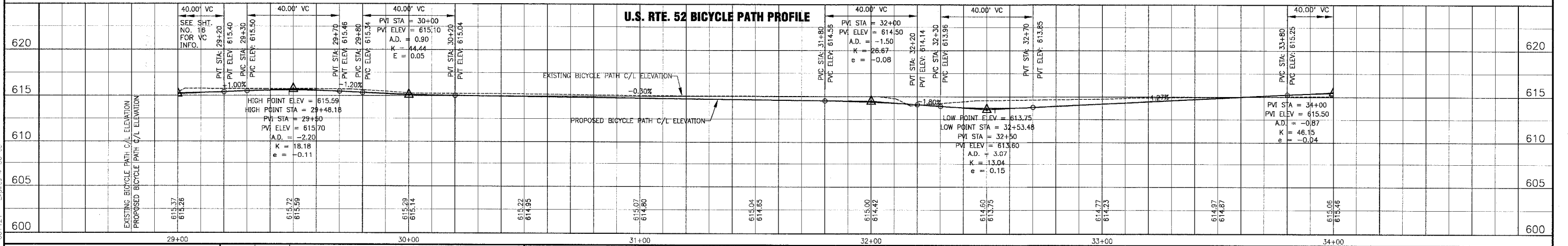

CONSULTANTS	REV. NO.	DATE	DESCRIPTION
	1	12-21-04	PER I.D.O.T. REVIEW

DRAWING FILE: \_\_\_\_\_ PLOTTED BY: \_\_\_\_\_

**BAXTER & WOODMAN**  
Consulting Engineers

**Baxter & Woodman**  
Crystal Lake, Illinois 815.459.1280  
Burlington, Wisconsin 262.763.7834  
Mokena, Illinois 708.478.2090  
DeKalb, Illinois 815.789.3111  
Grafton, Illinois 847.229.5088  
Rockford, Illinois 815.489.1551

**VILLAGE OF SHOREWOOD, ILLINOIS**  
**U.S. ROUTE 52 IMPROVEMENTS**

**U.S. ROUTE 52**  
**STA. 29+00 TO STA. 34+00**  
**GEOMETRIC PLAN**

DESIGNED BY	LDH	SCALE VERT: 1"=5'
DRAWN BY	UKB	HORIZ: 1"=20'
CHECKED BY	LDH	PROJECT NO.
DATE	10-05-04	010665
		SHEET NO.
		<b>17 OF 85</b>

\* REFER TO EQUIPMENT MANUFACTURER'S SHOP DRAWINGS