

F.A.P. ROUTE NO.	SECTION	COUNTY	TOTAL SHEETS	SHEET NO.
0607	01-00014-00-FP	WILL	85	18
STA. 34+00	TO STA. 39+50	ILLINOIS	FED AID PROJECT	CMF-0607 (070)
FED. ROAD DIST. NO.				

CONTRACT NO. 83786

SCALE: 1" = 20'

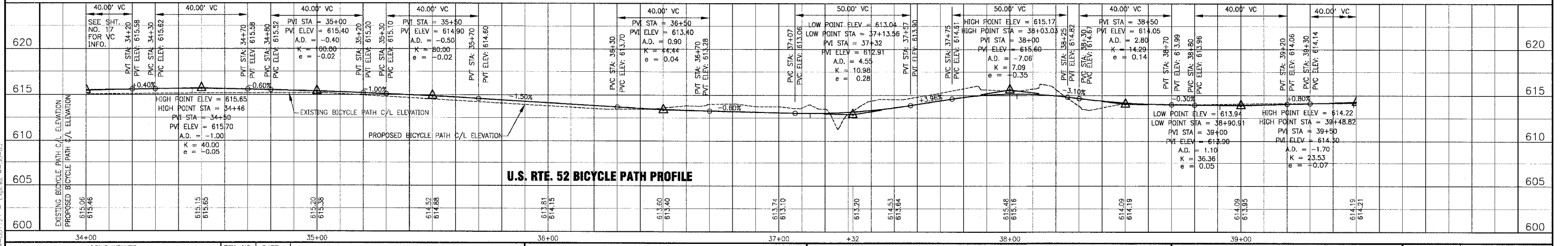
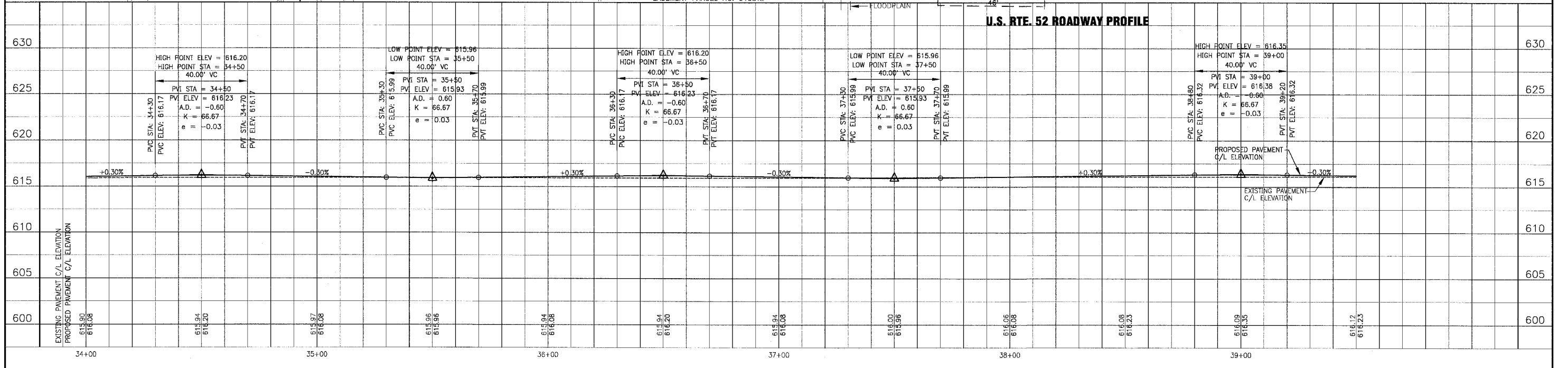
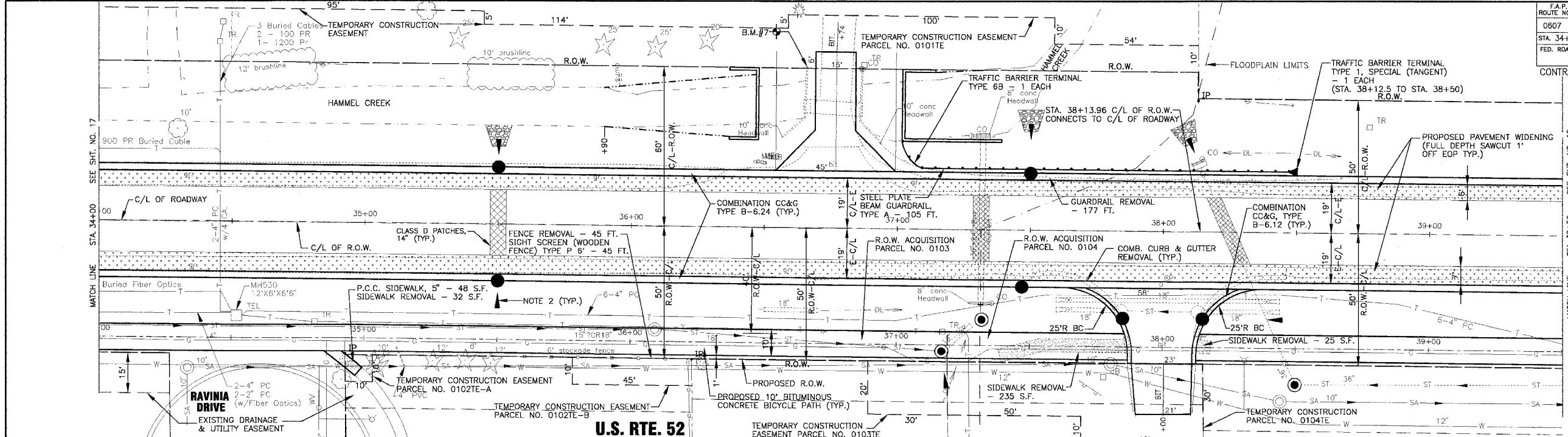

CONSULTANTS	REV. NO.	DATE	DESCRIPTION
	1	12-21-04	PER I.D.O.T. REVIEW

DRAWING FILE: _____ PLOTTED BY: _____

BAXTER & WOODMAN
 Consulting Engineers

Baxter & Woodman
 Crystal Lake, Illinois 815.459.1260
 Burlington, Wisconsin 262.763.7884
 Mokena, Illinois 708.478.2090
 DeKalb, Illinois 815.787.3111
 Crystal Lake, Illinois 847.223.5088
 Rockford, Illinois 815.488.1551

VILLAGE OF SHOREWOOD, ILLINOIS
U.S. ROUTE 52 IMPROVEMENTS

U.S. ROUTE 52
STA. 34+00 TO STA. 39+50
GEOMETRIC PLAN

DESIGNED BY	LDH	SCALE VERT: 1"=5'
DRAWN BY	UKB	HORIZ: 1"=20'
CHECKED BY	LDH	PROJECT NO.
DATE	10-05-04	010665
		SHEET NO.

1. (SHEET) 010665 (DWG) 10665-PRF-649
 Plotted: 12-20-04 @ 1:47pm By: 231ubd
 Copyright © 2004, By Baxter & Woodman, Inc.
 State of Illinois - Professional Design Firm
 License No. - 184-001121 - Expires 4-30-05

* REFER TO EQUIPMENT MANUFACTURER'S SHOP DRAWINGS