

| | | | | |
|--------------------------|----------------|--------------------------------|--------------------|-----------|
| F.A.P. ROUTE NO. | SECTION | COUNTY | TOTAL SHEETS | SHEET NO. |
| 0607 | 01-00014-00-FP | WILL | 85 | 22 |
| STA. 50+00 TO STA. 54+00 | | FED AID PROJECT CMF-0607 (070) | | |
| FED. ROAD DIST. NO. | | ILLINOIS | CONTRACT NO. 83786 | |

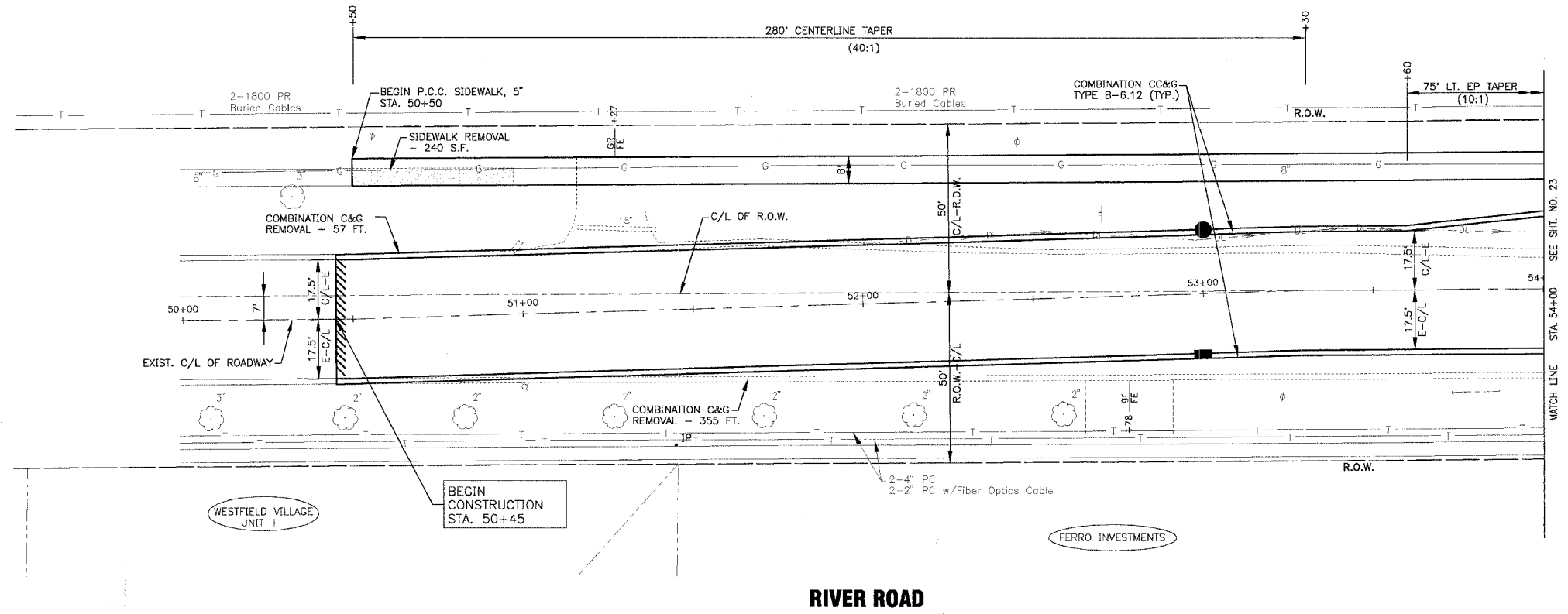

SCALE: 1" = 20'



NOTE:
1. SEE SHT. NO. 32 FOR DRAINAGE AND UTILITY INFORMATION.

RIVER ROAD

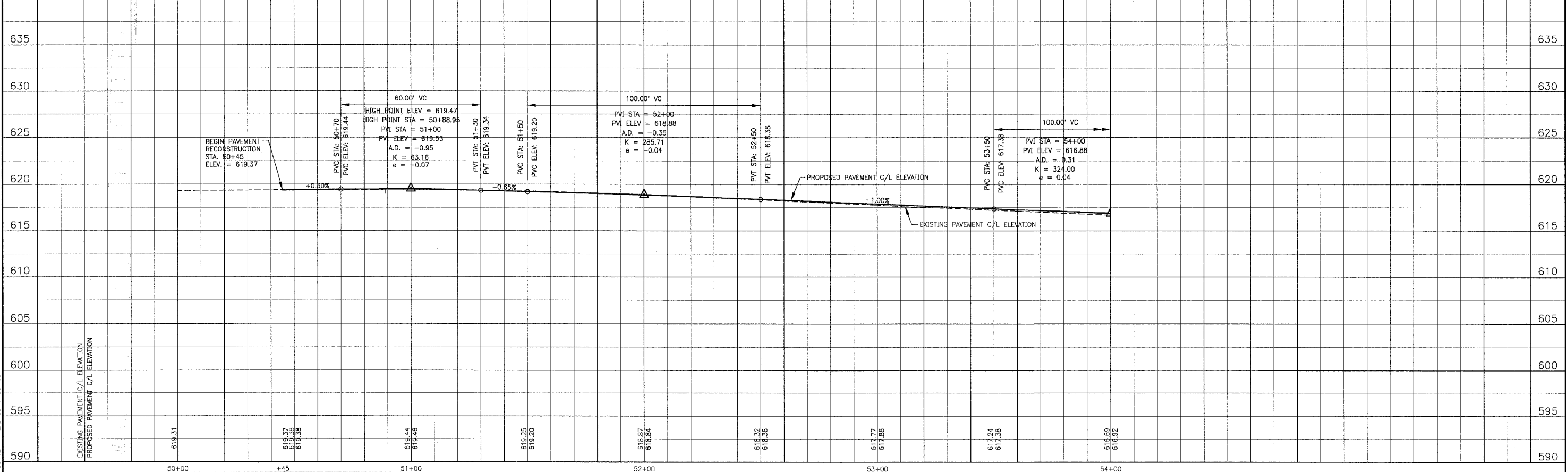

I:\SHRWD\010665\DWG\10665-PRF.dwg
 Plotted: 12-15-04 @ 10:18am By: 23\ukb
 Copyright © 2004, By: Baxter & Woodman, Inc.
 State of Illinois - Professional Design Firm
 License No. - 184-001121 - Expires 4-30-05

| CONSULTANTS | REV. NO. | DATE | DESCRIPTION |
|-------------|----------|----------|---------------------|
| | 1 | 12-21-04 | PER I.D.O.T. REVIEW |

DRAWING FILE: PLOTTED BY:

BAXTER & WOODMAN
 Consulting Engineers

Baxter & Woodman
 Crystal Lake, Illinois 815.459.1260
 Burlington, Wisconsin 262.763.7834
 Mokena, Illinois 708.478.2090
 DeKalb, Illinois 815.787.3111
 Graylake, Illinois 847.223.5088
 Rockford, Illinois 815.489.1551

VILLAGE OF SHOREWOOD, ILLINOIS
U.S. ROUTE 52 IMPROVEMENTS

RIVER ROAD
STA. 50+00 TO STA. 54+00
GEOMETRIC PLAN

| | |
|--------------------|------------------------------|
| DESIGNED BY LDH | SCALE VERT: 1"=5' |
| DRAWN BY UKB | HORIZ: 1"=20' |
| CHECKED BY LDH | PROJECT NO. 010665 |
| DATE 10-05-04 | SHEET NO. 22 OF 85 |