

**U.S. RTE. 52**

- NOTE:
- SEE SHT. NO. 21 FOR GEOMETRIC INFORMATION.
  - DATUM CORRELATION: BAXTER & WOODMAN, INC. SURVEY DATA SHOULD BE ADJUSTED BY -0.12' TO MATCH FEMA REFERENCE MARK DATUM.

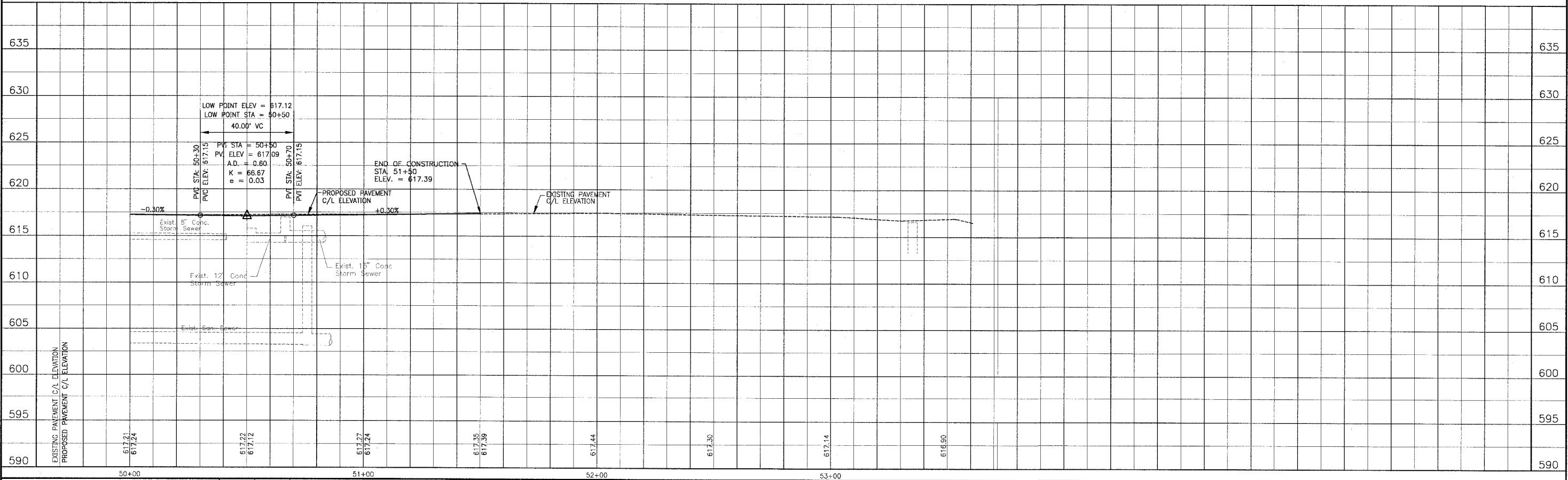

I:\SHR\01\0665\DWG\10665-PRF.dwg  
 Plotted: 12-15-04 @ 10:37am By: 231ukb  
 Copyright © 2004, By Baxter & Woodman, Inc.  
 State of Illinois - Professional Design Firm  
 License No. - 04-001121 - Expires 4-30-05

CONSULTANTS	REV. NO.	DATE	DESCRIPTION
	1	12-21-04	PER I.D.O.T. REVIEW

\* REFER TO EQUIPMENT MANUFACTURER'S SHOP DRAWINGS DRAWING FILE: PLOTTED BY:

**BAXTER & WOODMAN**  
 Consulting Engineers

*Baxter & Woodman*  
 Crystal Lake, Illinois 815.459.1260  
 Burlington, Wisconsin 262.763.7834  
 Mokena, Illinois 708.478.2090  
 DeKalb, Illinois 815.787.3111  
 Grayslake, Illinois 847.223.5098  
 Rockford, Illinois 815.488.1551

**VILLAGE OF SHOREWOOD, ILLINOIS**  
**U.S. ROUTE 52 IMPROVEMENTS**

**US. ROUTE 52**  
**STA. 50+00 TO STA. 54+00**  
**DRAINAGE & UTILITY PLAN**

DESIGNED BY LDH	SCALE VERT: 1"=5'
DRAWN BY UKB	HORIZ: 1"=20'
CHECKED BY LDH	PROJECT NO. 010665
DATE 10-05-04	SHEET NO. <b>31 OF 85</b>