

INTERCONNECT SCHEMATIC LEGEND

- EXISTING INTERSECTION CONTROLLER
- PROPOSED INTERSECTION CONTROLLER
- EXISTING MASTER CONTROLLER
- PROPOSED MASTER CONTROLLER
- MASTER MASTER CONTROLLER
- EXISTING INTERSECTION & SAMPLING (SYSTEM) DETECTORS
- PROPOSED INTERSECTION & SAMPLING (SYSTEM) DETECTORS
- EXISTING INTERSECTION LOOP DETECTORS
- PROPOSED SAMPLING (SYSTEM) DETECTORS
- EXISTING SAMPLING (SYSTEM) DETECTORS
- PROPOSED SAMPLING (SYSTEM) DETECTORS
- EXISTING SAMPLING (SYSTEM) DETECTORS, PROPOSED INTERSECTION AND SAMPLING (SYSTEM) DETECTORS
- EXISTING SAMPLING (SYSTEM) DETECTORS, PROPOSED SAMPLING (SYSTEM) DETECTORS
- EXISTING PREFORMED INTERSECTION & SAMPLING (SYSTEM) DETECTORS
- PROPOSED PREFORMED INTERSECTION & SAMPLING (SYSTEM) DETECTORS
- EXISTING SAMPLING (SYSTEM) PREFORMED DETECTORS
- PROPOSED SAMPLING (SYSTEM) PREFORMED DETECTORS
- EXISTING FIBER OPTIC CABLE IN CONDUIT, NO. 62.5/125, MM12F SM12F
- PROPOSED FIBER OPTIC CABLE IN CONDUIT, NO. 62.5/125, MM12F SM12F
- EXISTING INTERCONNECT CABLE - NO. 62.5/125 12F FIBER OPTIC CABLE
- PROPOSED INTERCONNECT CABLE - NO. 62.5/125 12F FIBER OPTIC CABLE
- EXISTING INTERCONNECT CABLE - NO. 18 3 PAIR TWISTED, SHIELDED
- PROPOSED INTERCONNECT CABLE - NO. 18 3 PAIR TWISTED, SHIELDED
- EXISTING LOOP DETECTOR CABLE 2/C TWISTED, SHIELDED
- PROPOSED LOOP DETECTOR CABLE 2/C TWISTED, SHIELDED
- EXISTING ELECTRIC CABLE, 1/C (AS SPECIFIED)
- PROPOSED ELECTRIC CABLE, 1/C (AS SPECIFIED)
- EXISTING TELEPHONE CONNECTION
- PROPOSED TELEPHONE CONNECTION

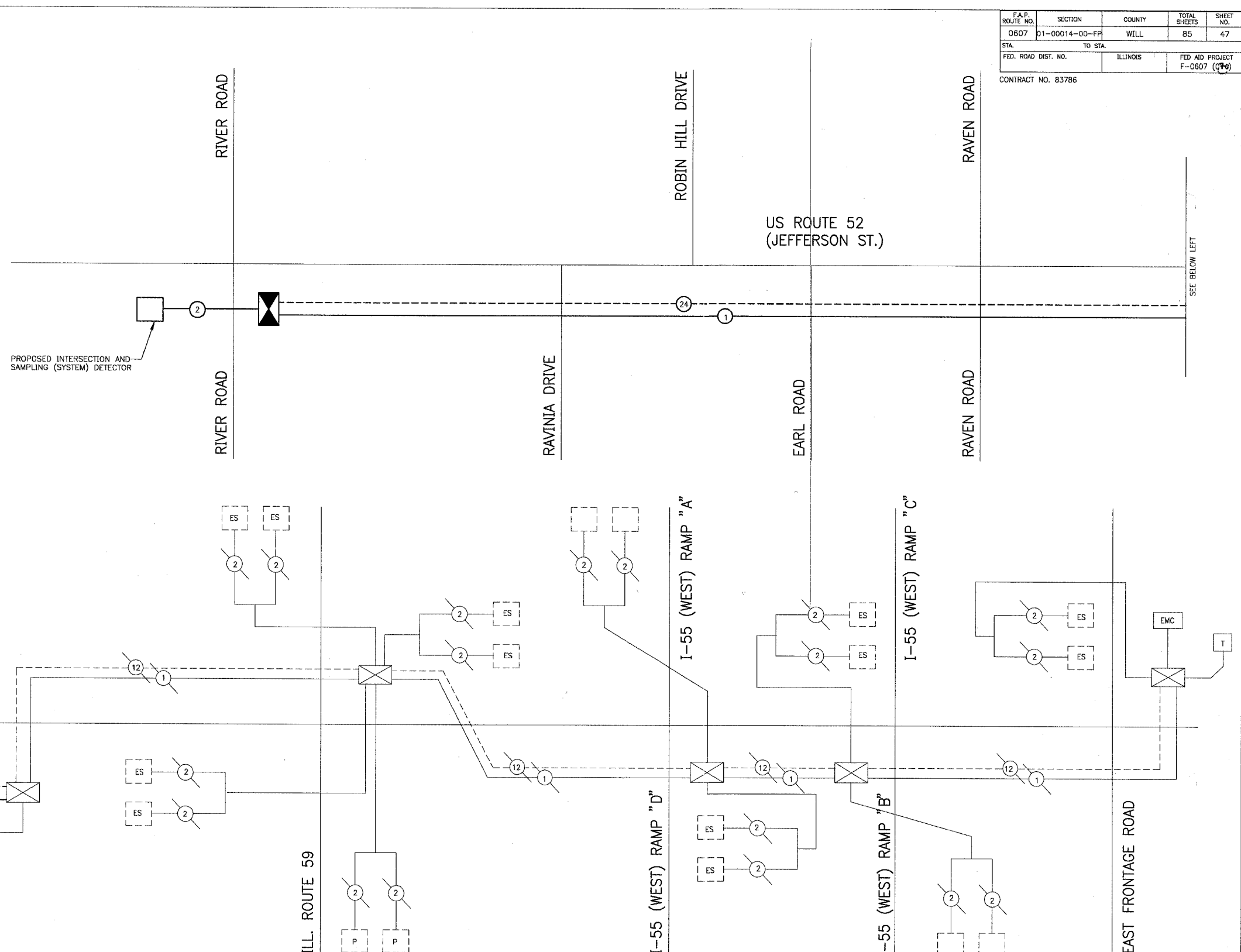

F.A.P. ROUTE NO.	SECTION	COUNTY	TOTAL SHEETS	SHEET NO.
0607	01-00014-00-FF	WILL	85	47
STA.	TO STA.			
FED. ROAD DIST. NO.	ILLINOIS	FED AID PROJECT	F-0607 (37)	
CONTRACT NO. 83786				

PAY ITEM	UNIT	QUANTITY
CONDUIT IN TRENCH, 2" DIA., GALVANIZED STEEL	FOOT	2537
CONDUIT PUSHED, 2" DIA., GALVANIZED STEEL	FOOT	345
HANDHOLE	EACH	4
TRENCH AND BACKFILL FOR ELECTRICAL WORK	FOOT	2537
DRILL EXISTING HANDHOLE	EACH	1
ELECTRIC CABLE IN CONDUIT, TRACER, NO. 14 1C	FOOT	3254
FIBER OPTIC CABLE IN CONDUIT, NO. 62.5/125, MM 12F, SM 12F	FOOT	3254
REOPTIMIZE TRAFFIC SIGNAL SYSTEM	L SUM	1

NOTE:
THE TRAFFIC SIGNAL CONTROL EQUIPMENT FOR THIS PROJECT SHALL BE "EAGLE" TO MATCH THE EXISTING ADJACENT SYSTEM

NAME	DATE
RWL	9-15-04

ILLINOIS DEPARTMENT OF TRANSPORTATION
INTERCONNECT SCHEMATIC AND SCHEDULE OF QUANTITIES
 US ROUTE 52 - RIVER ROAD TO EAST FRONTAGE ROAD
 SCALE NONE
 DATE 8-1-04
 DRAWN BY: UKB
 DESIGNED BY: RWL
 CHECKED BY: LDH

I:\SHR\010665\DWG\Intercon-Cobts.dwg
 Plotted: 12-15-04 @ 11:35am By: 231ukb
 Copyright © 2004, By: Boxler & Woodman, Inc.
 State of Illinois - Professional Design Firm
 License No. - 184-001171 - Expires 4-30-05