

F.A. NO.	SECTION	COUNTY	TOTAL SHEETS	SHEET NO.
0607	D1-00014-00-FH	WILL.	85	70
STA.	TO STA.			
FED. ROAD DIST. NO.	ALWAYS	FOR AID PROJECT		
CONTRACT NO.: 83786		CMF-0607 (070)		

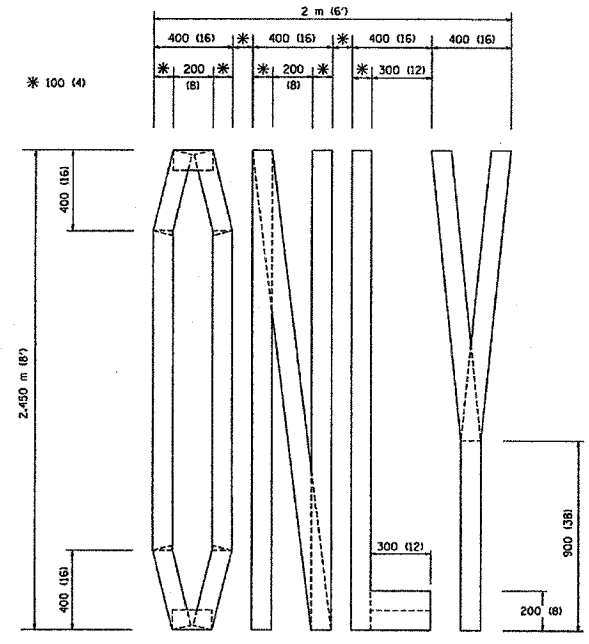

QUANTITY
 100 (4) LINE = 19.7 m (64.1 ft.)
 1.97 sq. m (21.1 sq. ft.)

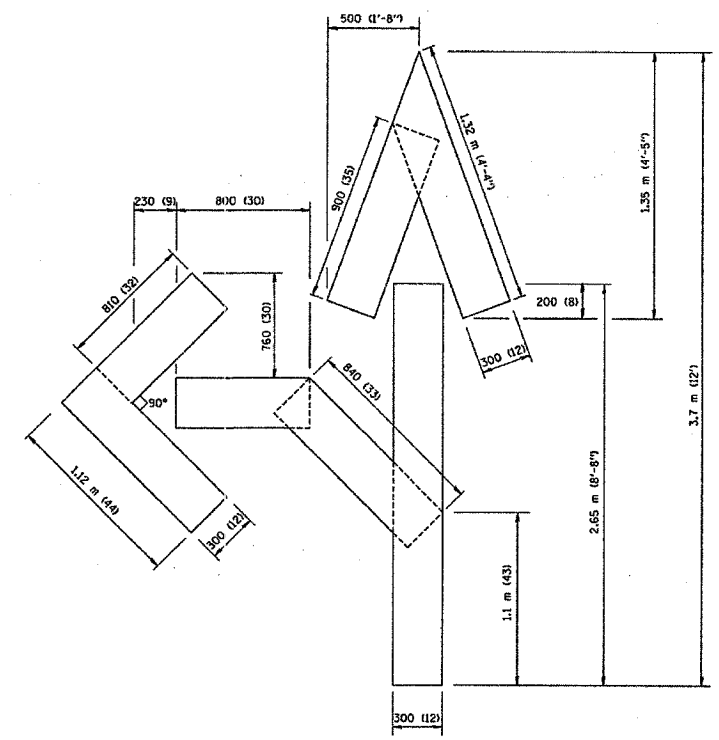

QUANTITY
 100 (4) LINE = 25.3 m (82.5 ft.)
 2.53 sq. m (27.5 sq. ft.)

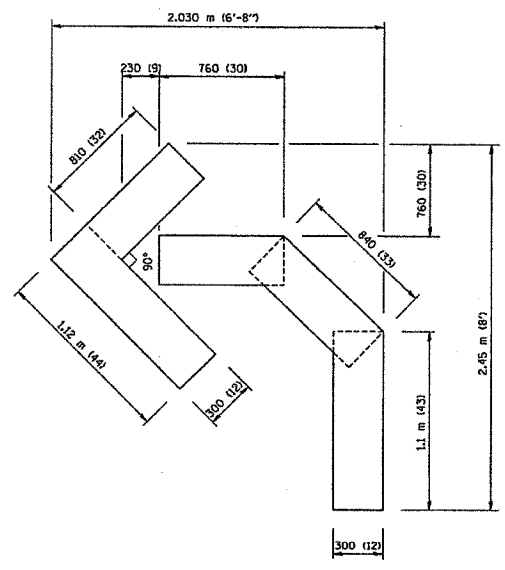

QUANTITY
 100 (4) LINE = 13.9 m (45.5 ft.)
 1.39 sq. m (15.2 sq. ft.)

All dimensions are in millimeters (inches) unless otherwise shown.

ILLINOIS DEPARTMENT OF TRANSPORTATION

PAVEMENT MARKING
 LETTERS AND SYMBOLS
 FOR TRAFFIC STAGING

REVISIONS	NAME	DATE
1	T. RAMMACHER	09/18/94
2	J. OBERLE	06/01/96
3	T. RAMMACHER	06/05/96
4	T. RAMMACHER	11/04/97
5	T. RAMMACHER	03/02/98
6	E. GOMEZ	08/28/00

SCALE: NONE
 DATE 10/18/2002

DRAWN BY CADD
 CHECKED BY TC-16

REVISION DATE: 08/28/00

Friday, October 18, 2002 @ 10:23:21 AM
 c:\projects\dist1\td16.dgn LV=35,63
 VPTC6

Copyright © 2004, by BATES & MCDONALD, INC.
 STATE OF ILLINOIS - PROFESSIONAL DESIGN FIRM
 LICENSE NO. 000-000111 - LICENSED 4/25/2000