

| | | | | |
|--------------------|----------------|--------|--------------------------------|-----------|
| F.A.P. ROUTE NO. | SECTION | COUNTY | TOTAL SHEETS | SHEET NO. |
| 0607 | 01-00014-00-FP | WILL | 85 | 79 |
| STA. | TO STA. | | FED. ROAD DIST. NO. | |
| | ILLINOIS | | FED AID PROJECT CMF-0607 (070) | |
| CONTRACT NO. 83786 | | | | |

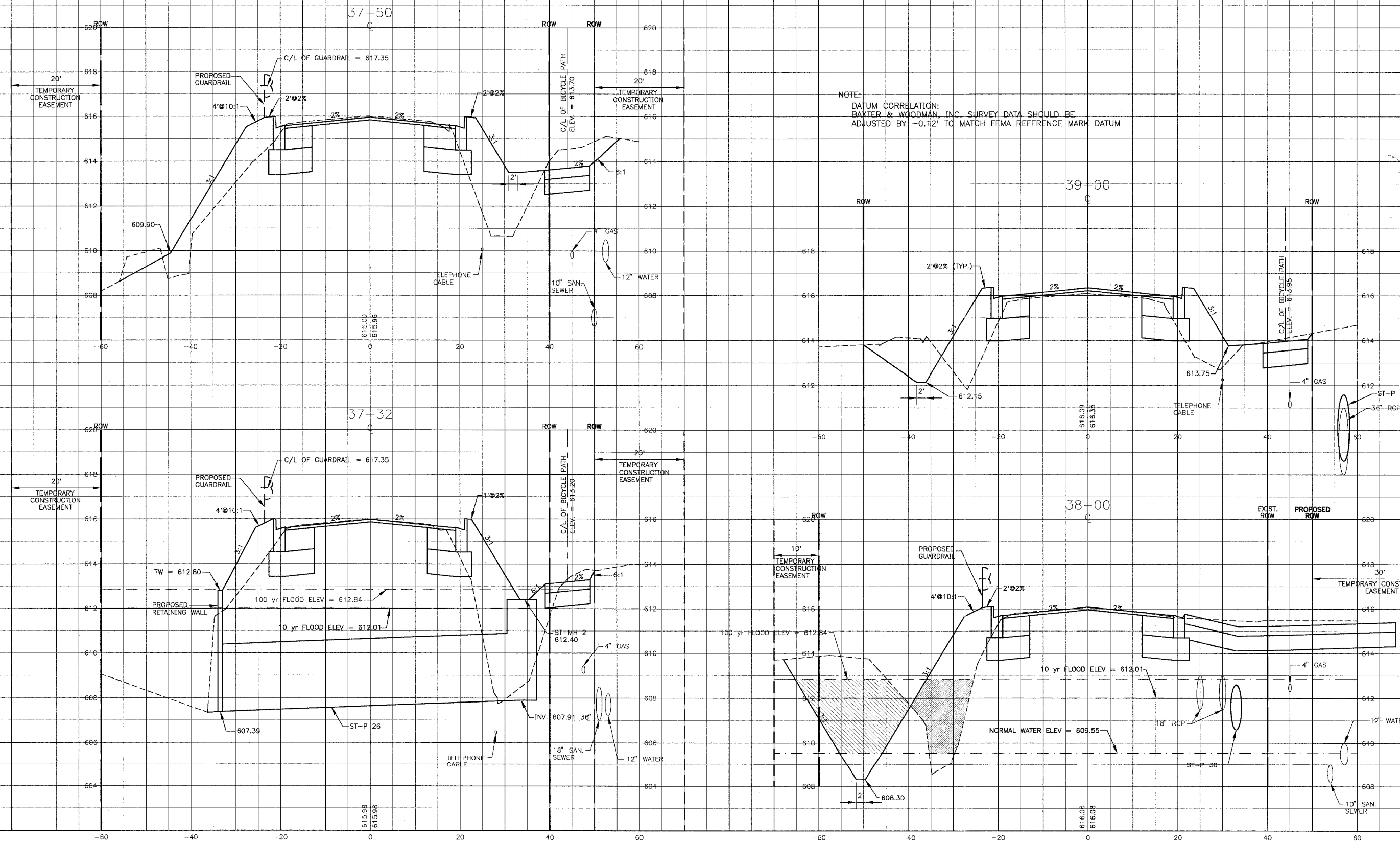

NOTE:
 DATUM CORRELATION:
 BAXTER & WOODMAN, INC. SURVEY DATA SHOULD BE
 ADJUSTED BY -0.12' TO MATCH FEMA REFERENCE MARK DATUM

I:\SHRWD\010665\DWGS\10665-XSEC.dwg
 Plotted: 12-20-04 @ 12:06pm By: 231ub
 Copyright © 2004, By Baxter & Woodman, Inc.
 State of Illinois - Professional Design Firm
 License No. - 184-001121 - Expires 4-30-05

| CONSULTANTS | REV. NO. | DATE | DESCRIPTION |
|-------------|----------|----------|---------------------|
| | 1 | 12-21-04 | PER I.D.O.T. REVIEW |

DRAWING FILE: _____ PLOTTED BY: _____

BAXTER & WOODMAN
 Consulting Engineers

Baxter & Woodman
 Crystal Lake, Illinois 815.459.1260
 Burlington, Wisconsin 262.763.7834
 Mokena, Illinois 708.478.2090
 DeKalb, Illinois 815.787.3111
 Grayslake, Illinois 847.823.5088
 Rockford, Illinois 815.489.1551

VILLAGE OF SHOREWOOD, ILLINOIS
U.S. ROUTE 52 IMPROVEMENTS

CROSS SECTIONS
U.S. ROUTE 52
STA. 37+50 TO STA. 39+00

| | | |
|-------------|----------|--------------------|
| DESIGNED BY | LDH | SCALE VERT: 1"=2' |
| DRAWN BY | UKB | HORIZ: 1"=10' |
| CHECKED BY | LDH | PROJECT NO. 010665 |
| DATE | 10-05-04 | SHEET NO. 79 OF 85 |