

F.A.P. ROUTE NO.	SECTION	COUNTY	TOTAL SHEETS	SHEET NO.
0607	01-00014-00-FP	WILL	85	81
STA.	TO STA.			
FED. ROAD DIST. NO.	ILLINOIS		FED AID PROJECT CMF-0607 (070)	
CONTRACT NO. 83786				

NOTE:
DATUM CORRELATION:
BAXTER & WOODMAN, INC. SURVEY DATA SHOULD BE
ADJUSTED BY -0.12' TO MATCH FEMA REFERENCE MARK DATUM

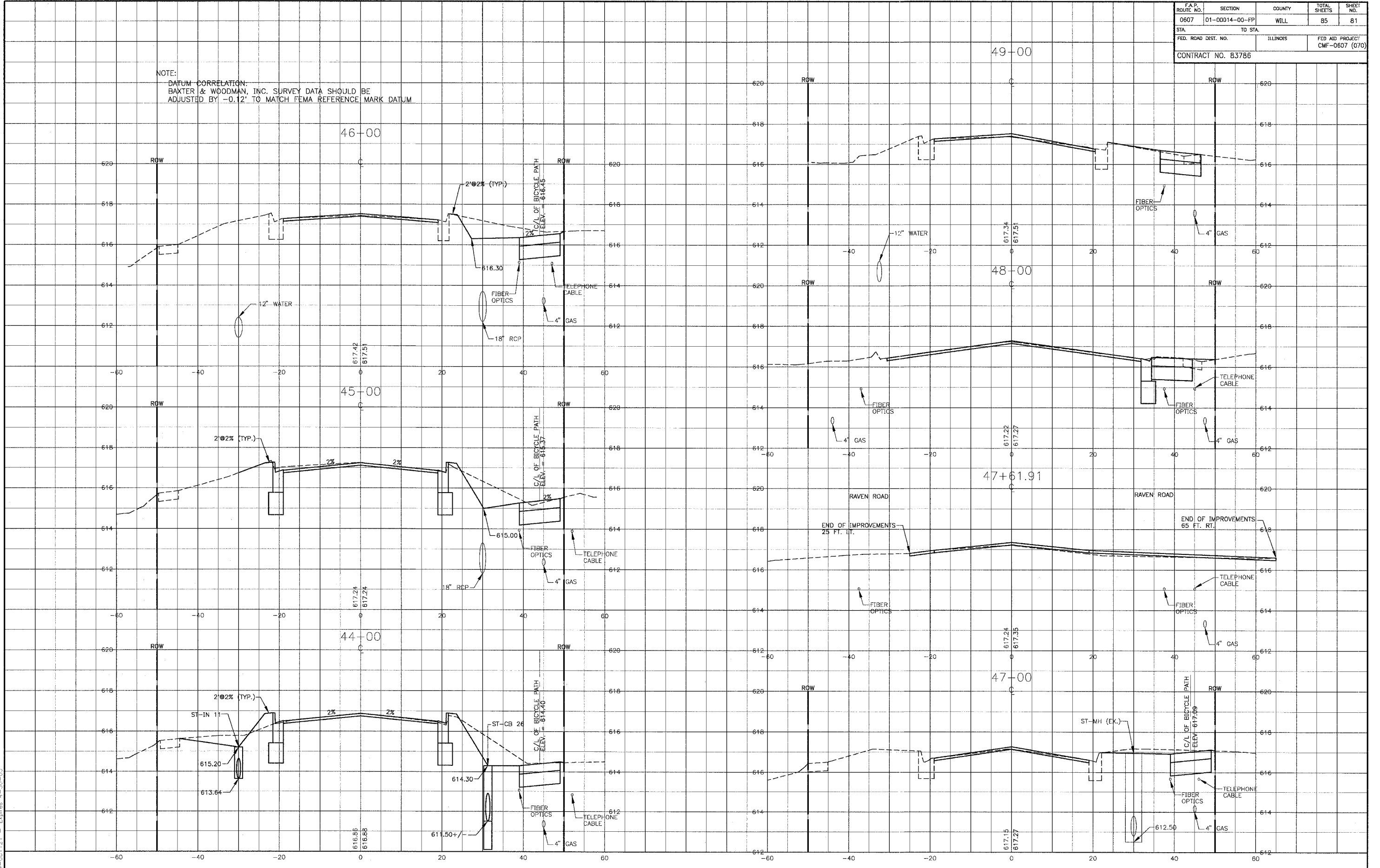

I:\SHRND\010665\DWG\10665-15SEC.dwg
 Plotted: 12-17-04 @ 7:40am By: 231ub
 Copyright © 2004, By Baxter & Woodman, Inc.
 State of Illinois - Professional Design Firm
 License No. - 184-001121 - Expires 4-30-05

CONSULTANTS	REV. NO.	DATE	DESCRIPTION
	1	12-21-04	PER I.D.O.T. REVIEW
DRAWING FILE: _____ PLOTTED BY: _____			

BAXTER & WOODMAN
Consulting Engineers

Baxter & Woodman
Crystal Lake, Illinois 815.459.1260
Burlington, Wisconsin 262.763.7834
Mokena, Illinois 708.478.2090
DeKalb, Illinois 815.787.3111
Grayslake, Illinois 847.223.5088
Rockford, Illinois 815.489.1551

VILLAGE OF SHOREWOOD, ILLINOIS
U.S. ROUTE 52 IMPROVEMENTS

CROSS SECTIONS
U.S. ROUTE 52
STA. 44+00 TO STA. 49+00

DESIGNED BY: LDH
DRAWN BY: UKB
CHECKED BY: LDH
DATE: 10-05-04

SCALE VERT: 1"=2'
SCALE HORIZ: 1"=10'

PROJECT NO.: 010665
SHEET NO.: 81 OF 85