

F.A.P. ROUTE NO.	SECTION	COUNTY	TOTAL SHEETS	SHEET NO.
0607	01-00014-00-FP	WILL	85	77
STA.	TO STA.			
FED. ROAD DIST. NO.	ILLINOIS		FED AID PROJECT CMF-0607 (070)	
CONTRACT NO. 83786				

NOTE:
DATUM CORRELATION:
BAXTER & WOODMAN, INC. SURVEY DATA SHOULD BE
ADJUSTED BY -0.12' TO MATCH FEMA REFERENCE MARK DATUM

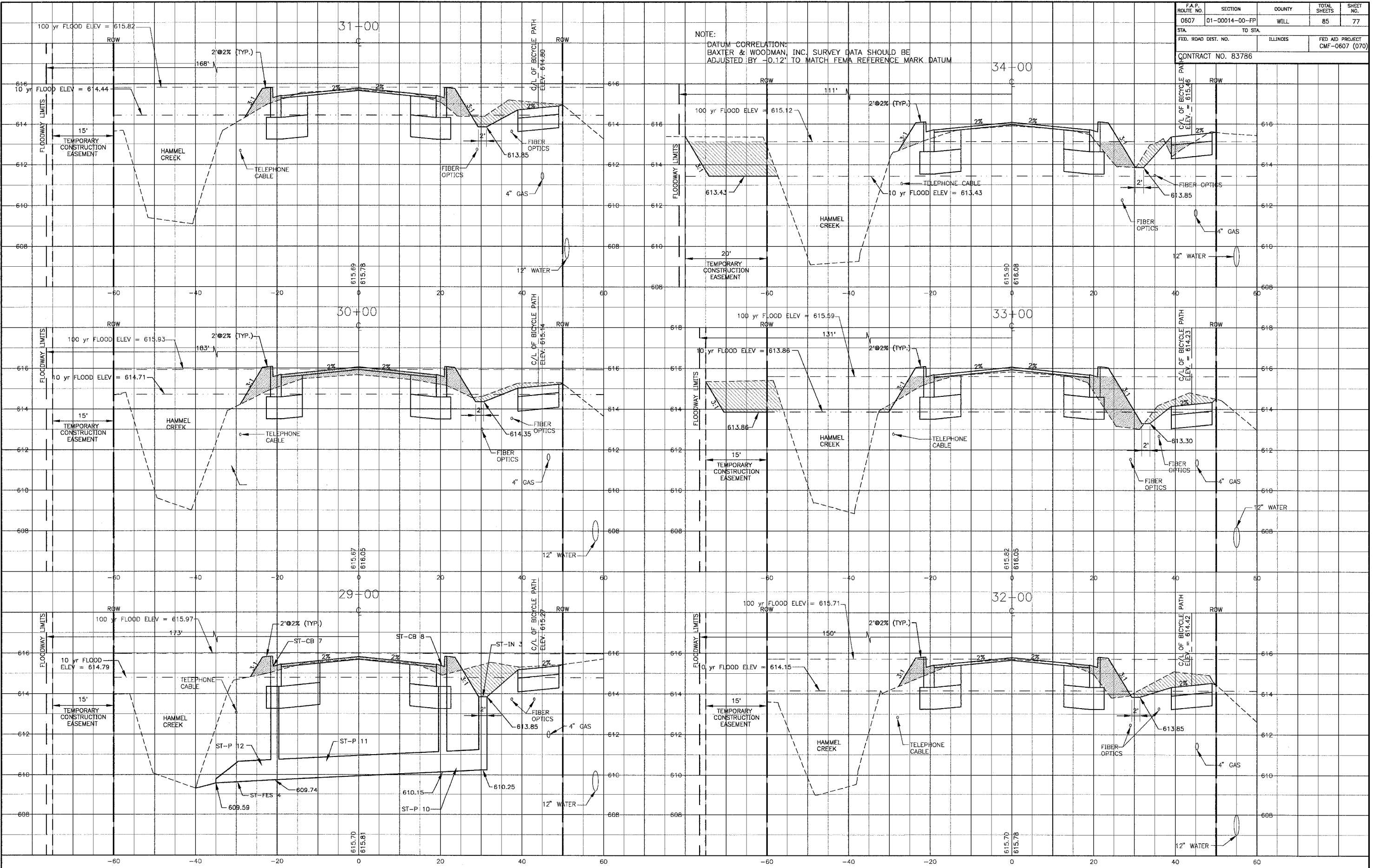

M:\SHRWDY\010665\DWGS\10665-XSEC.dwg
 Plotted: 3-08-05 @ 11:51am By: j62/pmm
 Copyright © 2004, By Baxter & Woodman, Inc.
 State of Illinois - Professional Design Firm
 License No. 184-001121 - Expires 4-30-05

CONSULTANTS	REV. NO.	DATE	DESCRIPTION
	1	12-21-04	PER I.D.O.T. REVIEW
	2	2-04-05	PER I.D.O.T. REVIEW
	3	4-5-05	

* REFER TO EQUIPMENT MANUFACTURER'S SHOP DRAWINGS

BAXTER & WOODMAN
Consulting Engineers

Baxter & Woodman
Crystal Lake, Illinois 815.459.1260
Burlington, Wisconsin 262.763.7834
Mokena, Illinois 708.478.2090
DeKalb, Illinois 815.787.3111
Craigs Lake, Illinois 847.223.5088
Rockford, Illinois 815.489.1551

VILLAGE OF SHOREWOOD, ILLINOIS
U.S. ROUTE 52 IMPROVEMENTS

CROSS SECTIONS
U.S. ROUTE 52
STA. 29+00 TO STA. 34+00

DESIGNED BY	LDH	SCALE VERT: 1"=2'	HORIZ: 1"=10'
DRAWN BY	UKB	PROJECT NO.	010665
CHECKED BY		SHEET NO.	
DATE	10-05-04	77 OF 85	

Revised 4-5-05