

steffennk
2/8/2005
c:\projects\94888d\d05703pa.dgn

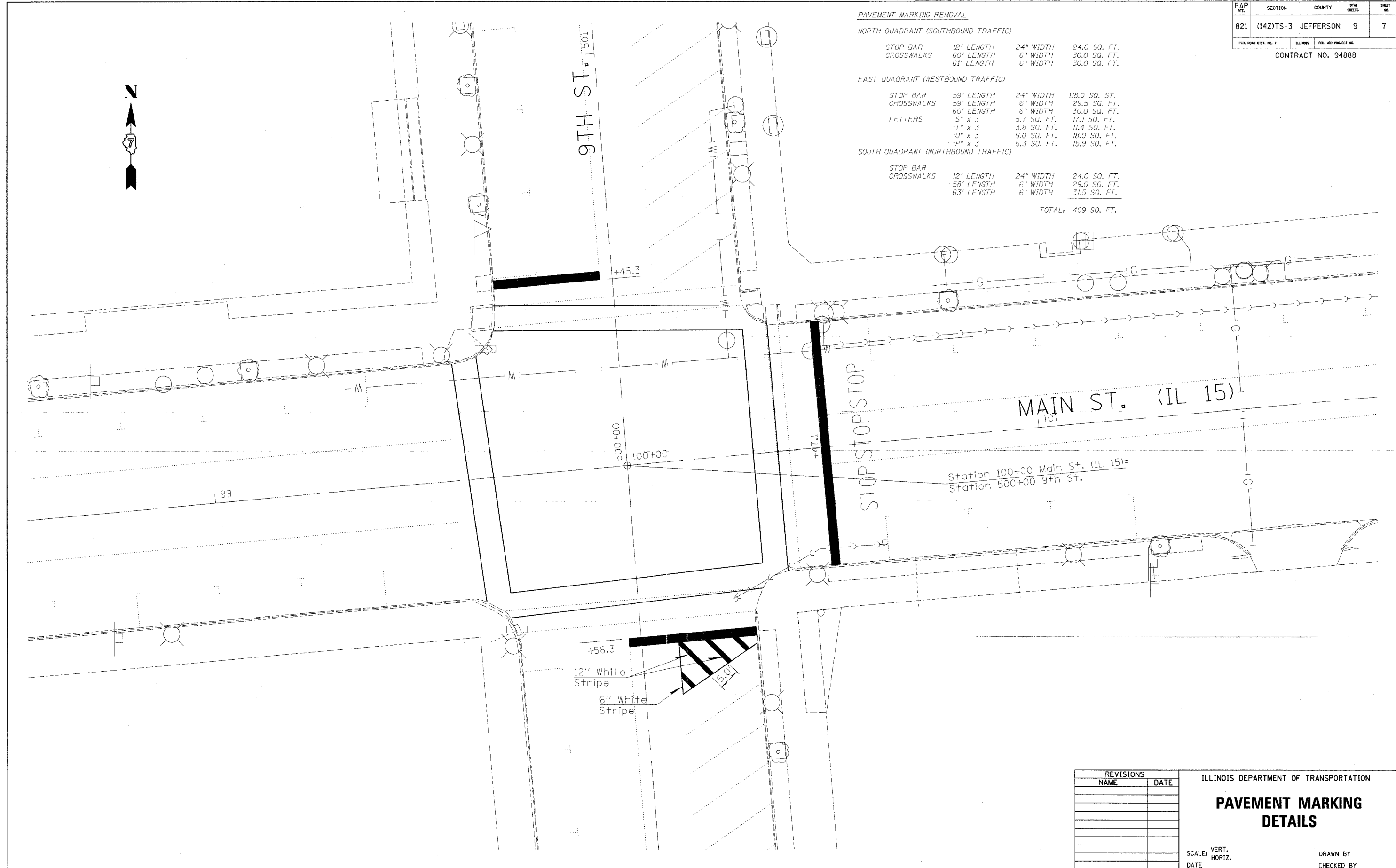

PAVEMENT MARKING REMOVAL

NORTH QUADRANT (SOUTHBOUND TRAFFIC)			
STOP BAR	12' LENGTH	24" WIDTH	24.0 SQ. FT.
CROSSWALKS	60' LENGTH	6" WIDTH	30.0 SQ. FT.
	61' LENGTH	6" WIDTH	30.0 SQ. FT.
EAST QUADRANT (WESTBOUND TRAFFIC)			
STOP BAR	59' LENGTH	24" WIDTH	118.0 SQ. FT.
CROSSWALKS	59' LENGTH	6" WIDTH	29.5 SQ. FT.
	60' LENGTH	6" WIDTH	30.0 SQ. FT.
LETTERS	"S" x 3	5.7 SQ. FT.	17.1 SQ. FT.
	"T" x 3	3.8 SQ. FT.	11.4 SQ. FT.
	"O" x 3	6.0 SQ. FT.	18.0 SQ. FT.
	"P" x 3	5.3 SQ. FT.	15.9 SQ. FT.
SOUTH QUADRANT (NORTHBOUND TRAFFIC)			
STOP BAR	12' LENGTH	24" WIDTH	24.0 SQ. FT.
CROSSWALKS	58' LENGTH	6" WIDTH	29.0 SQ. FT.
	63' LENGTH	6" WIDTH	31.5 SQ. FT.
			TOTAL: 409 SQ. FT.

FAP R/L	SECTION	COUNTY	TOTAL SHEETS	SHEET NO.
821	(14Z)TS-3	JEFFERSON	9	7
FED. ROAD DIST. NO. 7		ILLINOIS	FED. AID PROJECT NO.	
CONTRACT NO. 94888				

REVISIONS	
NAME	DATE

ILLINOIS DEPARTMENT OF TRANSPORTATION

PAVEMENT MARKING DETAILS

SCALE: VERT. _____
HORIZ. _____

DATE _____

DRAWN BY _____
CHECKED BY _____