

| F.A.U. RTE. | SECTION | COUNTY | TOTAL SHEETS | SHEET NO. |
|-------------|---------|-----------|--------------|-----------|
| 9195 | . | ST. CLAIR | 54 | 14 |
| STA. | | TO STA. | | |

• CITY SECTION #01-00039-00-FP
 COUNTY SECTION #03-00360-00-PV
 CONTRACT NO. 97235

STAGE 2 CONSTRUCTION

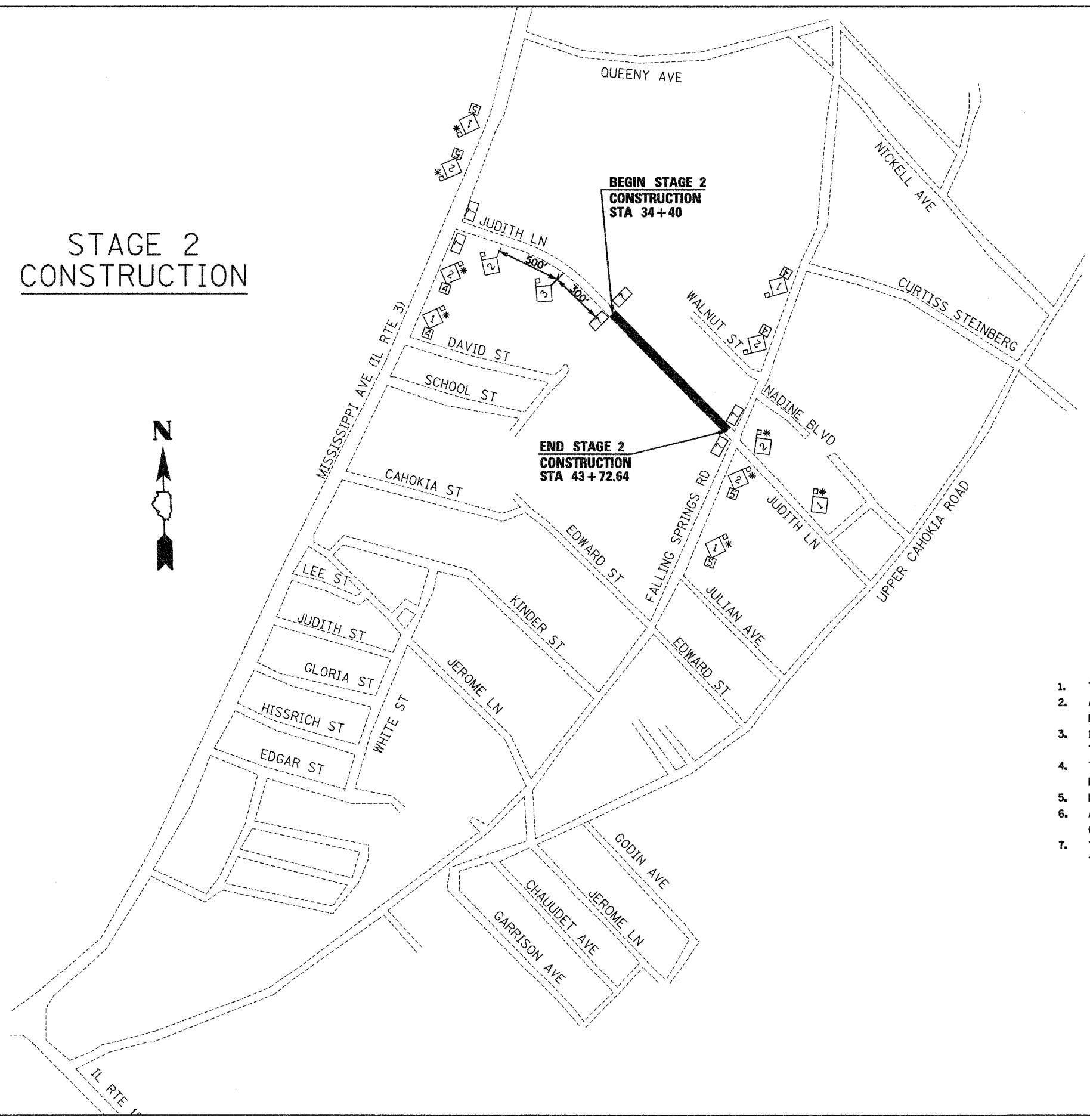

LEGEND

| | |
|--|---|
| | ROAD CONSTRUCTION AHEAD |
| | ROAD CLOSED AHEAD |
| | BARRICADE AHEAD |
| | 24" X 24" |
| | 24" X 24" |
| | ROAD CLOSED |
| | ROAD CLOSED TO THRU TRAFFIC |
| | 18" X 18" (MINIMUM) ORANGE FLAG |
| | DENOTES ADVANCE WARNING SIGN THAT IS TO STAY IN PLACE THROUGHOUT THE DURATION OF THE THE ENTIRE PROJECT FROM COMMENCEMENT TO COMPLETION |

GENERAL NOTES

1. THE CONTRACTOR MUST MAINTAIN ACCESS TO ALL ENTRANCES AT ALL TIMES.
2. ALL WARNING SIGNS SHALL BE A MINIMUM OF 48" X 48" AND HAVE A BLACK LEGEND ON AN ORANGE REFLECTORIZED BACKGROUND.
3. 12V FLASHING WARNING LIGHTS SHALL BE USED ON EACH APPROACH IN ADVANCE OF THE WORK DURING HOURS OF DARKNESS AND INSTALLED ABOVE THE FIRST TWO SIGNS.
4. THE NUMBER OF TYPE III BARRICADES REQUIRED AT EACH LOCATION SHALL BE DETERMINED BY THE ENGINEER DURING CONSTRUCTION.
5. DISTANCES MAY BE ADJUSTED TO FIT FIELD CONDITIONS.
6. ALL TYPE III BARRICADES UTILIZED FOR ROAD CLOSURES SHALL HAVE TWO 6V FLASHING LIGHTS MOUNTED ON TOP OF THE BARRICADES.
7. THE CONTRACTOR WILL NOT BE ALLOWED TO CONDUCT HIS OPERATIONS IN MORE THAN ONE STAGE AT A TIME WITHOUT WRITTEN APPROVAL FROM THE ENGINEER.

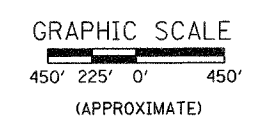

STAGE 2 CONSTRUCTION

| | |
|----------------|-----------------|
| SCALE: VERT. | DRAWN BY: JJC |
| HORIZ. | CHECKED BY: MAR |
| DATE: 12/01/04 | |

2/10/2005 10:00:31 AM