

| F.A.R.T.E. | SECTION | COUNTY | TOTAL SHEETS | SHEET NO. |
|-------------------------|----------------|------------------|--------------|-----------|
| 8980 | 02-00043-00-RS | MADISON | 18 | 1 |
| MADISON COUNTY ILLINOIS | | FED. AID PROJECT | | |
| CONTRACT NO. 97247 | | | | |

STATE OF ILLINOIS
DEPARTMENT OF TRANSPORTATION
**PLANS FOR PROPOSED
FEDERAL AID HIGHWAY
F.A.U. ROUTE 8980 (EDWARDSVILLE ROAD)
WOOD RIVER SECTION 02-00043-00-RS
MADISON COUNTY
PROJECT NO. M-5011 (180)
JOB NO. C-98-347-04**

THIS PROJECT IS LOCATED IN SECTION 21 AND 22,
TOWNSHIP 5 NORTH, RANGE 9 WEST OF THE
3RD PRINCIPAL MERIDIAN, MADISON COUNTY, ILLINOIS

UTILITY LOCATION CAN BE OBTAINED BY CALLING J.U.L.I.E.
(1-800-892-0123)

THE FOLLOWING UTILITY COMPANIES HAVE FACILITIES WITHIN
THE LIMITS OF THIS PROJECT WHICH MAY OR MAY NOT
REQUIRE ADJUSTMENT OR RELOCATION:

TELEPHONE:
SBC
203 GOETHE
COLLINSVILLE, ILLINOIS 62234
(618) 346-6400

WATER:
WOODRIVER PUBLIC WORKS DEPT.
501 W. FERGUSON AVE.
WOOD RIVER, ILLINOIS 62095
(618) 251-3122

GAS & ELECTRIC:
ILLINOIS POWER COMPANY
2600 N. CENTER STREET
MARYVILLE, ILLINOIS 62062
(618) 346-1273

STORM SEWERS:
WOODRIVER PUBLIC WORKS DEPT.
501 W. FERGUSON AVE.
WOOD RIVER, ILLINOIS 62095
(618) 251-3122

CABLE TELEVISION:
CHARTER COMMUNICATIONS
508 NIAGARA AVENUE
EAST ALTON, ILLINOIS 62024
(618) 251-2660

SANITARY SEWERS:
WOODRIVER PUBLIC WORKS DEPT.
501 W. FERGUSON AVE.
WOOD RIVER, ILLINOIS 62095
(618) 251-3122

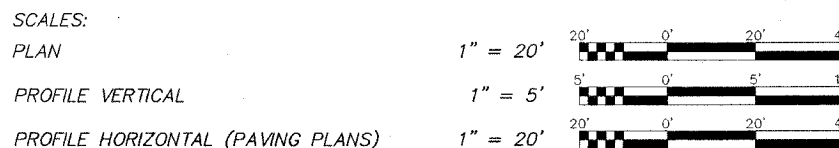
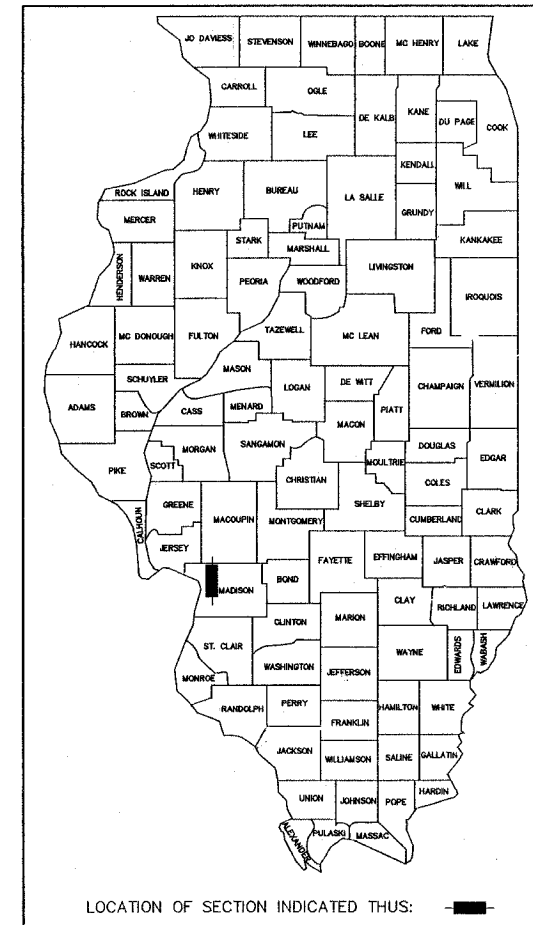

INDEX TO SHEETS

1. COVER SHEET
2. SUMMARY OF QUANTITIES AND GENERAL NOTES
- 3-4. TYPICAL SECTIONS
5. PLAN AND PROFILE (PAVING AND TRAFFIC SIGNAL IMPROVEMENTS AT WOOD RIVER AVENUE)
- 6-15. PLAN AND PROFILE (PAVING)
16. PLAN AND PROFILE (PAVING AND TRAFFIC SIGNAL IMPROVEMENTS AT NINTH STREET)
17. TRAFFIC SIGNAL PLAN
18. CABLE DIAGRAM

HIGHWAY STANDARDS

- 420701-01
- 442101-05
- 442201-01
- 701201-02
- 701306-01
- 701501-03
- 701701-04
- 702001-05
- 720001
- 780001-01
- 781001-02
- 805001
- 814001
- 814006
- 878001-03
- 880006
- 886001
- 886006

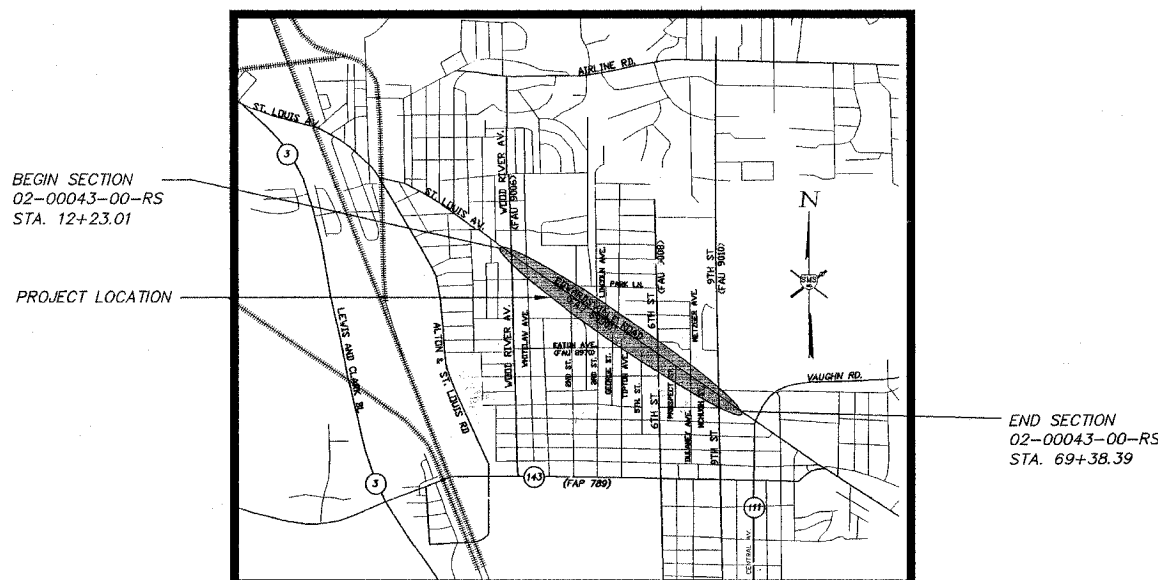

LOCATION MAP

SCALE: 1" = 1000'

TOTAL LENGTH OF PROJECT = 5,715.38 FT. = 1.082 MILES



Sheppard, Morgan & Schwaab, Inc.
CONSULTING ENGINEERS & LAND SURVEYORS

215 Market Street
Alton, Illinois 62002
618/462-9755

10 Central Industrial Dr
Northgate Center
Granite City, IL 62040
618/677-8700

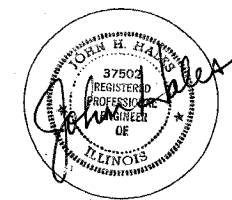

DATED: FEBRUARY, 2005
EXPIRES: NOVEMBER 30, 2005

APPROVED FEBRUARY 9, 2005

David L. Ayres

MAYOR, WOOD RIVER

PASSED 2-28-05 2005

Jennifer Oberst

LOCAL ROADS AND STREETS ENGINEER

APPROVED 2-28-2005

Mary C. Lamie

MARY C. LAMIE, P.E.
DEPUTY DIRECTOR OF HIGHWAYS
REGION FIVE ENGINEER

STATE OF ILLINOIS
DEPARTMENT OF TRANSPORTATION

ROADWAY CLASSIFICATION=TS-3 (MINOR ARTERIAL)
DESIGN SPEED=30 MPH
CURRENT ADT = 14,100
% MU=1.0% %SU=1.3%