

MATCH LINE SEE DRAWING RL4-1
W. FRONTAGE CONN. 6021+00.00
SB EXIT RAMP 2005+51.17

MATCH LINE SEE DRAWING RL4-3
WEST FRONTAGE
CONNECTOR 6035+50.00

MATCH LINE SEE DRAWING RL4-3
ARSENAL RD 918+00.00

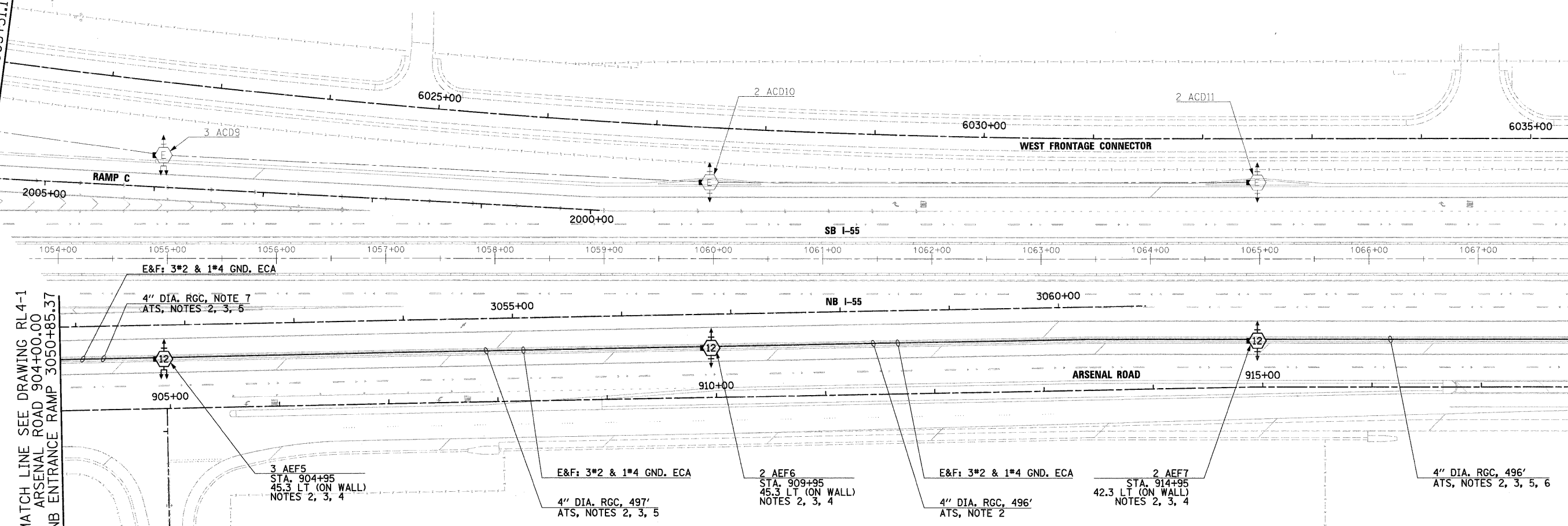

NOTES:

1. SEE DRAWING GE-1 FOR ELECTRICAL SYMBOL LIST AND ABBREVIATIONS. SEE DRAWING GE-2 FOR ELECTRICAL GENERAL NOTES AND SUGGESTED LIGHTING PHASING NOTES.
2. SEE DRAWINGS RL2-8 AND RL3-5 FOR ADDITIONAL WORK ASSOCIATED WITH WALL MOUNTED LIGHT TOWER FOUNDATIONS AND CONDUIT INSTALLATION.
3. SEE DRAWINGS S-1 AND ED-1 FOR HIGH MAST LIGHT TOWER FOUNDATIONS INTEGRAL WITH RETAINING WALL DETAILS.
4. SEE IDOT STANDARD DRAWINGS BE-505a, BE-505b, AND BE-505c FOR HIGH MAST LIGHT TOWER INSTALLATION DETAILS. THIS WORK SHALL BE INCLUDED IN "LIGHT TOWER, 120 FOOT MOUNTING HEIGHT, LUMINAIRE MT. - 12" PAY ITEM. SEPARATE PAYMENT WILL NOT BE MADE.
5. CONDUIT PREVIOUSLY INSTALLED IN STAGE 2 AS SHOWN ON DRAWING RL2-8. NO ADDITIONAL PAYMENT WILL BE MADE.
6. SPARE CONDUIT ATTACHED TO RETAINING WALL BETWEEN TOWERS 2 AEF7 AND 2 TEF8, SHOWN ON DRAWING RL4-3. CONDUIT OPENINGS TO RETAIN WATERTIGHT SEAL AFTER INSTALLATION OF HIGH MAST TOWERS ON RETAINING WALL.
7. LENGTH NOT SHOWN. SEE DRAWING RL4-1 FOR RUN LENGTH.

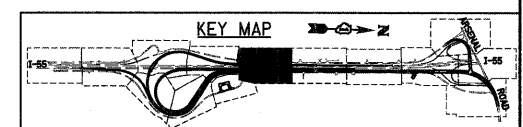
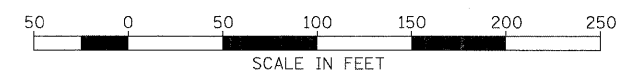

McDonough Associates Inc.
Engineers / Architects
130 East Randolph Street Chicago, Illinois 60601

FILE NAME = D162F12-SHT-RL4-2.dgn	USER NAME = Tkluog1	DESIGNED - JLW	REVISED -
		DRAWN - CJM	REVISED -
	PLOT SCALE = 1:50	CHECKED - KMY	REVISED -
	PLOT DATE = 2/3/2011	DATE - 2/4/11	REVISED -

**STATE OF ILLINOIS
DEPARTMENT OF TRANSPORTATION**

**I-55 AT ARSENAL ROAD
PROPOSED ROADWAY LIGHTING PLAN-STAGE 4**

SCALE: 1" = 50' SHEET NO. 2 OF 8 SHEETS STA. TO STA.

F.A.I. RTE. 55	SECTION 99-2HB-2B-1	COUNTY WILL	TOTAL SHEETS 756	SHEET NO. 383
CONTRACT NO. 60F12				
FED. ROAD DIST. NO. 1 ILLINOIS FED. AID PROJECT				