

CONSTRUCTION NOTES:

- ① RELOCATE EXISTING REMOTE-CONTROLLED VIDEO SYSTEM AND EXISTING SWITCH TO THE NEW COMBINATION MAST ARM ASSEMBLY AND POLE, 45 FT., WITH 20 FT. LUMINAIRE ARM AND CONTROLLER CABINET.
- ② NEW FIBER OPTIC INTERCONNECT CABLE WILL BE INSTALLED FROM THE EXISTING CONTROLLER CABINET AT ST. MARY'S RD. TO THE NEW CONTROLLER CABINET AT O'PLAINE RD. AND FROM THE CONTROLLER CABINET AT O'PLAINE RD. TO THE EXISTING CONTROLLER CABINET AT I-94 SB RAMP.
- ③ SPLICE PROPOSED 2" DIA. GALVANIZED STEEL CONDUIT TO THE EXISTING CONDUIT CONNECTED TO THE PEDESTRIAN PUSH-BUTTON FOUNDATION.

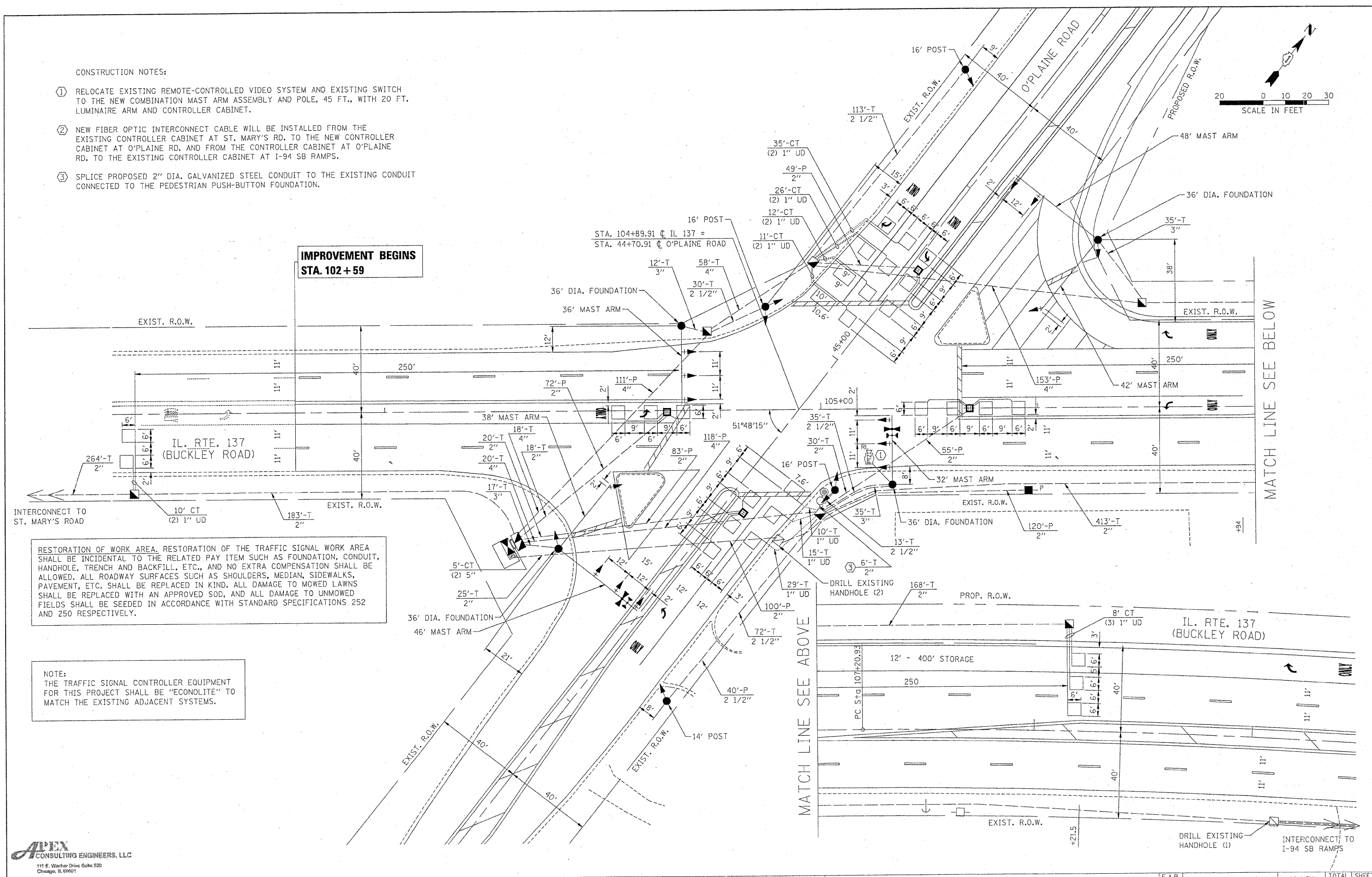
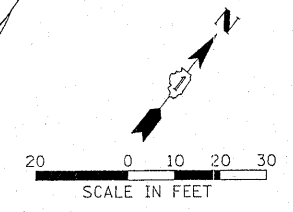

**IMPROVEMENT BEGINS
STA. 102 + 59**

RESTORATION OF WORK AREA. RESTORATION OF THE TRAFFIC SIGNAL WORK AREA SHALL BE INCIDENTAL TO THE RELATED PAY ITEM SUCH AS FOUNDATION, CONDUIT, HANDHOLE, TRENCH AND BACKFILL, ETC., AND NO EXTRA COMPENSATION SHALL BE ALLOWED. ALL ROADWAY SURFACES SUCH AS SHOULDERS, MEDIAN, SIDEWALKS, PAVEMENT, ETC. SHALL BE REPLACED IN KIND. ALL DAMAGE TO MOWED LAWNS SHALL BE REPLACED WITH AN APPROVED SOD, AND ALL DAMAGE TO UNMOWED FIELDS SHALL BE SEED IN ACCORDANCE WITH STANDARD SPECIFICATIONS 252 AND 250 RESPECTIVELY.

NOTE:
THE TRAFFIC SIGNAL CONTROLLER EQUIPMENT FOR THIS PROJECT SHALL BE "ECONOLITE" TO MATCH THE EXISTING ADJACENT SYSTEMS.

MATCH LINE SEE BELOW

MATCH LINE SEE ABOVE

APEX
CONSULTING ENGINEERS, LLC
111 E. Wacker Drive Suite 520
Chicago, IL 60601

FILE NAME =	USER NAME = #USER#	DESIGNED - WHI	REVISED -
#FILES#		DRAWN - WHI	REVISED -
	PLOT SCALE = #SCALE#	CHECKED - DEB	REVISED -
	PLOT DATE = #DATE#	DATE - 11/08/10	REVISED -

**STATE OF ILLINOIS
DEPARTMENT OF TRANSPORTATION**

**IL ROUTE 137 @ O'PLAINE ROAD
PROPOSED TRAFFIC SIGNAL MODERNIZATION PLAN**

F.A.P. RTE.	SECTION	COUNTY	TOTAL SHEETS	SHEET NO.
352	56N-4	LAKE	50	25
CONTRACT NO. 60K19			ILLINOIS FED. AID PROJECT	

SCALE: 1" = 20' SHEET NO. OF SHEETS STA. TO STA.