

MATCH LINE STA. 155+00 - SEE SHEET NO. 7

MATCH LINE STA. 170+00 - SEE BELOW LEFT

- LEGEND**
- EXISTING INLET
 - EXISTING CATCH BASIN
 - EXISTING MANHOLE
 - GVV GAS VALVE VAULT (ADJUSTMENTS PERFORMED BY OTHERS)
 - GBB GAS B-BOX (ADJUSTMENTS PERFORMED BY OTHERS)
 - EV ELECTRICAL VAULT (ADJUSTMENTS PERFORMED BY OTHERS)
 - T TELEPHONE (ADJUSTMENTS PERFORMED BY OTHERS)
 - WVV WATER VALVE VAULT (CITY OF CHICAGO)
 - SAN SANITARY (CITY OF CHICAGO)
 - ST STORM (CITY OF CHICAGO)
 - SP FRAMES AND LIDS TO BE ADJUSTED (SPECIAL)
 - C DRAINAGE STRUCTURES TO BE CLEANED
 - ADJ FRAMES AND LIDS TO BE ADJUSTED

NORTH AVE

NOTES:

1. SAW CUTTING PRIOR TO ANY REMOVAL ITEMS NOTED ON THE PLANS OR DIRECTED BY THE ENGINEER SHALL BE CONSIDERED INCLUDED IN THE COST OF THE ITEMS BEING REMOVED.
2. ALL PAVEMENT PATCHING LOCATIONS WILL BE DETERMINED BY THE RESIDENT ENGINEER.
3. ALL COMBINATION CONCRETE CURB AND GUTTER REMOVAL AND REPLACEMENT WILL BE DETERMINED BY THE RESIDENT ENGINEER.
4. THE CONTRACTOR SHALL USE CARE IN REMOVING OR EXCAVATING NEAR ALL EXISTING ITEMS WHICH WILL REMAIN. ANY DAMAGE DONE TO EXISTING ITEMS BY THE CONTRACTOR SHALL BE REPAIRED AT THE CONTRACTOR'S EXPENSE.
5. PAY ITEM X5539700 - STORM SEWERS TO BE CLEANED - SHALL ONLY BE UTILIZED TO CLEAN STORM SEWER LATERAL PIPES BETWEEN INLETS OR CATCH BASINS AND THE MAIN SEWER ONLY AT THE STRUCTURES SHOWN TO BE CLEANED AS INDICATED BY [C].
6. THE CONTRACTOR SHALL CONTACT PAUL LABUZ, THE CHICAGO DEPARTMENT OF TRANSPORTATION PROJECT MANAGER, AT (312) 744-3831 PRIOR TO THE RAILROAD TRACK REMOVAL ON KINGSBURY STREET TO COORDINATE REMOVAL WITH THE RECONSTRUCTION PROJECT ON KINGSBURY STREET.

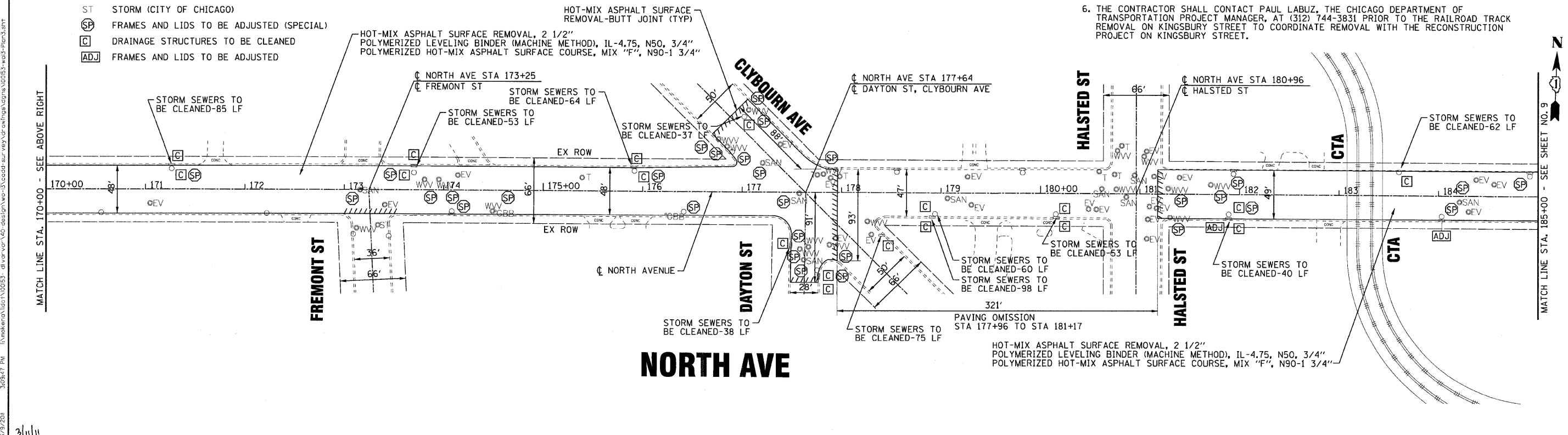

MATCH LINE STA. 170+00 - SEE ABOVE RIGHT

MATCH LINE STA. 185+00 - SEE SHEET NO. 9

NORTH AVE

COPYRIGHT © 2011 BY BAXTER & WOODMAN, INC.
 LICENSE NO. 044-00121 - EXPIRES 4/30/2018
 488ccc
 3/9/2011

	DESIGNED - CAC	REVISED - PER IDOT 2-3-11	STATE OF ILLINOIS DEPARTMENT OF TRANSPORTATION	NORTH AVENUE MILWAUKEE AVENUE TO CLARK STREET ROADWAY PLAN		F.A.P. RTE. 307	SECTION 2010-140-RS	COUNTY COOK	TOTAL SHEETS 29	SHEET NO. 8
	DRAWN - BCD	REVISED - PER CDOT 2-18-11		SCALE: 1" = 50'	STA. 155+00 TO STA. 185+00	CONTRACT NO. 60N19 FED. ROAD DIST. NO. 1 ILLINOIS FED. AID PROJECT				
	CHECKED - RWL	FILE - 100153-w013-Plan3.sht								