

INDEX OF SHEETS

- SHEET NO.
- COVER SHEET
 - LEGEND, GENERAL NOTES
 - SUMMARY OF QUANTITIES
 - 65TH STREET PLAN (WILLOW LANE TO CASS AVENUE)
 - 59TH STREET PLAN (TIMBER RIDGE COURT TO RICHMOND AVENUE)
 - TRAUBE AVENUE PLAN (ROSLYN ROAD TO PARK STREET)
 - LINCOLN STREET PLAN (NAPERVILLE ROAD TO STA. 9+36)
 - 60TH STREET PLAN (FAIRVIEW AVENUE TO STA. 12+00)
 - 60TH STREET PLAN (STA. 12+00 TO 23+00)
 - 60TH STREET PLAN (STA. 23+00 TO WILLIAMS STREET)
 - 63RD STREET (RIDGE ROAD TO STA. 10+75)
 - 63RD STREET (STA. 10+75 TO RICHMOND AVENUE)
 - MISCELLANEOUS DETAILS
 - MISCELLANEOUS DETAILS
 - MISCELLANEOUS DETAILS
 - BD-01: DRIVEWAY DETAILS - DISTANCE BETWEEN R.O.W. AND FACE OF CURB & EDGE OF SHOULDER \geq 15' (4.5M)
 - BD-02: DRIVEWAY DETAILS DISTANCE BETWEEN ROW AND FACE OF CURB < 15' (4.5M)
 - BD-22: PAVEMENT PATCHING FOR HMA SURFACED PAVEMENT
 - BD-32: BUTT JOINT AND HMA TAPER DETAILS
 - TC-10: TRAFFIC CONTROL AND PROTECTION FOR SIDE ROADS, INTERSECTIONS, AND DRIVEWAYS
 - TC-13: DISTRICT ONE TYPICAL PAVEMENT MARKINGS
 - 60TH STREET CROSS SECTIONS

CONTACT

VILLAGE OF WESTMONT
ENGINEERING DIVISION
CONTACT: NORIEL NORIEGA
OFFICE: 630-981-6295
FAX: 630-829-4479
24 HR: 630-968-2151

BURNS & MCDONNELL
CONTACT: ANTHONY BRYANT
OFFICE: 630-724-3200
FAX: 630-724-3201

DUDOT
CONTACT: ROBERT KOLAR
OFFICE: 630-407-6900
FAX: 630-407-6901

HIGHWAY STANDARDS

- 000001-06 STANDARD SYMBOL, ABBREVIATIONS AND PATTERNS
- 424001-05 CURB RAMPS FOR SIDEWALKS
- 542301-03 PRECAST REINFORCED CONCRETE FLARED END
- 542401-01 METAL END SECTION FOR PIPE CULVERTS
- 602001-02 CATCH BASIN TYPE A
- 602011-02 CATCH BASIN TYPE C
- 604021-02 BASE, FRAME AND LIDS TYPE 5
- 701801-04 LANE CLOSURE, MULTILANE, 1W OR 2W CROSSWALK OR SIDEWALK CLOSURE
- 701901-01 TRAFFIC CONTROL DEVICES

TRAFFIC DATA 2010

59TH STREET ADT = 3,950
POSTED SPEED LIMIT = 25 MPH

63rd STREET ADT = <25,000
POSTED SPEED LIMIT = 40 MPH

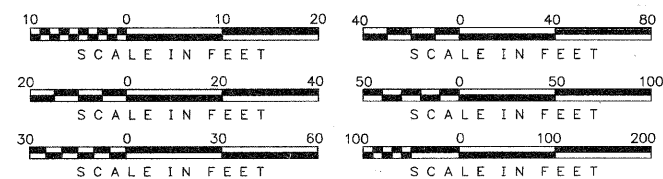

FULL SIZE PLANS HAVE BEEN PREPARED USING STANDARD ENGINEERING SCALES, REDUCED SIZED PLANS WILL NOT CONFORM TO STANDARD SCALES, IN MAKING MEASUREMENT ON REDUCED PLANS, THE ABOVE SCALES MAY BE USED.

CONTRACT NO.: 63132

LENGTH OF PROJECT

PROJECT LENGTH GROSS = 1.13 MILES (5944 FT.)
NET = 1.00 MILES (5304 FT.)

DESIGN DESIGNATION - SIDEWALK



STATE OF ILLINOIS
DEPARTMENT OF TRANSPORTATION
DIVISION OF HIGHWAYS

**PLANS FOR PROPOSED
FEDERAL AID HIGHWAY**

59th Street, 60th Street, 63rd Street, 65th Street, Traube Avenue, Lincoln Street

SECTION NO.: 08-00098-00-SW

PROJECT NO.: CMM-8003 (956)

SIDEWALKS

VILLAGE OF WESTMONT

DU PAGE COUNTY

JOB NO.: C-91-213-08

PROJECT LOCATION
STA. 1+12 TO STA. 27+00

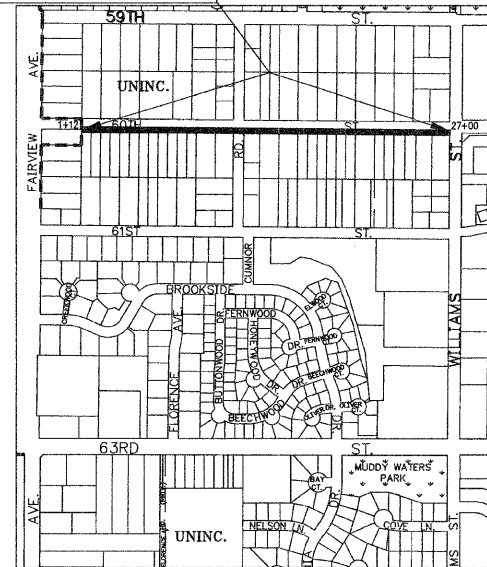

PROJECT LOCATION
STA. 2+26 TO STA. 4+23

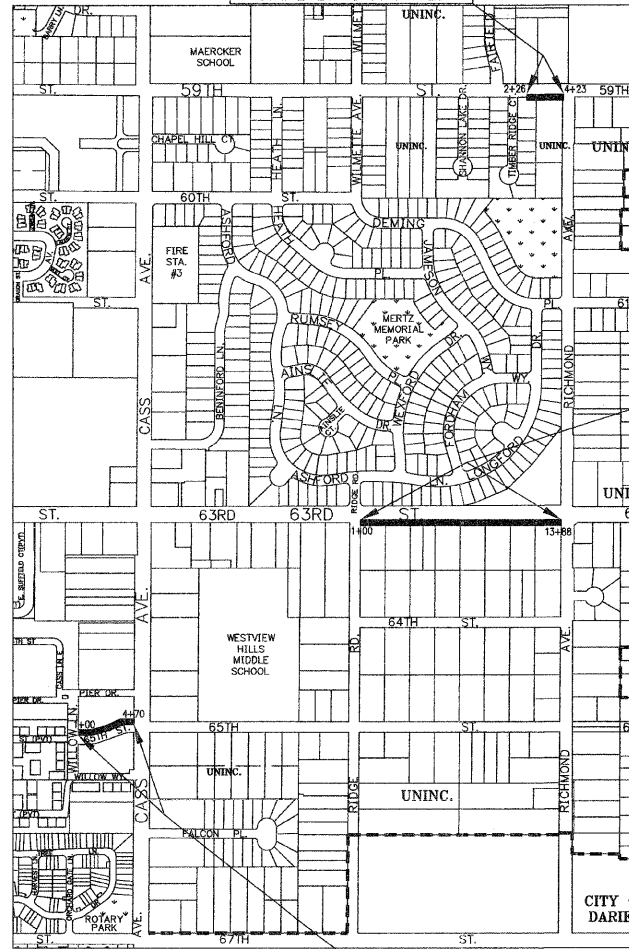

PROJECT LOCATION
STA. 1+00 TO STA. 7+45

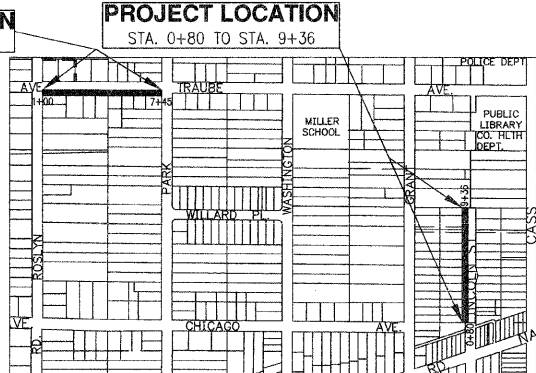

PROJECT LOCATION
STA. 0+80 TO STA. 9+36

PROJECT LOCATION
STA. 1+00 TO STA. 13+88

PROJECT LOCATION
STA. 1+00 TO STA. 4+70

TOWNSHIP: 38 NORTH, DOWNERS GROVE TOWNSHIP
RANGE: 11 WEST, 3RD P.M.



F.A.P. RTE.	SECTION	COUNTY	TOTAL SHEETS	SHEET NO.
08-00098-00-SW	DUPAGE	ILLINOIS	22	1
FEDERAL RD. DIST. NO.		FEDERAL AID PROJECT		
CONTRACT: 63132				

CALL
J.U.L.I.E.
BEFORE YOU DIG
1-800-892-0123



LOCATION OF SECTION INDICATED THIS: - [Symbol]

STATE OF ILLINOIS
DEPARTMENT OF TRANSPORTATION
DIVISION OF HIGHWAYS

Approved: *[Signature]* MARCH 3, 2011
WESTMONT VILLAGE ENGINEER

Passed: MARCH 4, 2011, 2011
[Signature]
District Engineer of Local Roads & Streets

Releasing for Bid Based on Limited Review: MARCH 4, 2011, 2011
[Signature]
Deputy of Highways, Region 1 Engineer

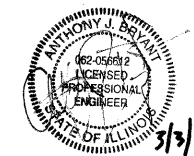

ANTHONY J. BRYANT, P.E.
NO. 062-056612
EXP. DATE: 11/30/2011

**PRINTED BY THE AUTHORITY
OF THE STATE OF ILLINOIS**



IL DESIGN FIRM NO.
184-001310

PLAN	SURVEYED	DATE
	PLOTTED	
	GRADES CHECKED	
	STRUCTURE NOTATIONS CHECKED	
	NO. _____	

PROFILE	SURVEYED	DATE
	PLOTTED	
	GRADES CHECKED	
	STRUCTURE NOTATIONS CHECKED	
	NO. _____	

- LEGEND**
- x— EXISTING FENCE
 - - - EXISTING R.O.W.
 - o— PROPOSED FENCE
 - - - - - LIMITS OF TOP SOIL AND SOD
 - ~~~~~ TREE LINE
 - ⊗ LIGHT POLE
 - ⊠ ET ELECTRIC TRANSFORMER
 - ⊠ ET ELECTRICAL TRANSFORMER W/CONC. PAD
 - ⊕ TRAFFIC SIGNAL
 - ⊠ POWER POLE
 - * GUY WIRE
 - ⊠ TELEPHONE PEDESTAL
 - ⊠ HANDHOLE
 - ⊠ FIRE HYDRANT
 - ⊠ LANDSCAPE STONE
 - ⊠ STORM SEWER INLET
 - ⊠ TREE STUMP
 - ⊗ TREE OR SHRUB
 - (FOUND) ○ PROPERTY PIPE (FOUND)
 - ⊠ SIGN
 - PK1 ⊠ CONTROL POINT (PK-NAIL)
 - ⊠ BM BENCHMARK

CONTRACTOR SHALL MILL BEFORE PATCHING.

HOT-MIX ASPHALT MIXTURE REQUIREMENTS	
MIXTURE TYPE	AIR VOIDS @ Ndes
DRIVEWAYS	
HMA SURFACE COURSE, MIX C, N 50 (IL 9.5 mm); 2"	4% @ 50 GYR
HMA BASE COURSE (HMA BINDER IL-19 mm); PE - 6", CE - 8"	4% @ 50 GYR
PATCHING	
CLASS D PATCHES (HMA BINDER IL-19 mm)	4% @ 70 GYR
HMA SURFACE COURSE, MIX C, N50 (IL-9.5 mm) 2"	4% @ 50 GYR

THE UNIT WEIGHT USED TO CALCULATE ALL HMA SURFACE MIXTURE QUANTITIES IS 112 LBS/SQ YD/IN.
 THE "AC" TYPE FOR POLYMERIZED HMA MIXES SHALL BE "SBS/SBR PG 70-22" AND FOR NON-POLYMERIZED HMA THE "AC TYPE" SHALL BE "PG 64-22" UNLESS MODIFIED BY DISTRICT ONE SPECIAL PROVISIONS. FOR "PERCENT OF RAP" SEE DISTRICT ONE SPECIAL PROVISIONS

EARTHWORK SCHEDULE				
LOCATION	REMOVAL AND DISPOSAL OF UNSUITABLE MATERIAL (CU. YD.)	TOPSOIL FURNISH AND PLACE, 4" (SQ. YD.)	FURNISHED EXCAVATION (CU. YD.)	POROUS GRANULAR EMBANKMENT (SUBGRADE) (CU. YD.)
<u>65th STREET</u> STA. 1+00 TO STA. 4+70	60	170	0	0
<u>59th STREET</u> STA. 2+26 TO STA. 4+23	30	215	0	0
<u>TRAUBE AVENUE</u> STA. 1+00 TO STA. 7+45	100	700	0	0
<u>LINCOLN STREET</u> STA. 0+80 TO STA. 9+36	125	765	0	0
<u>60th STREET</u> STA. 1+12 TO STA. 27+00	320	2090	1105	108
<u>63rd STREET</u> STA. 1+00 TO STA. 13+88	190	1540	757	0
TOTAL	825	5,480	1862	108

DISTRICT ONE DETAILS:

- BD-01 DRIVEWAY DETAILS DISTANCE BETWEEN R.O.W. AND FACE OF CURB/EDGE OF SHOULDER \geq 15'
- BD-02 DRIVEWAY DETAILS DISTANCE BETWEEN ROW AND FACE OF CURB < 15' (4.5M)
- BD-22 PAVEMENT PATCHING FOR HMA SURFACED PAVEMENT
- BD-32 BUTT JOINT AND HMA TAPER DETAILS
- TC-10 TRAFFIC CONTROL AND PROTECTION FOR SIDE ROADS, INTERSECTIONS, AND DRIVEWAYS
- TC-13 DISTRICT ONE TYPICAL PAVEMENT MARKINGS

EROSION CONTROL PLAN

- EROSION CONTROL ITEMS ARE CONSIDERED TO BE HIGH PRIORITY ITEMS ON THIS CONTRACT. THE ENGINEER WILL IMPLEMENT ALL PROVISIONS OF THE SPECIFICATION NECESSARY TO ASSURE THAT EROSION CONTROL ITEMS ARE CONSTRUCTED AND MAINTAINED IN A TIMELY WAY. ALL EROSION CONTROL MEASURES SHALL BE INSTALLED PRIOR TO BEGINNING OF ANY CONSTRUCTION ACTIVITIES WHICH WILL POTENTIALLY CREATE ERODABLE CONDITIONS.
- THE EROSION CONTROL MEASURES SHOWN ARE BUT A GRAPHICAL REPRESENTATION OF SUGGESTED MEASURES. DEVIATIONS FROM THIS PLAN ARE TO BE EXPECTED PENDING A JOBSITE INSPECTION BETWEEN THE CONTRACTOR AND THE DEPARTMENT.

GENERAL NOTES

- THE CONTRACTOR SHALL NOTIFY J.U.L.I.E. (800-892-0123) AT LEAST 48 HOURS PRIOR TO CONSTRUCTION FOR LOCATIONS OF UTILITIES, AND SHALL BE RESPONSIBLE FOR THE PROTECTION OF THE SAME.
- THE CONTRACTOR SHALL NOTIFY THE DUPAGE COUNTY DIVISION OF TRANSPORTATION (630-682-7318) A MINIMUM OF 48 HOURS PRIOR TO THE START OF CONSTRUCTION WITHIN THE COUNTY'S RIGHT OF WAY AND WITHIN 300' OF ANY COUNTY MAINTAINED SIGNAL. TRAFFIC SIGNALS AND RELATED EQUIPMENT ARE NOT ON THE J.U.L.I.E. SYSTEM.
- THE CONTRACTOR SHALL NOTIFY THE ENGINEER AND THE VILLAGE OF WESTMONT AT LEAST 48 HOURS IN ADVANCE OF CONSTRUCTION. NO UNDERGROUND WORK SHALL BE COVERED UNTIL IT HAS BEEN INSPECTED. APPROVAL TO PROCEED MUST BE OBTAINED FROM THE ENGINEER PRIOR TO POURING CONCRETE AFTER FORMS HAVE BEEN SET. THE CONTRACTOR IS RESPONSIBLE FOR OBTAINING ALL NECESSARY PERMITS, IN ACCORDANCE WITH ARTICLE 107.04.
- CONTRACTORS ARE CAUTIONED AGAINST INSTITUTING ANY CHANGES AND/OR SUBSTITUTIONS TO THE PROJECT REPRESENTED BY THESE DRAWINGS WITHOUT PRIOR WRITTEN APPROVAL BY THE ENGINEER. VISUAL CONTACT WITH THESE DRAWINGS SHALL CONSTITUTE CONCLUSIVE EVIDENCE OF ACCEPTANCE OF THESE RESTRICTIONS.
- WRITTEN DIMENSIONS ON THESE DRAWINGS SHALL TAKE PRECEDENCE OVER SCALED DIMENSIONS. CONTRACTORS SHALL VERIFY AND BE RESPONSIBLE FOR ALL ELEVATIONS, DIMENSIONS, AND CONDITIONS ON THE JOB. THE ENGINEER SHALL BE NOTIFIED AS SOON AS POSSIBLE OF ANY VARIATIONS FROM THE DIMENSIONS AND CONDITIONS SHOWN ON THESE DRAWINGS.
- ANY DELAY OR EXTRA COST TO THE CONTRACTOR CAUSED BY PIPELINES OR OTHER UNDERGROUND STRUCTURES OR OBSTRUCTIONS WHICH ARE NOT SHOWN ON THE DRAWINGS OR FOUND IN LOCATIONS DIFFERENT FROM THOSE INDICATED, SHALL BE IN ACCORDANCE WITH ARTICLE 105.07(b) AND 107.31.
- THE CONTRACTOR SHALL BE RESPONSIBLE FOR THE PROTECTION OF ALL PUBLIC AND PRIVATE UTILITIES, EVEN THOUGH THEY MAY NOT BE SHOWN ON THE DRAWINGS. ANY UTILITY DAMAGES DURING CONSTRUCTION SHALL BE REPAIRED OR REPLACED TO THE SATISFACTION OF THE OWNER AT THE CONTRACTOR'S EXPENSE.
- THE CONTRACTOR SHALL BE RESPONSIBLE FOR REMOVING IMMEDIATELY ALL MUD, DIRT, OR DEBRIS DEPOSITED ON ROADWAYS FROM ANY VEHICLES EXITING OR ENTERING THE SITE.
- IT IS THE CONTRACTOR'S RESPONSIBILITY TO GUARD AND PROTECT NEWLY POURED CONCRETE AGAINST ANY FOREIGN MARKINGS, GRAFFITI OR OTHER DAMAGE, AND AT HIS EXPENSE, REPLACE ALL SIDEWALK NOT ACCEPTABLE TO THE ENGINEER.
- ON 63rd STREET DAILY LANE CLOSURES ARE PERMITTED BETWEEN 9:00 A.M. AND 4:00 P.M. ONLY. OTHER LANE CLOSURES SHALL BE RESTRICTED TO THE HOURS OF 8:00 A.M. TO 5:00 P.M. ALL LANES SHALL BE KEPT OPEN FOR THE REMAINING PART OF EVERYDAY. DAILY LANE CLOSURES ON 63rd STREET REQUIRE DUPAGE COUNTY APPROVAL.
- TRAFFIC CONTROL SHALL CONFORM TO IDOT'S HIGHWAY STANDARDS AND THE "MANUAL ON UNIFORM TRAFFIC CONTROL DEVICES FOR STREETS AND HIGHWAYS" AT ALL TIMES DURING CONSTRUCTION. TRAFFIC CONTROL SHALL INCLUDE ADVANCE WARNING LANE CLOSURE SIGNAGE, AN ARROW BOARD AND TYPE I BARRICADES WITH SANDBAGS.
- THE CONTRACTOR SHALL COORDINATE CONSTRUCTION ACTIVITIES WITH UTILITY COMPANIES AND THE VILLAGE OF WESTMONT.
- ALL TREE PROTECTION, TREE REMOVAL, PRUNING AND ROOT PRUNING SHALL BE COMPLETED BEFORE CONSTRUCTION OPERATIONS COMMENCE IN ANY AREA. AT NO TIME SHALL THE CONTRACTOR PRUNE OR REMOVE ANY TREES UNLESS SPECIFICALLY DIRECTED BY THE ENGINEER.
- THE CONTRACTOR SHALL ERECT A TEMPORARY FENCE ALONG THE DRIP LINE OF ALL EXISTING TREES TO REMAIN WITHIN THE CONSTRUCTION AREA TO ESTABLISH A "TREE PROTECTION ZONE" BEFORE ANY WORK BEGINS OR ANY MATERIAL IS DELIVERED TO THE JOBSITE. NO WORK IS TO BE PERFORMED (OTHER THAN ROOT PRUNING), MATERIALS STORED OR VEHICLES DRIVEN OR PARKED WITHIN THE "TREE PROTECTION ZONE." REMOVE PROTECTION TEMPORARY FENCE ONLY AFTER ALL CONSTRUCTION WORK HAS BEEN COMPLETED.
- TREE ROOT PRUNING IS TO BE USED ON EXISTING TREES TO PREVENT THE RIPPING UP OF ROOTS WHEN TRENCHING OR EXCAVATION IS WITHIN THE ROOT ZONE OF ADJACENT TREES TO REMAIN. SUPPLEMENTAL WATERING AND FERTILIZING OF TREES SHOULD BEGIN WITHIN 48 HOURS AFTER ROOT PRUNING OF THE TREES HAS OCCURED.

NOTE:
 PROVIDE THERMOPLASTIC PAVEMENT MARKING TO PEDESTRIAN CROSSWALK AT THE FOLLOWING INTERSECTIONS:

- 59th STREET
105 L.F. THERMOPLASTIC PAVEMENT MARKING-LINE, 6" WHITE
- TRAUBE AVENUE
100 L.F. THERMOPLASTIC PAVEMENT MARKING-LINE, 6" WHITE
- 63rd STREET
75 L.F. THERMOPLASTIC PAVEMENT MARKING-LINE, 6" WHITE

DATUM
 ILLINOIS EAST STATE PLANE COORDINATES
 NAD83
 NAVD88

FILE NAME =	USER NAME =	DESIGNED - MB	REVISED -	STATE OF ILLINOIS DEPARTMENT OF TRANSPORTATION	F.A.U. RTE.	SECTION	COUNTY	TOTAL SHEETS	SHEET NO.
		DRAWN - MB	REVISED -		-	08-00098-00-SW	DUPAGE	22	2
		CHECKED - AJB	REVISED -		SIDEWALK PROJECT		CONTRACT NO. 63132		
		DATE - 10/29/2008	REVISED -		FED. ROAD DIST. NO. 1 (ILLINOIS) FED. AID PROJECT				

PLAN SURVEYED BY DATE
 PLOTTED BY CHECKED
 NOTE BOOK NO. OF WAY CHECKED
 NO. CADD FILE NAME

PROFILE SURVEYED BY DATE
 PLOTTED BY CHECKED
 NOTE BOOK NO. OF WAY CHECKED
 NO. STRUCTURE NO. STATUS CHG

SUMMARY OF QUANTITIES						
SP	SI	CONSTRUCTION TYPE CODE	CODE NO	ITEM	UNIT	TOTAL
*		0031	20100110	TREE REMOVAL (6 TO 15 UNITS DIAMETER)	UNIT	24
*		0031	20100210	TREE REMOVAL (OVER 15 UNITS DIAMETER)	UNIT	30
		0031	20101000	TEMPORARY FENCE	FOOT	997
*		0031	20101200	TREE ROOT PRUNING	EACH	34
*		0031	20101300	TREE PRUNING (1 TO 10 INCH DIAMETER)	EACH	23
*		0031	20101350	TREE PRUNING (OVER 10 INCH DIAMETER)	EACH	12
*		0021	20201200	REMOVAL AND DISPOSAL OF UNSUITABLE MATERIAL	CU YD	825
		0021	20400800	FURNISHED EXCAVATION	CU YD	1862
		0021	20700220	POROUS GRANULAR EMBANKMENT	CU YD	108
		0021	20800150	TRENCH BACKFILL	CU YD	57
*		0031	21101615	TOPSOIL FURNISH AND PLACE, 4"	SQ YD	5480
*		0031	25000400	NITROGEN FERTILIZER NUTRIENT	POUND	85
*		0031	25000600	POTASSIUM FERTILIZER NUTRIENT	POUND	85
*		0031	25200110	SODDING, SALT TOLERANT	SQ YD	5480
*		0031	25200200	SUPPLEMENTAL WATERING	UNIT	55
		0043	28100105	STONE RIPRAP, CLASS A3	SQ YD	25
		0043	28200200	FILTER FABRIC	SQ YD	25
		0004	35501308	HOT-MIX ASPHALT BASE COURSE, 6"	SQ YD	1091
		0004	40600982	HOT-MIX ASPHALT SURFACE REMOVAL - BUTT JOINT	SQ YD	20
		0004	40801005	HOT-MIX ASPHALT REPLACEMENT OVER PATCHES	TON	0.2
		0004	40803310	HOT-MIX ASPHALT SURFACE COURSE, MIX "C", N 50	TON	119
		0004	42300300	PORTLAND CEMENT CONCRETE DRIVEWAY PAVEMENT, 7 INCH	SQ YD	344
		0021	42400200	PORTLAND CEMENT CONCRETE SIDEWALK 5 INCH	SQ FT	25735
		0021	42400400	PORTLAND CEMENT CONCRETE SIDEWALK 7 INCH	SQ FT	785
		0021	42400800	DETECTABLE WARNINGS	SQ FT	175
		0004	44000100	PAVEMENT REMOVAL	SQ YD	40
		0004	44000157	HOT-MIX ASPHALT SURFACE REMOVAL, 2"	SQ YD	125
		0004	44000200	DRIVEWAY PAVEMENT REMOVAL	SQ YD	1781
*		0004	44000500	COMBINATION CURB & GUTTER REMOVAL	FOOT	27
		0021	44000600	SIDEWALK REMOVAL	SQ FT	40
		0004	44201723	CLASS D PATCHES, TYPE M, 6 INCH	SQ YD	114
		0004	50104400	CONCRETE HEADWALL REMOVAL	EACH	2
		0043	50105220	PIPE CULVERT REMOVAL	FOOT	147
		0043	54213447	END SECTIONS 12"	EACH	10
		0043	54213450	END SECTIONS 15"	EACH	2
		0043	54213453	END SECTIONS 18"	EACH	2
		0043	54213657	PRECAST REINFORCED CONCRETE FLARED END SECTIONS 12"	EACH	7
		0043	54213681	PRECAST REINFORCED CONCRETE FLARED END SECTIONS 36"	EACH	2
		0043	542A0217	PIPE CULVERTS, CLASS A, TYPE 1 12"	FOOT	318
		0043	542A0241	PIPE CULVERTS, CLASS A, TYPE 1 36"	FOOT	68
		0043	542D0220	PIPE CULVERTS, CLASS D, TYPE 1 15"	FOOT	29
		0043	542D0223	PIPE CULVERTS, CLASS D, TYPE 1 18"	FOOT	35
		0043	550B0050	STORM SEWERS, CLASS B, TYPE 1 12"	FOOT	156
		0043	55100400	STORM SEWER REMOVAL 10"	FOOT	8
*		0043	56500600	DOMESTIC WATER SERVICE BOXES TO BE ADJUSTED	EACH	2
		0043	60200105	CATCH BASINS, TYPE A, 4'-DIAMETER, TYPE 1 FRAME, OPEN LID	EACH	4
		0043	60207305	CATCH BASINS, TYPE C, TYPE 5 FRAME, OPEN LID	EACH	2
		0004	60803800	COMBINATION CONCRETE CURB AND GUTTER, TYPE B-5.12	FOOT	27
		0021	63200310	GUARDRAIL REMOVAL	FOOT	26
		0004	67100100	MOBILIZATION	L SUM	1
		0021	70102640	TRAFFIC CONTROL AND PROTECTION, STANDARD 701801	L SUM	1
*		0004	78000400	THERMOPLASTIC PAVEMENT MARKING - LINE 6"	FOOT	280

SUMMARY OF QUANTITIES						
SP	SI	CONSTRUCTION TYPE CODE	CODE NO	ITEM	UNIT	TOTAL
*		0031	B2000116	TREE, ACER CAMPESTRE (HEDGE MAPLE), 2" CALIPER, TREE FORM, BALLED AND BURLAPPED	EACH	1
*		0031	B2000216	TREE, ACER GINNALA (AMUR MAPLE), 2" CALIPER, TREE FORM, BALLED AND BURLAPPED	EACH	1
*		0031	B2006220	TREE, SYRINGA RETICULATA (JAPANESE TREE LILAC), 2-1/2" CALIPER, TREE FORM, BALLED AND BURLAPPED	EACH	1
*		0031	B2010016	TREE, AMELANCHIER CANADENSIS (SHADBLOW SERVICEBERRY), 2" CALIPER, TREE FORM, BALLED AND BURLAPPED	EACH	1
*		0031	K0026830	SHRUB REMOVAL	EACH	9
*		0021	X0325793	WOOD FENCE, TYPE 1	FOOT	45
*		0043	X0976500	END SECTIONS TO BE REMOVED	EACH	2
*		0021	X002133	RELOCATE SIGN AND BASE	EACH	1
*		0004	Z0013796	CONSTRUCTION LAYOUT	L SUM	1
*		0031	Z0023204	SEDIMENT CONTROL, SILT FENCE	FOOT	234

FILE NAME = USFR NAME = DESIGNED -- MB REVISION --
 DRAWN -- MP REVISION --
 PLOT SCALE = CHECKED -- AJB REVISION --
 PLOT DATE = DATE -- 10/29/2008 REVISION --

STATE OF ILLINOIS
 DEPARTMENT OF TRANSPORTATION

SCALE:

F.A.U. SECTION COUNTY TOTAL SHEETS SHEET NO.
 RTE. 08-00098-00-SW DUPAGE 22 3
 SIDEWALK PROJECT CONTRACT NO. 63132
 FED. ROAD DIST. NO. 1 ILLINOIS FED. AID PROJECT

PLAN	SURVEYED	DATE
	PLOTTED	
	CHECKED	
	BY	
	NO.	
	FILE NAME	

PROFILE	SURVEYED	DATE
	PLOTTED	
	CHECKED	
	BY	
	NO.	
	FILE NAME	

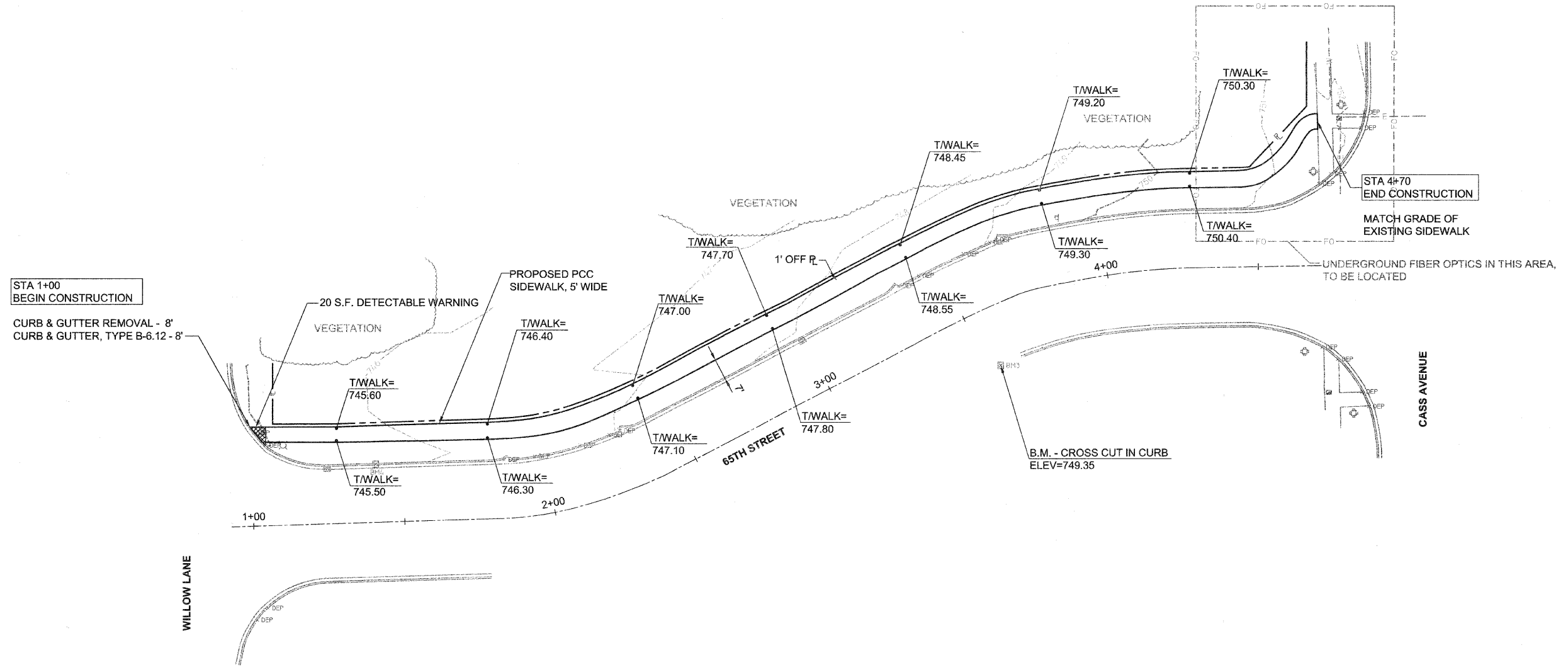

QUANTITIES THIS SHEET

- 1900 SF PCC SIDEWALK 5
- 60 CY REMOVAL AND DISPOSAL OF UNSUITABLE MATERIAL
- 170 SY TOPSOIL FURNISH AND PLACE, 4"
- 170 SY SODDING, SALT TOLERANT

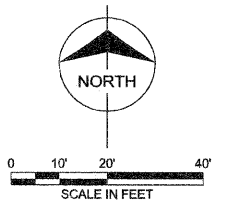

FILE NAME =	USER NAME =	DESIGNED -- MB	REVISED --	STATE OF ILLINOIS DEPARTMENT OF TRANSPORTATION	F.A.U. RTE.	SECTION	COUNTY	TOTAL SHEETS	SHEET NO.
		DRAWN -- MB	REVISED --		08-00098-00-SW	DUPAGE	22	4	
		CHECKED -- AUB	REVISED --		SIDEWALK PROJECT		CONTRACT NO. 63132		
		DATE -- 10/29/2008	REVISED --		FED. ROAD DIST. NO. 1 ILLINOIS FED. AID PROJECT				

DATE	
BY	
PLAN	
SURVEYED	
ALLOTTED	
NOTED	
RT. OF WAY CHECKED	
NO. _____	
NOTE BOOK	
CADD FILE NAME	

DATE	
BY	
PROFILE	
SURVEYED	
PLOTTED	
CHECKED	
NO. _____	
NOTE BOOK	
STRUCTURE NOTATIONS CHECKED	

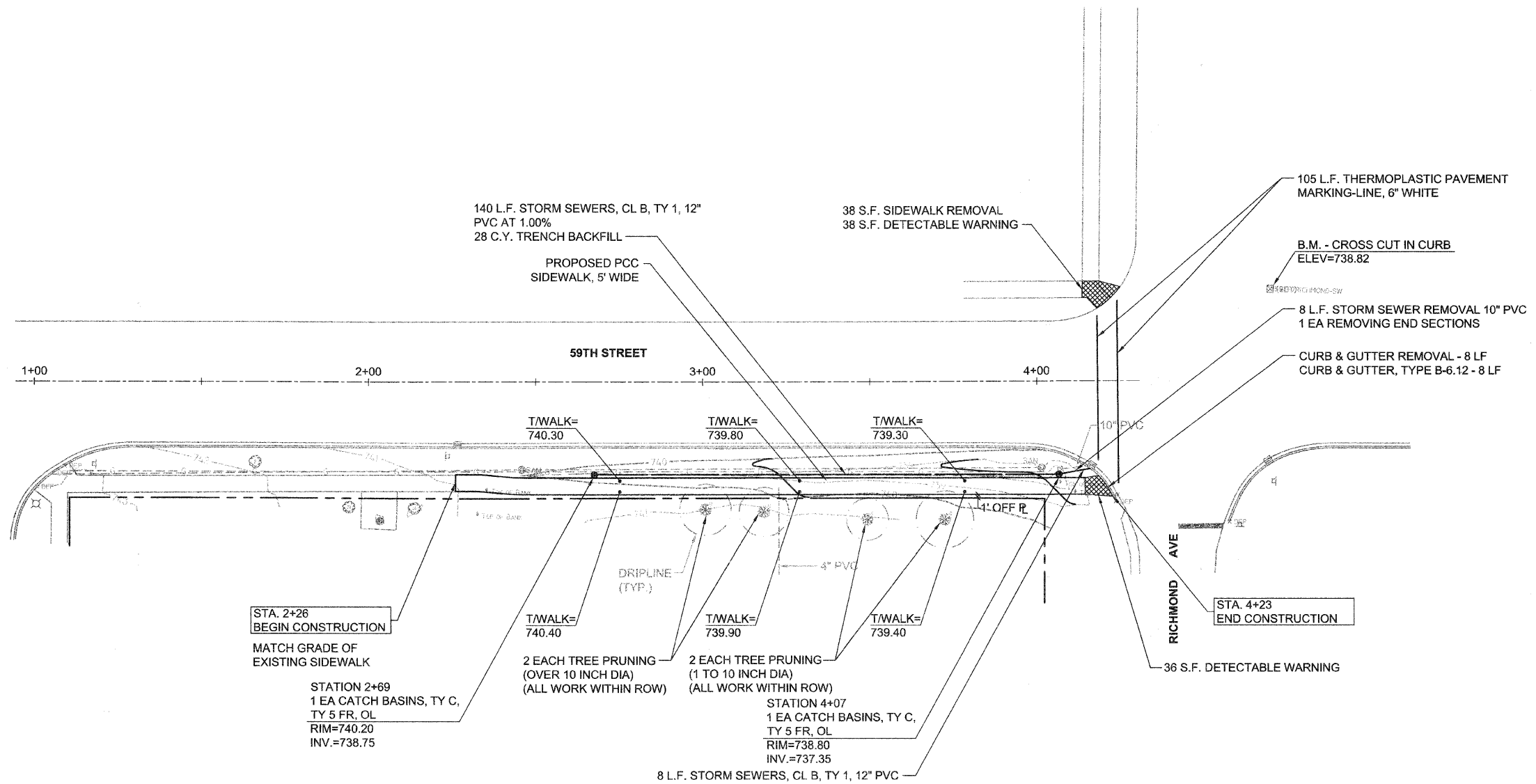

QUANTITIES THIS SHEET

- 950 SF PCC SIDEWALK 5
- 30 CY REMOVAL AND DISPOSAL OF UNSUITABLE MATERIAL
- 215 SY TOPSOIL FURNISH AND PLACE, 4"
- 215 SY SODDING, SALT TOLERANT

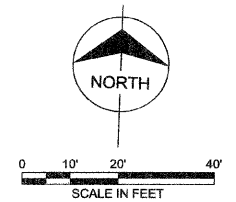

FILE NAME =	USER NAME =	DESIGNED - MB	REVISED -	STATE OF ILLINOIS DEPARTMENT OF TRANSPORTATION	SCALE:	F.A.U. RTE.	SECTION	COUNTY	TOTAL SHEETS	SHEET NO.	
		DRAWN - MB	REVISED -			-	08-00098-00-SW	DUPAGE	22	5	
		CHECKED - A.C.B.	REVISED -			SIDEWALK PROJECT		CONTRACT NO. 63132			
		DATE - 10/29/2008	REVISED -			FED. ROAD DIST. NO. 1 ILLINOIS FED. AID PROJECT					

PLAN	SURVEYED	DATE
	PLOTTED	
	ALIGNED	
	CHECKED	
	BY	
	NO. OF WAY CHECKED	
	CADD FILE NAME	
	NO.	

PROFILE	SURVEYED	DATE
	PLOTTED	
	ALIGNED	
	CHECKED	
	BY	
	NO. OF WAY CHECKED	
	CADD FILE NAME	
	NO.	

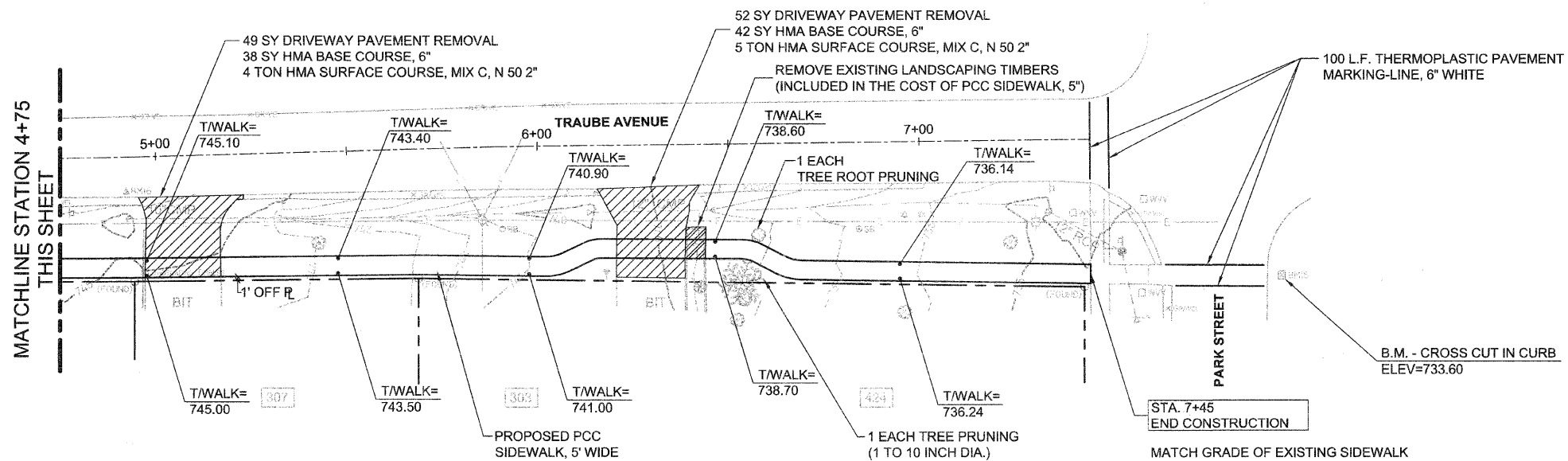
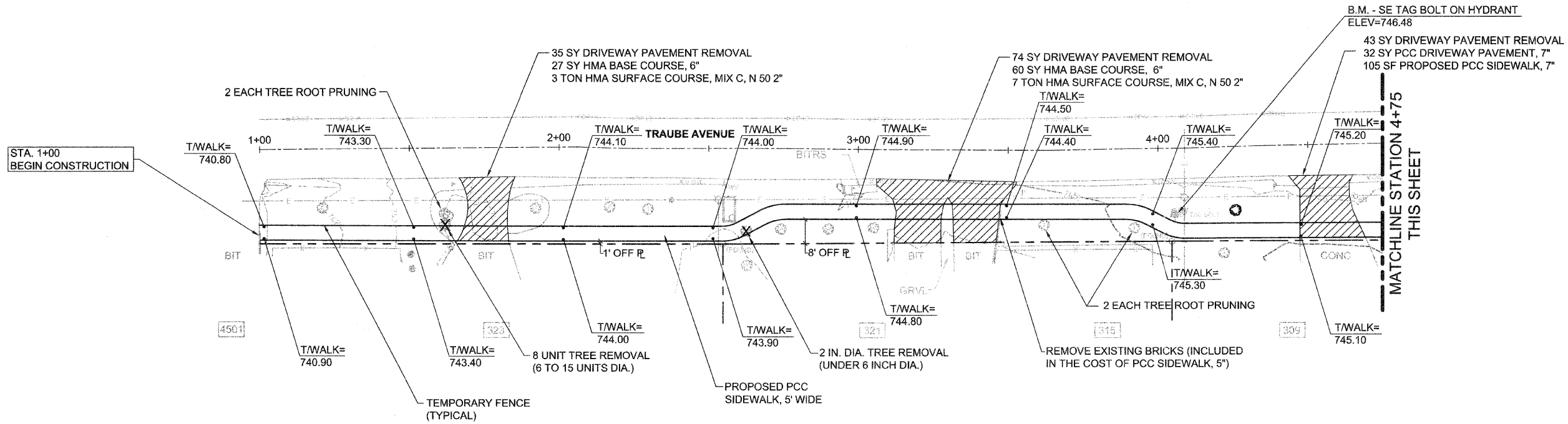

QUANTITIES THIS SHEET

- 3225 SF PCC SIDEWALK 5
- 100 CY REMOVAL AND DISPOSAL OF UNSUITABLE MATERIAL
- 700 SY TOPSOIL FURNISH AND PLACE, 4"
- 700 SY SODDING, SALT TOLERANT
- 330 LF TEMPORARY FENCE

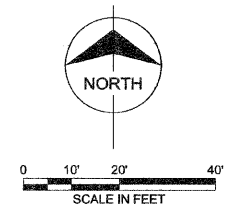

FILE NAME =	USER NAME =	DESIGNED -- MB	REVISED --
		DRAWN -- MB	REVISED --
		CHECKED -- A.B.	REVISED --
		DATE -- 10/29/2008	REVISED --

**STATE OF ILLINOIS
DEPARTMENT OF TRANSPORTATION**

SCALE:

F.A.U. RTE.	SECTION	COUNTY	TOTAL SHEETS	SHEET NO.
-	08-0098-00-SW	DUPAGE	22	6
SIDEWALK PROJECT		CONTRACT NO. 63132		
FED. ROAD DIST. NO. 1 ILLINOIS FED. AID PROJECT				

DATE	
BY	
PLAN	
REVISIONS	
NO.	
DATE	
BY	
DESCRIPTION	

DATE	
BY	
PROFILE	
REVISIONS	
NO.	
DATE	
BY	
DESCRIPTION	

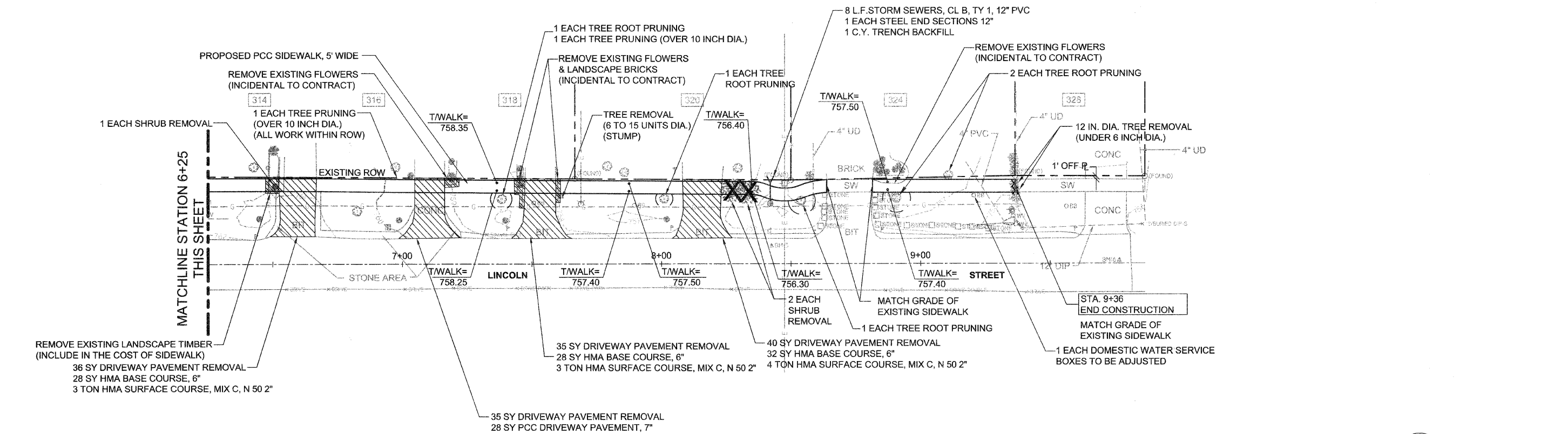
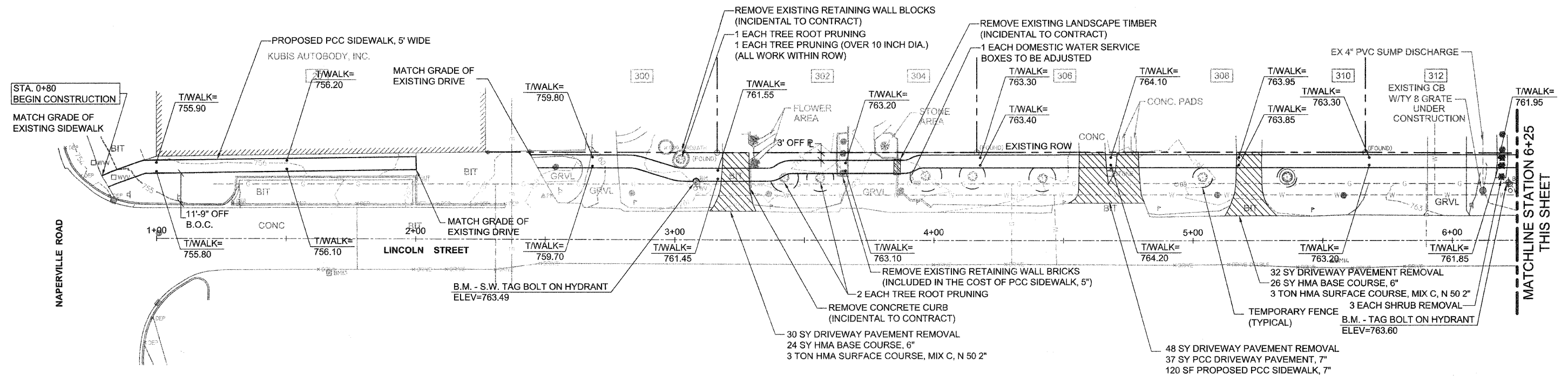

QUANTITIES THIS SHEET

- 3995 SF PCC SIDEWALK 5
- 125 CY REMOVAL AND DISPOSAL OF UNSUITABLE MATERIAL
- 765 SY TOPSOIL FURNISH AND PLACE, 4"
- 765 SY SODDING, SALT TOLERANT
- 227 LF TEMPORARY FENCE

NOTE
ALL TREE PRUNING SHALL BE WITHIN THE EXISTING RIGHT-OF-WAY.

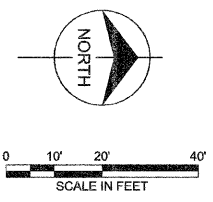

FILE NAME =	USER NAME =	DESIGNED -- VB	REVISED --	STATE OF ILLINOIS DEPARTMENT OF TRANSPORTATION	SCALE:	F.A.U. R.T.E. =	SECTION =	COUNTY =	TOTAL SHEETS =	SHEET NO. =	
		DRAWN -- VB	REVISED --			-	08-00098-00-SW	DUPAGE	22	7	
		CHECKED -- AJB	REVISED --			SIDEWALK PROJECT CONTRACT NO. 63132					
		DATE -- 10/29/2008	REVISED --			FED. ROAD DIST. NO. 1 [ILLINOIS] FED. AID PROJECT					

DATE	
BY	
PLAN	
SURVEYED	
GRADES CHECKED	
ALTIMETER CHECKED	
NOTE BOOK	
NO. OF WAY CHECKED	
NO. OF FILE NAME	

DATE	
BY	
PROFILE	
SURVEYED	
GRADES CHECKED	
ALTIMETER CHECKED	
NOTE BOOK	
NO. OF WAY CHECKED	
NO. OF FILE NAME	

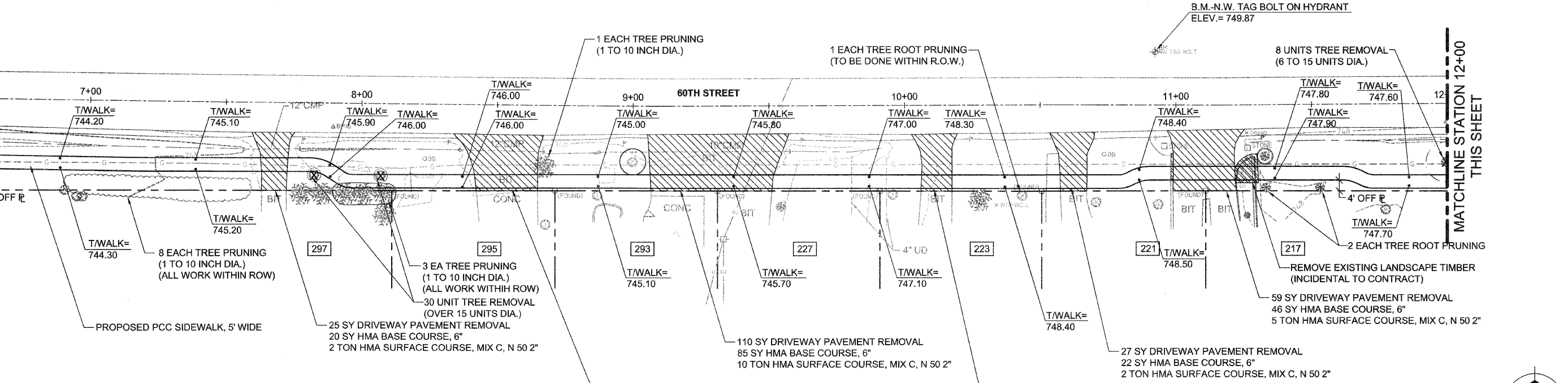
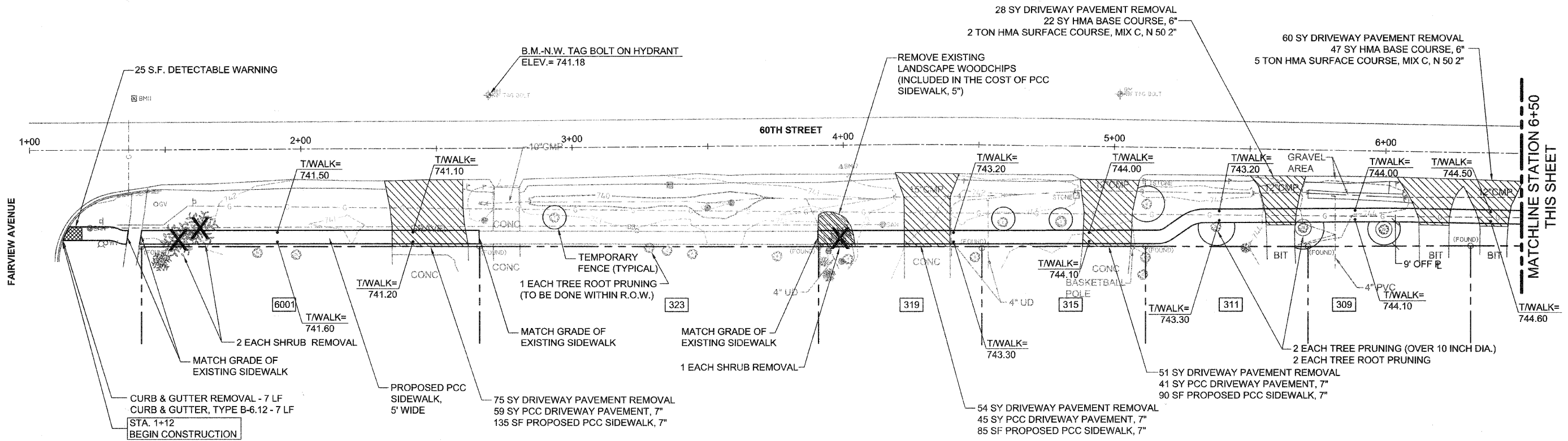

QUANTITIES THIS SHEET

- 4830 SF PCC SIDEWALK 5
- 145 CY REMOVAL AND DISPOSAL OF UNSUITABLE MATERIAL
- 890 SY TOPSOIL FURNISH AND PLACE, 4"
- 890 SY SODDING, SALT TOLERANT
- 390 SF FENCE TEMPORARY

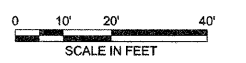

FILE NAME =	USER NAME =	DESIGNED -- MB	REVISED --	STATE OF ILLINOIS DEPARTMENT OF TRANSPORTATION	SCALE:	F.A.U. R.E.	SECTION	COUNTY	TOTAL SHEETS	SHEET NO.
		DRAWN -- MB	REVISED --			-	08-00098-00-SW	DUPAGE	22	8
PLOT SCALE =		CHECKED -- AJB	REVISED --			SIDEWALK PROJECT	CONTRACT NO. 63132			
PLOT DATE =		DATE -- 10/29/2008	REVISED --			FED. ROAD DIST. NO. 1 ILLINOIS FED. AID PROJECT				

PLAN	DATE
BY	
REVISIONS	
NO.	
DATE	
BY	
DESCRIPTION	
1	
2	
3	
4	
5	
6	
7	
8	
9	
10	
11	
12	
13	
14	
15	
16	
17	
18	
19	
20	
21	
22	
23	
24	
25	
26	
27	
28	
29	
30	
31	
32	
33	
34	
35	
36	
37	
38	
39	
40	
41	
42	
43	
44	
45	
46	
47	
48	
49	
50	

PROFILE	DATE
BY	
REVISIONS	
NO.	
DATE	
BY	
DESCRIPTION	
1	
2	
3	
4	
5	
6	
7	
8	
9	
10	
11	
12	
13	
14	
15	
16	
17	
18	
19	
20	
21	
22	
23	
24	
25	
26	
27	
28	
29	
30	
31	
32	
33	
34	
35	
36	
37	
38	
39	
40	
41	
42	
43	
44	
45	
46	
47	
48	
49	
50	

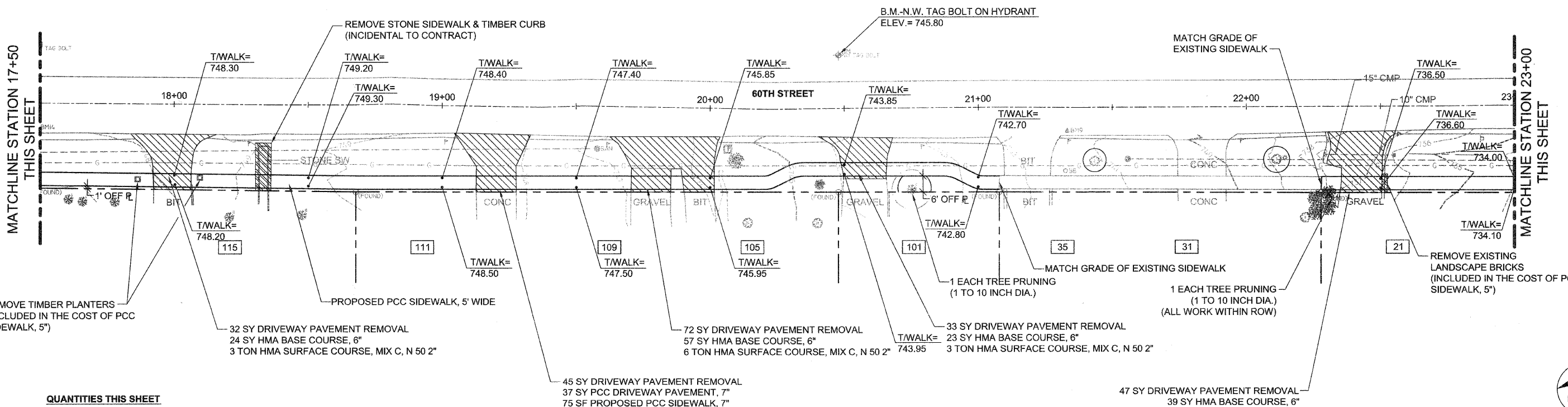
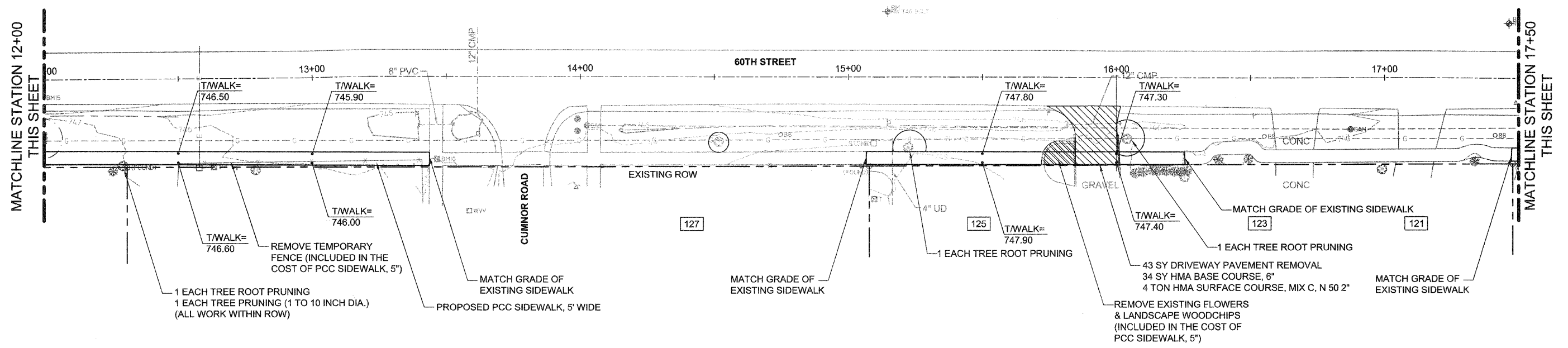

QUANTITIES THIS SHEET

- 3485 SF PCC SIDEWALK 5
- 105 CY REMOVAL AND DISPOSAL OF UNSUITABLE MATERIAL
- 730 SY TOPSOIL FURNISH AND PLACE, 4"
- 730 SY SODDING, SALT TOLERANT

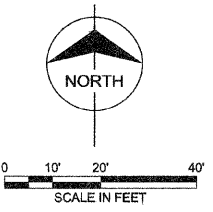

FILE NAME =	USER NAME =	DESIGNED -- MB	REVISED	STATE OF ILLINOIS DEPARTMENT OF TRANSPORTATION	F.A.U. RTE.	SECTION	COUNTY	TOTAL SHEETS	SHEET NO.
		DRAWN -- MB	REVISED --		08-00098-00-SW	DUPAGE	22	9	
		CHECKED -- AJB	REVISED --		SIDEWALK PROJECT CONTRACT NO. 63132				
		DATE -- 10/29/2008	REVISED --		FED. ROAD DIST. NO. 1 [ILLINOIS] FED. AID PROJECT				

DATE	
BY	
PLAN	
NO.	
DATE	
BY	
PROFILE	
NO.	

DATE	
BY	
PROFILE	
NO.	
DATE	
BY	
PLAN	
NO.	

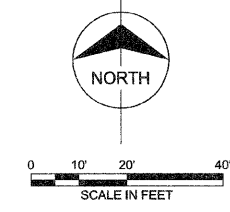
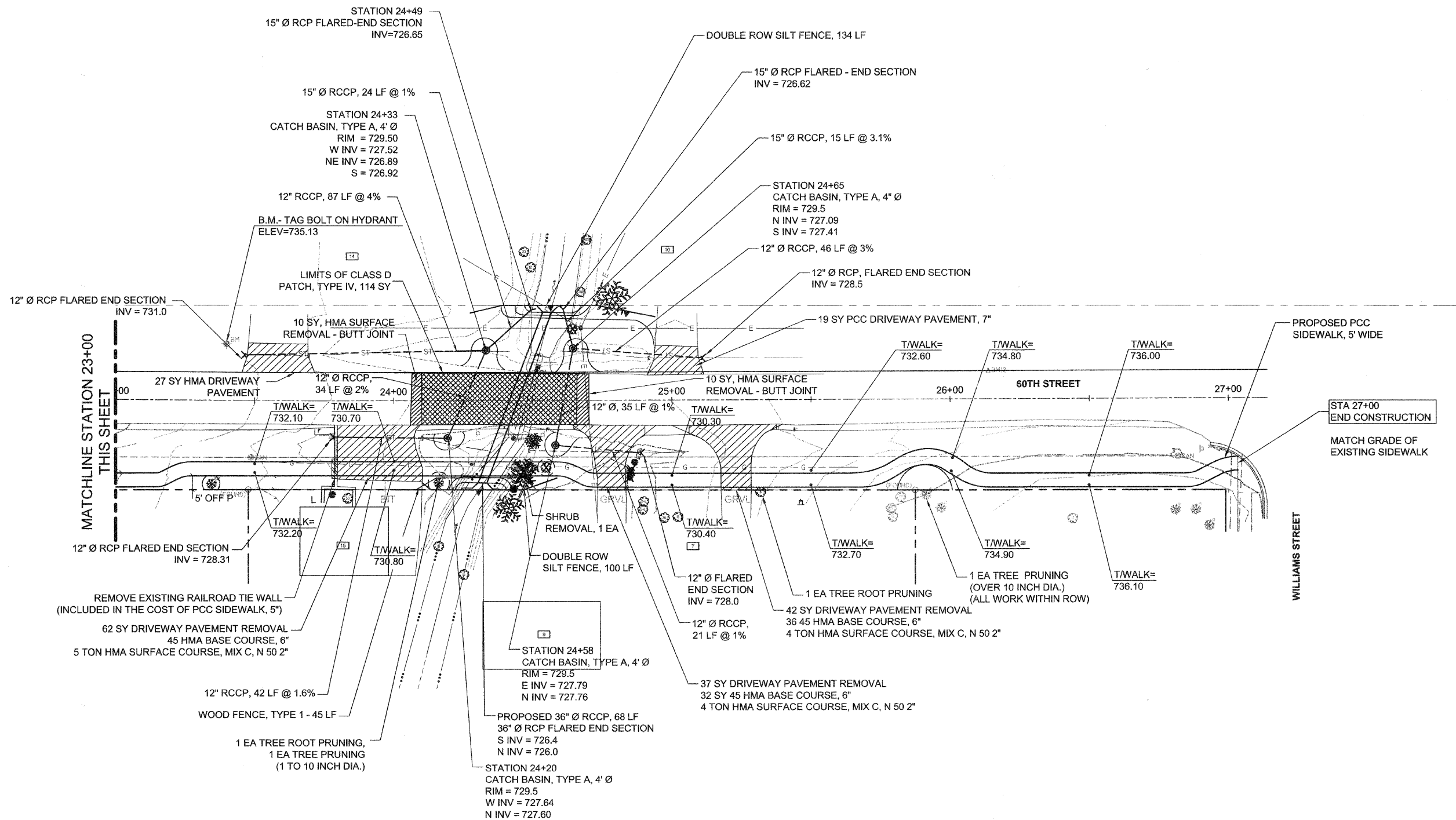

- QUANTITIES THIS SHEET**
- 2030 SF PCC SIDEWALK 5
 - 70 CY REMOVAL AND DISPOSAL OF UNSUITABLE MATERIAL
 - 470 SY TOPSOIL FURNISH AND PLACE, 4"
 - 470 SY SODDING, SALT TOLERANT
 - 14 UNIT TREE REMOVAL (6 TO 15 UNITS DIAMETER)
 - 3 EACH SHRUB REMOVAL

FILE NAME =	USER NAME =	DESIGNED -- M3	REVISED --	STATE OF ILLINOIS DEPARTMENT OF TRANSPORTATION	F.A.U. R.T.E. =	SECTION =	COUNTY =	TOTAL SHEETS =	SHEET NO. =
		DRAWN -- M3	REVISED --		SCALE:	08-00098-00-SW	DUPAGE	22	10
		CHECKED -- AJR	REVISED --			SIDEWALK PROJECT		CONTRACT NO. 63132	
		DATE -- 10/29/2008	REVISED --			FED. ROAD DIST. NO. 1 ILLINOIS FED. AID PROJECT			

PLAN	DATE
BY	
NO.	
DATE	
BY	
NO.	
DATE	
BY	
NO.	
DATE	
BY	
NO.	
DATE	
BY	
NO.	
DATE	

PROFILE	DATE
BY	
NO.	
DATE	
BY	
NO.	
DATE	
BY	
NO.	
DATE	
BY	
NO.	
DATE	

CURB & GUTTER REMOVAL - 10 LF
CURB & GUTTER, TYPE B-6.12 - 10 LF

75 L.F. THERMOPLASTIC PAVEMENT MARKING-LINE, 6" WHITE

B.M. - CROSS CUT IN CURB
ELEV=758.13

STA 1+00
BEGIN CONSTRUCTION

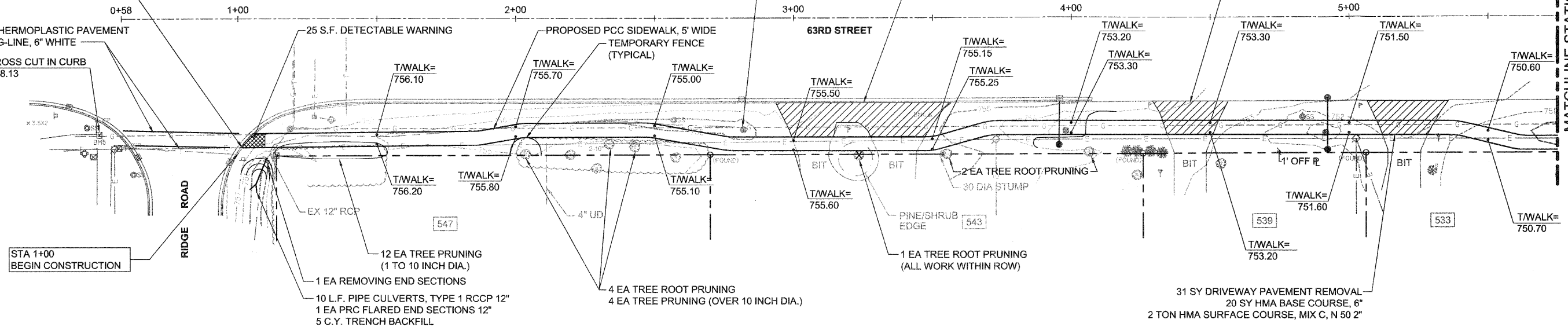

MATCHLINE STATION 5+75
THIS SHEET

MATCHLINE STATION 5+75
THIS SHEET

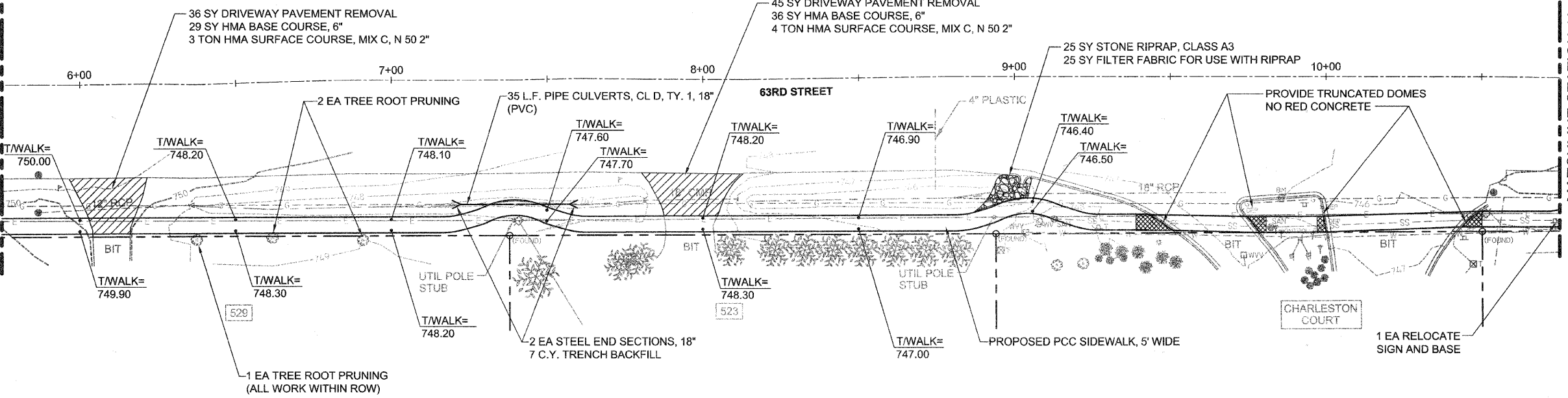

MATCHLINE STATION 10+75
THIS SHEET

QUANTITIES THIS SHEET

- 4555 SF PCC SIDEWALK 5
- 140 CY REMOVAL AND DISPOSAL OF UNSUITABLE MATERIAL
- 1155 SY TOPSOIL FURNISH AND PLACE, 4"
- 1155 SY SODDING, SALT TOLERANT
- 50 LF TEMPORARY FENCE

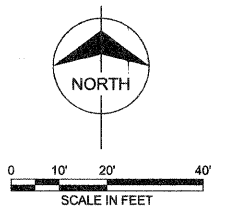

FILE NAME =	USER NAME =	DESIGNED - MB	REVISED -
		DRAWN - MB	REVISED -
		CHECKED - AJB	REVISED -
		DATE - 10/29/2008	REVISED -

**STATE OF ILLINOIS
DEPARTMENT OF TRANSPORTATION**

SCALE:

F.A.U. RTE.	SECTION	COUNTY	TOTAL SHEETS	SHEET NO.
-	08-00098-00-SW	DUPAGE	22	11
SIDEWALK PROJECT			CONTRACT NO. 63132	
FED. ROAD DIST. NO. 1 ILLINOIS FED. AID PROJECT				

PLAN	SURVEYED	BY	DATE
	NOTE BOOK		
	ALIGNMENT CHECKED		
	RT. OF WAY CHECKED		
	POD FILE NAME		

PROFILE	SURVEYED	BY	DATE
	GRADES CHECKED		
	B.M. NOTED		
	STRUCTURE NOTATIONS CHECKED		

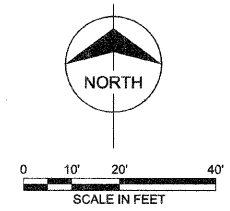
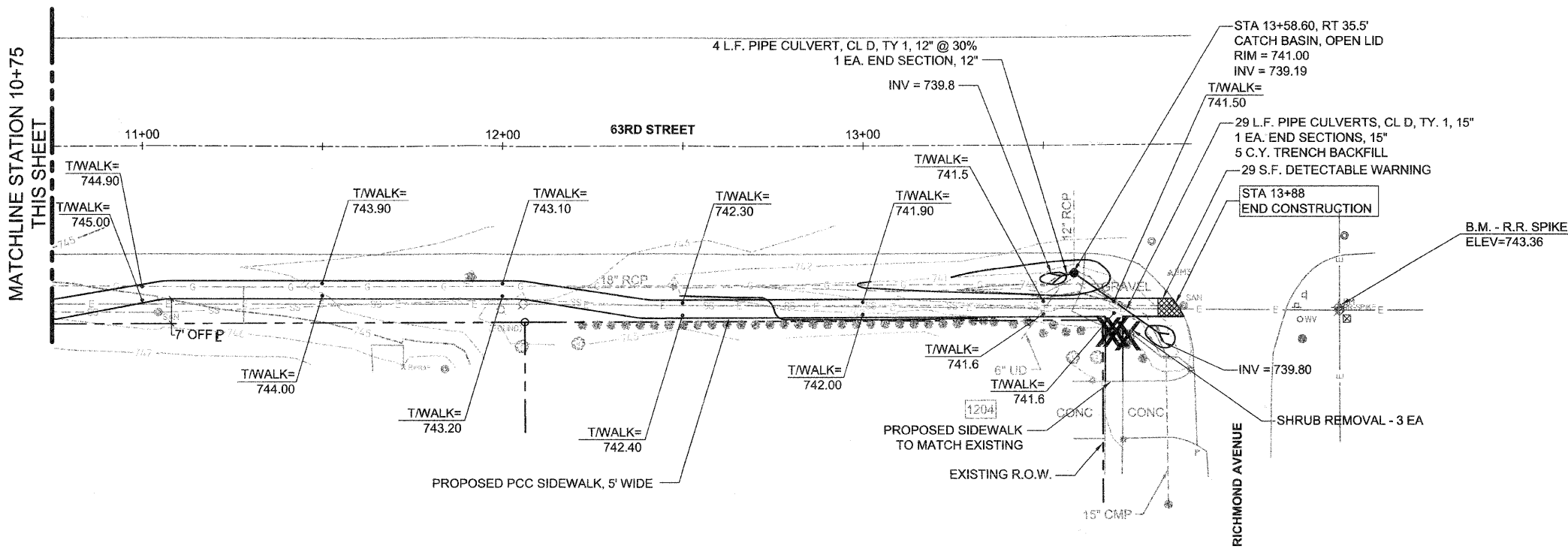

QUANTITIES THIS SHEET

1550 SF PCC SIDEWALK 5
 50 CY REMOVAL AND DISPOSAL OF UNSUITABLE MATERIAL
 385 SY TOPSOIL FURNISH AND PLACE, 4"
 385 SY SODDING, SALT TOLERANT

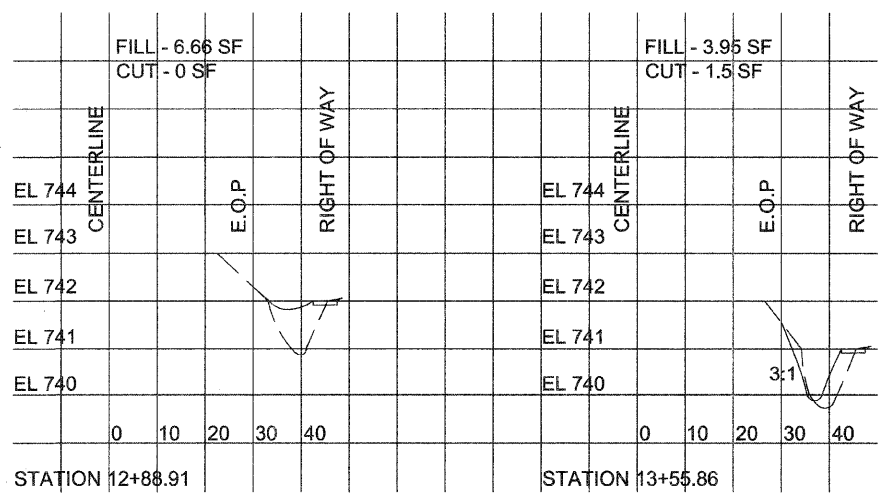

FILE NAME =	USER NAME =	DESIGNED -- M3	REVISED --	STATE OF ILLINOIS DEPARTMENT OF TRANSPORTATION	F.A.U. R.T.E. =	SECTION	COUNTY	TOTAL SHEETS	SHEET NO.
	PLOT SCALE =	DRAWN -- M3	REVISED --			08-00098-00-SW	DUPAGE	22	12
	PLOT DATE =	CHECKED -- AJB	REVISED --		SCALE:	SIDEWALK PROJECT		CONTRACT NO. 63132	
		DATE -- 10/29/2008	REVISED --			FED. ROAD DIST. NO. 1 ILLINOIS FED. AID PROJECT			

DATE: _____ BY: _____
 SURVEYED _____
 PLAN NOTE BOOK _____
 NO. _____

DATE: _____ BY: _____
 SURVEYED _____
 PROFILE NOTE BOOK _____
 NO. _____

BURNS AND McDONNELL ENGINEERING COMPANY, INC.

COPYRIGHT ©

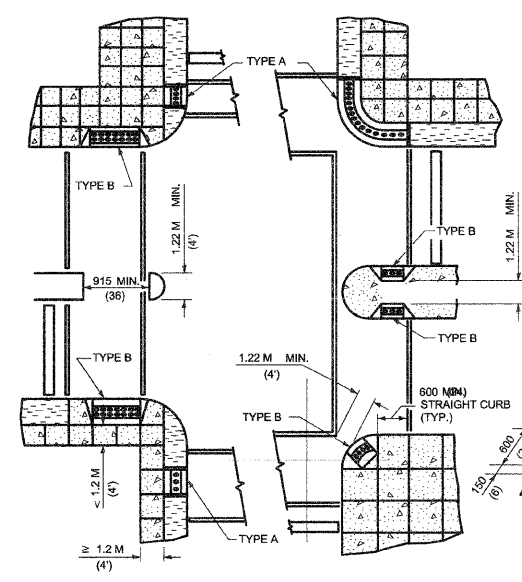

RECOMMENDED LOCATION OF RAMPS

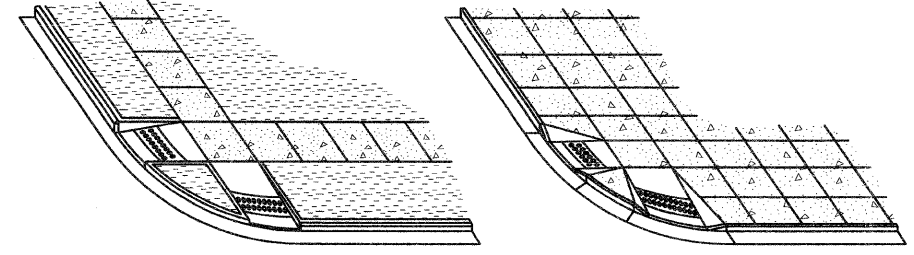

TYPE A RAMPS TYPE B RAMPS

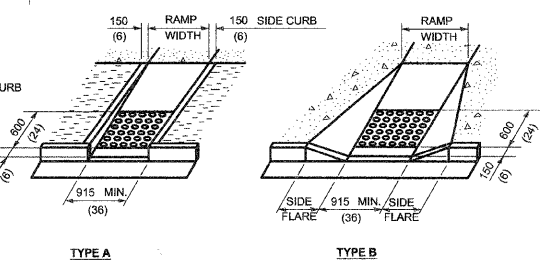

DETAILS OF RAMPS

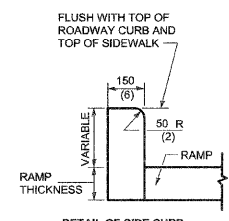

DETAIL OF SIDE CURB (SIDE CURB MAY BE CONSTRUCTED MONOLITHICALLY WITH RAMP)

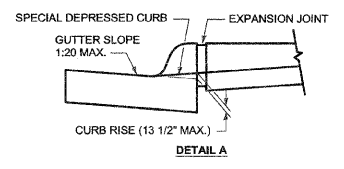

DETAIL A

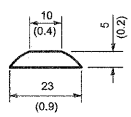

TRUNCATED DOME DETAIL

LEGEND

- SIDEWALK
- RAMP
- DETECTABLE WARNING TILES
- NON WALKING AREA

GENERAL NOTES

1. THE MAXIMUM SLOPE OF THE SIDE FLARE FOR TYPE B RAMPS SHALL BE 1:10; HOWEVER, IF THE WIDTH OF THE LANDING AREA BETWEEN THE TOP OF THE RAMP AND AN OBSTRUCTION IS LESS THAN 1.2 M (4'-0") THEN THE MAXIMUM SLOPE SHALL BE 1:12.
2. ALL SLOPE RATIOS ARE EXPRESSED AS UNITS OF VERTICAL DISPLACEMENT TO UNITS OF HORIZONTAL DISPLACEMENT (V:H).
3. ALL DIMENSIONS ARE IN MILLIMETERS (INCHES) UNLESS OTHERWISE SHOWN. DETECTABLE WARNING TILES SHALL BE E2-SET.

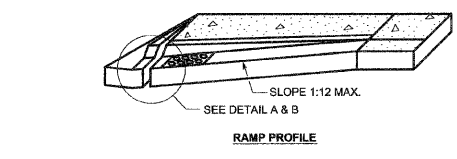

RAMP PROFILE

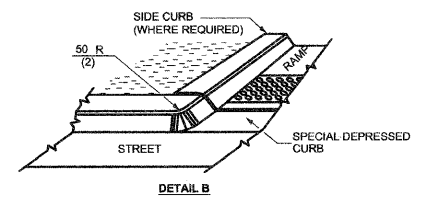

DETAIL B

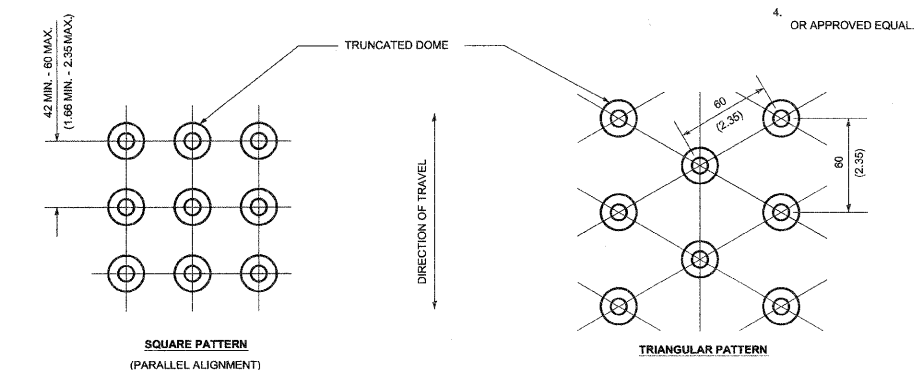

DETECTABLE WARNINGS DETAIL N.T.S.

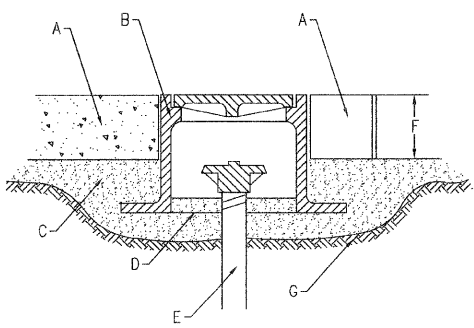

SERVICE BOX INSTALLATION IN PAVEMENT AREAS N.T.S.

CONSTRUCTION NOTES:

- A. STAMPED CONCRETE PAVEMENT OR CONCRETE BRICK PAVERS.
- B. FOR CONCRETE-ROUND FRAME SHALL BE EQUIVALENT TO TYLER 6895 VALVE BOX. FOR BRICK PAVERS-SQUARE FRAME SHALL BE EQUIVALENT TO NEENAH B-1978-1 INSPECTION FRAME.
- C. COMPACTED AGGREGATE BASE, MIN. 2".
- D. SERVICE BOX LID WITH BRASS PENTAGON HEAD PLUG, TOP TO BE MARKED "WATER".
- E. SERVICE BOX EXTENSION.
- F. SERVICE BOX SET 4"-6" BELOW FINISHED GRADE.
- G. SUBGRADE.

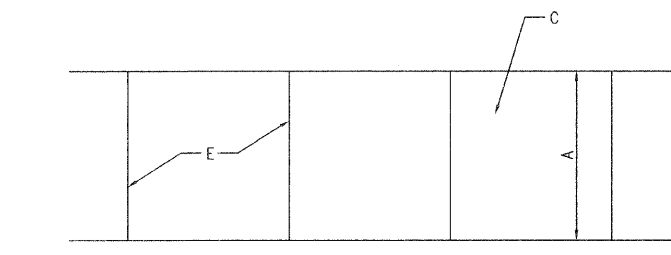

PLAN

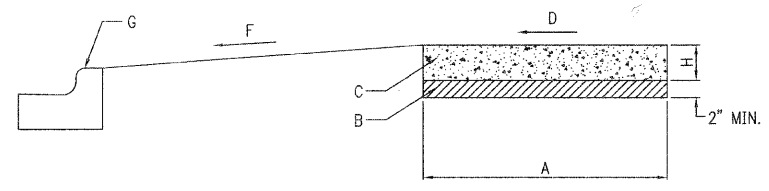

PROFILE SIDEWALK DETAIL N.T.S.

CONSTRUCTION NOTES

- A. 5' NORMAL WIDTH OR AS INDICATED ON PLANS
- B. AGGREGATE BASE COURSE, TYPE B, 2"
- C. P.C.C. SIDEWALK
- D. SLOPE 1/4" PER FOOT TO STREET SIDE, MAXIMUM 2%
- E. JOINTS, SEE NOTES 3 AND 4
- F. SLOPE 2% TO 8% TOWARDS STREET
- G. CURB AND GUTTER
- H. CONCRETE THICKNESS, SEE NOTE 1

GENERAL NOTES

1. STANDARD THICKNESS OF CONCRETE SHALL BE A MINIMUM OF 5".
2. WHERE WOODEN FORMS ARE USED, 2x4'S ARE NOT ALLOWED. ONLY 2x6'S SHALL BE USED.
3. PREFORMED 3/4" EXPANSION JOINTS SHALL BE CONSTRUCTED AT MAX. SPACING OF 40'.
4. FORMED OR SAW-CUT CONTRACTION JOINTS SHALL BE SPACED GENERALLY 5' APART, BUT NO LESS THAN 4' AND NO MORE THAN 6'.
5. 1/2" EXPANSION JOINTS SHALL BE INSTALLED WHERE SIDEWALK ABUTS BUILDINGS, TRAFFIC SIGNAL FOUNDATIONS, SERVICE POLES, AND OTHER IMMOVABLE STRUCTURES.
6. CONCRETE TO BE MINIMUM 6-BAG MIX.

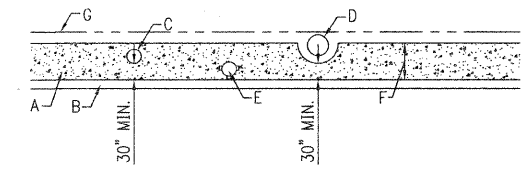

IMMOVABLE OBJECTS (CURB-TYPE SIDEWALK, NARROW R.O.W.)

CONSTRUCTION NOTE:

- A. SIDEWALK
- B. CURB
- C. SERVICE POLE, SEE NOTES 1 AND 3.
- D. TREE TRUNK, SEE NOTE 1
- E. FIRE HYDRANT, SEE NOTES 1, 2, AND 3.
- F. SIDEWALK WIDTH.
- G. RIGHT-OF-WAY (R.O.W.)

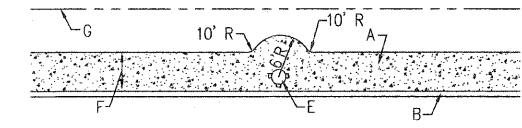

IMMOVABLE OBJECTS (CURB-TYPE SIDEWALK, WIDE R.O.W.)

GENERAL NOTES:

1. A FIRE HYDRANT, SERV. POLE OR TREE TRUNK SHALL BE CONSIDERED IMMOVABLE ONLY WHEN DIRECTED BY THE VILLAGE ENGINEER.
2. THE VILLAGE OF WESTMONT WATER DEPT. SHALL BE CONTACTED AS SOON AS POSSIBLE WHENEVER A FIRE HYDRANT IS FOUND TO BE IN THE PATH OF A NEW SIDEWALK, SO THAT THE FIRE HYDRANT CAN BE RELOCATED, IF POSSIBLE.
3. WHEN A SERVICE POLE OR FIRE HYDRANT IS LOCATED WITHIN THE SIDEWALK AREA, AND IS CONSIDERED IMMOVABLE, A 1/2" EXPANSION JOINT SHALL BE INSTALLED ENCIRCLING THE OBJECT.

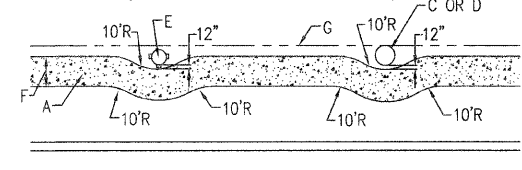

IMMOVABLE OBJECTS (SIDEWALK WITH PARKWAY)

SIDEWALK OBSTRUCTIONS N.T.S.

FILE NAME =	USER NAME =	DESIGNED -- M3	REVISED --
		DRAWN -- MB	REVISED --
		CHECKED -- AJB	REVISED --
		DATE -- 10/29/2008	REVISED --

STATE OF ILLINOIS DEPARTMENT OF TRANSPORTATION

SCALE:	F.A.U. RTE.:	SECTION:	COUNTY:	TOTAL SHEETS:	SHEET NO.:
		08-00098-00-SW	DUPAGE	22	13
		SIDEWALK PROJECT		CONTRACT NO. 63132	
		FED. ROAD DIST. NO. 1 ILLINOIS FED. AID PROJECT			

PLAN	DATE
BY	
DESIGNED	
CHECKED	
IN CHARGE	
DATE	
NO.	
NOTE BOOK	
NO.	
ALIGNMENT CHECKED	
RT. OF WAY CHECKED	
PAID FILE NAME	

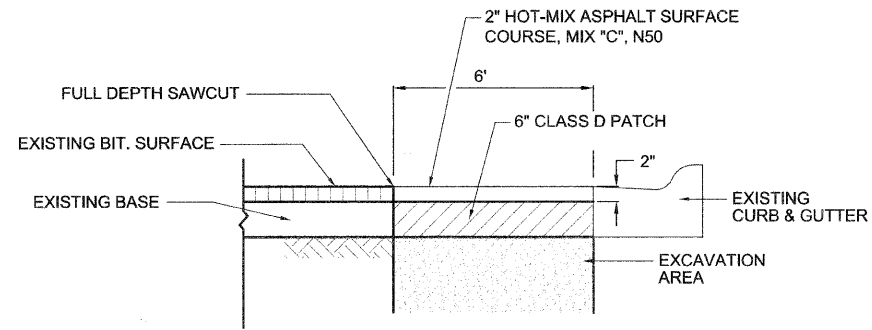

1. THE LOCATION AND LIMITS OF THE PAVEMENT PATCHING SHALL BE ESTABLISHED BY THE ENGINEER.
2. THE REMOVAL OF THE EXISTING SURFACE SHALL BE INCLUDED IN THE CONTRACT UNIT PRICE FOR PAVEMENT REMOVAL.
3. SAWCUTS SHALL NOT BE PAID FOR SEPARATELY AND SHALL BE CONSIDERED INCIDENTAL TO THE PAVEMENT PATCHING.
4. ALL FULL DEPTH PATCHES, WHERE PAVEMENT HAS BEEN REMOVED, SHALL BE PROTECTED BY A MINIMUM OF TWO (2) FLASHING BARRICADES. THE FURNISHING, PLACING AND MAINTENANCE OF BARRICADES SHALL BE PAID FOR UNDER TRAFFIC CONTROL AND PROTECTION.

CLASS D PATCHING
NTS

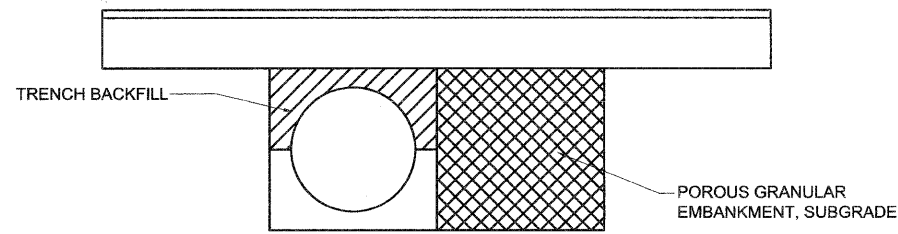

CROSS SECTION A-A
NTS

PROFILE	DATE
BY	
DESIGNED	
CHECKED	
IN CHARGE	
DATE	
NO.	
NOTE BOOK	
NO.	
GRADES CHECKED	
E.M. NOTED	
STRUCTURE NOTATIONS CHECKED	

CONSTRUCTION NOTES

- A. Slope 3/4"/Ft.
- B. 2- #4 Bars Continuous, Optional.
- C. 2 Dowel Bars at Expansion Joints.
- D. Min. 2" Aggr. Base.
- E. Min. 6" Bog Mix Concrete.
- F. Depressed Curb Configuration.

GENERAL NOTES

1. Standard Curb and Gutter Shall be Used For All New Construction. Roll-Type Curb and Gutter is Not Acceptable.
2. Prefabricated Expansion Joints of 3/4" Thickness Shall be Spaced a Maximum of 40' Apart, and at All Radius Points and 4' Either Side of Inlets.
3. Formed or Saw-Cut Contraction Joints Shall be Spaced a Maximum of 10' Apart and Filled with a Silicone Sealant.
4. Concrete Barrier-Type Curb and Gutter Shall be Provided for All Parking Lots Accommodating Five (5) or More Parking Spaces.

VILLAGE OF WESTMONT
CURB AND GUTTER DETAIL
ISSUED: March 1988
REVISED: August 2003
DWG. R-6-1

FILE NAME =	USER NAME =	DESIGNED -- MB	REVISED --	STATE OF ILLINOIS DEPARTMENT OF TRANSPORTATION	SCALE:	F.A.U. RTE.	SECTION	COUNTY	TOTAL SHEETS	SHEET NO.	
		DRAWN -- MB	REVISED --			--	08--00098--00--SW	DUPAGE	22	14	
		CHECKED -- AJB	REVISED --			SIDEWALK PROJECT CONTRACT NO. 63132					
		DATE -- 10/29/2008	REVISED --			FED. ROAD DIST. NO. 1 ILLINOIS FED. AID PROJECT					

DATE	BY	REVIEWED	DATE
PLAN	DESIGNED	BY	DATE
	CHECKED	BY	DATE
	NOTED	BY	DATE

DATE	BY	REVIEWED	DATE
PROFILE	DESIGNED	BY	DATE
	CHECKED	BY	DATE
	NOTED	BY	DATE

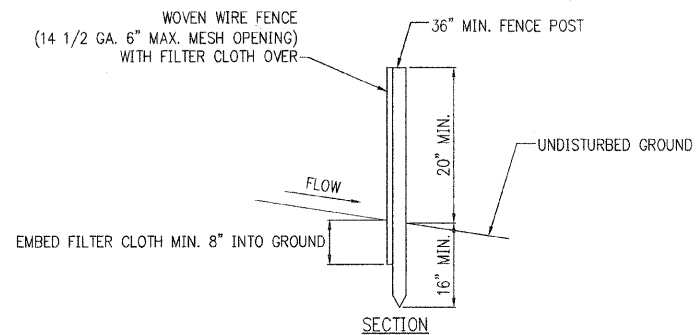
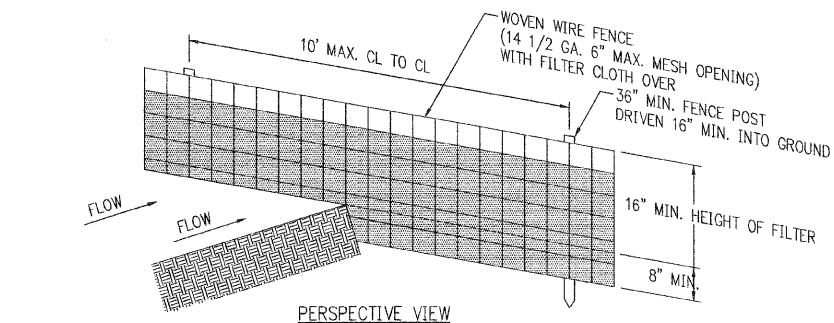

SILT FENCE
N.T.S.

CONSTRUCTION NOTES FOR FABRICATED SILT FENCE

1. WOVEN WIRE FENCE TO BE FASTENED SECURELY TO FENCE POSTS WITH WIRE TIES OR STAPLES.
2. FILTER CLOTH TO BE FASTENED SECURELY TO WOVEN WIRE FENCE WITH TIES SPACED EVERY 24" AT TOP AND MID SECTION.
3. WHEN TWO SECTIONS OF FILTER CLOTH ADJOIN EACH OTHER THEY SHALL BE OVER LAPPED BY 6" AND FOLDED.
4. MAINTENANCE SHALL BE PERFORMED AS NEEDED AND MATERIAL REMOVED WHEN "BULGES" DEVELOP IN THE SILT FENCE.

POSTS: STEEL EITHER 'I' OR 'U' TYPE OR 2" HARDWOOD
 FENCE: WOVEN WIRE 14 1/2 GA. 6" MAX. MESH OPENING
 FILTER CLOTH: FILTER X, MIRAFI 100X OR STABLINKA T140N
 PREFABRICATED UNIT: GOEFAB, ENVIROFENCE OR APPROVED EQUAL.

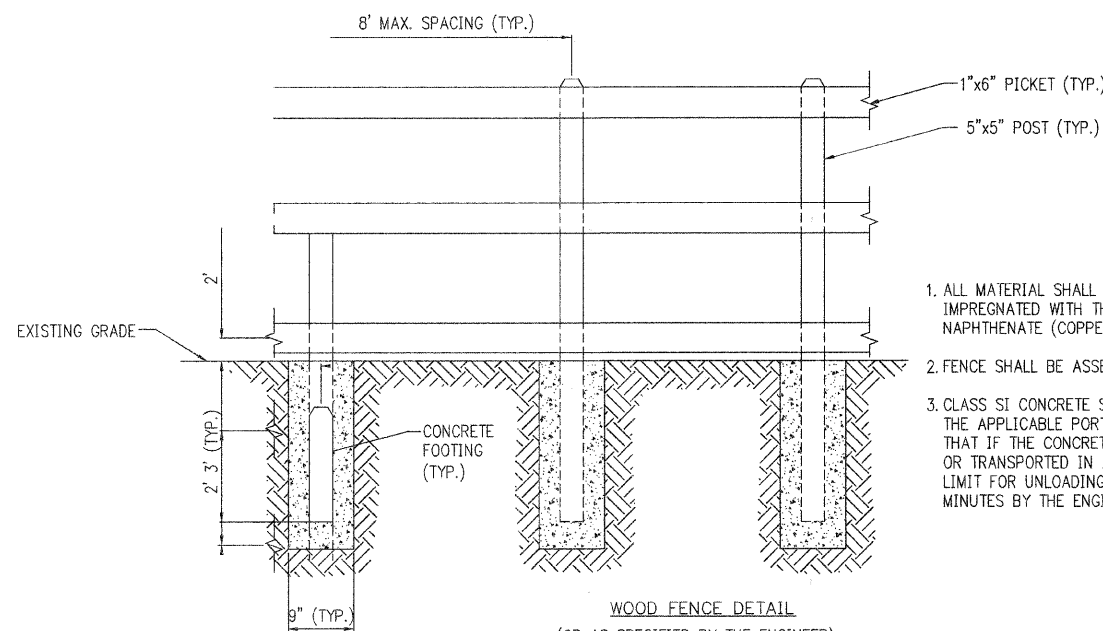

WOOD FENCE DETAIL
(OR AS SPECIFIED BY THE ENGINEER)
NOT TO SCALE

1. ALL MATERIAL SHALL BE SOUTHERN YELLOW PINE IMPREGNATED WITH THE PRESERVATIVE, COPPER NAPHTHENATE (COPPERWOOD OR APPROVED EQUAL).
2. FENCE SHALL BE ASSEMBLED BY FACE NAILING.
3. CLASS SI CONCRETE SHALL BE USED CONFORMING TO THE APPLICABLE PORTIONS OF SECTION 1020, EXCEPT THAT IF THE CONCRETE IS MIXED IN TRANSIT MIXERS OR TRANSPORTED IN AGITATOR TRUCKS, THE TIME LIMIT FOR UNLOADING IT MAY BE EXTENDED TO 120 MINUTES BY THE ENGINEER.

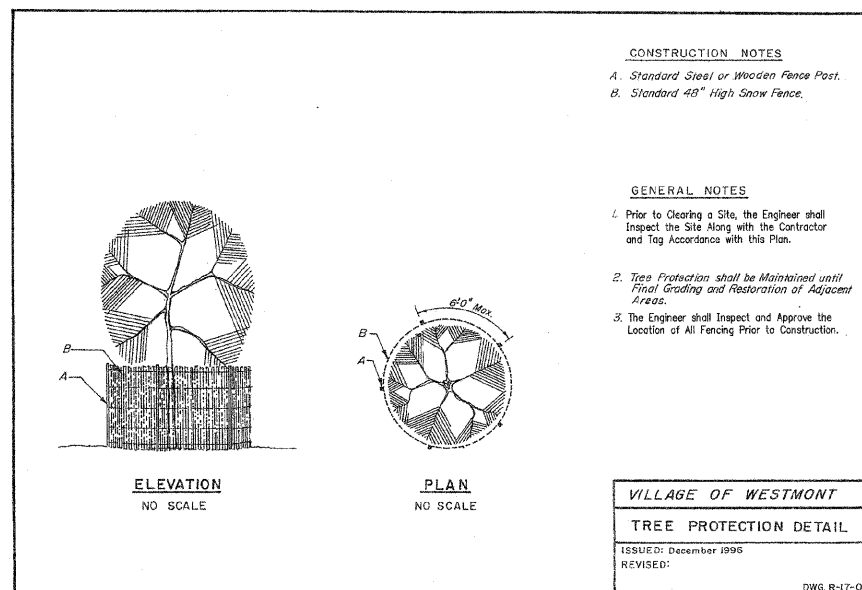

VILLAGE OF WESTMONT

TREE PROTECTION DETAIL

ISSUED: December 1995
 REVISED:

DWG. R-17-0

FILE NAME =	USER NAME =	DESIGNED -- MB	REVISED --
		DRAWN -- MB	REVISED --
	PLOT SCALE =	CHECKED -- AJS	REVISED --
	PLOT DATE =	DATE -- 10/29/2008	REVISED --

STATE OF ILLINOIS
DEPARTMENT OF TRANSPORTATION

SCALE:

F.A.U. RTE.	SECTION	COUNTY	TOTAL SHEETS	SHEET NO.
-	08-00098-00-SW	DUPAGE	22	15
SIDEWALK PROJECT			CONTRACT NO. 63132	
FED. ROAD DIST. NO. 1 ILLINOIS FED. AID PROJECT				

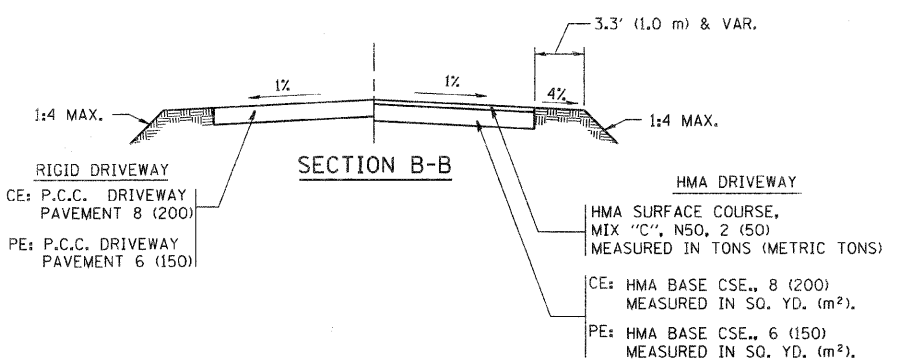
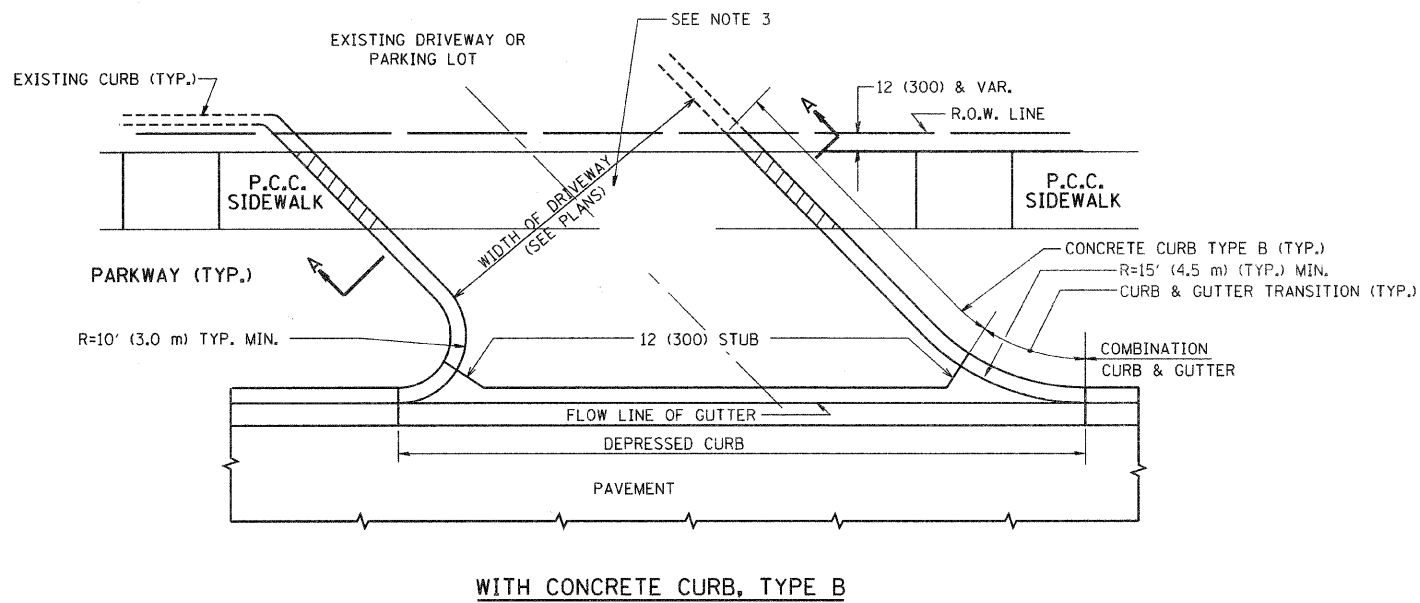
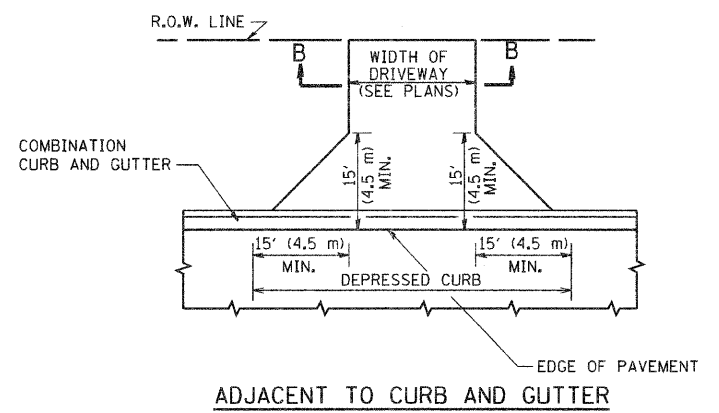
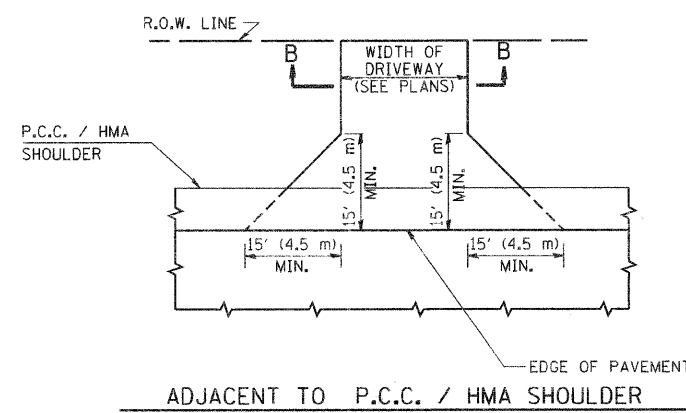
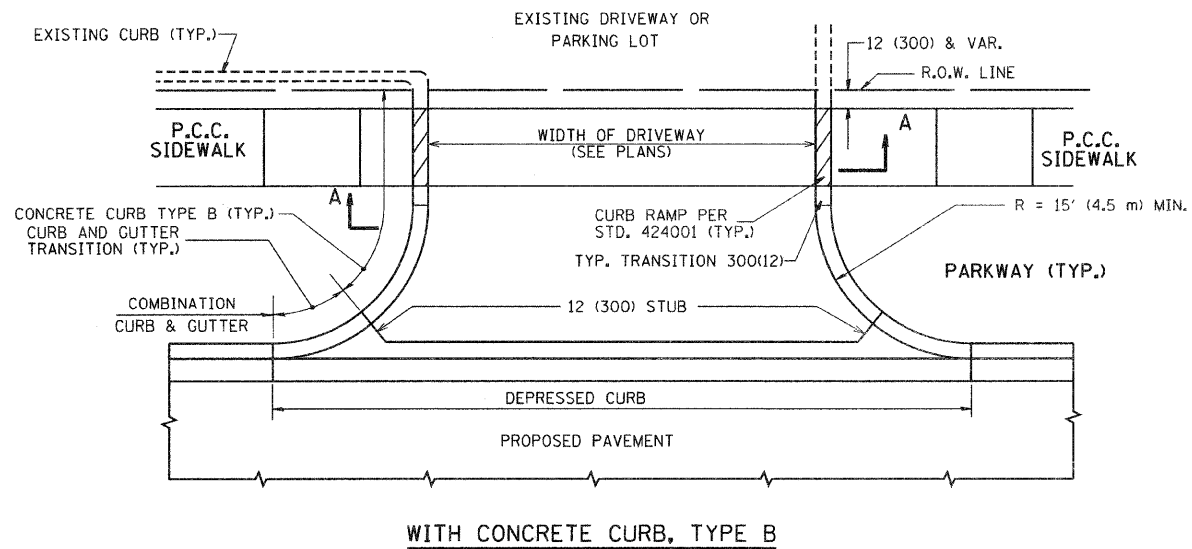

RURAL FIELD ENTRANCE (FE)

HMA SURFACE COURSE, MIX "C", N50, 2 (50) MEASURED IN TONS (METRIC TONS)

AGGREGATE BASE CSE., TYPE B, 8 (200) MEASURED IN SQ. YD. (m²).

GENERAL NOTES:

DRIVEWAY SLOPES, LOCATIONS, & GEOMETRIC LAYOUT SHALL BE IN ACCORDANCE WITH THE LATEST EDITION OF THE "HANDBOOK FOR POLICY ON PERMITS FOR ACCESS DRIVEWAYS TO STATE HIGHWAYS". FOR FURTHER LAYOUT REQUIREMENTS, REFER TO ILLUSTRATIONS IN THE PERMIT HANDBOOK. DRIVEWAYS SHALL BE REPLACED IN KIND, UNLESS OTHERWISE NOTED ON THE PLANS.

COMMERCIAL DRIVEWAYS SHALL BE CONSTRUCTED WITH CONCRETE CURB, TYPE B RETURNS EXCEPT WHEN THE SIDEWALK EDGE IS 4 FEET (1.2 METERS) OR LESS FROM THE BACK OF CURB, CONSTRUCT A FLARE DRIVEWAY WITHOUT CURB.

THE RESIDENT ENGINEER SHALL CONTACT THE TRAFFIC PERMIT OFFICE AT 847/ 705-4131 FOR ANY QUESTIONS ON DRIVEWAYS SHOWN IN THE PLANS; SPECIFICALLY IN REFERENCE TO ADDITIONAL AND/OR RELOCATION/REMOVAL OF A DRIVEWAY.

COMBINATION CONCRETE CURB & GUTTER SHALL BE MEASURED STRAIGHT ACROSS THE DRIVEWAY. NO ADDITIONAL COMPENSATION WILL BE ALLOWED FOR THE CURB & GUTTER TRANSITION.

1 (25) PREFORMED EXPANSION JOINT FILLER WILL NOT BE PAID SEPARATELY, BUT SHALL BE CONSIDERED INCLUDED IN THE COST OF THE P.C.C. DRIVEWAY PAVEMENT OR P.C.C. SIDEWALK.

WHEN THE P.C.C. SIDEWALK EXTENDS THROUGH THE DRIVEWAY, THE THICKNESS OF THE SIDEWALK IN THE DRIVEWAY AREA SHALL BE THE SAME AS THE DRIVEWAY THICKNESS. SIDEWALK WILL BE PAID FOR AS P.C.C. SIDEWALK OF THE THICKNESS SPECIFIED, SIDEWALK CROSS SLOPE THRU DRIVEWAY AREA TO BE A MAXIMUM OF 1:50.

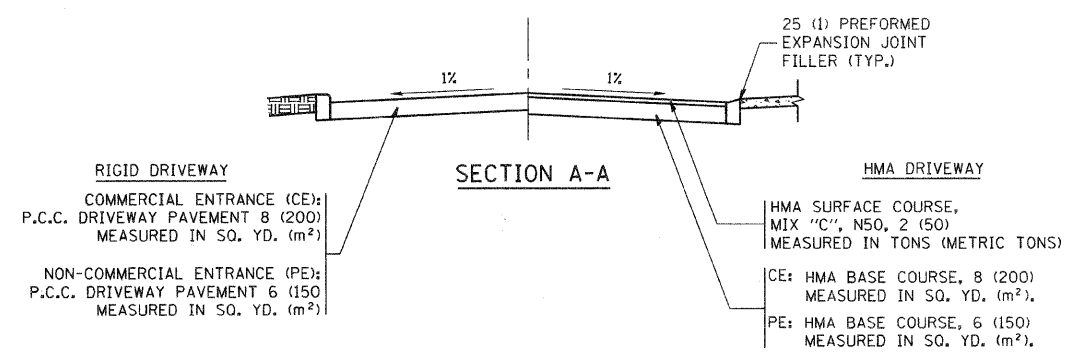

FILE NAME =	USER NAME = bauerdl	DESIGNED - R. SHAH	REVISED - M. GOMEZ 04-06-01	STATE OF ILLINOIS DEPARTMENT OF TRANSPORTATION	DRIVEWAY DETAILS - DISTANCE BETWEEN R.O.W. AND FACE OF CURB & EDGE OF SHOULDER >= 15' (4.5 m)			F.A. RTE.	SECTION	COUNTY	TOTAL SHEETS	SHEET NO.
cs\projects\dststd22x34\bd01.dgn		DRAWN -	REVISED - P. LGFLUER 04-15-03		08-00098-00-SW	DUPAGE	22	16				
PLOT SCALE = 49.9999' / IN.		CHECKED -	REVISED - R. BORO 01-01-07		BD0156-07 (BD-01)			CONTRACT NO. 63132				
PLOT DATE = 6/12/2008		DATE - 11-04-95	REVISED - R. BORO 06-11-08		SCALE: NONE	SHEET NO. 1 OF 1 SHEETS	STA. TO STA.	FED. ROAD DIST. NO. 1 ILLINOIS FED. AID PROJECT				

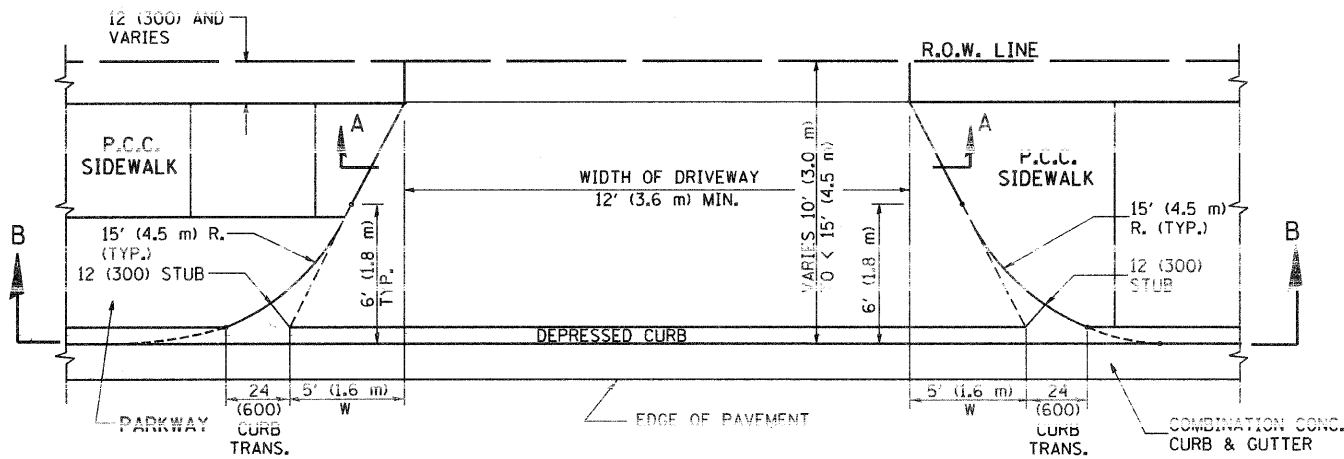

PLAN
10' (3.0 m) TO < 15' (4.5 m)

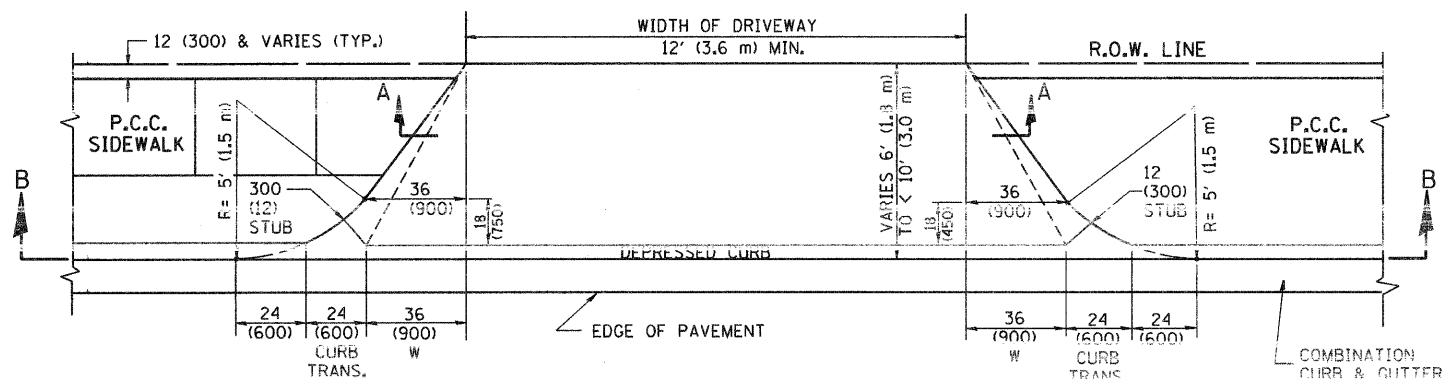

PLAN
6' (1.8 m) TO < 10' (3.0 m)

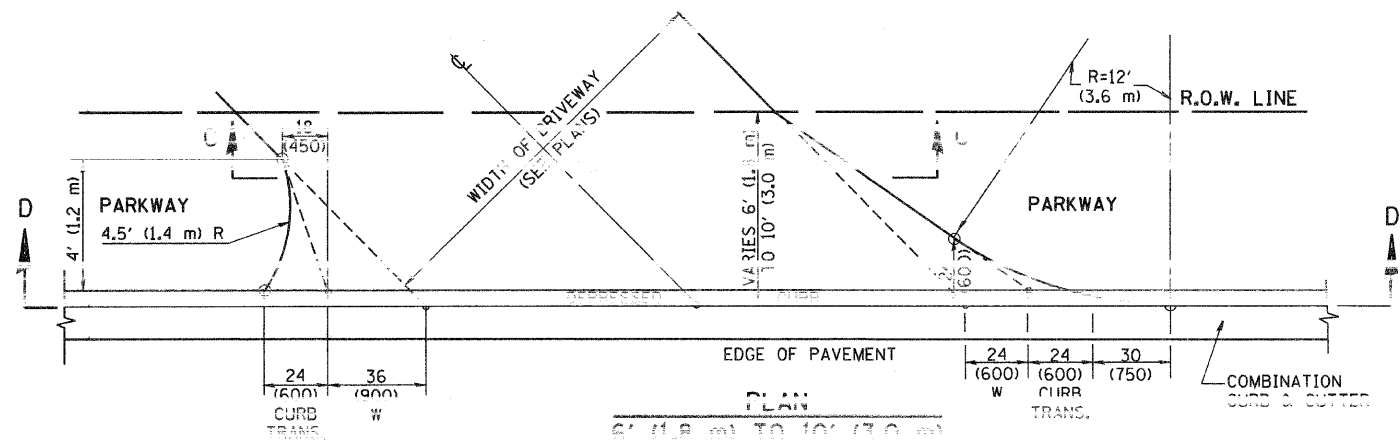

PLAN
6' (1.8 m) TO 10' (3.0 m)

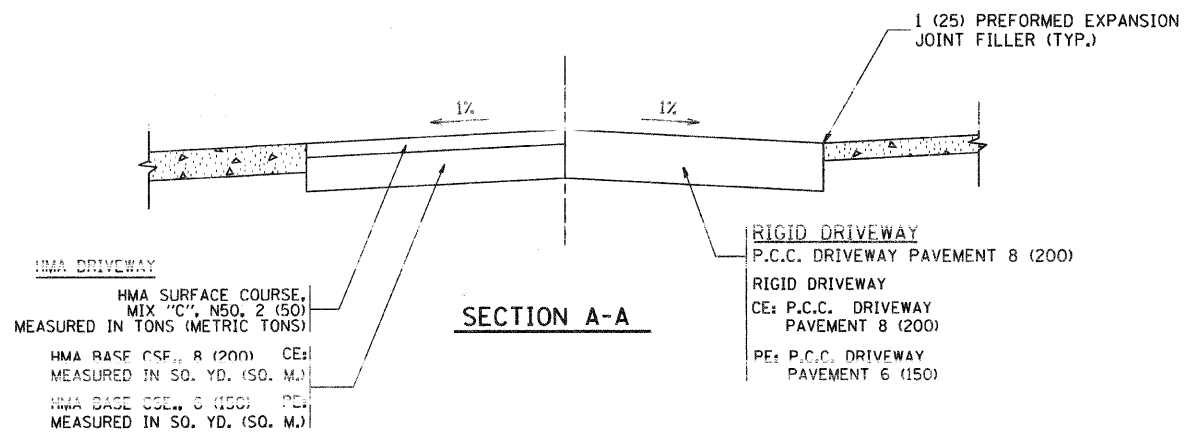

SECTION A-A

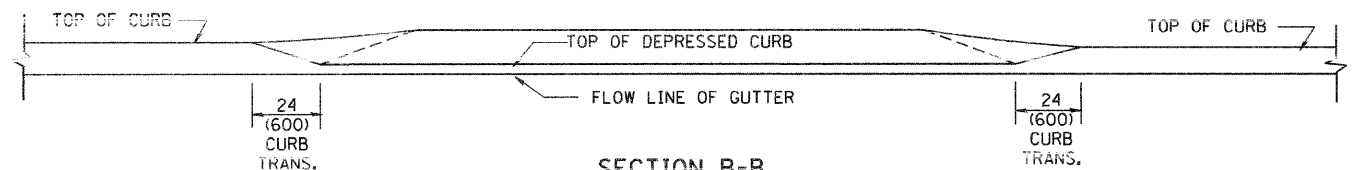

SECTION B-B

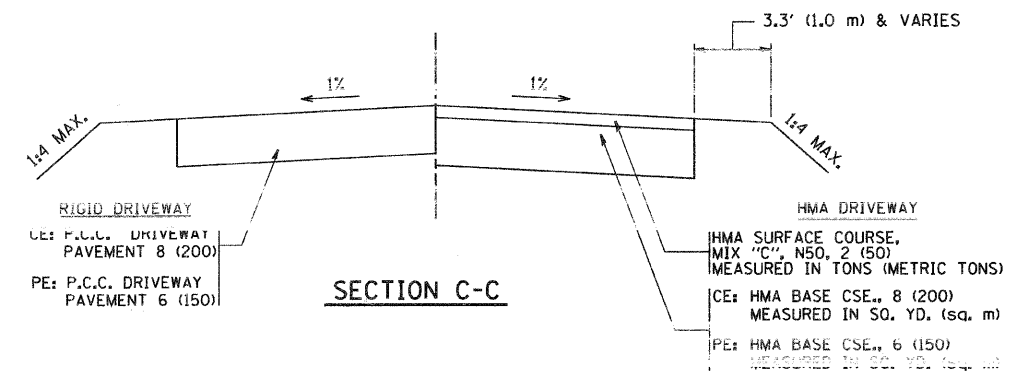

SECTION C-C

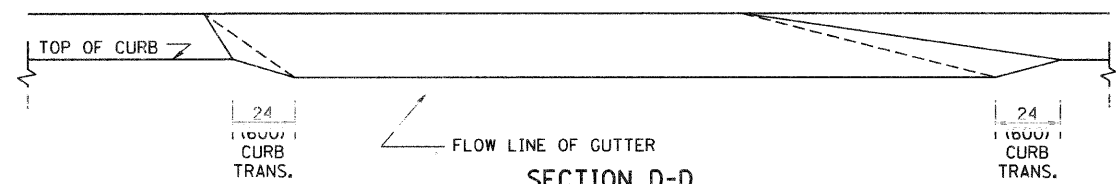

SECTION D-D

GENERAL NOTES

DRIVEWAY SLOPES, LOCATIONS, & GEOMETRIC LAYOUT SHALL BE IN ACCORDANCE WITH THE LATEST EDITION OF THE "HANDBOOK FOR POLICY ON PERMITS FOR ACCESS DRIVEWAYS TO STATE HIGHWAYS". FOR FURTHER LAYOUT REQUIREMENTS, REFER TO ILLUSTRATION 10 IN THE PERMIT HANDBOOK. WHERE SIDEWALKS EXIST, DRIVEWAYS SHALL BE REPLACED WITH RIGID PAVEMENT. WHERE NO SIDEWALKS EXIST, DRIVEWAYS SHALL BE REPLACED IN KIND. SIDEWALK CROSS SLOPE THRU DRIVEWAY AREA TO BE A MAXIMUM OF 1:50.

WHEN THE DISTANCE BETWEEN R.O.W. AND THE BACK OF CURB IS EQUAL TO OR LESS THAN 8' (2.4 m), THE P.C.C. SIDEWALK SHALL EXTEND TO THE BACK OF CURB.

THE RESIDENT ENGINEER SHALL CONTACT THE TRAFFIC PERMIT OFFICE AT 847/705-4131 FOR ANY QUESTIONS ON DRIVEWAYS SHOWN IN THE PLANS; SPECIFICALLY IN REFERENCE TO ADDITIONAL AND/OR RELOCATION/REMOVAL OF A DRIVEWAY.

COMBINATION CONCRETE CURB & GUTTER SHALL BE MEASURED STRAIGHT ACROSS THE DRIVEWAY. NO ADDITIONAL COMPENSATION WILL BE ALLOWED FOR THE CURB & GUTTER TRANSITION.

THE 1 (25) PREFORMED EXPANSION JOINT FILLER WILL NOT BE PAID SEPARATELY, BUT SHALL BE CONSIDERED INCLUDED IN THE COST OF THE P.C.C. DRIVEWAY PAVEMENT OR P.C.C. SIDEWALK.

"W" VARIES FROM 36 (900) TO 5' (1.5 m) PROPORTIONAL TO THE LENGTH (L), FROM 6' (1.8 m) TO 10' (3 m).

ALL DIMENSIONS ARE IN INCHES (MILLIMETERS) UNLESS OTHERWISE NOTED.

FILE NAME =	USER NAME = geglionobt	DESIGNED - R. SHAH	REVISED - T. HOLTZ 04-08-97
W:\dststd\22x34\bd02.dgn		DRAWN -	REVISED - M. GOMEZ 04-06-01
	PLOT SCALE = 50.0000' / IN.	CHECKED -	REVISED - P. LaFLEUR 04-15-03
	PLOT DATE = 1/4/2008	DATE - 11-06-95	REVISED - R. BORO 01-01-07

STATE OF ILLINOIS
DEPARTMENT OF TRANSPORTATION

DRIVEWAY DETAILS

DISTANCE BETWEEN ROW AND FACE OF CURB < 15' (4.5 m)

SCALE: NONE SHEET NO. 1 OF 1 SHEETS STA. TO STA.

F.A. RTE.	SECTION	COUNTY	TOTAL SHEETS	SHEET NO.
	08-00098-00-SW	DUPAGE	22	17
	BD400-02 (BD-02)			CONTRACT NO. 63132
FED. ROAD DIST. NO. 1 ILLINOIS FED. AID PROJECT				

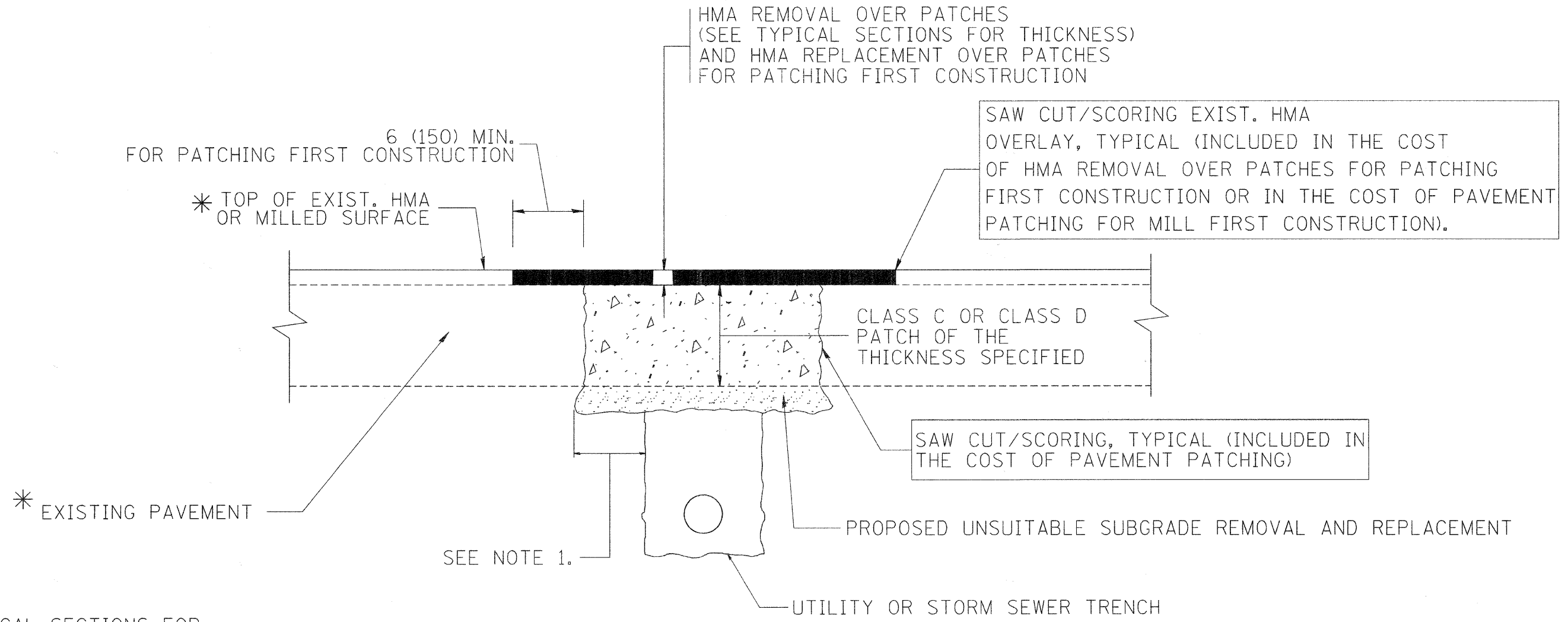

* SEE TYPICAL SECTIONS FOR THICKNESS AND MATERIALS

NOTES:

1. THE WIDTH OF THE FULL DEPTH PATCH OVER A TRENCH SHALL BE 12 (300) WIDER ON EACH SIDE OF THE TRENCH.
2. FOR METHOD OF MEASUREMENT AND BASIS OF PAYMENT, SEE RECURRING SPECIAL PROVISION "PATCHING WITH HOT-MIX ASPHALT OVERLAY REMOVAL".

SEQUENCE OF CONSTRUCTION (PATCHING FIRST)

1. REMOVE THE EXISTING HMA MATERIAL OVER THE AREA TO BE PATCHED.
2. REMOVE AND REPLACE WITH CLASS C OR D PATCH.
3. REPLACE HMA MATERIAL OVER THE AREA TO BE PATCHED.

SEQUENCE OF CONSTRUCTION (MILLING FIRST)

1. MILL HMA FIRST IF THERE IS AT LEAST 4 1/2 INCHES OR MORE OF HMA MATERIAL ON TOP OF THE EXISTING PAVEMENT OR IF THE PAVEMENT IS FULL DEPTH HMA. A MINIMUM OF 2 INCHES OF HMA MATERIAL SHALL BE IN PLACE AFTER MILLING.
2. REMOVE AND REPLACE WITH FULL DEPTH CLASS D PATCHES TO TOP OF MILLED SURFACE.

ALL DIMENSIONS ARE IN INCHES (MILLIMETERS) UNLESS OTHERWISE SHOWN.

FILE NAME = c:\projects\diststd22x34\bd22.dgn	USER NAME = bauerdl	DESIGNED - R. SHAH	REVISED - A. ABBAS 04-27-98	STATE OF ILLINOIS DEPARTMENT OF TRANSPORTATION	PAVEMENT PATCHING FOR HMA SURFACED PAVEMENT			F.A. RTE.	SECTION	COUNTY	TOTAL SHEETS	SHEET NO.
	PLOT SCALE = 50.000' / IN.	CHECKED -	REVISED - R. BORO 01-01-07					08-00098-00-SW	DUPAGE	22	18	
	PLOT DATE = 10/27/2008	DATE - 10-25-94	REVISED - K. ENG 10-27-08					BD400-04 (BD-22)	CONTRACT NO. 63132			
					SCALE: NONE	SHEET NO. 1 OF 1 SHEETS	STA.	TO STA.		FED. ROAD DIST. NO. 1 [ILLINOIS] FED. AID PROJECT		

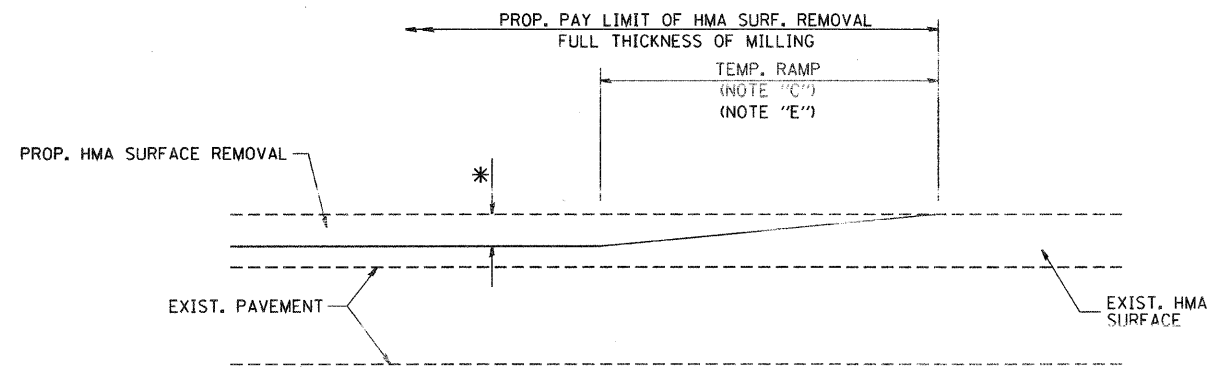

MILLED TEMPORARY RAMP
(FOR BUTT JOINT AND HMA TAPER SEE DETAIL BELOW)

OPTION 1

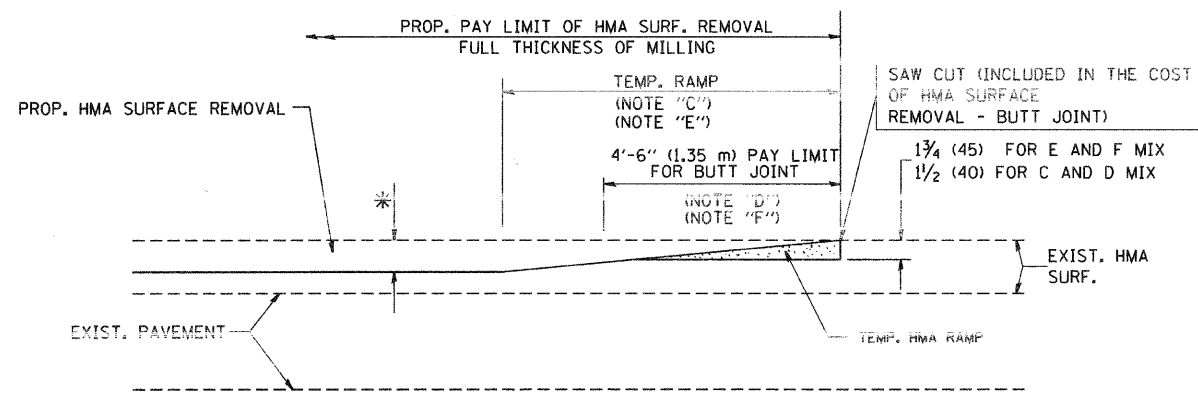

HMA CONSTRUCTED TEMPORARY RAMP
(FOR BUTT JOINT AND HMA TAPER SEE DETAIL BELOW)

OPTION 2
TYPICAL TEMPORARY RAMP

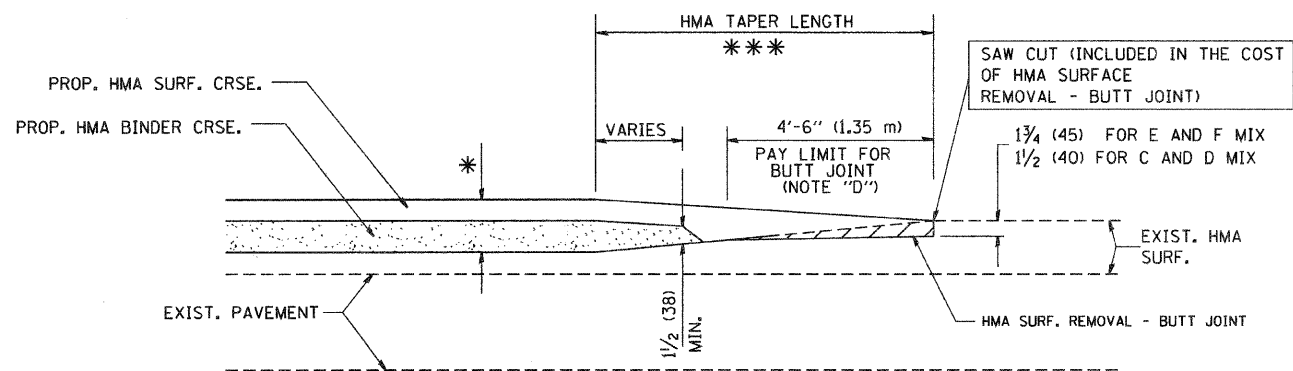

TYPICAL BUTT JOINT AND HMA TAPER
FOR MILLING AND RESURFACING

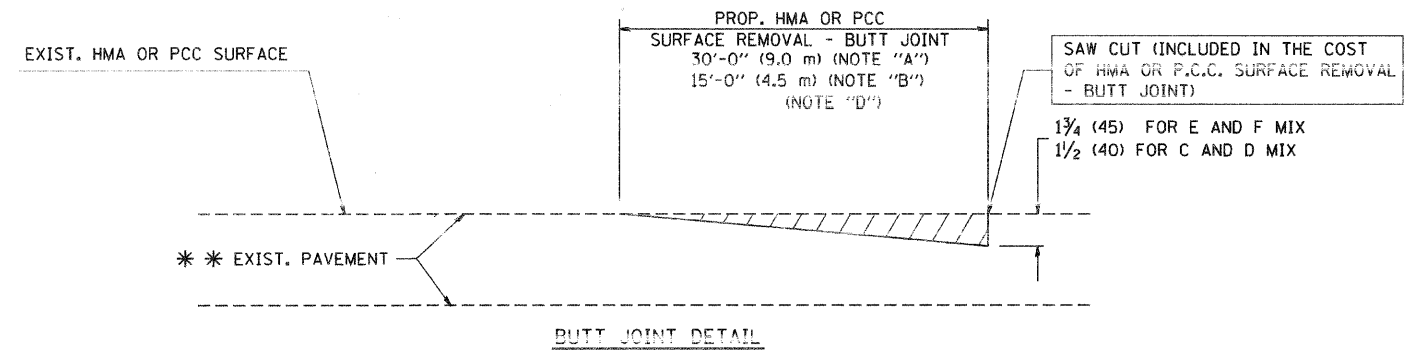

SAW CUT (INCLUDED IN THE COST OF HMA OR P.C.C. SURFACE REMOVAL - BUTT JOINT)
1 3/4 (45) FOR E AND F MIX
1 1/2 (40) FOR C AND D MIX

BUTT JOINT DETAIL

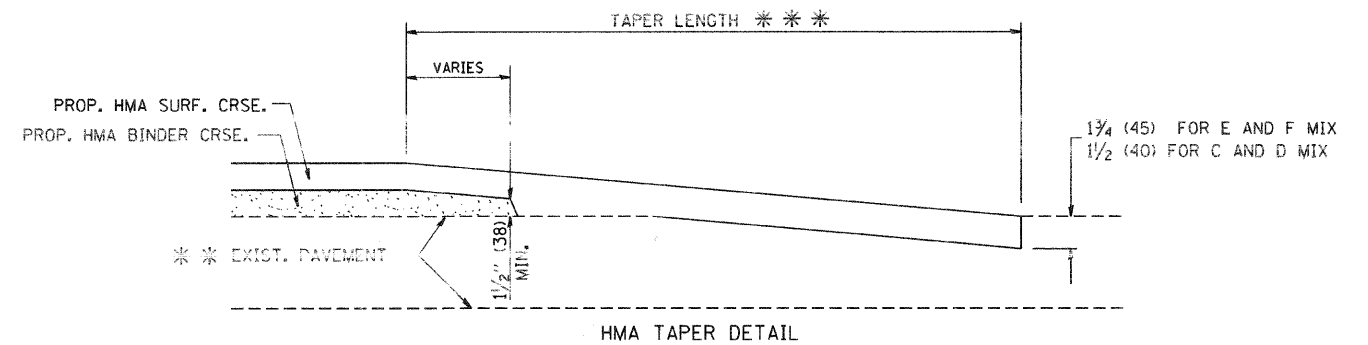

HMA TAPER DETAIL

TYPICAL BUTT JOINT AND HMA TAPER
FOR RESURFACING ONLY

*** PC CONCRETE, HMA OR HMA RESURFACED PAVEMENT.

NOTES

- A: MAINLINE ROADWAYS AND MAJOR SIDE ROADS.
 - B: MINOR SIDE ROADS.
 - C: THE TEMP. RAMP SHALL BE CONSTRUCTED IMMEDIATELY UPON REMOVAL OF THE EXISTING HMA SURFACE.
 - D: THE BUTT JOINT SHALL BE CONSTRUCTED IMMEDIATELY PRIOR TO PLACING THE PROPOSED HMA COURSES.
 - E: TAPER THE TEMP. RAMP AT A RATE OF 3'-0" (900 mm) PER 1 INCH (25 mm) OF MILLING THICKNESS.
 - F: INSTALLATION AND REMOVAL OF THE 4'-6" (1.35 m) TEMP. RAMP IS INCLUDED IN COST OF HMA SURFACE REMOVAL - BUTT JOINT
 - G: SEE ARTICLE 406.08 AND 406.14 OF THE STANDARD SPECIFICATIONS FOR "HMA AND/OR PCC SURFACE REMOVAL, BUTT JOINT".
- * SEE TYPICAL SECTIONS FOR MILLING THICKNESS.
- *** 20'-0" (6.1 m) PER 1 (25) RESURFACING (NOTE "A")
10'-0" (3.0 m) PER 1 (25) RESURFACING (NOTE "B")

BASIS OF PAYMENT:

THE BUTT JOINT WILL BE PAID FOR AT THE CONTRACT UNIT PRICE PER SQUARE YARD (SQUARE METER) FOR "HOT-MIX ASPHALT SURFACE REMOVAL - BUTT JOINT" OR FOR "PORTLAND CEMENT CONCRETE SURFACE REMOVAL - BUTT JOINT".

ALL DIMENSIONS ARE IN INCHES (MILLIMETERS) UNLESS OTHERWISE SHOWN.

FILE NAME =	USER NAME = geglinoht	DESIGNED - M. DE YONG	REVISED - R. SHAH 10-25-94
W:\dstated\22x34\bd32.dgn		DRAWN -	REVISED - A. ABBAS 03-21-97
	PLOT SCALE = 50.0000' / IN.	CHECKED -	REVISED - M. GOMEZ 04-06-01
	PLOT DATE = 1/4/2008	DATE - 06-13-90	REVISED - R. BORO 01-01-07

STATE OF ILLINOIS
DEPARTMENT OF TRANSPORTATION

BUTT JOINT AND
HMA TAPER DETAILS

SCALE: NONE SHEET NO. 1 OF 1 SHEETS STA. TO STA.

F.A. RTE.	SECTION	COUNTY	TOTAL SHEETS	SHEET NO.
	08-00098-00-SW	DUPAGE	22	19
BD400-05 BD32			CONTRACT NO. 63132	
FED. ROAD DIST. NO. 1 ILLINOIS FED. AID PROJECT				

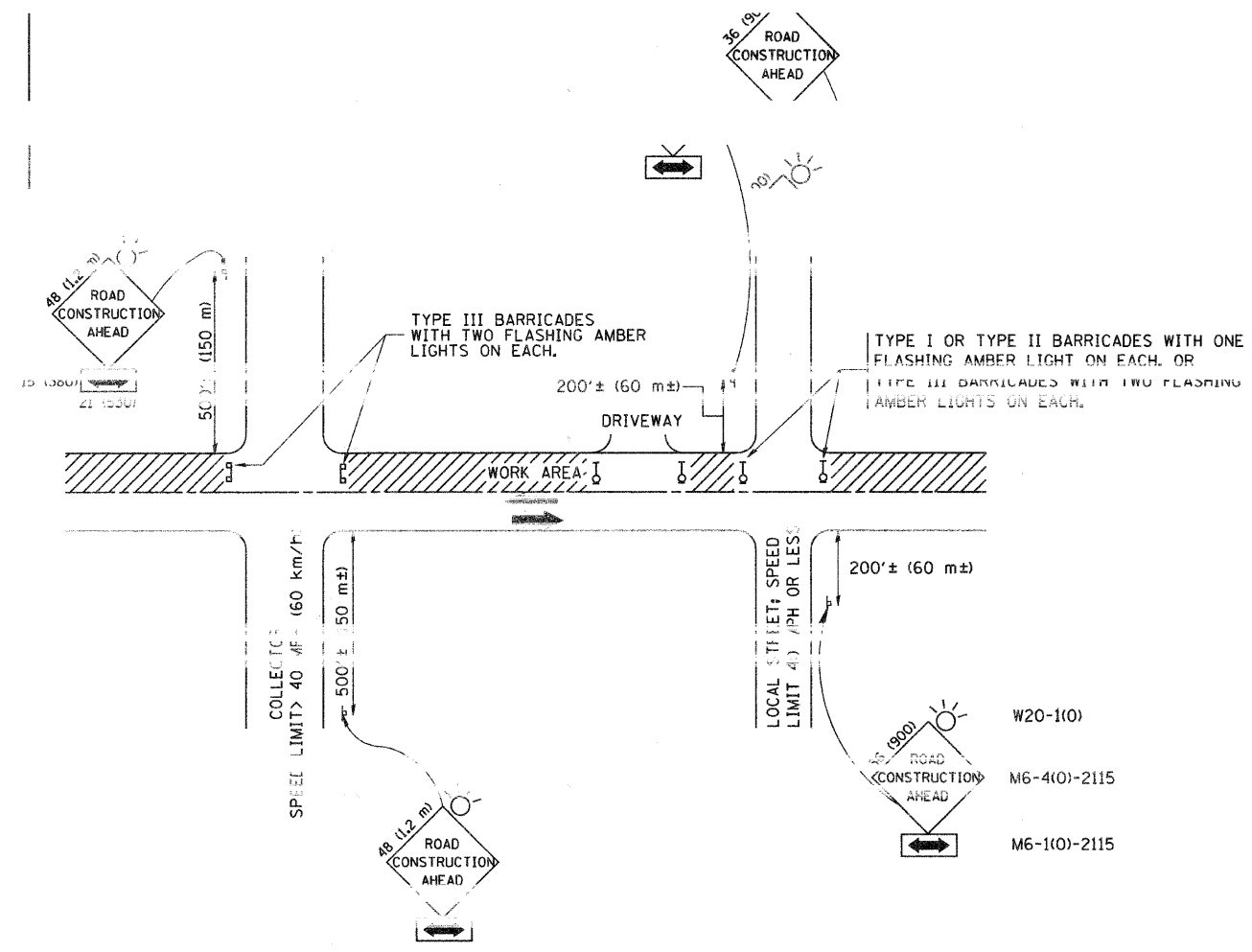

TRAFFIC CONTROL AND PROTECTION FOR SIDE ROADS, INTERSECTIONS, AND DRIVEWAYS

NOTES:

- A. FOR NO LANE RESTRICTION ON THE SIDE ROAD OR DRIVEWAYS
 1. SIDE ROAD WITH A SPEED LIMIT OF 40 MPH (60 km/h) OR LESS AS SHOWN ON THE DRAWING AND AS DIRECTED BY THE ENGINEER:
 - a) ONE ROAD CONSTRUCTION AHEAD SIGN 36 x 36 (900x900) WITH A FLASHER AND FLAG MOUNTED ON IT APPROXIMATELY 200' (60 m) IN ADVANCE OF THE MAIN ROUTE.
 - b) THE CLOSED PORTION OF THE MAIN ROUTE SHALL BE PROTECTED BY BLOCKING WITH TYPE I, TYPE II OR TYPE III BARRICADES, 1/3 OF THE CROSS SECTION OF THE CLOSED PORTION.
 2. SIDE ROAD WITH A SPEED LIMIT GREATER THAN 40 MPH (60 km/h) AS SHOWN ON THE DRAWING AND AS DIRECTED BY THE ENGINEER:
 - a) ONE ROAD CONSTRUCTION AHEAD SIGN 48 x 48 (1.2 m x 1.2 m) WITH A FLASHER MOUNTED ON IT APPROXIMATELY 500' (150 m) IN ADVANCE OF THE MAIN ROUTE.
 - b) THE CLOSED PORTION OF THE MAIN ROUTE SHALL BE PROTECTED BY BLOCKING WITH TYPE III BARRICADES, 1/2 OF THE CROSS SECTION OF THE CLOSED PORTION.
 3. WHEN THE SIDE ROAD LIES BETWEEN THE BEGINNING OF THE MAINLINE SIGNING AND THE WORK ZONE, A SINGLE HEADED ARROW (M6-1) SHALL BE USED IN LIEU OF THE DOUBLE HEADED ARROW (M6-4).
- B. FOR A LANE CLOSURE ON A SIDE ROAD OR DRIVEWAY:
 - USE APPLICABLE PORTIONS OF THE TYPICAL APPLICATION OF TRAFFIC CONTROL DEVICES (STD. 701501, STD. 701606 OR THE APPROPRIATE STANDARD). THE SPACING OF SIGNS AND BARRICADES SHALL BE ADJUSTED FOR FIELD CONDITIONS AS DIRECTED BY THE ENGINEER. THE DIRECTIONAL ARROW SHALL BE COVERED OR REMOVED WHEN NO LONGER CONSISTENT WITH THE SIDE ROAD LANE CLOSURE.
 - C. ADVANCE WARNING SIGNS ARE TO BE OMITTED ON DRIVEWAY UNLESS OTHERWISE NOTED.
 - D. THE TRAFFIC CONTROL AND PROTECTION FOR SIDE ROADS, INTERSECTIONS, AND DRIVEWAYS SHALL BE INCIDENTAL TO THE COST OF SPECIFIED TRAFFIC CONTROL STANDARDS OR ITEMS.

All dimensions are in millimeters (inches) unless otherwise shown.

FILE NAME = W:\diststd\22x34\tbl8.dgn	USER NAME = geglianobt	DESIGNED - LHA	REVISED - J. OBERLE 10-18-95	STATE OF ILLINOIS DEPARTMENT OF TRANSPORTATION	TRAFFIC CONTROL AND PROTECTION FOR SIDE ROADS, INTERSECTIONS, AND DRIVEWAYS			F.A. RTE.	SECTION	COUNTY	TOTAL SHEETS	SHEET NO.
	PLOT SCALE = 50.000' / IN.	DRAWN -	REVISED - A. HOUSEH 03-06-96					08-00098-00-SW	DUPAGE	22	20	
	PLOT DATE = 1/4/2008	CHECKED -	REVISED - A. HOUSEH 10-15-96					TC-10		CONTRACT NO. 63132		
	DATE - 06-89	REVISED - T. RAMMACHER 01-06-00		SCALE: NONE	SHEET NO. 1 OF 1 SHEETS	STA. TO STA.	FED. ROAD DIST. NO. 1 ILLINOIS FED. AID PROJECT					

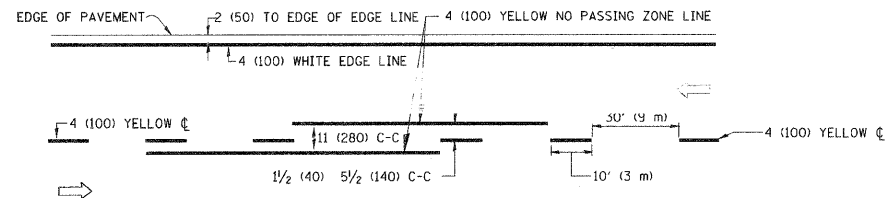

2-LANE ROADWAY

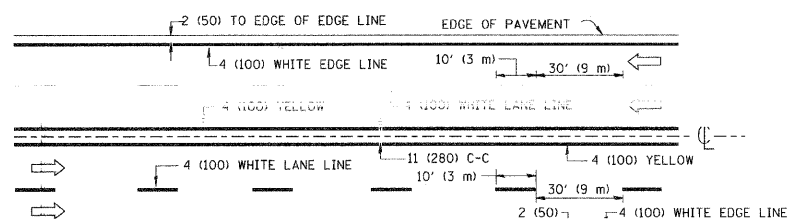

MULTI-LANE UNDIVIDED

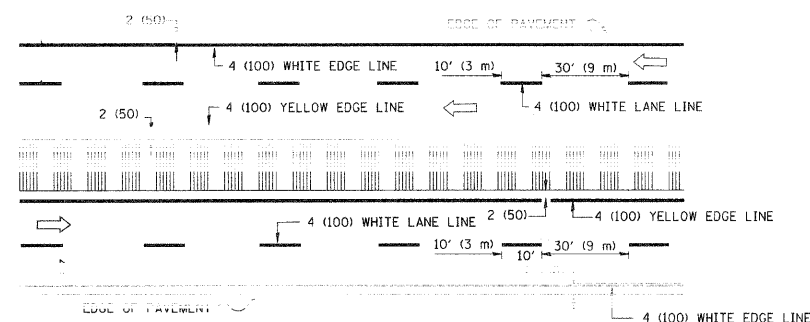

MULTI-LANE DIVIDED WITH MOUNTABLE MEDIAN

NOTE: MEDIANS WITH BARRIER CURB DO NOT REQUIRE AN EDGE LINE

TYPICAL LANE AND EDGE LINE MARKING

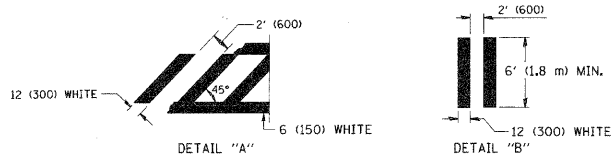
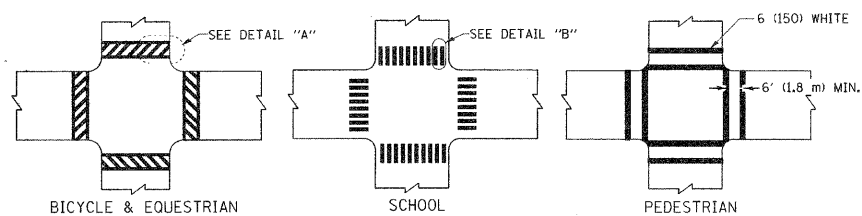

TYPICAL CROSSWALK MARKING

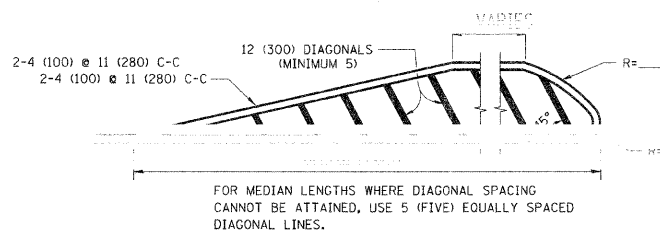
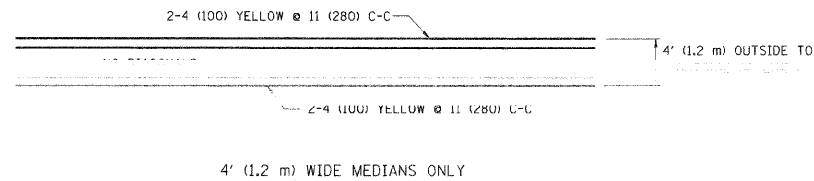

MEDIANS OVER 4' (1.2 m) WIDE

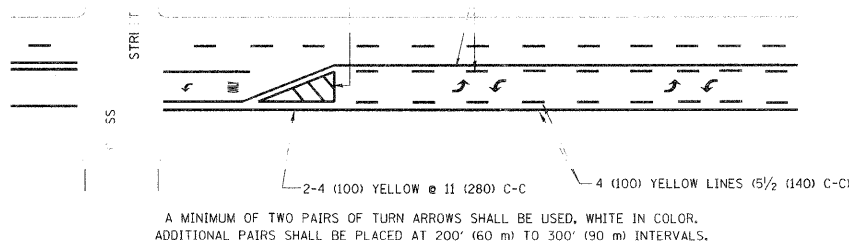

MEDIAN WITH TWO-WAY LEFT TURN LANE

TYPICAL PAINTED MEDIAN MARKING

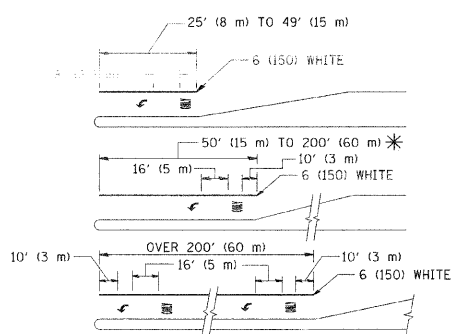

FULL SIZE LETTERS 8' (2.4 m) AND ARROWS SHALL BE USED.
 * TURN LANES IN EXCESS OF 400' (120 m) IN LENGTH MAY HAVE AN ADDITIONAL SET OF ARROW - "ONLY" INSTALLED MIDWAY BETWEEN THE OTHER TWO SETS OF ARROW - "ONLY".

TYPICAL LEFT (OR RIGHT) TURN LANE

TYPICAL TURN LANE MARKING

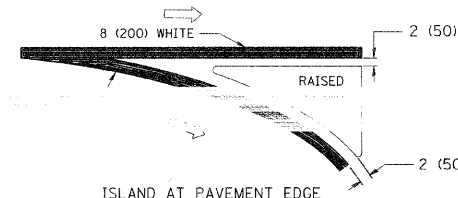
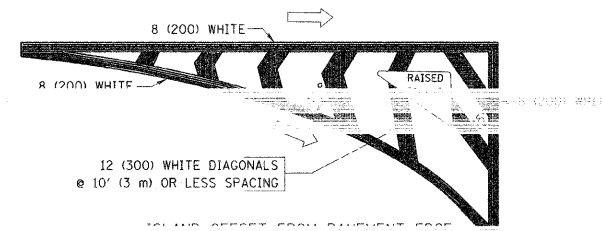

TYPICAL ISLAND MARKING

TYPE OF MARKING	WIDTH OF LINE	PATTERN	COLOR	SPACING / REMARKS
CONTINUED LINE ON MEDIAN UNDIVIDED PAVEMENT	2 @ 4 (100)	SOLID	YELLOW	11 (280) C-C
NO PASSING ZONE LINES: FOR ONE DIRECTION FOR BOTH DIRECTIONS	4 (100) 2 @ 4 (100)	SOLID	YELLOW YELLOW	5/2 (140) C-C FROM SKIP-DASH CENTERLINE 11 (280) C-C OMIT SKIP-DASH CENTERLINE BETWEEN
DOTTED LINES (EXTENSIONS OF CENTER, LANE OR TURN LANE MARKINGS)	2 @ 4 (100) ON FREELANE	SKIP-DASH	WHITE	2' (600) LINE WITH 6' (1.8 m) SPACE
EDGE LINES	4 (100)	SOLID	YELLOW-LEFT WHITE-RIGHT	OUTLINE MOUNTABLE MEDIANS IN YELLOW; EDGE LINES ARE NOT USED NEXT TO BARRIER CURB
TURN LANE MARKINGS	6 (150) LINE FULL SYMBOLS (8' (2.4m))	SOLID	WHITE	SEE TYPICAL TURN LANE MARKING DETAIL
TWO WAY LEFT TURN MARKING	2 @ 4 (100) EACH DIRECTION R' (2.4m) LEFT ARROW	SKIP-DASH AND SOLID IN PAIRS	YELLOW WHITE	10' (3 m) LINE WITH 30' (9 m) SPACE FOR SKIP-DASH; 5/2 (140) C-C BETWEEN SOLID LINE AND SKIP-DASH LINE SEE TYPICAL TWO-WAY LEFT TURN MARKING DETAIL
A. DIAGONALS (BIKE & EQUESTRIAN) B. LONGITUDINAL BARS (SCHOOL)	12 (300) @ 45° 12 (300) @ 90°	SOLID SOLID	WHITE WHITE	NOTE: 12 (300) APART FOR BIKE AND EQUESTRIAN 2' (600) APART FOR SCHOOL SEE TYPICAL CROSSWALK MARKING DETAILS.
STOP LINES	24 (600)	SOLID	WHITE	PLACE 4' (1.2 m) IN ADVANCE OF AND PARALLEL TO CROSSWALK, IF PRESENT. OTHERWISE, PLACE AT DESIRED STOPPING POINT, PARALLEL TO CROSSROAD CENTERLINE, WHERE POSSIBLE
PAINTED MEDIANS	2 @ 4 (100) WITH 12 (300) DIAGONALS @ 45° NO DIAGONALS USED FOR 4' (1.2 m) WIDE MEDIANS	SOLID	YELLOW; TWO WAY TRAFFIC WHITE; ONE WAY TRAFFIC	11 (280) C-C FOR THE DOUBLE LINE SEE TYPICAL PAINTED MEDIAN MARKING.
GORE MARKING AND CHANNELIZING LINES	8 (200) WITH 12 (300) DIAGONALS @ 45°	SOLID	WHITE	DIAGONALS: 15' (4.5 m) C-C (LESS THAN 30MPH (50 km/h)) 20' (6 m) C-C 30MPH (50 km/h) TO 45MPH (70 km/h) 30' (9 m) C-C (OVER 45MPH (70 km/h))
RAILROAD CROSSING	24 (600) TRANSVERSE LINES: "RR" IS 6' (1.8 m) LETTERS: 16 (400) LINE FOR "X"	SOLID	WHITE	SEE STATE STANDARD 780001 AREA OF: "R"=3.6 SQ. FT. (0.33 m ²) EACH "X"=54.0 SQ. FT. (5.0 m ²)
SHOULDER DIAGONALS	12 (300) @ 45°	SOLID	WHITE - RIGHT YELLOW - LEFT	50' (15 m) C-C (LESS THAN 30MPH (50 km/h)) 75' (25 m) C-C (30 MPH (50 km/h) TO 45MPH (70 km/h)) 150' (45 m) C-C (OVER 45MPH (70 km/h))

FOR FURTHER DETAILS ON PAVEMENT MARKING REFER TO STANDARD SPECIFICATIONS FOR ROAD AND BRIDGE CONSTRUCTION AND STATE STANDARD 780001.

All dimensions are in inches (millimeters) unless otherwise shown.

PLAN	NO.	BY	DATE
NO.			
NO.			
NO.			
NO.			
NO.			

PROFILE	NO.	BY	DATE
NO.			
NO.			
NO.			
NO.			
NO.			

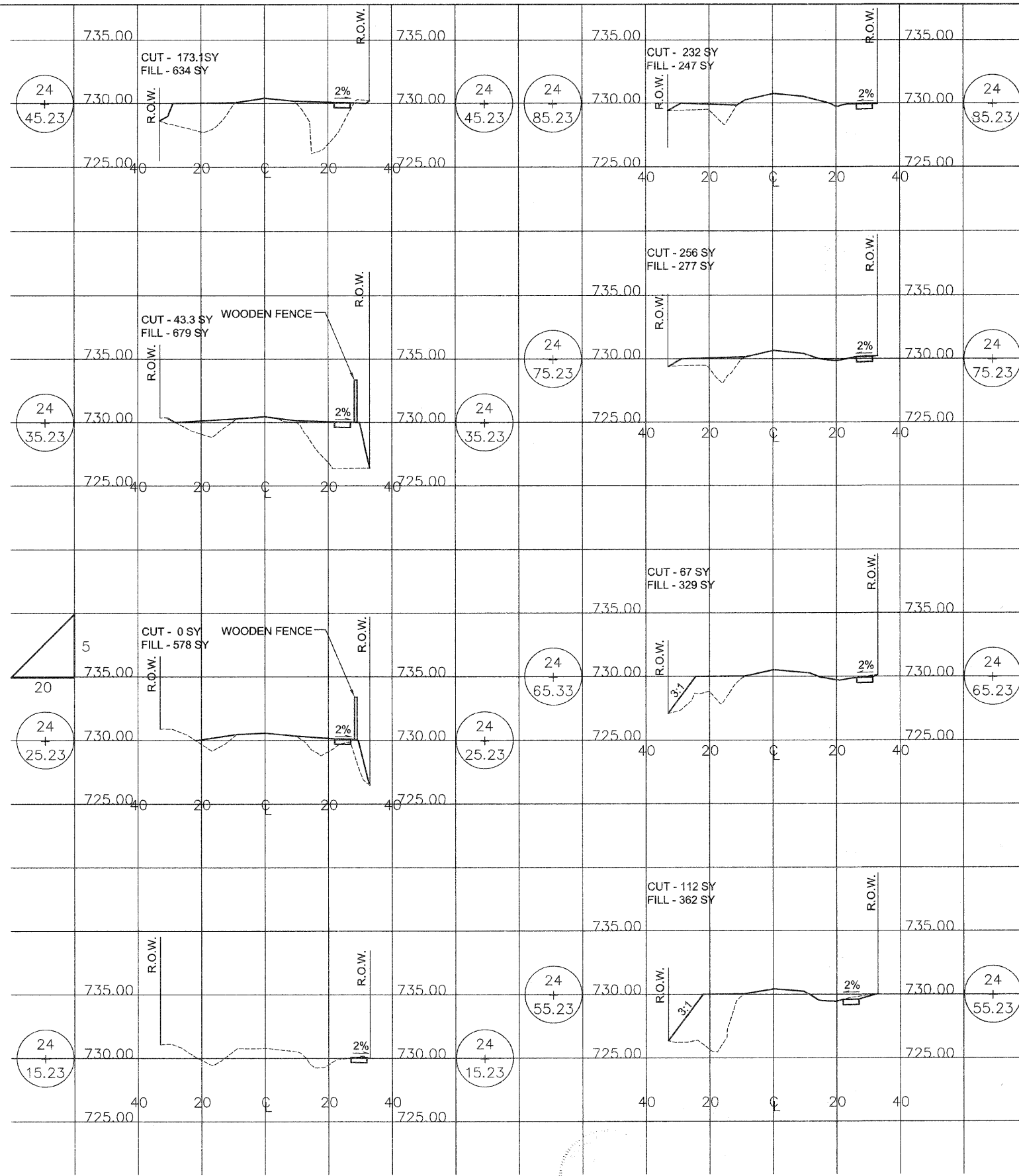

60th STREET CROSS SECTION

FILE NAME =	USER NAME =	DESIGNED -- MB	REVISED --
		DRAWN -- MB	REVISED --
		CHECKED -- A.J.R.	REVISED --
		DATE -- 10/29/2008	REVISED --

**STATE OF ILLINOIS
DEPARTMENT OF TRANSPORTATION**

SCALE:

F.A.U. RTE.	SECTION	COUNTY	TOTAL SHEETS	SHEET NO.
-	08-00098-00-SW	DUPAGE	22	22
SIDEWALK PROJECT			CONTRACT NO. 63132	
FED. ROAD DIST. NO. 1 ILLINOIS FED. AID PROJECT				