

DATE	
BY	
REVISIONS	
ALIGNED	CHECKED
NOTE BOOK	CHECKED
NO.	
PLAN	
NO.	

DATE	
BY	
REVISIONS	
GRADES CHECKED	
NOTE BOOK	
NO.	
PROFILE	
NO.	

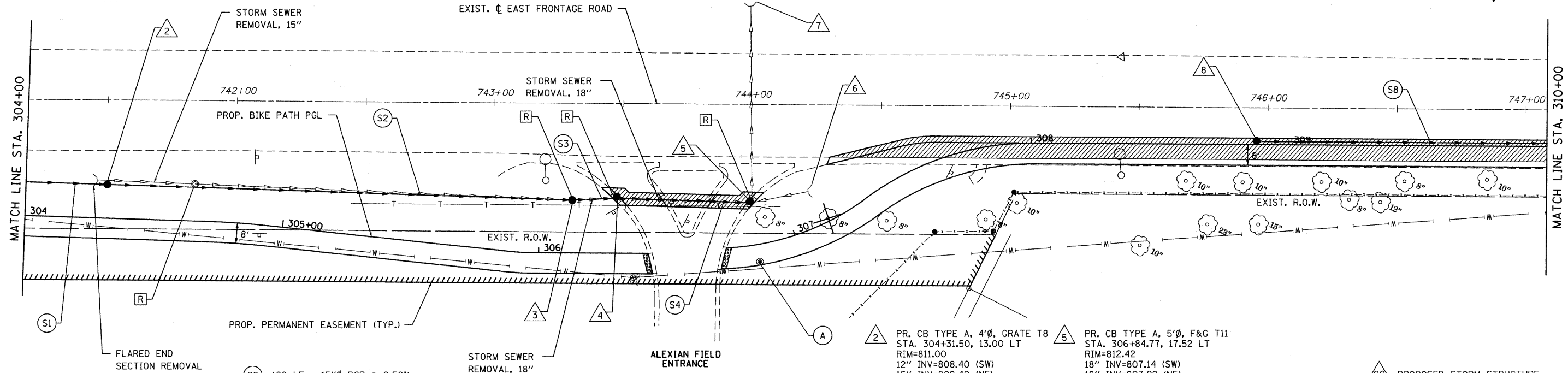

- (S2) 180 LF - 15" RCP @ 0.50%  
T.B.F. = 0.0 CU. YD.
- (S3) 17 LF - 18" RCP @ 0.53%  
T.B.F. = 1.3 CU. YD.
- (S4) 53 LF - 18" RCP @ 0.51%  
T.B.F. = 23.3 CU. YD.
- (S8) 204 LF - 12" RCP @ 1.00%  
T.B.F. = 189.2 CU. YD.

- 2 PR. CB TYPE A, 4'Ø, GRATE T8  
STA. 304+31.50, 13.00 LT  
RIM=811.00  
12" INV=808.40 (SW)  
15" INV=808.40 (NE)
- 3 PR. CB TYPE A, 4'Ø, GRATE T8  
STA. 306+12.91, 20.56 LT  
RIM=811.71  
15" INV=807.50 (SW)  
18" INV=807.50 (NE)
- 4 PR. CB TYPE A, 4'Ø, F&G T11  
STA. 306+30.62, 22.11 LT  
RIM=812.40  
18" INV=807.41 (SW, NE)
- 5 PR. CB TYPE A, 5'Ø, F&G T11  
STA. 306+84.77, 17.52 LT  
RIM=812.42  
18" INV=807.14 (SW)  
18" INV=807.92 (NE)  
24" INV=804.97 (N)
- 6 EX. FES  
18" INV=809.84
- 7 EX. FES  
24" INV=804.94
- 8 PR. CB TYPE C, F&G T24  
STA. 308+91.80, 2.50 LT  
RIM=812.84  
12" INV=804.70 (NE)

- (S) PROPOSED STORM STRUCTURE
- (O) PROPOSED STORM SEWER
- (AD) STRUCTURE TO BE ADJUSTED
- (A) VALVE VAULT TO BE ADJUSTED
- (R) STRUCTURE TO BE REMOVED

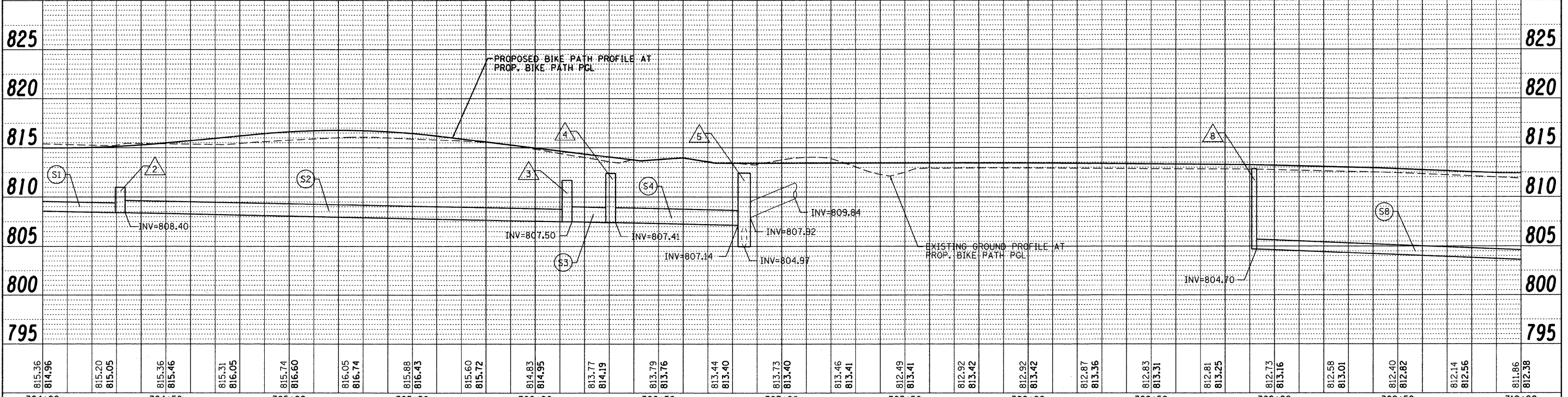

FILE NAME = ...\\D163355-shd-drain2.dgn	USER NAME = gellwanger	DESIGNED - LP	REVISED -	<b>STATE OF ILLINOIS DEPARTMENT OF TRANSPORTATION</b>	<b>IRVING PARK ROAD BIKE PATH DRAINAGE AND UTILITIES</b>	F.A. RTE.	SECTION	COUNTY	TOTAL SHEETS	SHEET NO.
PLOT SCALE = 20.00' / IN.	CHECKED - JP	REVISED -	07-00091-00-BT			COOK	70	23		
PLOT DATE = 12/26/2010	DATE - 10/26/2010	REVISED -	CONTRACT NO. 63355							
			FED. ROAD DIST. NO. 1 ILLINOIS FED. AID PROJECT							