

- 12 PR. MH TYPE A, 4'Ø, F&G T1, CL
STA. 318+30.53, 9.89 LT
RIM=804.08
12" INV=798.83 (NW)
12" INV=797.30 (W)
15" INV=794.40 (E)
- 13 PR. CB TYPE C, GRATE T8
STA. 318+47.50, 5.00 LT
RIM=801.61
12" INV=794.50 (N)
- 14 PR. MH TYPE A, 5'Ø, F&G T1, CL
STA. 319+74.68, 10.00 LT
RIM=800.12
12" INV=796.95 (NW)
15" INV=793.94 (W)
21" INV=793.94 (E)
- 15 PR. CB TYPE C, GRATE T8
STA. 320+32.47, 9.00 LT
RIM=797.71
12" INV=794.15 (SW)
- 16 PR. MH TYPE A, 5'Ø, F&G T1, CL
STA. 320+63.35, 2.00 LT
RIM=798.31
21" INV=793.67 (E, W)
- 17 PR. CB TYPE C, GRATE T8
STA. 321+27.60, 12.52 LT
RIM=797.22
12" INV=793.87 (S)
- 18 PR. MH TYPE A, 5'Ø, F&G T1, CL
STA. 321+39.42, 5.55 LT
RIM=799.15
12" INV=794.50 (NW)
21" INV=793.44 (W)
24" INV=793.44 (E)

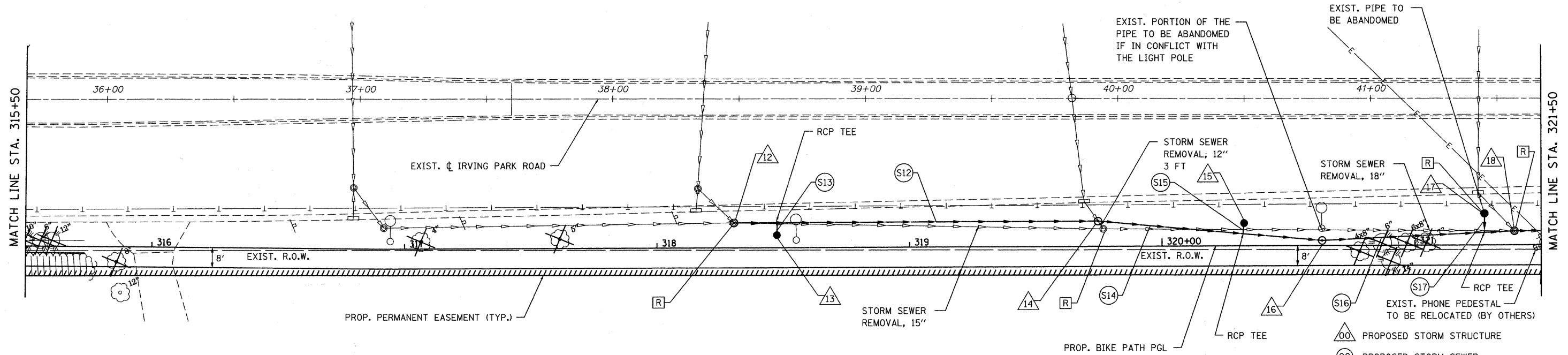

PLAN	REVISIONS	DATE
NO.	NO.	
NO.	NO.	
NO.	NO.	
NO.	NO.	

PROFILE	REVISIONS	DATE
NO.	NO.	
NO.	NO.	
NO.	NO.	
NO.	NO.	



- S12 142 LF - 15"Ø RCP @ 0.32%
T.B.F. = 0.0 CU. YD.
- S13 3 LF - 12"Ø RCP @ 0.50%
T.B.F. = 0.0 CU. YD.
- S14 87 LF - 21"Ø RCP @ 0.31%
T.B.F. = 0.0 CU. YD.
- S15 2 LF - 12"Ø RCP @ 0.50%
T.B.F. = 0.0 CU. YD.
- S16 74 LF - 21"Ø RCP @ 0.31%
T.B.F. = 0.0 CU. YD.
- S17 5 LF - 12"Ø RCP @ 0.50%
T.B.F. = 0.0 CU. YD.

- △ PROPOSED STORM STRUCTURE
- PROPOSED STORM SEWER
- ADJ STRUCTURE TO BE ADJUSTED
- A VALVE VAULT TO BE ADJUSTED
- R STRUCTURE TO BE REMOVED

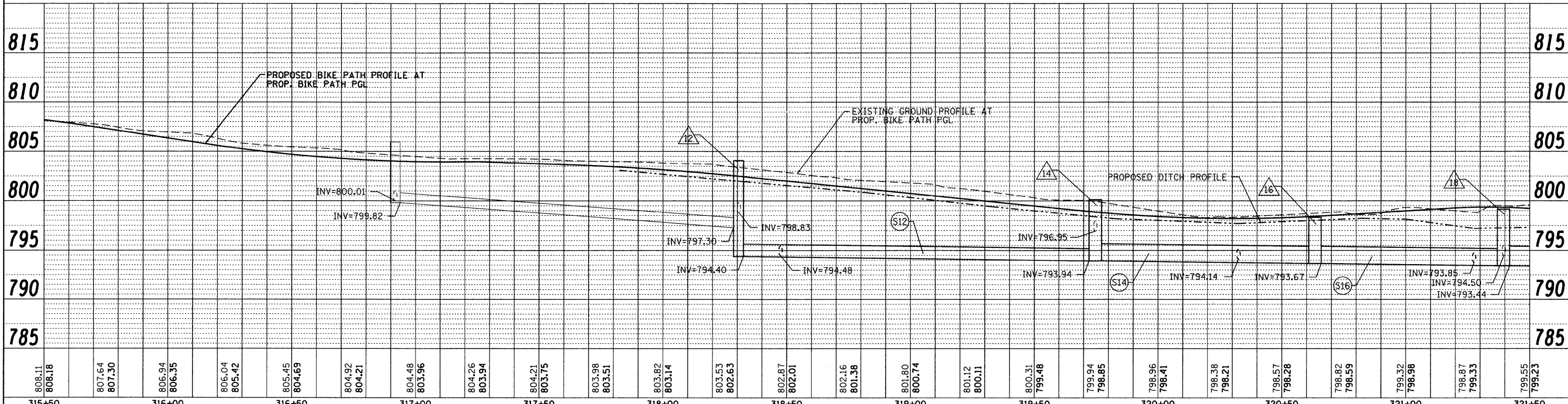

FILE NAME = ...ND163355-shd-drain4.dgn	USER NAME = gellwanger	DESIGNED - LP	REVISED -	STATE OF ILLINOIS DEPARTMENT OF TRANSPORTATION	IRVING PARK ROAD BIKE PATH DRAINAGE AND UTILITIES	F.A. RTE.	SECTION	COUNTY	TOTAL SHEETS	SHEET NO.	
PLOT SCALE = 28.00' / IN.						HORIZ. 1"=20'		07-00091-00-BT		70 25	
PLOT DATE = 10/27/2010						SCALE: VERT. 1"=5'		SHEET NO. 25 OF 70 SHEETS		CONTRACT NO. 63355	
DATE = 10/26/2010						STA. 315+50 TO STA. 321+50		FED. ROAD DIST. NO. 1 ILLINOIS FED. AID PROJECT			