

TRAFFIC SIGNAL NOTES

- ① REMOVE THE EXISTING PEDESTRIAN SIGNAL HEAD AND INSTALL PEDESTRIAN SIGNAL HEAD, L.E.D., 1-FACE, BRACKET MOUNTED REUSING THE EXISTING ELECTRIC CABLE IN CONDUIT, SIGNAL, NO 14 3/C.
- ② INSTALL PEDESTRIAN PUSH BUTTON AND PEDESTRIAN SIGNAL HEAD, L.E.D., 1-FACE, BRACKET MOUNTED ON THE EXISTING TRAFFIC SIGNAL POST. PULL ELECTRIC CABLE IN CONDUIT, SIGNAL, NO 14 3/C AND ELECTRIC CABLE IN CONDUIT, SIGNAL, NO 14 2/C FROM THE EXISTING TRAFFIC SIGNAL CONTROLLER.
- ③ THE REMOVAL AND REPLACEMENT OF SIDEWALK, DRIVEWAY, MEDIAN AND ISLAND SURFACE PAVING AT HANDHOLES, JACKING PITS AND INSPECTION OPENINGS SHALL BE SAW CUT AROUND THE AREA TO BE REMOVED. THE REMOVAL AND REPLACEMENT OF SIDEWALK, DRIVEWAY, MEDIAN AND ISLAND SURFACE PAVING WILL BE PAID FOR SEPARATELY.
- ④ THE EXACT LOCATION OF ALL UTILITIES SHALL BE FIELD VERIFIED BY THE CONTRACTOR BEFORE THE INSTALLATION OF ANY COMPONENTS OF THE TRAFFIC SIGNAL SYSTEM. FOR LOCATION OF UTILITIES, CALL J.U.L.I.E. TOLL FREE NUMBER 1-800-892-0123.
- ⑤ ALL SIGNAL POSTS AND MAST ARM POLES SHALL BE LOCATED WITH THEIR CENTERLINES A MINIMUM OF FOUR (4) FEET AND SIX (6) FEET RESPECTIVELY FROM THE BACK OF CURB UNLESS NOTED OR DIMENSIONED TO THE CONTRARY ON THE DRAWINGS. IN NON-CURBED AREAS THE MAST ARM POLE SHALL BE LOCATED A MINIMUM OF TEN (10) FEET BEHIND THE EDGE OF PAVEMENT OR TWO (2) FEET BEHIND THE EDGE OF SHOULDER, WHICHEVER DISTANCE IS GREATER. SIGNAL POSTS SHALL BE PLACED AT A MINIMUM OF TWO (2) FEET BEHIND THE EDGE OF SHOULDER.
- ⑥ REMOVE THE EXISTING PEDESTRIAN PUSH BUTTON AND INSTALL A NEW PEDESTRIAN PUSH BUTTON REUSING THE EXISTING ELECTRIC CABLE IN CONDUIT, SIGNAL, NO 14 2/C.

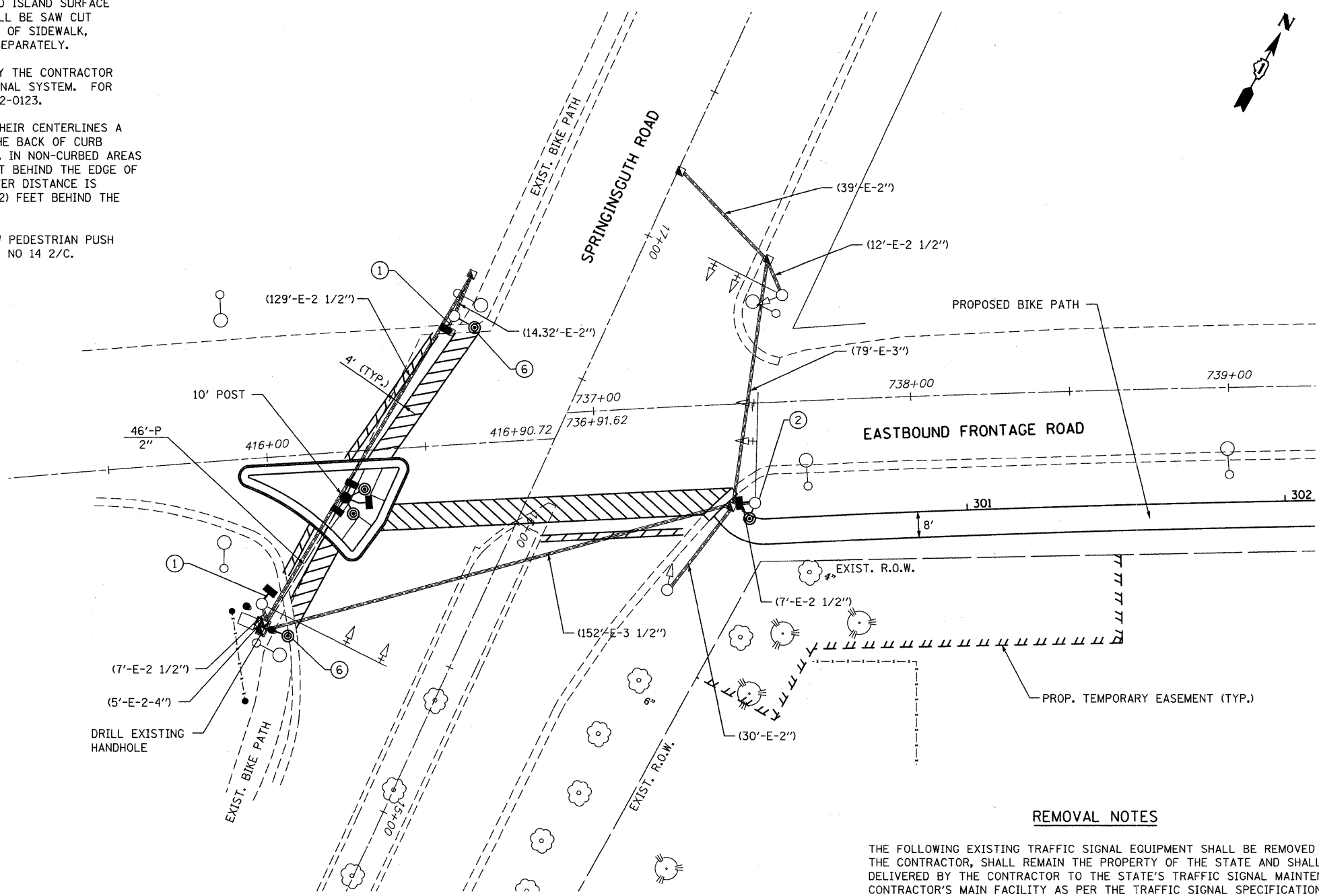

REMOVAL NOTES

THE FOLLOWING EXISTING TRAFFIC SIGNAL EQUIPMENT SHALL BE REMOVED BY THE CONTRACTOR, SHALL REMAIN THE PROPERTY OF THE STATE AND SHALL BE DELIVERED BY THE CONTRACTOR TO THE STATE'S TRAFFIC SIGNAL MAINTENANCE CONTRACTOR'S MAIN FACILITY AS PER THE TRAFFIC SIGNAL SPECIFICATIONS.

- 2 EACH PEDESTRIAN SIGNAL HEAD, 1-FACE, BRACKET MOUNTED
- 2 EACH PEDESTRIAN PUSH BUTTON

FILE NAME = ...VDI63355-sht-tal.dgn	USER NAME = gellwenger	DESIGNED - LP	REVISED -	STATE OF ILLINOIS DEPARTMENT OF TRANSPORTATION	IRVING PARK ROAD BIKE PATH TRAFFIC SIGNAL MODIFICATION PLAN			F.A. RTE.	SECTION	COUNTY	TOTAL SHEETS	SHEET NO.
		DRAWN - LP	REVISED -		07-00091-00-BT	COOK	70	51				
		CHECKED - JP	REVISED -		CONTRACT NO. 63355							
		DATE - 10/26/2010	REVISED -		FED. ROAD DIST. NO. 1 ILLINOIS FED. AID PROJECT							
				SCALE: 1" = 20'	SHEET NO. 51 OF 70 SHEETS	STA.	TO STA.					