

- LEGEND**
- ① EXISTING PAVEMENT
 - ② TEMPORARY PAVEMENT, 10" WITH SUB-BASE GRANULAR MATERIAL, TYPE B, 4" (INCIDENTAL TO TEMPORARY PAVEMENT)
 - ③ PROPOSED PAVEMENT
 - ④ TEMPORARY PAVEMENT MARKING

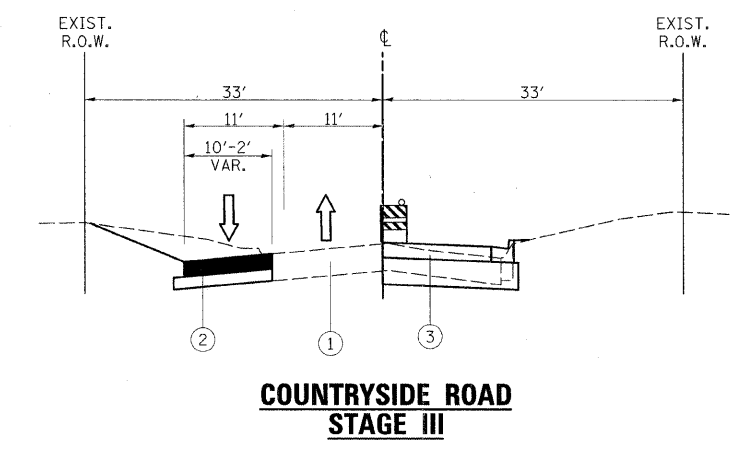
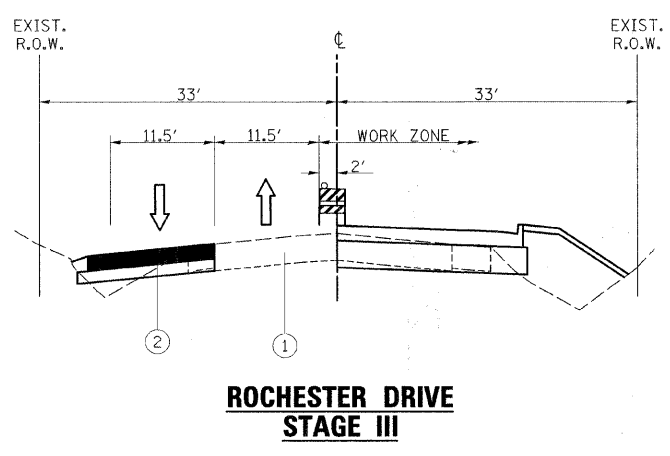
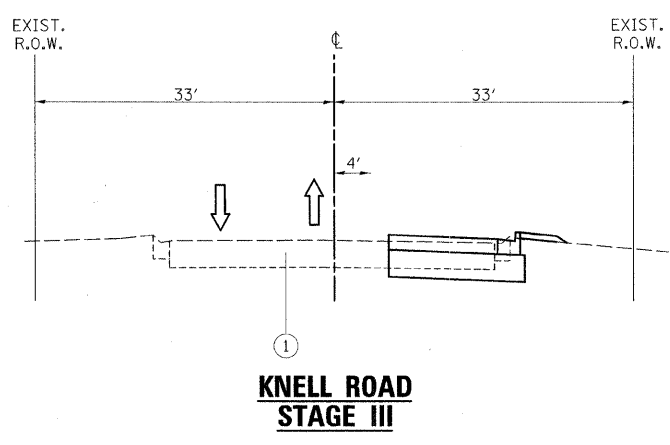
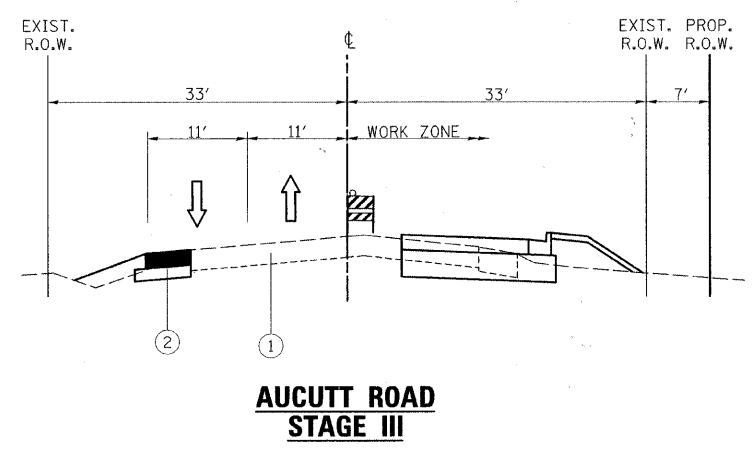

PROJECT CONSTRUCTION STAGE III

TRAFFIC MAINTENANCE:

ORCHARD ROAD - TRAFFIC SHALL BE MAINTAINED ON THE NEW ORCHARD ROAD PAVEMENT BUILT IN STAGE II WITH ONE LANE OF TRAFFIC IN EACH DIRECTION. SOUTHBOUND LEFT TURN LANES SHALL BE PROVIDED AT AUCUTT ROAD, KNELL ROAD AND JERICO ROAD. TRAFFIC CONTROL SHALL BE INSTALLED AS DETAILED IN THESE PLANS.

SIDE STREETS - TRAFFIC SHALL BE MAINTAINED ON THE EXISTING AND TEMPORARY SIDE STREET PAVEMENT WITH ONE LANE OF TRAFFIC IN EACH DIRECTION. TRAFFIC CONTROL SHALL BE INSTALLED AS DETAILED IN THESE PLANS

THE FOLLOWING WORK ITEMS ARE TO BE COMPLETED DURING STAGE III:

- TRAFFIC CONTROL ITEMS, TEMPORARY PAVEMENT MARKING AND OTHER TRAFFIC CONTROL DEVICES SHALL BE INSTALLED THROUGHOUT THE CONSTRUCTION AREA PRIOR TO WORK COMMENCING.
- GRADING AND EMBANKMENT CONSTRUCTION SHALL BE COMPLETED FOR THE NORTHBOUND LANES.
- CONSTRUCTION OF 4 CELL BOX CULVERT SHALL BE COMPLETED AS SHOWN IN THE PLANS.
- STORM SEWER LATERALS SHALL BE EXTENDED FOR NORTHBOUND LANES.
- CONSTRUCT NORTHBOUND PAVEMENT LANES AND OUTSIDE CURB AND GUTTER.
- CONSTRUCT SOUTHERN PORTION OF SIDE STREETS CONCRETE PAVEMENT AS SHOWN IN THESE PLANS
- INSTALL PERMANENT TRAFFIC SIGNALS AND LIGHTING FOUNDATIONS ALONG NORTHBOUND PAVEMENTS
- COMPLETE FINAL RESTORATION OF EAST EMBANKMENT SLOPES

ALL TEMPORARY PAVEMENT MARKING, ON FINAL PAVEMENT SURFACES, SHALL BE PAVEMENT MARKING TAPE, TYPE III UNLESS NOTED OTHERWISE

SEE STAGE IV TYPICAL SECTIONS AND NOTES FOR ADDITIONAL MAINTENANCE OF TRAFFIC NOTES.

| | |
|-------------------|-----------|
| DESIGNED - MK | REVISED - |
| DRAWN - DW | REVISED - |
| CHECKED - MH | REVISED - |
| DATE - 12/20/2010 | REVISED - |

| | | | | |
|--------------------|------------------------|-------------|---------------------------|--------------|
| F.A.P. RTE. 336 | SECTION 99-00232-01-WR | COUNTY KANE | TOTAL SHEETS 215 | SHEET NO. 31 |
| CONTRACT NO. 63541 | | | ILLINOIS FED. AID PROJECT | |