

- NOTES:
1. TYPICAL SECTIONS SHOWN FOR PAVEMENT COMPOSITION ONLY.
  2. ALL SIDE SLOPES AND GRADES ARE TO BE PER THE CROSS SECTIONS. SIDE SLOPE CONDITIONS SHOWN IN THE TYPICAL SECTIONS ARE GENERIC AND NOT TYPICAL.
  3. ALL STATIONING REFERS TO JERICHO ROAD CENTERLINE STATIONING.

- LEGEND
- 1 EXISTING PCC PAVEMENT
  - 2 EXISTING COMBINATION CONCRETE CURB AND GUTTER TYPE B-6.24
  - 3 EXISTING GROUND LINE
  - 4 PROPOSED PRECAST MODULAR RETAINING WALL, HEIGHT VARIES
  - 5 PROPOSED HOT MIX ASPHALT SURFACE COURSE, MIX "C", N50, 2"
  - 6 PROPOSED SUBBASE GRANULAR MATERIAL, TYPE B, 8"
  - 7 PROPOSED TOPSOIL, FURNISH AND PLACE, 4"
- FES 1  
STA 308+73; 37' L  
18" FLARED END SECTION  
WITH GRATE  
IE 669.10 ME
- FES 2  
STA 309+13; 52' L  
18" FLARED END SECTION  
WITH GRATE  
IE 668.76 ME

PROJECT BEGINS  
STA 306+21

PROJECT ENDS  
STA 309+42

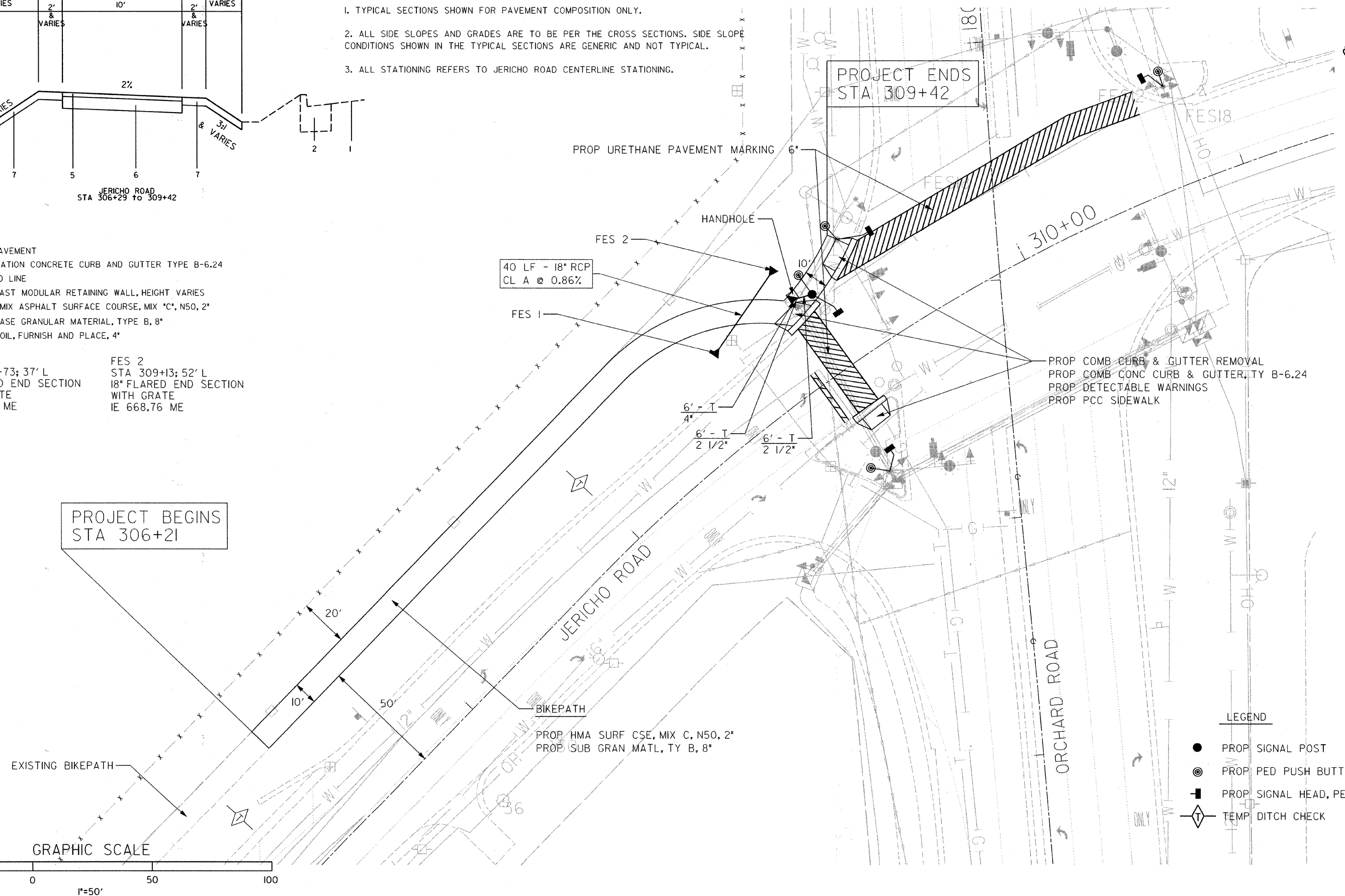

- PROP COMB CURB & GUTTER REMOVAL  
PROP COMB CONC CURB & GUTTER, TY B-6.24  
PROP DETECTABLE WARNINGS  
PROP PCC SIDEWALK

PROP HMA SURF CSE, MIX C, N50, 2"  
PROP SUB GRAN MATL, TY B, 8"

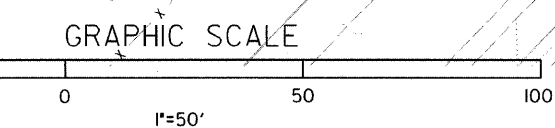

- LEGEND
- PROP SIGNAL POST
  - ⊙ PROP PED PUSH BUTTON
  - PROP SIGNAL HEAD, PED
  - ◇ TEMP DITCH CHECK

FILE NAME =	USER NAME = #USER#	DESIGNED -	REVISED -	KANE COUNTY DIVISION OF TRANSPORTATION	JERICHO ROAD BIKEPATH			F.A.P. RTE.	SECTION	COUNTY	TOTAL SHEETS	SHEET NO.
#FILEL#		DRAWN -	REVISED -		336	99-00232-01-WR	KANE	215	60			
	PLOT SCALE = #SCALE#	CHECKED -	REVISED -		SCALE:	SHEET NO. OF	SHEETS	STA.	TO STA.			
	PLOT DATE = #DATE#	DATE -	REVISED -					STA.	TO STA.			