

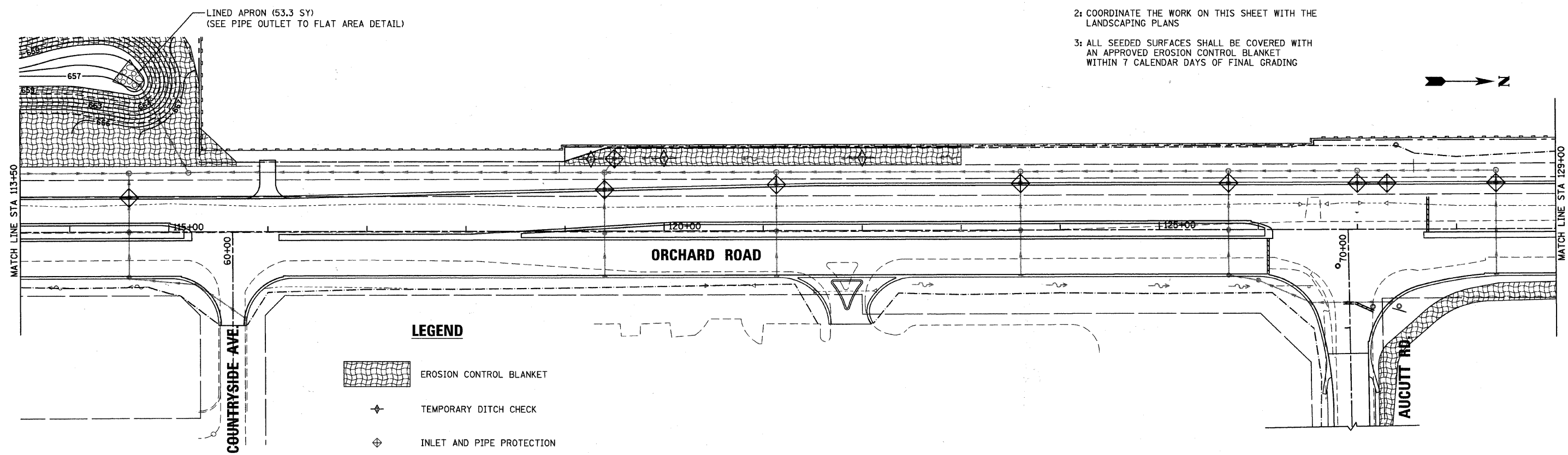





- NOTES:
- 1: FOR EROSION AND SEDIMENT CONTROL MEASURES AT STORMWATER BASINS SEE BASIN GRADING SHEETS
 - 2: COORDINATE THE WORK ON THIS SHEET WITH THE LANDSCAPING PLANS
 - 3: ALL SEEDED SURFACES SHALL BE COVERED WITH AN APPROVED EROSION CONTROL BLANKET WITHIN 7 CALENDAR DAYS OF FINAL GRADING

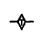

- LEGEND**
-  EROSION CONTROL BLANKET
 -  TEMPORARY DITCH CHECK
 -  INLET AND PIPE PROTECTION
 -  TEMPORARY FENCE
 -  PERIMETER EROSION BARRIER

50,000,000 / IN.
 d-radas
 1/20/2011
 K:\117782\CAD\Sheets\177782_Erosion_Stage2.dwg



200 West Front Street
Wheaton, IL 60187

DESIGNED - MK	REVISED -
DRAWN - DW	REVISED -
CHECKED - MH	REVISED -
DATE - 12/20/2010	REVISED -

**KANE COUNTY
DIVISION OF TRANSPORTATION
ORCHARD ROAD RECONSTRUCTION**

**EROSION AND SEDIMENT CONTROL PLAN
STAGE II**

SCALE: 1" = 50' SHEET NO. 2 OF 15 SHEETS STA. 100+00.00 TO STA. 129+00.00

F.A.P. RTE.	SECTION	COUNTY	TOTAL SHEETS	SHEET NO.
336	99-00232-01-WR	KANE	215	100
CONTRACT NO. 63541			ILLINOIS FED. AID PROJECT	