

- NOTES:
- 1: FOR EROSION AND SEDIMENT CONTROL MEASURES AT STORMWATER BASINS SEE BASIN GRADING SHEETS
  - 2: COORDINATE THE WORK ON THIS SHEET WITH THE LANDSCAPING PLANS
  - 3: ALL SEEDED SURFACES SHALL BE COVERED WITH AN APPROVED EROSION CONTROL BLANKET WITHIN 7 CALENDAR DAYS OF FINAL GRADING

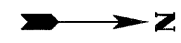
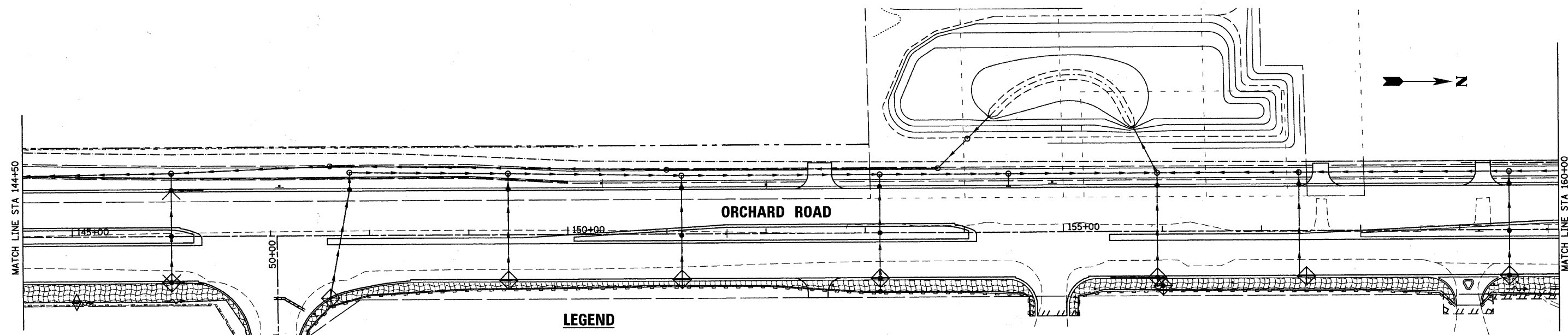

**LEGEND**

- EROSION CONTROL BLANKET
- TEMPORARY DITCH CHECK
- INLET AND PIPE PROTECTION
- TEMPORARY FENCE
- PERIMETER EROSION BARRIER

49,999 / IN.  
chadas  
1/20/2011  
K:\117782\CAD\Sheets\177782-Erosion-Stage3.dwg

|                   |           |
|-------------------|-----------|
| DESIGNED - MK     | REVISED - |
| DRAWN - DW        | REVISED - |
| CHECKED - MH      | REVISED - |
| DATE - 12/20/2010 | REVISED - |

| F.A.P. RTE.        | SECTION        | COUNTY | TOTAL SHEETS              | SHEET NO. |
|--------------------|----------------|--------|---------------------------|-----------|
| 336                | 99-00232-01-WR | KANE   | 215                       | 105       |
| CONTRACT NO. 63541 |                |        | ILLINOIS FED. AID PROJECT |           |