

UPON ACTIVATION OF ELECTRICAL SERVICE, CONTRACTOR SHALL VERIFY THAT THE VEHICLE DETECTION ZONES ARE DELINEATED AND THE DETECTION SYSTEM IS WORKING PROPERLY BEFORE THE SIGNALS ARE TURNED ON.

* CONDUIT IS FOR INTERCONNECT CABLE ONLY. QUANTITY INCLUDED IN INTERCONNECT PLANS.

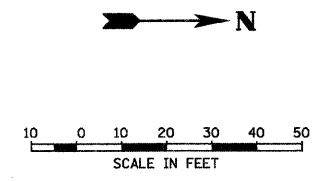
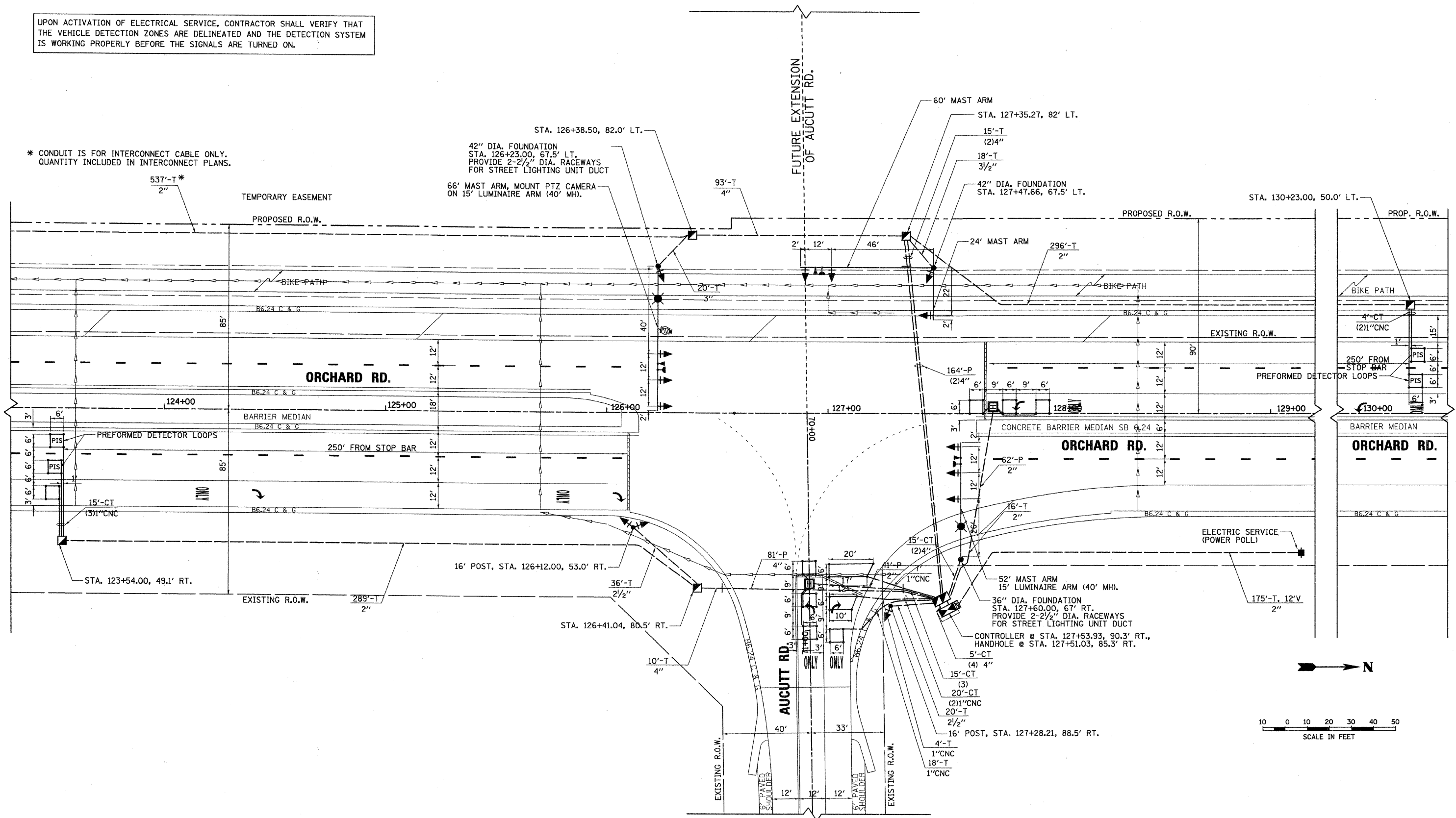

20.00000 / IN. 12/17/2010 12:11:17 PM C:\Users\jg\Documents\177762-Signal_Aucutt\perm\tdgn

rjngroup
 Excellence through Ownership
 200 West Front Street
 Wheaton, IL 60187

DESIGNED - MK	REVISED -
DRAWN - DW	REVISED -
CHECKED - MH	REVISED -
DATE - 12/20/2010	REVISED -

**KANE COUNTY
 DIVISION OF TRANSPORTATION
 ORCHARD ROAD RECONSTRUCTION**

**TRAFFIC SIGNAL INSTALLATION PLAN
 ORCHARD ROAD AND AUCUTT ROAD**

SCALE: 1" = 20' SHEET NO. 3 OF 13 SHEETS STA. TO STA.

F.A.P. RTE. 336	SECTION 99-00232-01-WR	COUNTY KANE	TOTAL SHEETS 215	SHEET NO. 115
CONTRACT NO. 63541				
ILLINOIS FED. AID PROJECT				