

\* QUANTITIES INCLUDED IN ROCHESTER DRIVE SIGNAL PLANS

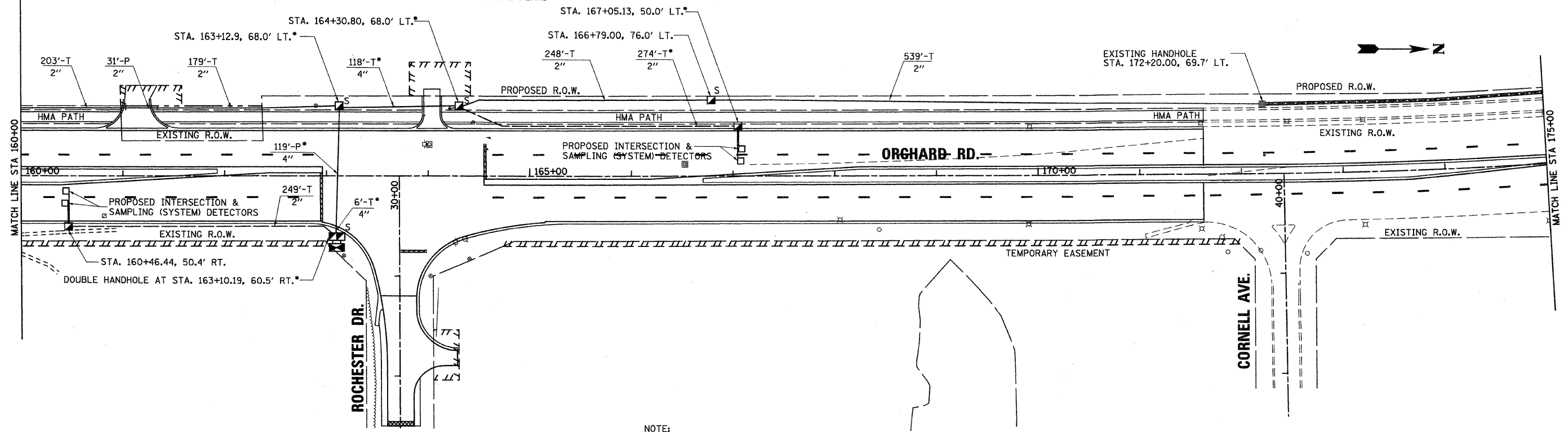

NOTE:

THE TRAFFIC SIGNAL CONTROLLER EQUIPMENT FOR THIS PROJECT SHALL BE "EAGLE" TO BE COMPATIBLE WITH KANE COUNTY'S EXISTING ADVANCE TRAFFIC MANAGEMENT SYSTEM (ATMS).

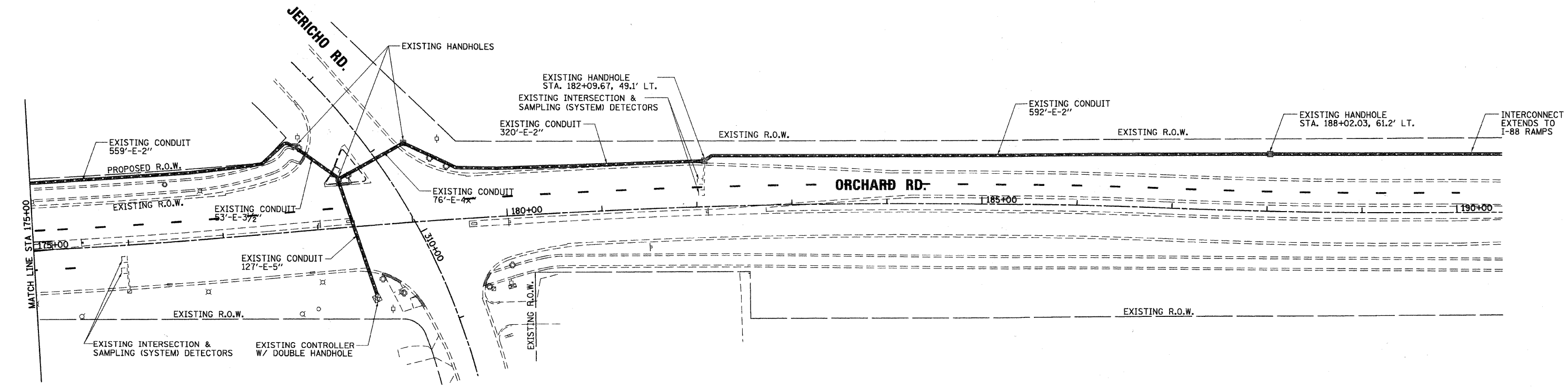

45.9999 / IN. dwg 12/17/2010 R:\117782\CAD\Sheets\177782\_Interconnect\_83.dgn



200 West Front Street  
Wheaton, IL 60187

DESIGNED - MK	REVISED -
DRAWN - DW	REVISED -
CHECKED - MH	REVISED -
DATE - 12/20/2010	REVISED -

**KANE COUNTY  
DIVISION OF TRANSPORTATION  
ORCHARD ROAD RECONSTRUCTION**

**ORCHARD ROAD INTERCONNECT PLAN**

SCALE: 1" = 50' SHEET NO. 8 OF 8 SHEETS STA. 160+00.00 TO STA. 190+00.00

F.A.P. RTE. 336	SECTION 99-00232-01-WR	COUNTY KANE	TOTAL SHEETS 215	SHEET NO. 126
				CONTRACT NO. 63541
ILLINOIS FED. AID PROJECT				