

STATE OF ILLINOIS
DEPARTMENT OF TRANSPORTATION

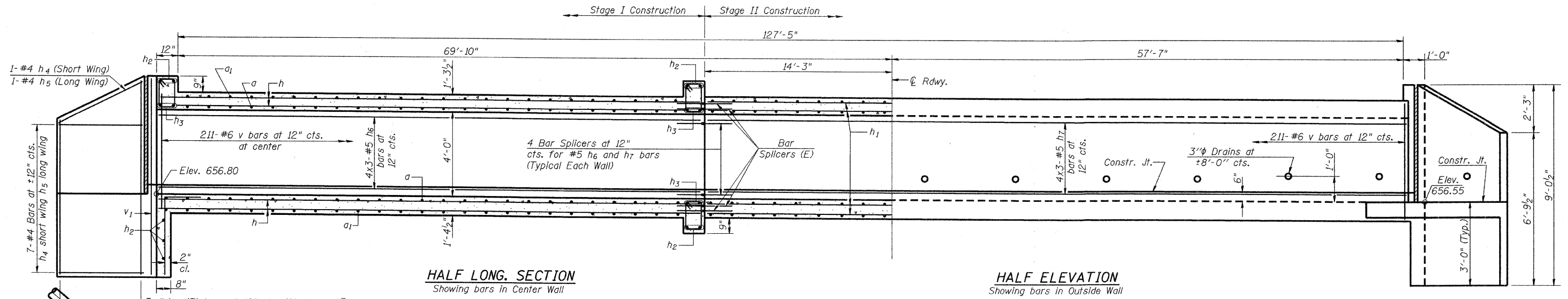

HALF LONG SECTION
Showing bars in Center Wall

HALF ELEVATION
Showing bars in Outside Wall

Dimensions are at Right Angles to ϕ Roadway

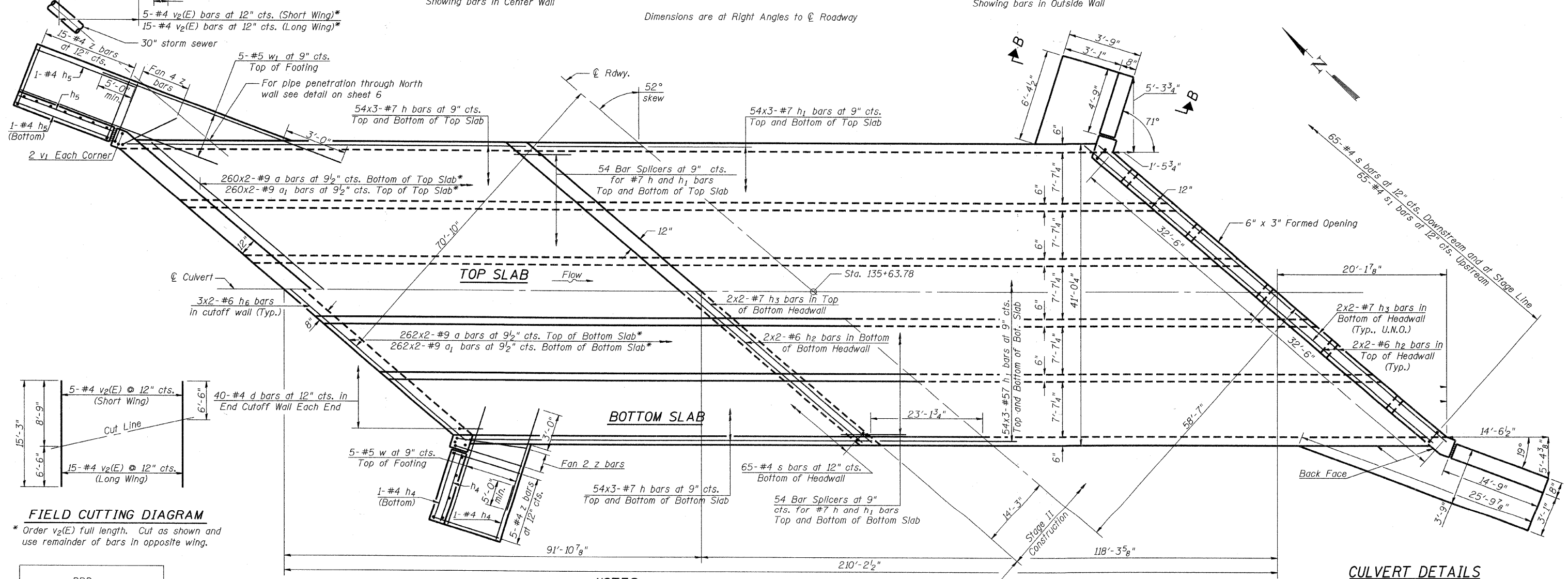

FIELD CUTTING DIAGRAM

* Order v₂(E) full length. Cut as shown and use remainder of bars in opposite wing.

NOTES

U.N.O. - Unless Noted Otherwise
Bars indicated thus 20 x 3-#5 etc. indicates 20 lines of bars with 3 lengths per line.
*Measured along centerline of culvert

CULVERT DETAILS
STRUCTURE NO. 045-6400

| | |
|----------|-----|
| DESIGNED | PRD |
| CHECKED | AWW |
| DRAWN | PRD |
| CHECKED | AWW |

rjngroup
Excellence through Ownership
200 West Front Street
Wheaton, IL 60187

SHEET NO. 5
9 SHEETS

| | | | | |
|---------------------|----------------|--------------------|------------------|-----------|
| F.A.P. RTE. | SECTION | COUNTY | TOTAL SHEETS | SHEET NO. |
| 336 | 99-00232-01-WR | Kane | 215 | 143 |
| FED. ROAD DIST. NO. | | ILLINOIS | FED. AID PROJECT | |
| | | CONTRACT NO. 63541 | | |

12/17/2010 9:04:54 AM K:\NIT7702\83738\CADD_Sheets\0456400-83738-05_Culvert.dgn