

PLAN
 SURVEYED _____ BY _____ DATE _____
 PLOTTED _____
 NOTE BOOK _____ CHECKED _____
 NO. _____ AUTOMATICALLY CHECKED _____
 CAD FILE NAME _____

PROFILE
 SURVEYED _____ BY _____ DATE _____
 GRADES CHECKED _____
 NOTE BOOK _____ CHECKED _____
 NO. _____ SIGNATURE _____ NOTATIONS CHFD _____

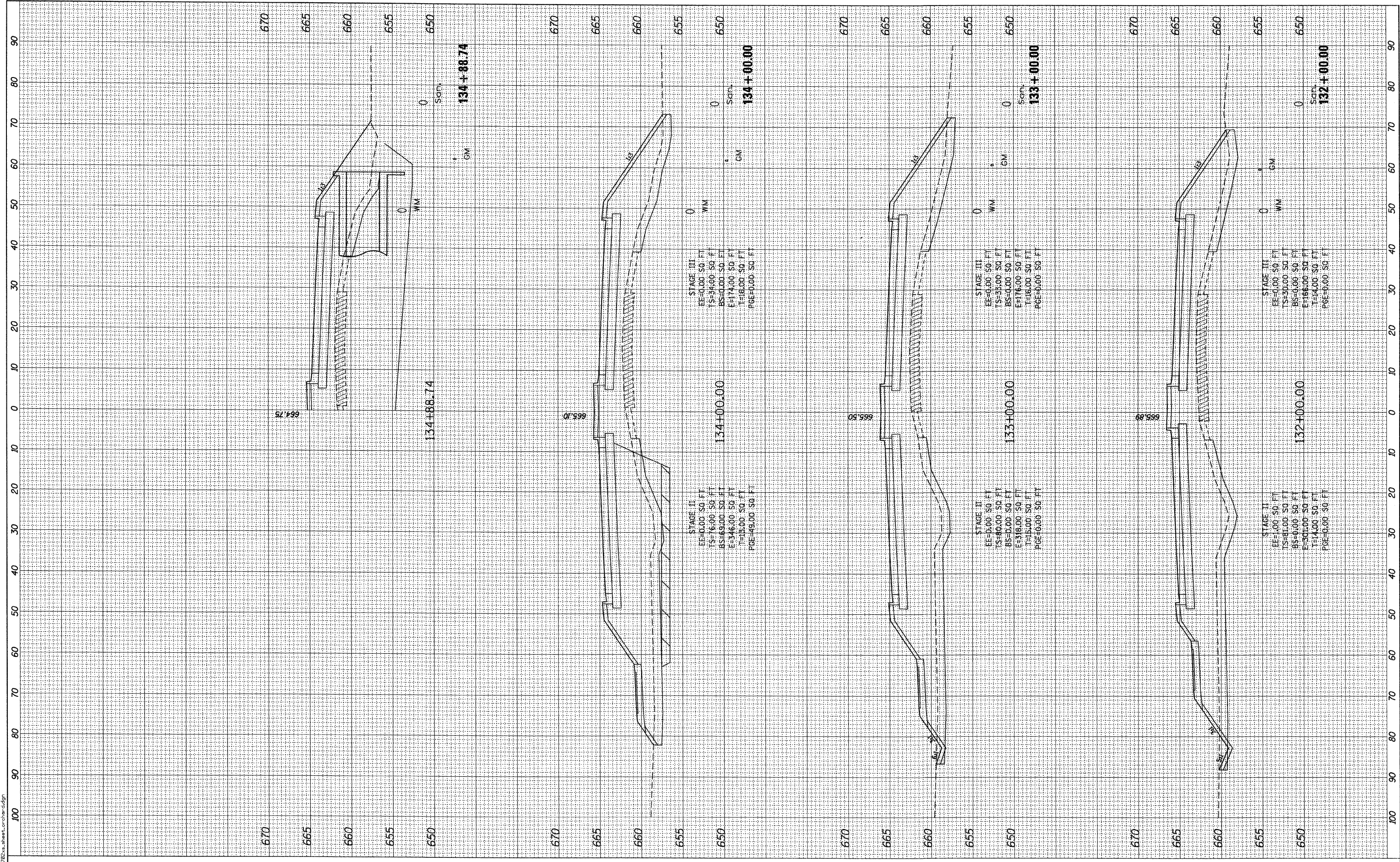

DESIGNED - MK	REVISED -
DRAWN - DW	REVISED -
CHECKED - MH	REVISED -
DATE - 12/20/2010	REVISED -

**KANE COUNTY
 DIVISION OF TRANSPORTATION
 ORCHARD ROAD RECONSTRUCTION**

ORCHARD ROAD CROSS SECTIONS
 SCALE: 1" = 10'
 SHEET NO. 10 OF 47 SHEETS
 STA. 132+00.00 TO STA. 134+88.74

F.A.P. R.T.E. 336	SECTION 99-00232-01-WR	COUNTY KANE	TOTAL SHEETS 215	SHEET NO. 177
CONTRACT NO. 63541			ILLINOIS FED. AID PROJECT	