

PLAN	SUBMITTED	BY	DATE
	NOTED		
	PLOTTED		
	FILED		
	REVISIONS		
	CAD FILE NAME		

PROFILE	SUBMITTED	BY	DATE
	NOTED		
	PLOTTED		
	FILED		
	REVISIONS		
	CAD FILE NAME		

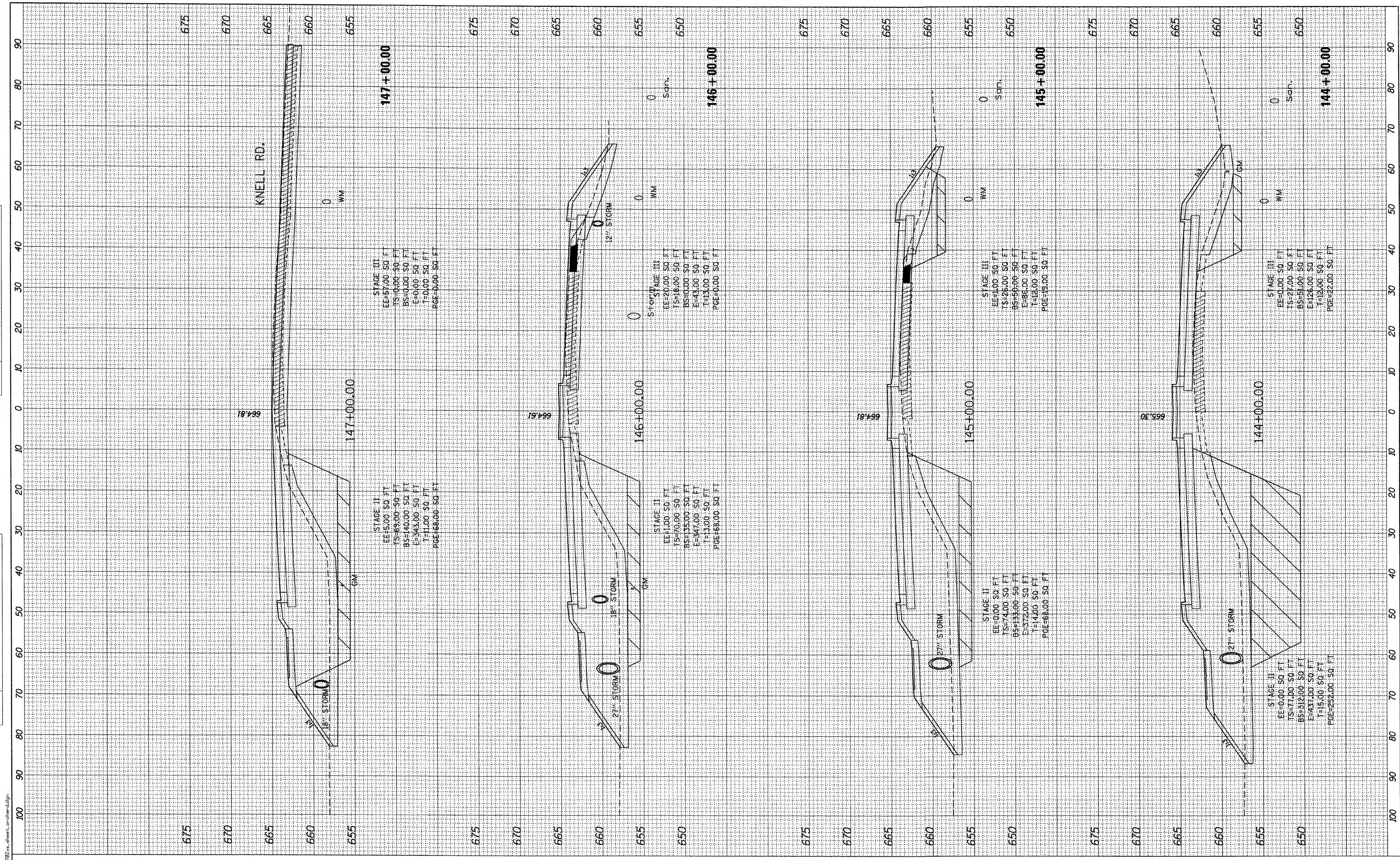

18.0006 / IN.  
12/17/2010  
K:\117782\CAD\Sheet\17782a.dwg



200 West Front Street  
Wheaton, IL 60187

DESIGNED	-	MK	REVISED	-
DRAWN	-	DW	REVISED	-
CHECKED	-	MH	REVISED	-
DATE	-	12/20/2010	REVISED	-

REVISED	-
REVISED	-
REVISED	-
REVISED	-

**KANE COUNTY  
DIVISION OF TRANSPORTATION  
ORCHARD ROAD RECONSTRUCTION**

**ORCHARD ROAD CROSS SECTIONS**

SCALE: 1" = 10' SHEET NO. 14 OF 47 SHEETS STA. 144+00.00 TO STA. 147+00.00

F.A.P. RTE.	SECTION	COUNTY	TOTAL SHEETS	SHEET NO.
336	99-00232-01-WR	KANE	215	181
ILLINOIS FED. AID PROJECT			CONTRACT NO. 63541	