

**PROPOSED 71ST STREET**  
 STA 24+60 TO STA 27+75  
 STA 25+04 TO STA 26+00 (\*SLOPE VARIES - SEE SE TABLES FOR TRANSITION)  
 STA 27+75 TO STA 27+90 (\*SLOPE VARIES - SEE SE TABLES FOR TRANSITION)  
 \*\* RW SN 016-7725 FROM STA 23+73.90 TO STA 26+47.29 & RW SN 016-7726 FROM STA 27+30.63 TO STA 27+62.00  
 \*\*\* RW SN 016-7724 FROM STA 23+73.90 TO STA 27+90.00

- PROPOSED LEGEND:**
- ① PORTLAND CEMENT CONCRETE PAVEMENT 10" (JOINTED) - (15' JOINT SPACING)
  - ② STABILIZED SUBBASE - HOT-MIX ASPHALT, 4 1/2"
  - ③ AGGREGATE SUBGRADE 12"
  - ④ COMBINATION CURB AND GUTTER TYPE B-6.12
  - ⑤ PORTLAND CEMENT CONCRETE SIDEWALK 5 INCH
  - ⑥ TOPSOIL AND SODDING (SEE LANDSCAPING PLANS)
  - ⑦ RETAINING WALL - SN 016-7722 OR SN 016-7724
  - ⑧ RETAINING WALL - SN 016-7721 OR SN 016-7725 OR SN 016-7726
  - ⑨ BITUMINOUS MATERIALS (PRIME COAT)
  - ⑩ AGGREGATE (PRIME COAT)
  - ⑪ #6 TIE BARS, 30" LONG AT 30" C-C (IF LONGITUDINAL SAWED JOINT) / #6 TIE BARS, 24" LONG AT 24" C-C (IF LONGITUDINAL CONSTRUCTION JOINT) (INCLUDED IN PRICE FOR BID FOR VARIOUS PCC ITEMS)
  - ⑫ #6 TIE BARS, 24" LONG AT 24" C-C (INCLUDED IN PRICE FOR BID FOR VARIOUS PCC ITEMS)
  - ⑬ PROPOSED LIGHTING UNIT
- EXISTING LEGEND:**
- Ⓐ EXISTING PAVEMENT (+10" CONCRETE - 71ST STREET; HMA FERDINAND)
  - Ⓑ GRAVEL OR CRUSHED STONE BASE
  - Ⓒ COMBINATION CURB & GUTTER
  - Ⓓ EXISTING GROUND LINE

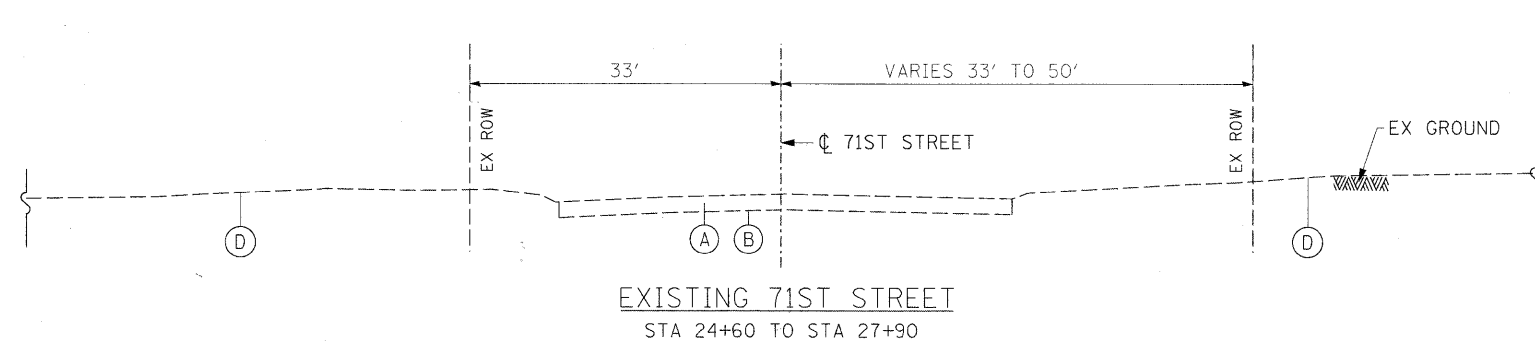

**EXISTING 71ST STREET**  
 STA 24+60 TO STA 27+90

**71ST STREET**

STRUCTURAL DESIGN TRAFFIC:	YEAR	2030
PV= 5,040	SU= 659	MU= 237
ROAD/STREET CLASSIFICATION:	CLASS 1	
PERCENT OF STRUCTURAL DESIGN TRAFFIC IN DESIGN LANE:		
P= 84.9%	S= 11.1%	M= 4.0%
TRAFFIC FACTOR:	ACTUAL TF= 2.35	AC TYPE= 20
	MINIMUM TF= NA	
PG GRADE:	BINDER= NA	SURFACE= NA
SUBGRADE SUPPORT RATING	SSR= FAIR	

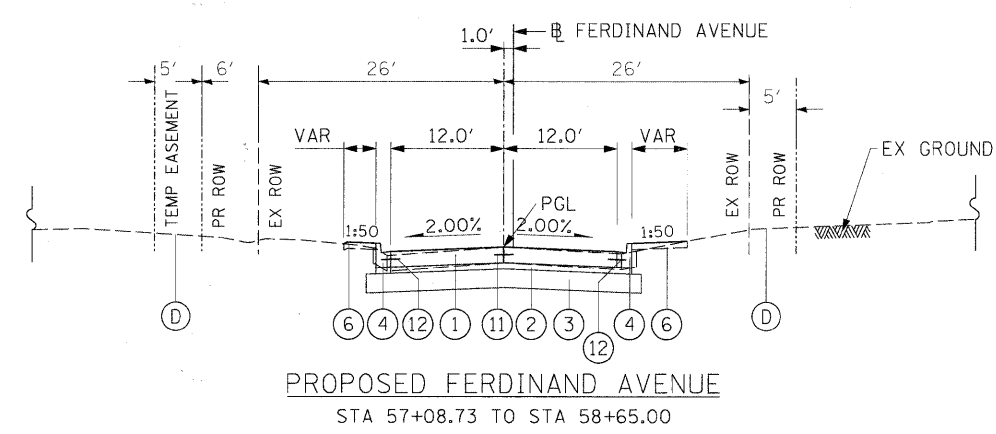

**PROPOSED FERDINAND AVENUE**  
 STA 57+08.73 TO STA 58+65.00

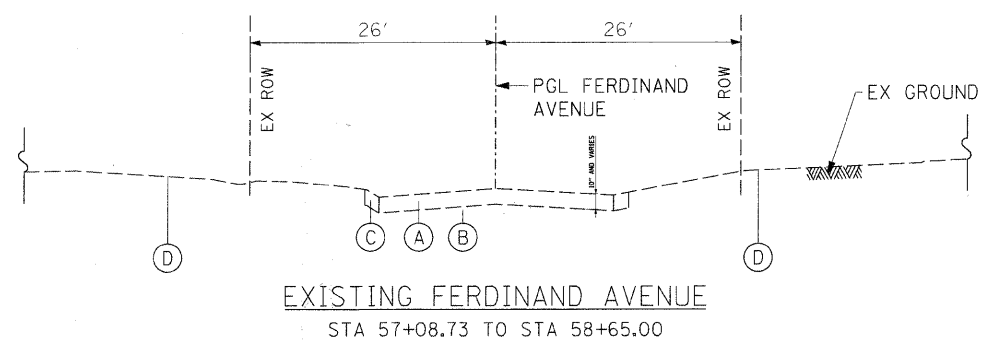

**EXISTING FERDINAND AVENUE**  
 STA 57+08.73 TO STA 58+65.00

FILE NAME = P:\60155877\6020 CAD\001 Drawings\Sheets\Civil\60155877-hts-Typico-02.dgn



USER NAME = manuj	DESIGNED - NJH	REVISED - 4/14/11 ADDENDUM 1
PLOT SCALE = 1/8" = 1'	DRAWN - JWM	REVISED -
PLOT DATE = 4/12/2011	CHECKED - TJW	REVISED -
	DATE - March 17, 2011	REVISED -

**STATE OF ILLINOIS  
 DEPARTMENT OF TRANSPORTATION**

**TYPICAL SECTIONS**

SCALE: 1"=10'	SHEET NO. 2 OF 3 SHEETS	STA. 17+08.73 TO STA. 19+76.00
---------------	-------------------------	--------------------------------

F.A.U. RTE.	SECTION	COUNTY	TOTAL SHEETS	SHEET NO.
1537	06-00050-00-GS	COOK	209	12
FED. ROAD DIST. NO. 1 ILLINOIS FED. AID PROJECT CRE-9003(709)			CONTRACT NO. 63556	